

DV25FG62B0BE

4.0 cu. ft. Smart Dial Heat Pump Dryer with Sensor Dry

SAMSUNG



Dryer door installed left swing from factory.

Available Color

White
DV25FG62B0BE

- Features
- Heat Pump Technology
 - AI Smart Dial
 - ENERGY STAR® Certified
 - Wi-Fi Connectivity¹
 - Sensor Dry
 - Large 4.0 cu. ft. Capacity
 - Lint Filter Indicator
 - Stainless Steel Drum
 - Internal Drum Light
 - Closet-Depth Fit²
 - Reversible Dryer Door
 - 15 Total Drying Cycles
 - 11 Options
 - 10 Timed Dry Settings

- Convenience
- Child Lock
 - Filter Check Indicator

Ratings

 ENERGY STAR® Rated:
125 kWh/yr

Electrical Requirements

240 V / 60 Hz

30 Amps

- Specifications
- 15 Total Drying Cycles:

Normal, Heavy Duty, Mixed Load, Towels, Perm Press, Activewear, Bedding, Denim, Delicates, Wool, Shirts, Time Dry, Air Fluff, 40' Express, Refresh
- 11 Options:

Damp Alert, Wrinkle Prevent, My Cycles, Smart Control, Drum Light, Alarm, AI Pattern, Wi-Fi, Language, Child Lock, Factory Reset
- 3 Dry Levels:

More Dry, Normal Dry, Less Dry

- Warranty
- One (1) Year Parts and Labor
- Product Dimensions & Weight (WxHxD)

Dimensions: 23⁵/₈" x 33¹/₂" x 25¹³/₁₆"

Weight: 110.2 lbs
- Shipping Dimensions & Weight (WxHxD)

Dimensions: 26³/₈" x 34⁷/₈" x 27³/₈"

Weight: 114.6 lbs

Heat Pump Dryer	Model #	UPC Code
White	DV25FG62B0BEA2	198957233562

Matching Electric Dryer

White	DV25FG60BVBEA2	198957233555
-------	----------------	--------------

Matching Washer

White	WW25FG6B34BEA2	198957226892
-------	----------------	--------------

Optional Accessory	Model #	UPC Code
Stacking Kit	SKK-DF	198957238253

¹ Requires wireless network, Samsung account and Samsung SmartThings App. The Samsung SmartThings App supports Android OS 4.0 (ICS) or later, which is optimized for Samsung smartphones (Galaxy S and Galaxy Note series). This app also supports iOS 7 or later for iPhone models. Samsung SmartThings App available in App Store and Play Store.

² Designed to fit a 30" installation depth.

Dimensions

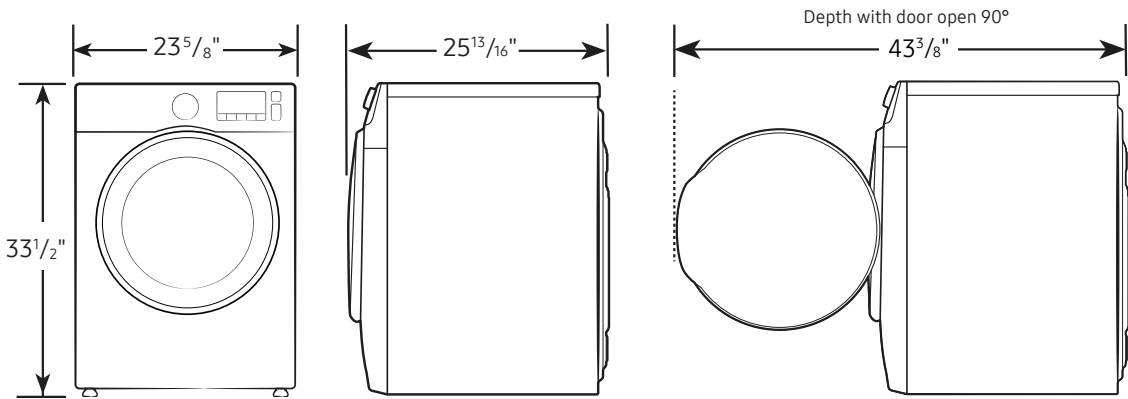

Installation Specifications – Side-by-Side or Stand-Alone

If the washer and dryer are installed together or the dryer alone, the closet front must have two unobstructed air openings for a combined minimum total area of 72-inch². Your washer alone does not require a specific air opening.

Alcove or closet installation
Minimum clearances for
closet and alcove installations:

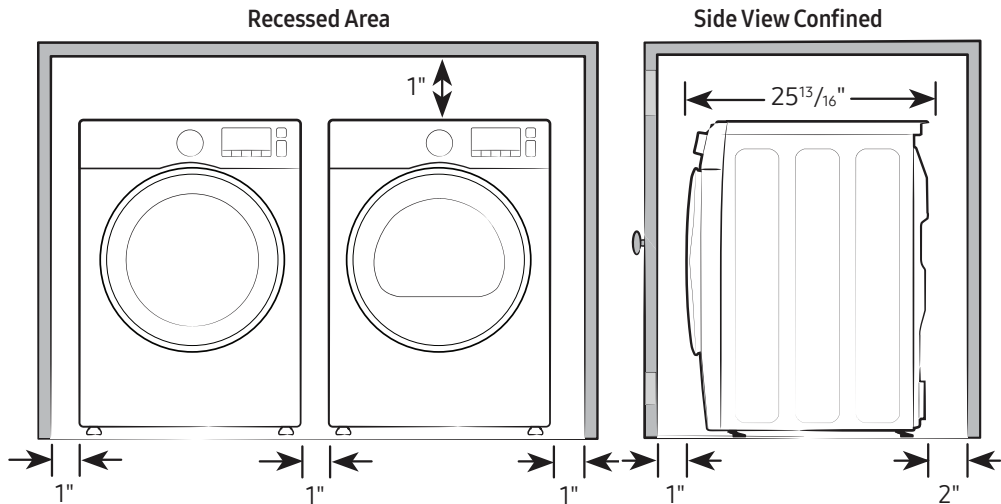

Installation Specifications – Stacked Pair

Clearances indicated are for stacked pairs. The closet front must have two unobstructed air openings for a combined minimum total area of 72-inch².

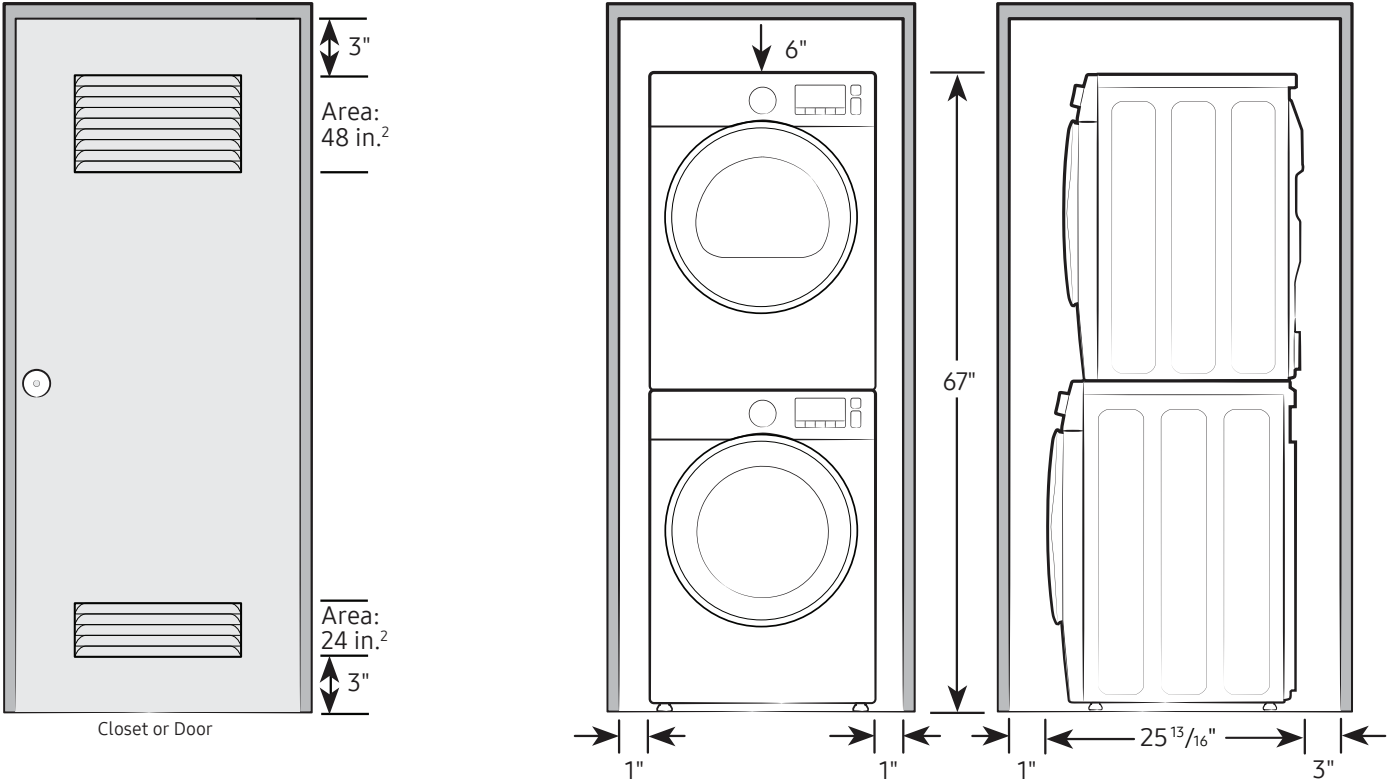

Connection Dimensions

Back and side views of stacked pair

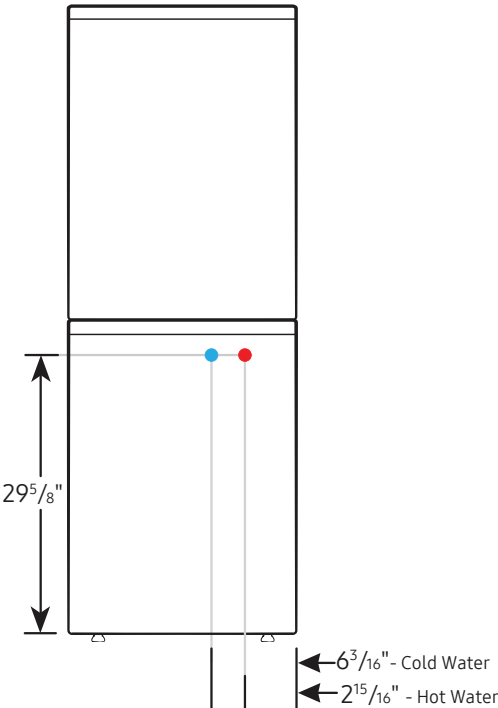

LEGEND:

- Cold Water Connection
- Hot Water Connection

Actual color may vary. Design, specifications, and color availability are subject to change without notice. Non-metric weights and measurements are approximate.

©2025 Samsung Electronics America, Inc., 700 Sylvan Avenue, Englewood Cliffs, NJ 07632. Tel: 800-SAMSUNG.samsung.com. Samsung is a registered trademark of Samsung Electronics Co., Ltd.