

# KITCHEN PLANNER

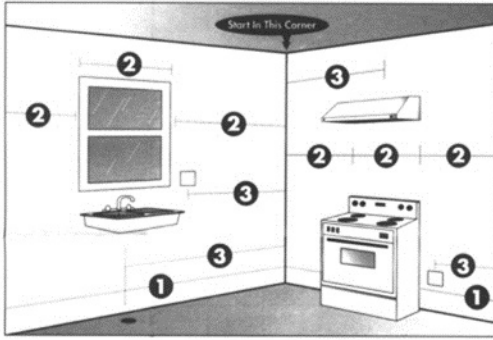

- 1 Measure the overall length of each wall. Use the grid on this page to note your measurements.
- 2 Indicate all breaks in wall such as doors, windows, etc. Show measurements from the corners.
- 3 Indicate all permanent appliances, plumbing, vents and electrical. Plumbing and electrical can be moved to fit a new layout.
- 4 Use your kitchen measurements to start sketching your cabinet layout. Start in one corner and work around the room. Remember that the small squares are 3 inches and the large squares equal 1 foot.
- 5 Note the location of your plumbing fixtures, electrical outlets and air vent ducts. Major appliances may be moved several inches either way to accommodate your layout.
- 6 Do not forget to include in your layout accessorized items, such as toe kick plates, wall and base filler strips, etc.

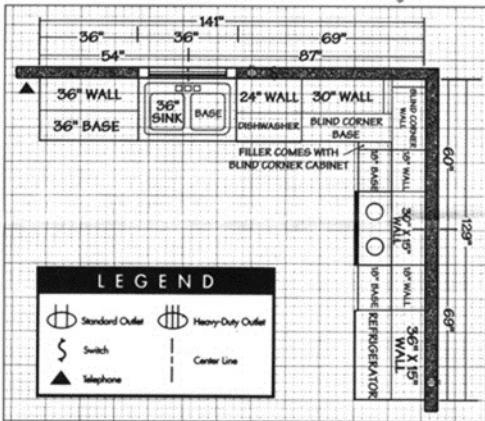
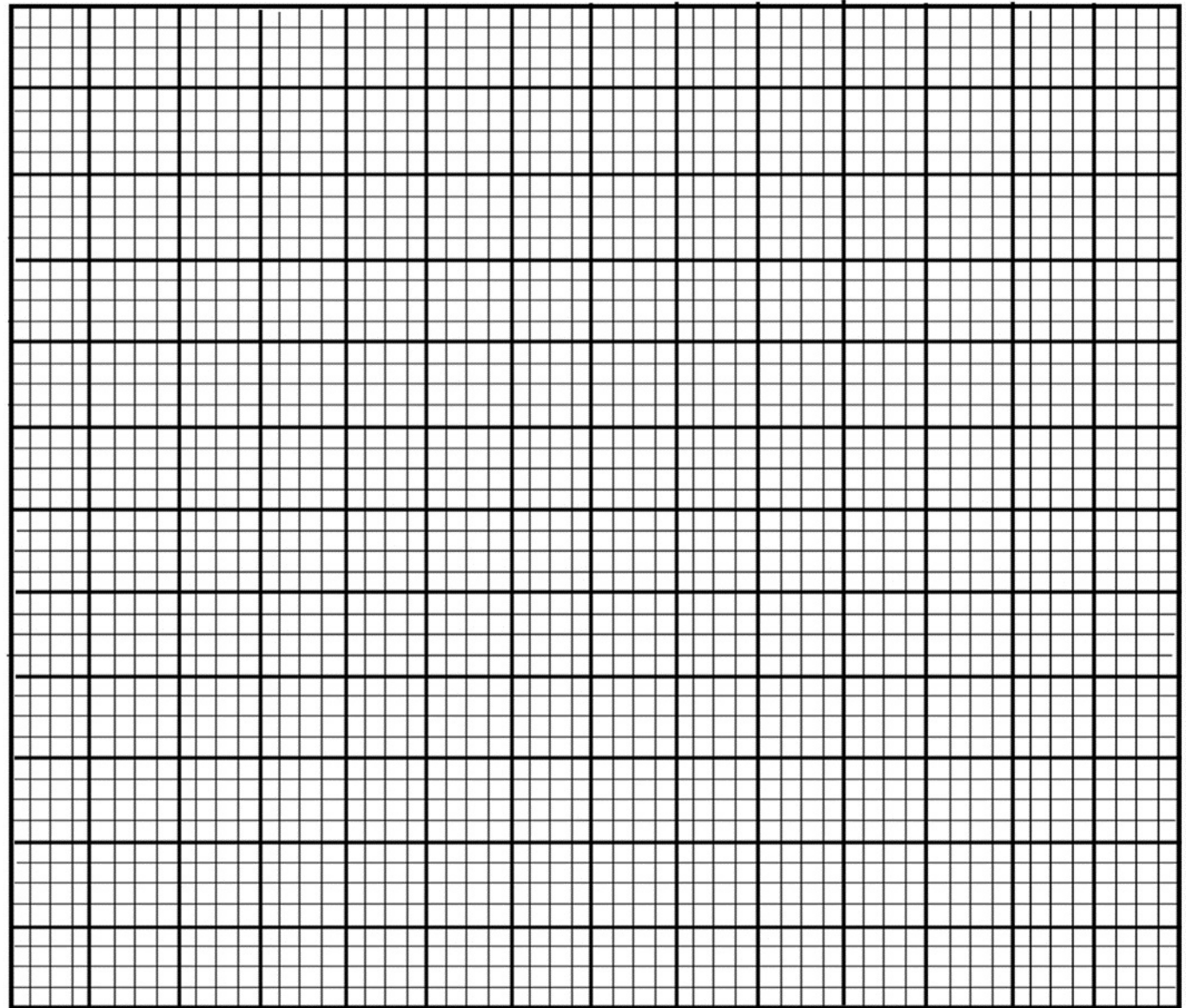

## Corner Layout Ideas (overhead views)

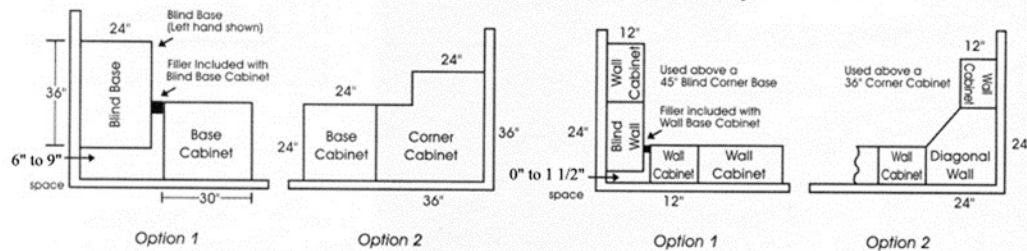

BASE CABINETS

WALL CABINETS