

## ⚠ WARNING

**Serious or fatal crushing injuries can occur from furniture tip-over. To help prevent tip-over:**

- install tipover restraint provided.
- Place heaviest items in the lowest drawers.
- Do not set TV's or other heavy objects on top of this product unless the product is specifically designed to accommodate them.
- Never allow children to climb or hang on drawers, doors, or shelves.
- Never open more than one drawers at a time (OR)
- Do not defeat or remove the drawers interlock system.

**Use of tip-over restraints may only reduce, but not eliminate, the risk of tip-over.**

this is a permanent label. Do not remove!

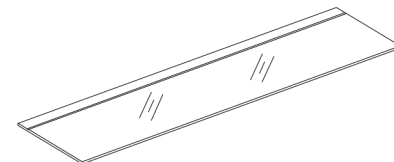
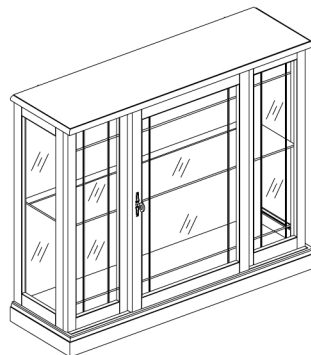

**A**

x1 Console  
x1 Console  
x1 Consola

**B**

x1 Glass shelf \*  
x1 Étagère en verre  
x1 Estante de vidrio



**C**

x4 Common Shelf Support \*  
x4 Supports Pour Tablette  
x4 Soporte De Las Repisas

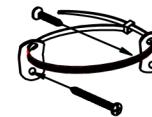

**D**

x1 Furniture Tipping Restraint  
x1 Systeme antibasculément  
x1 Control para evitar vulcos

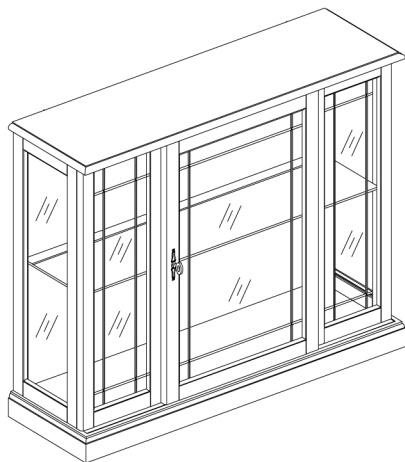

\* Replaceable Part

**⚠ WARNING**

**Serious or fatal crushing injuries can occur from furniture tip-over. To help prevent tip-over:**

- install tipover restraint provided.
- Place heaviest items in the lowest drawers.
- Do not set TV's or other heavy objects on top of this product unless the product is specifically designed to accommodate them.
- Never allow children to climb or hang on drawers, doors, or shelves.
- Never open more than one drawers at a time (OR)
- Do not defeat or remove the drawers interlock system.

**Use of tip-over restraints may only reduce, but not eliminate, the risk of tip-over. this is a permanent label. Do not remove!**

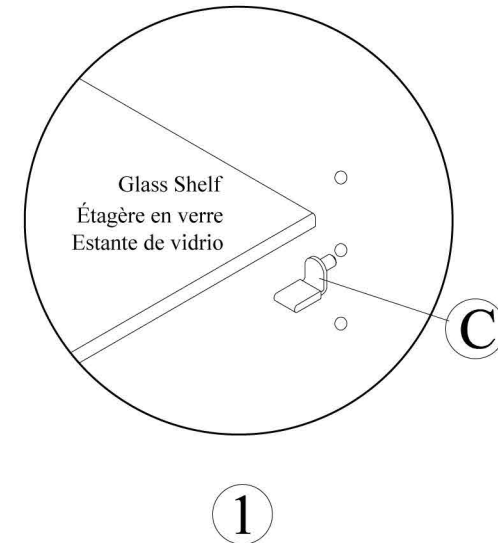
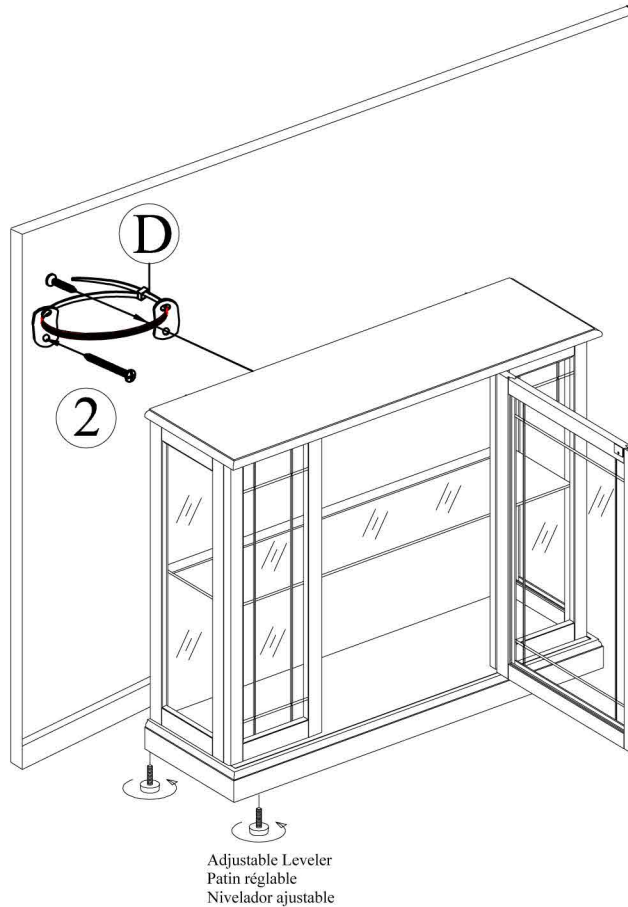
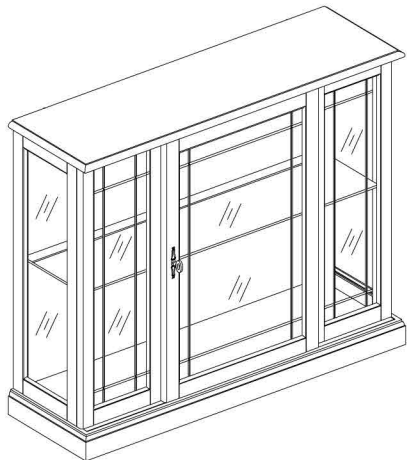

**⚠ WARNING**

**Serious or fatal crushing injuries can occur from furniture tip-over. To help prevent tip-over:**

- install tipover restraint provided.
- Place heaviest items in the lowest drawers.
- Do not set TV's or other heavy objects on top of this product unless the product is specifically designed to accommodate them.
- Never allow children to climb or hang on drawers, doors, or shelves.
- Never open more than one drawers at a time (OR)
- Do not defeat or remove the drawers interlock system.

**Use of tip-over restraints may only reduce, but not eliminate, the risk of tip-over.**

this is a permanent label. Do not remove!



- x1 R6705-PULL  
Pull with screw \*  
Poignée et vis  
Tirador y Tornillo

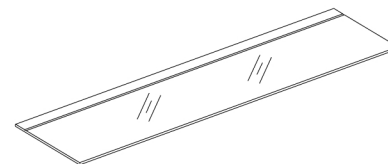

- x1 R01137-60 \*  
Glass shelf \*  
Étagère en verre  
Estante de vidrio

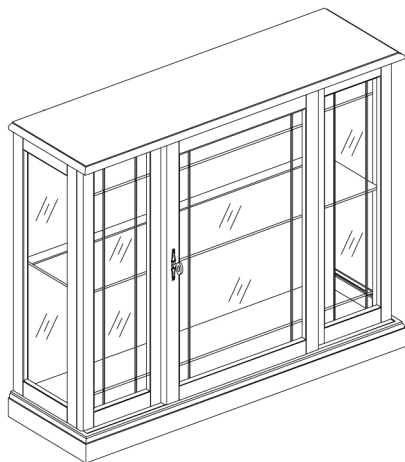

- x4 RC-SUPPORT-01  
Common Shelf Support \*  
Supports Pour Tablette  
Soporte De Las Repisas

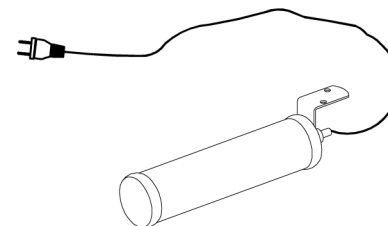

- x1 RC-LIGHT-22  
Light fixture \*  
Lumière  
luz

\* Replaceable Part