



## Palladian Shower Package

ROHL Transitional Palladian

### AKIT92LM

#### FEATURES

- Shower package components:
  - A1900 – Pressure Balance Trim
  - 1440/6 – Shower Arm
  - B100701 – Showerhead
- **To complete package, rough valve must be ordered separately:**
  - **RMV-1 – Pressure Balance Rough**

#### COLORS/FINISHES

- Polished Chrome
- Polished Nickel
- Satin Nickel
- Tuscan Brass

#### WARRANTY

- See individual component specs for warranty

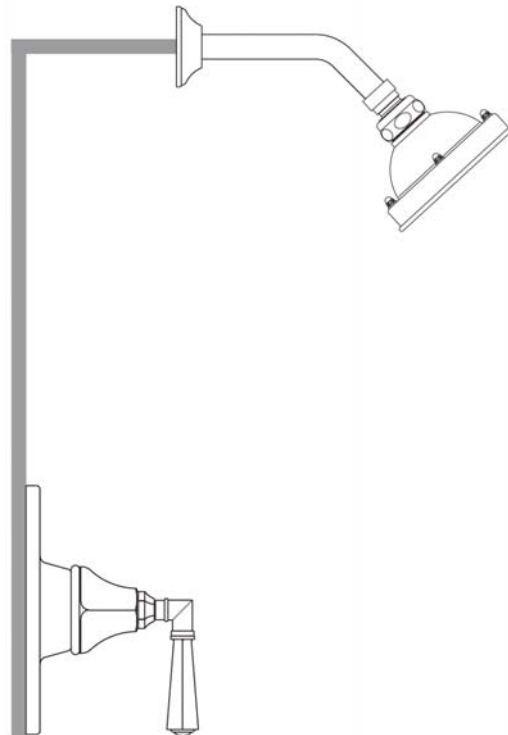



## Palladian Pressure Balance Trim Without Diverter

ROHL Transitional Palladian

**A1900LM** (Metal Lever)

**A1900XM** (Cross Handle)

### FEATURES

- Palladian metal lever
- Single lever control
- Coverplate, dome, and handle made from solid brass
- Trim for concealed pressure balance shower or bath valve
- **To complete package order #RMV-1 rough valve**

### COLORS/FINISHES

- Polished Chrome
- Polished Nickel
- Satin Nickel
- Tuscan Brass
- Inca Brass

### WARRANTY

- Limited Lifetime\*

\* No Warranty on Tuscan Brass Finish

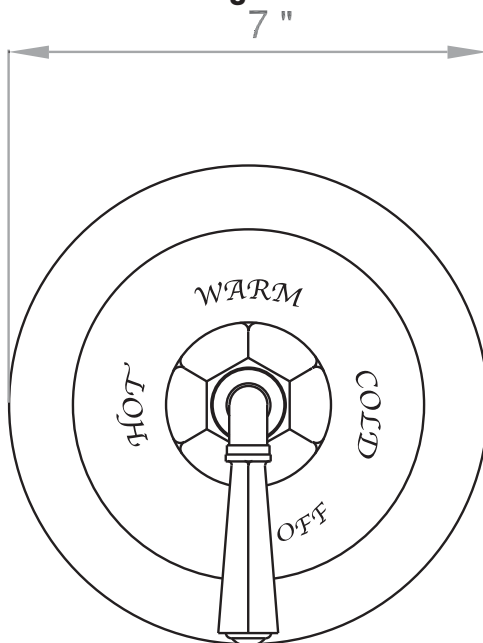

**A1900LM**

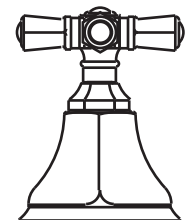
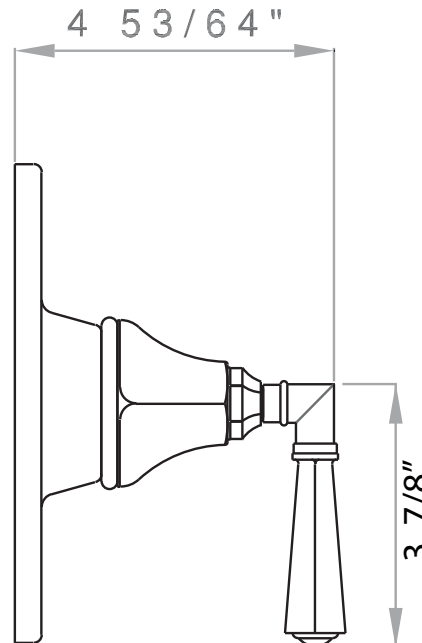

**A1900XM**

## A1900 Spare Parts and Installation Instructions

**IMPORTANT:**  
ROUGH AND TRIM MUST BE PURCHASED SEPARATELY. PLEASE NOTE THE HANDLE PIECES ARE ASSEMBLED IN THE BOX. YOU MUST DISASSEMBLE FOR INSTALLATION (SEE DRAWING).

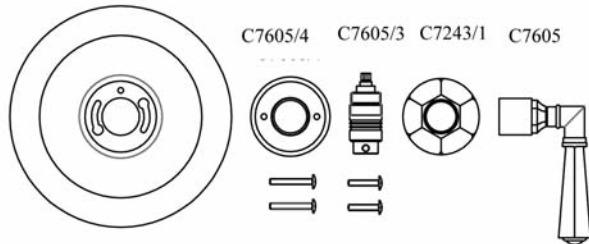

### ASSEMBLING INSTRUCTIONS

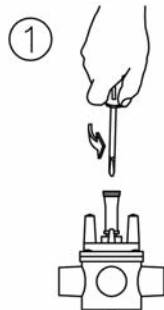

UNSCREW THE ADAPTER'S SCREW

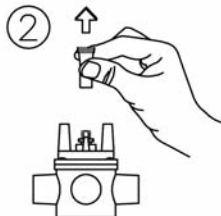

REMOVE THE ADAPTER, BUT LEAVE THE CAM STOP 1403-0896 IN PLACE (NOT PICTURED)

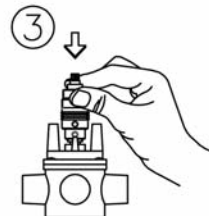

INSERT THE NEW ADAPTER FOR A7605 (PLEASE SEE UNDER THE "WALL LIMITS NOTE")

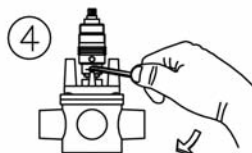

SCREW THE ADAPTER'S DOWEL TIGHTEN THE ADAPTER ONTO THE SPINDLE WITH A 3 mm. ALLEN KEY (NOT INCLUDED)

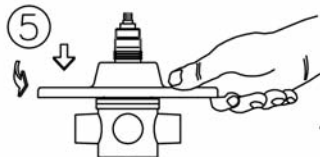

PLACE THE EXTERNAL PLATE PLEASE NOTE, THE ADAPTER HAS A VARIABLE LENGTH TO ADJUST FOR THE VALVE DEPTH. FIT THE PLATE, AND SCREW THE ADAPTER OUT TO EXPOSE THE 3 O-RINGS. ADJUST THE DEPTH AS NEEDED; THEN TIGHTEN WITH 3mm. ALLEN KEY

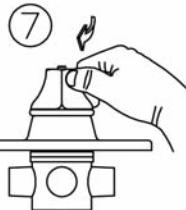

SCREW THE HEXAGONAL CAP HAVING CARE TO UNSCREW 1/4 TURN TO THE END

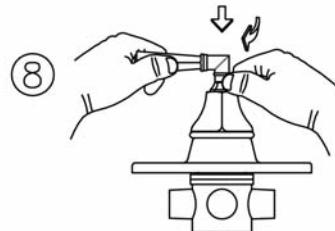

INSERT THE HANDLE AND FIX IT SCREWING THE HEXAGONAL COVER VALVE ATTENTION: BE SURE THAT THE HANDLE HAS NO PLAY UNSCREW THE CAP JUST TO GET IN TOUCH WITH THE COVER VALVE

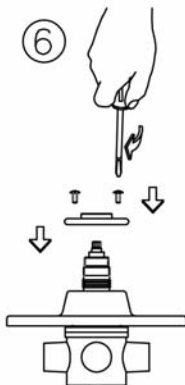

PLACE THE ADAPTER'S RING AND FIX IT WITH THE SCREWS

#### WALL LIMITS NOTE

FINISHED WALL LIMITS (TEMPRESS TEMPLATE INDICATION)

MINIMUM

MAXIMUM



ADJUSTING THE ADAPTER LENGTH

UNSCREW THE DOWEL EXTRACT THE LOWER PART SCREW THE DOWEL

**ATTENTION :** ENSURE ALL PARTS ARE FIRMLY TIGHTENED



## Retro Jet Showerhead

ROHL Shower Collection

**B100700** (9" Spray Area)

**B100701** (6" Spray Area)

### FEATURES

- Single function classic spray pattern
- Flexible spray nozzles allow for easy removal of hard water build-up
- 1/2" female inlet with swivel connection
- Restricted to 2.5 GPM

### COLORS/FINISHES

- Polished Chrome
- Polished Nickel
- Satin Nickel
- Tuscan Brass

### WARRANTY

- 2 Years on manufacturer defects\*

\* No Warranty on Tuscan Brass Finish (TCB)

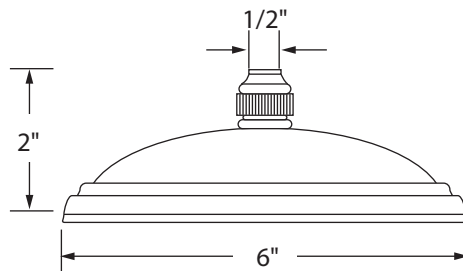

**B100701**

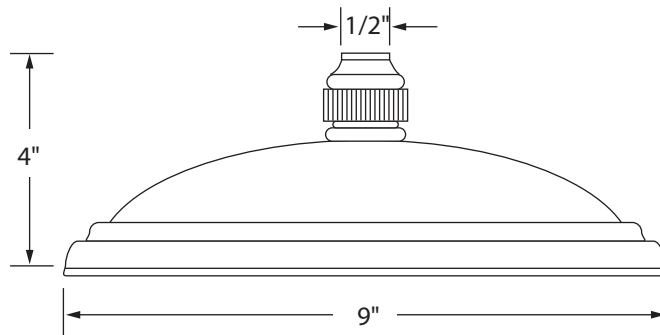

**B100700**



## Shower Arm

ROHL Shower Collection

**1440/6** 6" Shower Arm

**1440/8** 8" Shower Arm

### FEATURES

- Brass construction
- Sliding escutcheon
- 1/2" male thread inlet supply
- 1/2" male thread outlet supply

### COLORS/FINISHES

- Polished Chrome
- Polished Nickel
- Satin Nickel
- Tuscan Brass
- Inca Brass
- Old Iron

### WARRANTY

- 2 years on manufacturer defects\*

\* No Warranty On Tuscan Brass Finish (TCB)

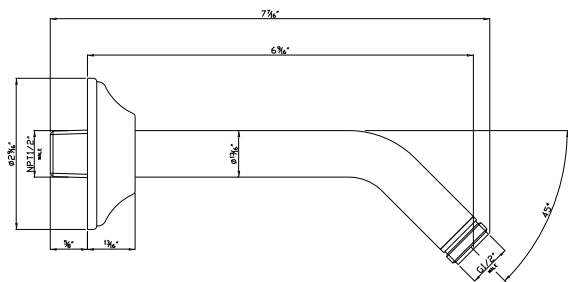

**1440/6**

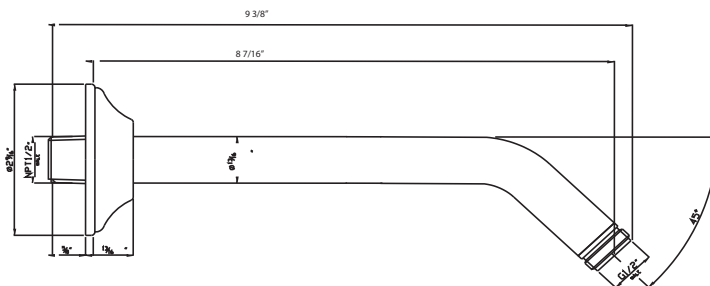

**1440/8**