



## Palladian Pressure Balance Trim With Diverter

ROHL Transitional Palladian

**A2900LM** (Metal Lever)

**A2900XM** (Cross Handle)

### FEATURES

- Single lever control
- Coverplate, dome, and handle made from solid brass
- Trim for concealed pressure balance shower and bath valve
- **To complete package order #RMV-2 rough valve**

### COLORS/FINISHES

- Polished Chrome
- Polished Nickel
- Satin Nickel
- Tuscan Brass
- Inca Brass

### WARRANTY

- Limited Lifetime\*

\* No Warranty on Tuscan Brass Finish

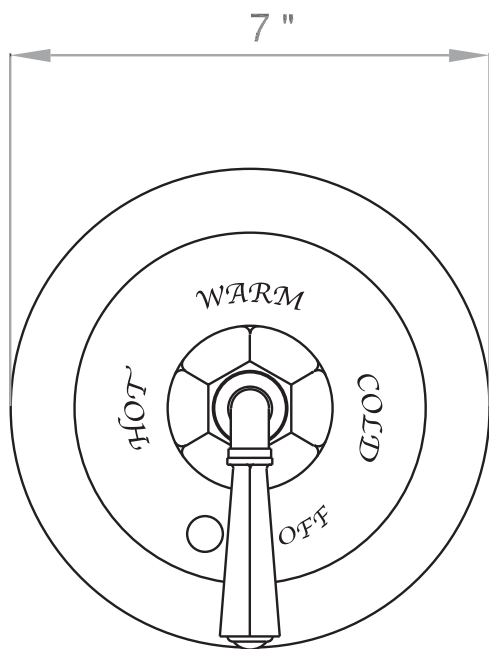

**A2900LM**

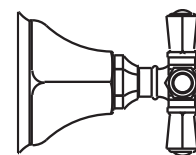
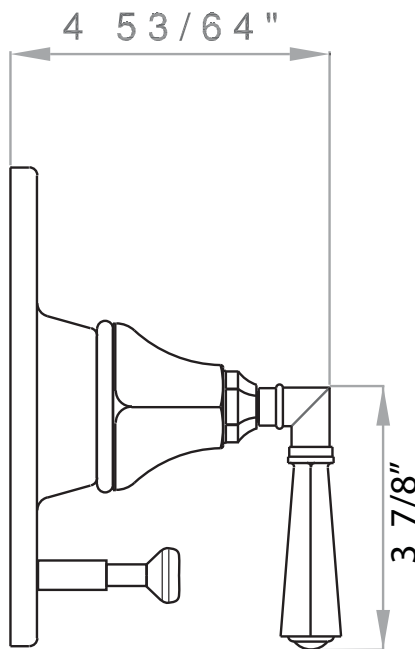

**A2900XM**

## A2900 Spare Parts and Installation Instructions

### IMPORTANT:

ROUGH AND TRIM MUST BE PURCHASED SEPARATELY. PLEASE NOTE THE HANDLE PIECES ARE ASSEMBLED IN THE BOX. YOU MUST DISASSEMBLE FOR INSTALLATION (SEE DRAWING).

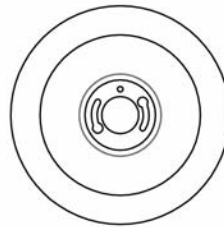

C7605/4 C7605/3 C7243/1 C7605

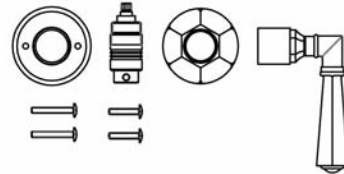

### ASSEMBLING INSTRUCTIONS

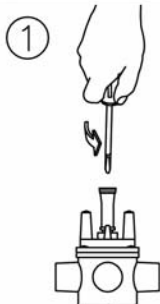

UNSCREW THE ADAPTER'S SCREW

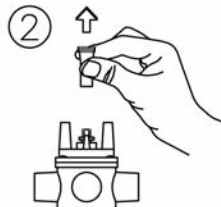

REMOVE THE ADAPTER, BUT LEAVE THE CAM STOP 1403-0696 IN PLACE (NOT PICTURED)

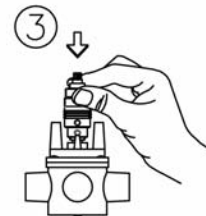

INSERT THE NEW ADAPTER FOR A7605 (PLEASE SEE UNDER THE "WALL LIMITS NOTE")

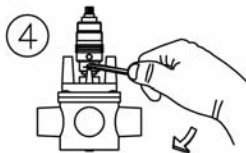

SCREW THE ADAPTER'S DOWEL TIGHTEN THE ADAPTER ONTO THE SPINDLE WITH A 3 mm. ALLEN KEY (NOT INCLUDED)

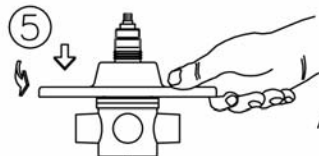

PLACE THE EXTERNAL PLATE PLEASE NOTE, THE ADAPTER HAS A VARIABLE LENGTH TO ADJUST FOR THE VALVE DEPTH. FIT THE PLATE, AND SCREW THE ADAPTER OUT TO EXPOSE THE 3 O-RINGS. ADJUST THE DEPTH AS NEEDED; THEN TIGHTEN WITH 3mm. ALLEN KEY

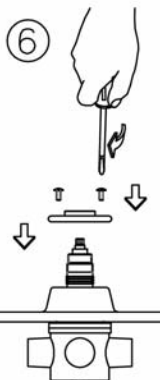

PLACE THE ADAPTER'S RING AND FIX IT WITH THE SCREWS

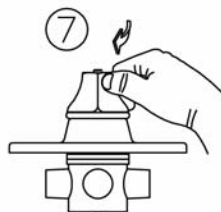

SCREW THE HEXAGONAL CAP HAVING CARE TO UNSCREW 1/4 TURN TO THE END

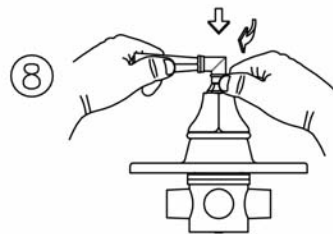

INSERT THE HANDLE AND FIX IT SCREWING THE HEXAGONAL COVER VALVE ATTENTION: BE SURE THAT THE HANDLE HAS NO PLAY UNSCREW THE CAP JUST TO GET IN TOUCH WITH THE COVER VALVE

### WALL LIMITS NOTE

FINISHED WALL LIMITS (TEMPRESS TEMPLATE INDICATION)

MINIMUM

MAXIMUM

ADJUSTING THE ADAPTER LENGTH

UNSCREW THE DOWEL EXTRACT THE LOWER PART SCREW THE DOWEL

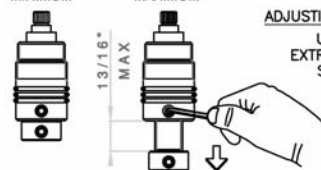

**ATTENTION :** ENSURE ALL PARTS ARE FIRMLY TIGHTENED