

*Sizes, models and finishes may differ from those presented.

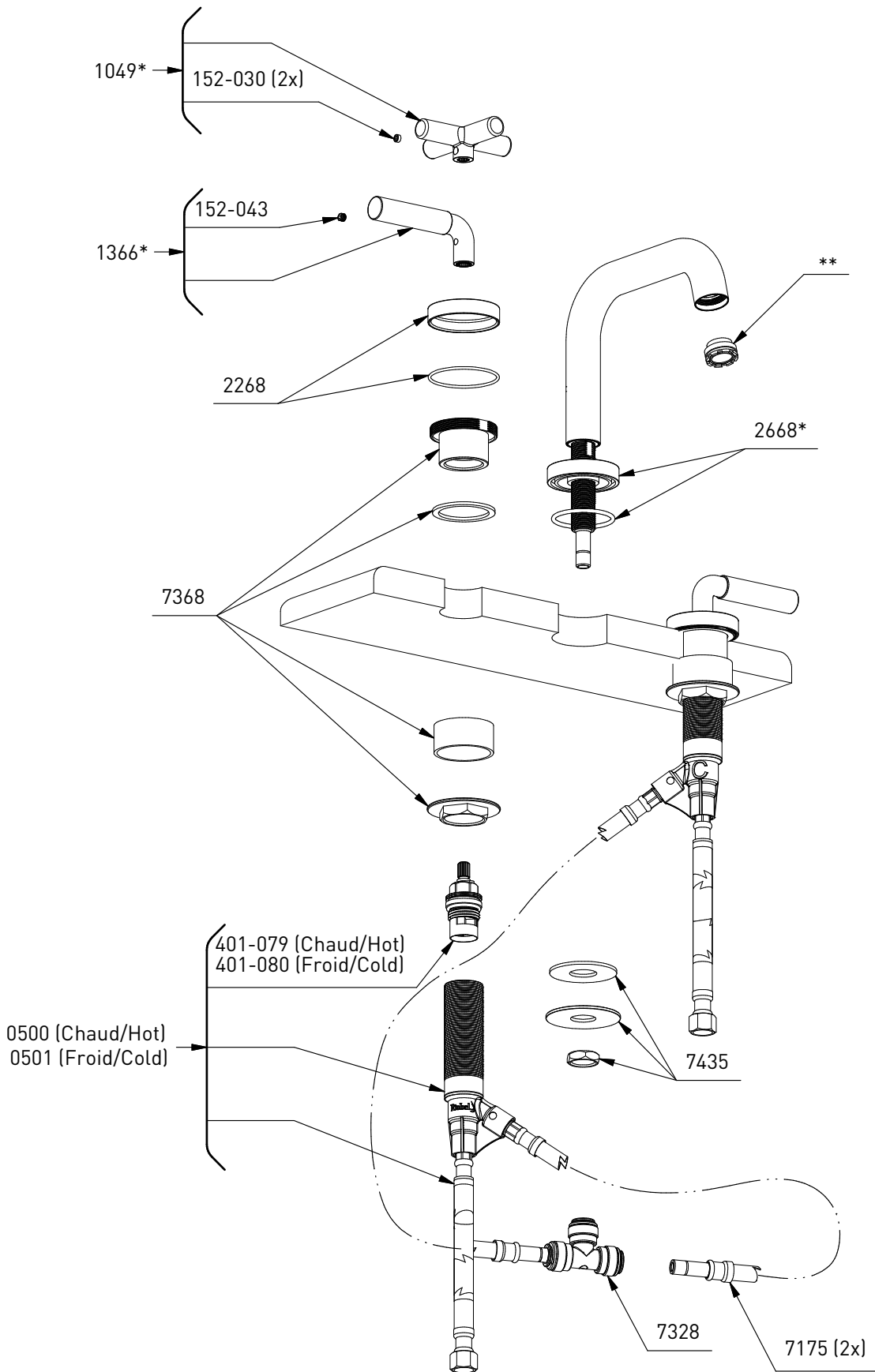

Push drain part view, See 6150

*Finish determined by Suffix

Finish	Description
C	Chrome
BN	Brushed Nickel
PN	Polished Nickel
BG	Brushed Gold
BK	Black

**Aerator Kit (Include tool) :

- S6-654-12 (1.2gpm / 4.6l/min)
- S6-654-10 (1.0gpm / 3.8l/min)
- S6-654-05 (0.5gpm / 1.9l/min)

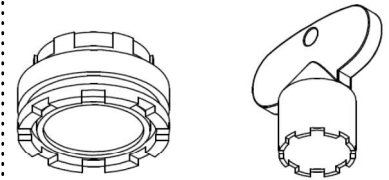

TOOL :

505-025 (Allen key 2.5mm)

