

BASE OR LOWER CABINET

ARE YOU CHOOSING THE CORRECT SIZE?

MAKE SURE TO CORRECTLY MEASURE YOUR CABINET'S OPENING (INSIDE DIMENSIONS)

- Measure side to side (width)
- Measure front to back (depth or length)
- Measure top to bottom (height)

DOUBLE CHECK THAT THE PRODUCT IS WITHIN YOUR MEASUREMENTS AND DON'T FORGET TO TAKE INTO ACCOUNT ANY OBSTRUCTIONS (PLUMBING, HINGES, ETC.)

FULL ACCESS (Frameless)

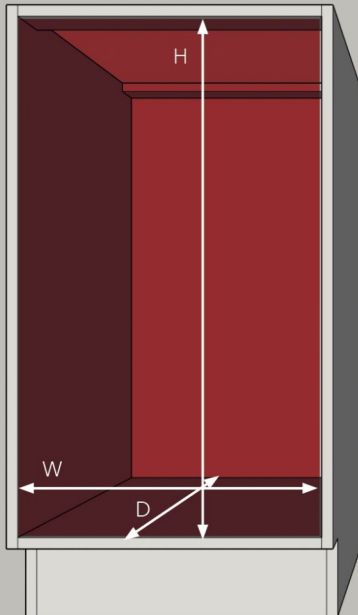

FACE FRAME

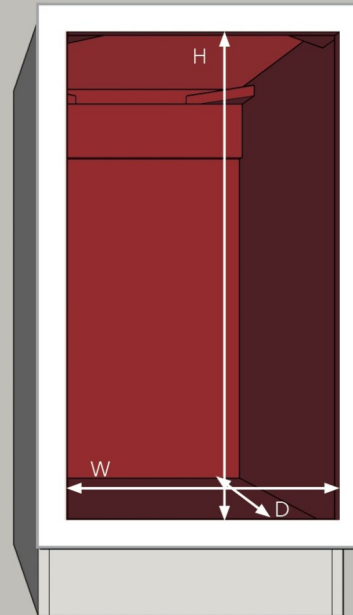

Types of
face frames:

1-1/2"
1-3/8"
1-3/4"
and Inset

Rev-A-Shelf manufactures products that install into nearly all cabinet sizes. Make sure to correctly measure your cabinets to allow the best fit.