

L-SHAPED VANITY ORGANIZER FOR 24" VANITY SINK BASE CABINET

TOOLS REQUIRED:

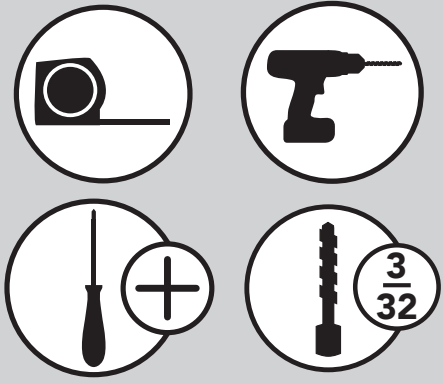

ESTIMATED ASSEMBLY TIME:

30 MIN

CARE AND MAINTENANCE:

Clean with a damp cloth and wipe parts dry.

PARTS LIST

- L-Shaped Vanity Organizer
- Blum Release Triggers
- (2) Slide Locking Devices
- (4) #8 x 3/4" Pan Head Screws
- (4) #6 x 1/2" Pan Head Screws
- (6) Plastic Trays
- (2) Wood Plug Covers

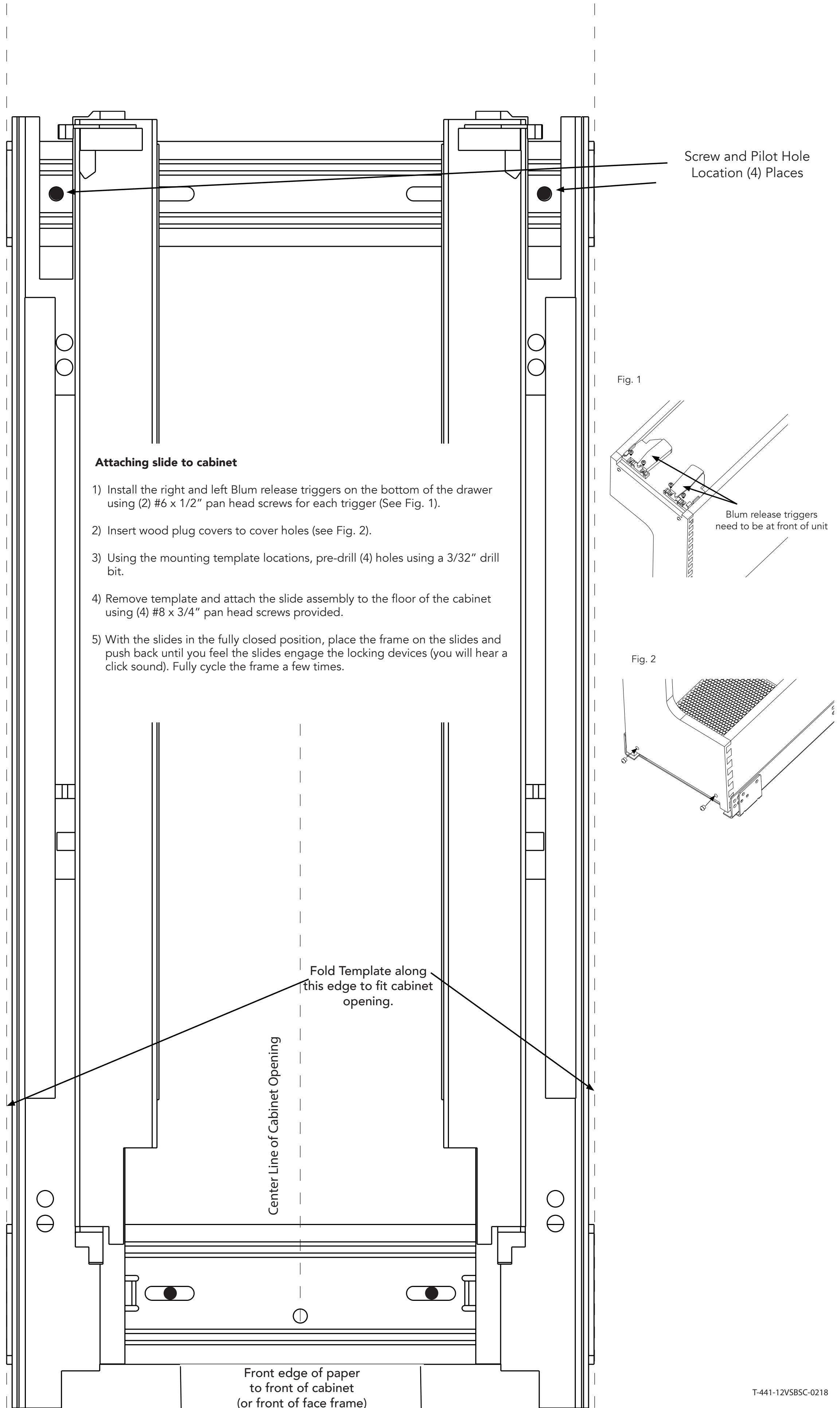

Attaching slide to cabinet

- 1) Install the right and left Blum release triggers on the bottom of the drawer using (2) #6 x 1/2" pan head screws for each trigger (See Fig. 1).
- 2) Insert wood plug covers to cover holes (see Fig. 2).
- 3) Using the mounting template locations, pre-drill (4) holes using a 3/32" drill bit.
- 4) Remove template and attach the slide assembly to the floor of the cabinet using (4) #8 x 3/4" pan head screws provided.
- 5) With the slides in the fully closed position, place the frame on the slides and push back until you feel the slides engage the locking devices (you will hear a click sound). Fully cycle the frame a few times.

ORGANIZADOR DE TOCADOR EN FORMA L PARA BASE DE GABINETE DEL TOCADOR DEL LAVABO

ORGANISEUR DE VANITÉ EN L POUR ARMOIRE DU BAS DE 24 PO

HERRAMIENTAS REQUERIDAS: OUTILS REQUIS:

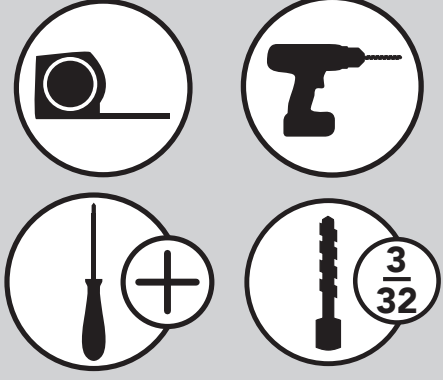

TIEMPO ESTIMADO
DE ENSAMBLE:
TEMPS ESTIMÉ
DE L'ASSEMBLAGE:

30 MIN

CUIDADO Y MANTENIMIENTO: ENTRETIEN:

Limpie con un paño húmedo y seque las partes.
Nettoyez avec un chiffon humide et essuyez les pièces.

LISTA DE PARTES LISTE DES PIÈCES

- Organizador de Tocador en Forma L
- Organiseur de vanité en L
- Gatillos de Liberación tipo Blum
- Gâchettes de déclenchement Blum
- 2 deslizantes de seguridad de aparatos
- 2 Dispositifs de Verrouillage de Coulisse
- 4 tornillos de cabeza de sartén del #8 x 3/4"
- 4 Vis à Tête Cylindrique #8 x 3/4 po
- 4 tornillos de cabeza de sartén del #6 x 1/2"
- 4 Vis à Tête Cylindrique #6 x 1/2 po
- 6 bandejas de plástico
- 6 Tablettes en Plastique
- 2 cubiertas de madera para clavija
- 2 Cache-Trous en Bois

