

**Tools Required**

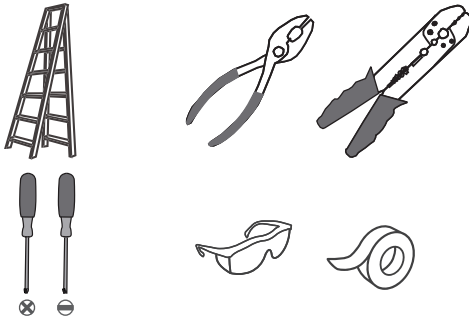

**Light Source**

40W  
MAX



**BULB SHAPE  
TYPE G9 XENON**

**9 BULBS REQUIRED  
BULBS NOT INCLUDED**

**Warnings and Cautions**

Turn off the electricity at the circuit breaker before installation. Consult a licensed electrician if in doubt about installation.

Turn off power to the fixture and allow the bulbs to cool before replacing.

Do not touch the bulb with bare hands use a cloth or glove.

**Package Contents**

**Preparation:** Identify and inspect all parts before beginning the installation.

Missing or damaged parts? Contact your original place of purchase.

**PARTS BAG**

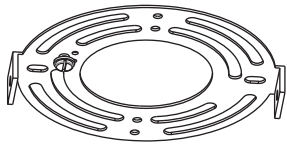

**A** Crossbar  
x 1

**B** Lock Screw  
x 2

**C** Outlet Box Screw  
x 2

**D** Wire Connector  
x 3

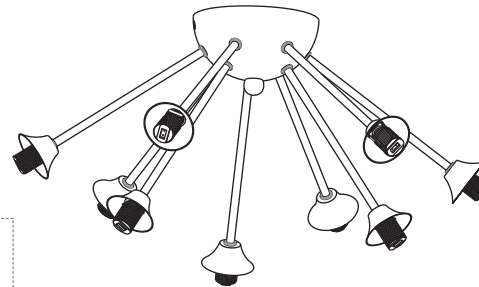

**E** Fixture Body  
x 1



**F** Bulb  
x 9

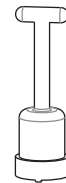

**G** Socket  
Collar Tool  
x 1



**H** Socket Collar  
x 9

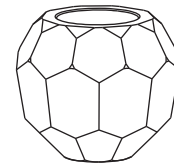

**I** Shade  
x 9

**Table of Contents**

**Crossbar**

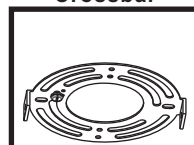

**STEP 1**

**Wiring**

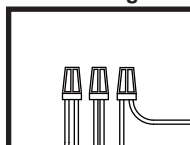

**STEP 2**

**Fixture Body**

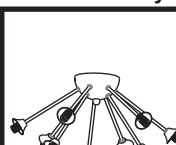

**STEP 3**

**Shade&Bulb**



**STEP 4**

### STEP 1

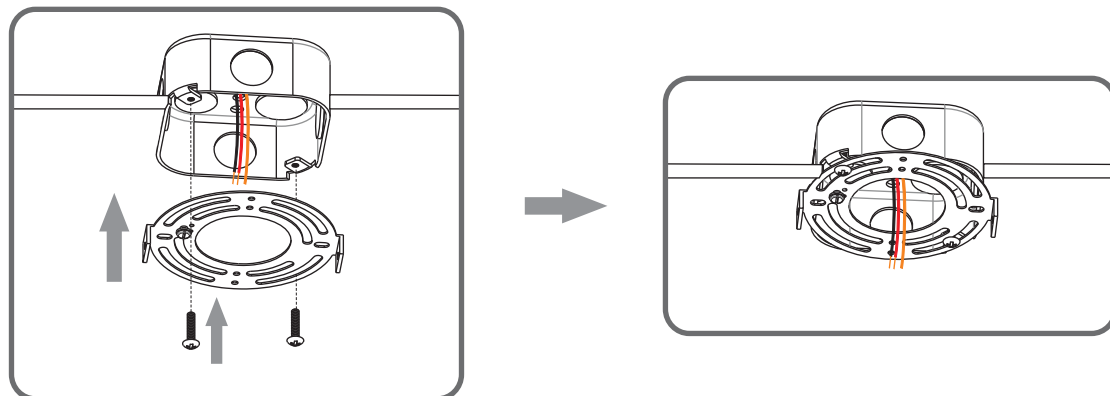

### STEP 2

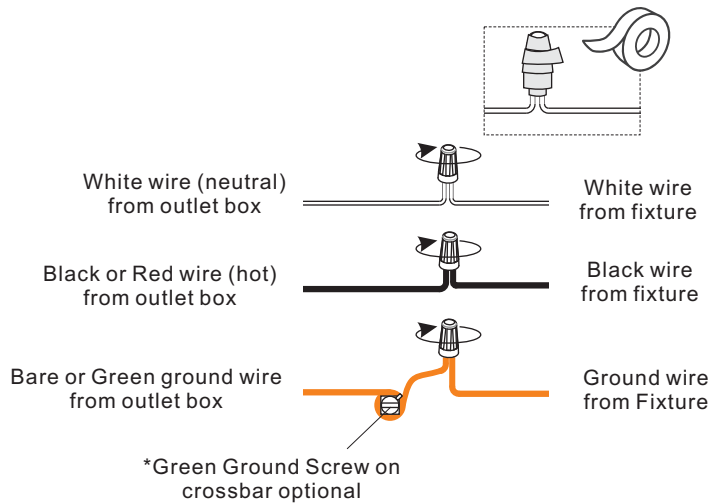

### STEP 3

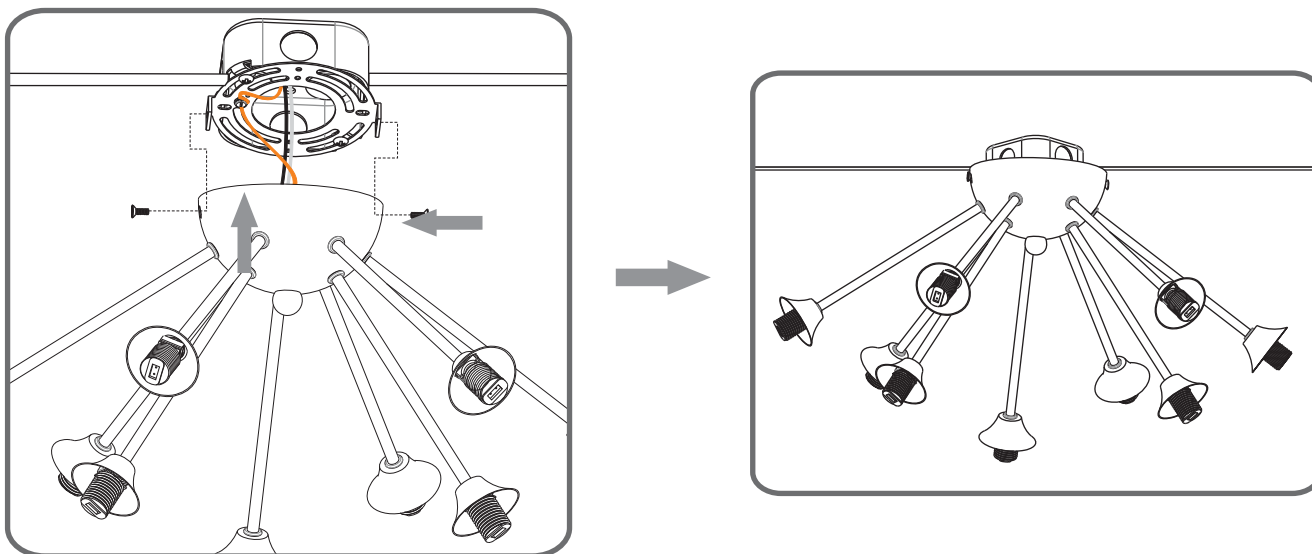

**STEP 4**

**1**

**Install Shade**

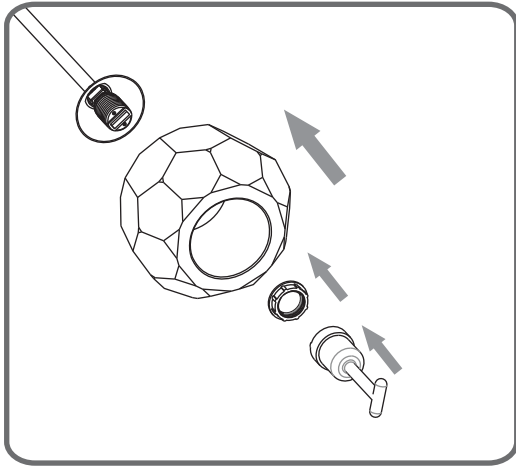

**2**

**Install Bulb**

