

**Tools Required**

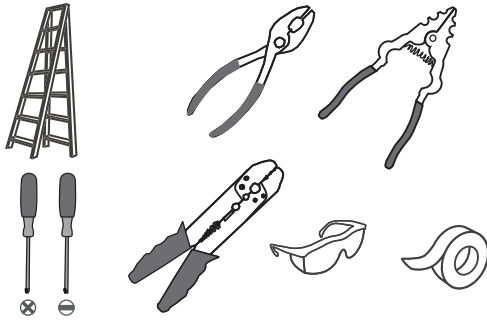

**Light Source**

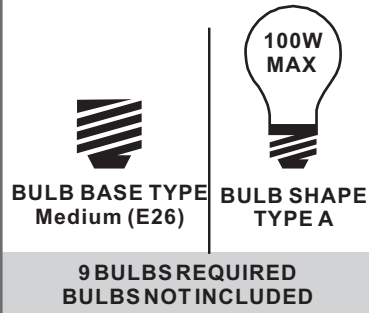

Option 1 (socket up): Fixture Height Adjustable 32" to 129.5"

**Warnings and Cautions**

Turn off the electricity at the circuit breaker before installation. Consult a licensed electrician if in doubt about installation.

Turn off power to the fixture and allow the bulbs to cool before replacing.

**Package Contents**

**Preparation:** Identify and inspect all parts before beginning the installation.

Missing or damaged parts? Contact your original place of purchase.

**PARTS BAG**

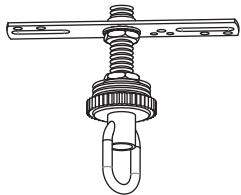

**A** Crossbar Assembly x 1



**B** Outlet Box Screw x 2



**C** Wire Connector x 3

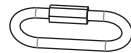

**D** Quick Link x 2

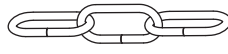

**E** Fixture Chain x 1

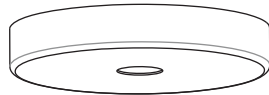

**F** Ceiling Canopy x 1



**G** Fixture Loop x 1



**H** Rod x 2



**I** Center Column x 1



**J** Socket Collar x 9



**K** Shade x 9

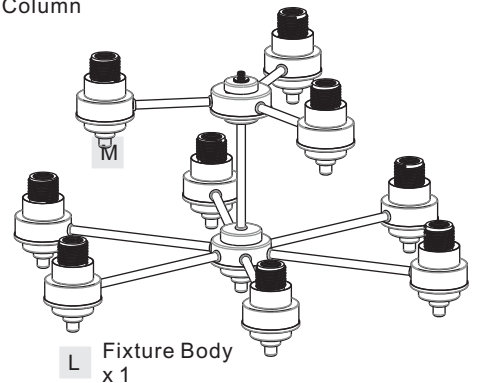

**L** Fixture Body x 1

**Table of Contents**

**Fixture Loop, Rods & Center Column**

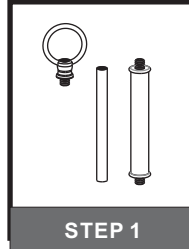

STEP 1

**Crossbar Assembly**

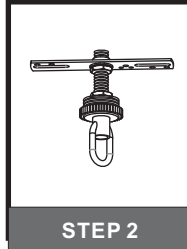

STEP 2

**Fixture Chain**

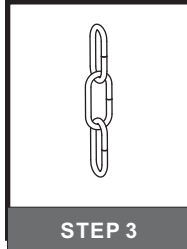

STEP 3

**Wiring**

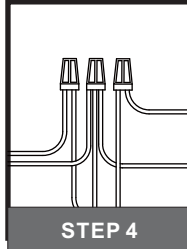

STEP 4

**Ceiling Canopy**

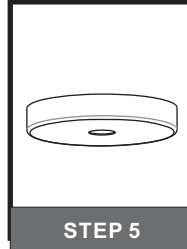

STEP 5

**Shade & Bulb**

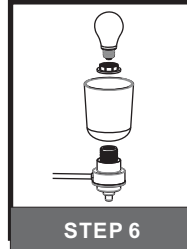

STEP 6

# STEP 1

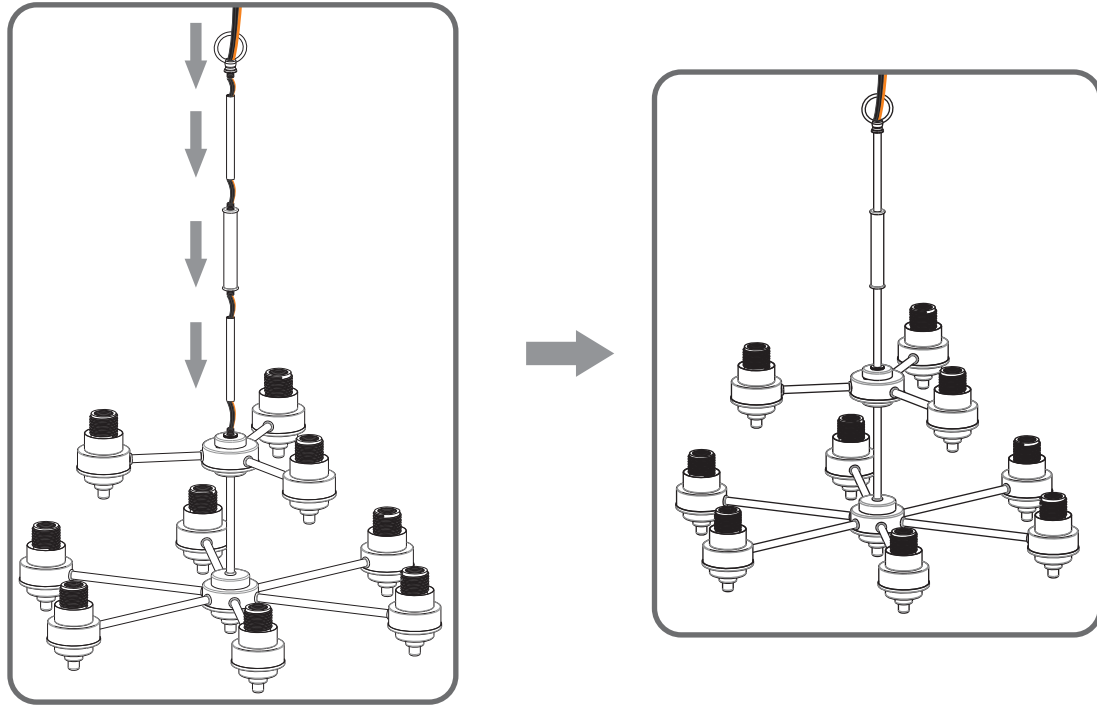

# STEP 2

- 1 ----- 2 ----- 3

**Step 1**  
Install crossbar assembly

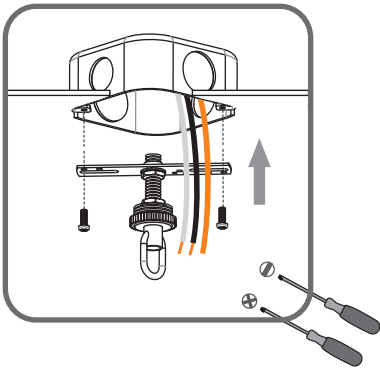

**Step 2 - 3**  
Test fitting ceiling canopy to nipple

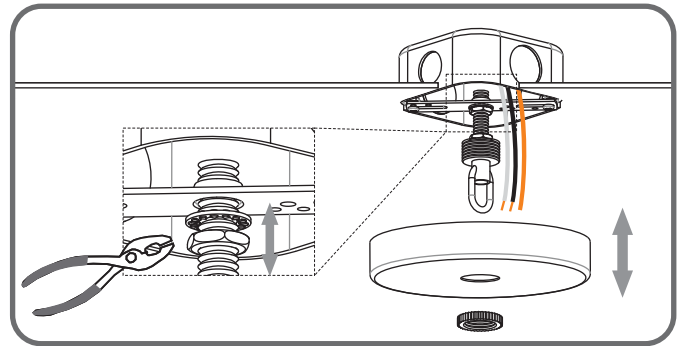
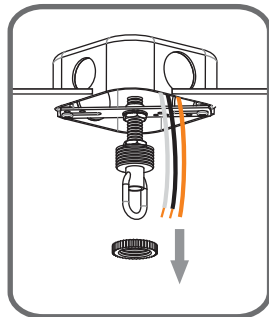

### STEP 3

1

Step 1  
Adjust fixture chain length

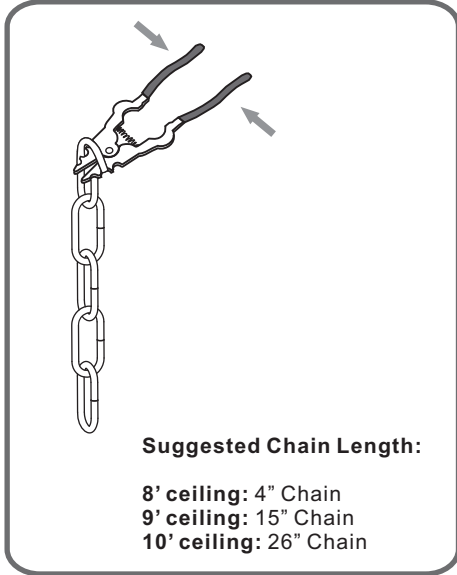

2

Step 2 - 3  
Install Fixture Chain

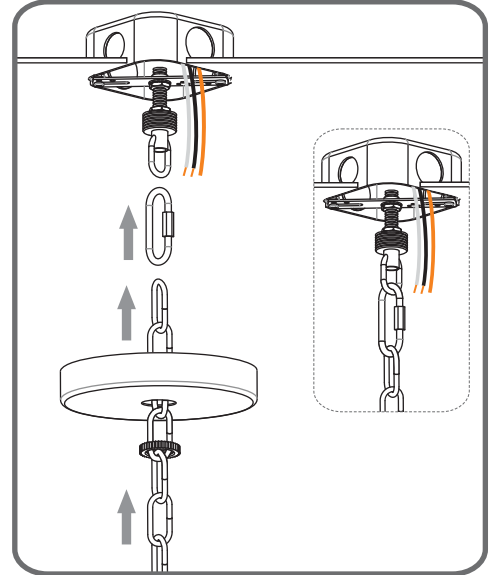
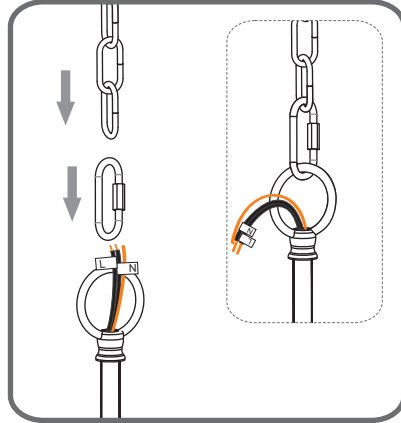

### STEP 4

1

Step 1  
Feed the fixture wires through the loop

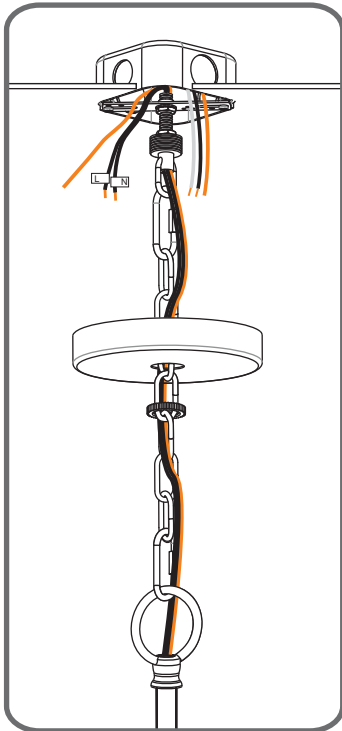

2

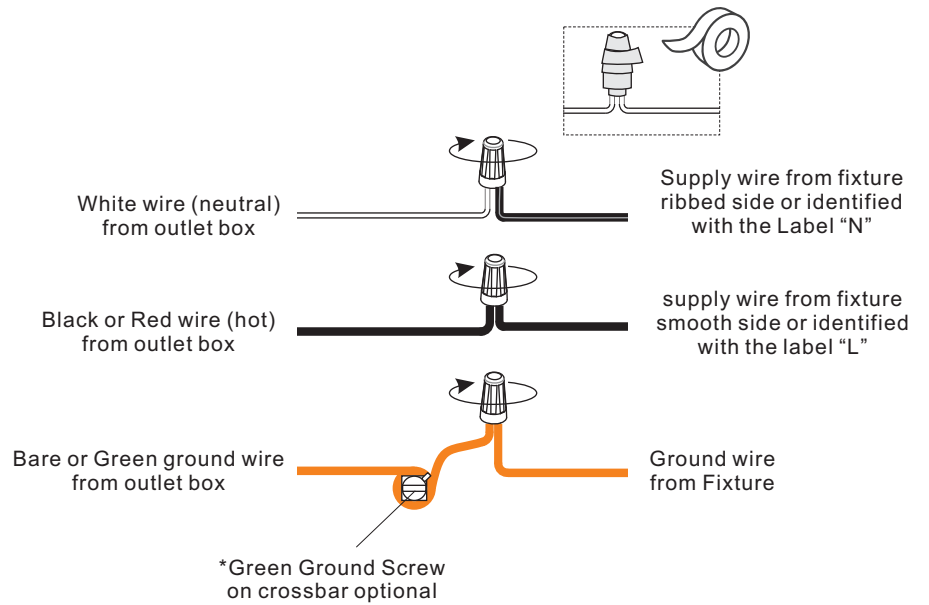

**STEP 5**

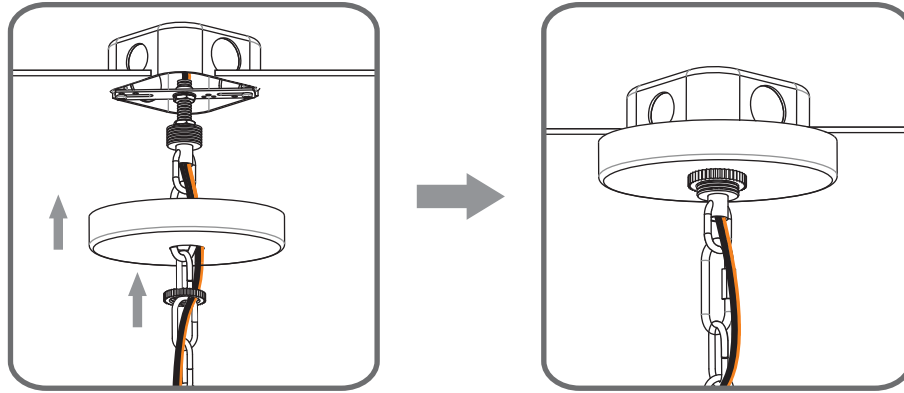

**STEP 6**

