

Please go to www.quoizel.com for product cleaning tips. Go to the **Care + Maintenance** selection.

Tools Required: Flathead screwdriver, Phillips screwdriver, pliers, wire cutters, wire strippers, electrical tape, safety glasses.

Light Source: Integrated LED 11W

Estimated Assembly Time: 20-30 minutes

Preparation: Identify and inspect all parts before beginning installation. Check package content list and diagrams below to be sure all parts are present. If any parts are missing or damaged, do not attempt to assemble, install, or operate the fixture. Contact customer service for replacement parts.

⚠ Warnings and Cautions

Turn off electricity at circuit breaker or main fuse box before installation. Consult a licensed electrician if in doubt.

These instructions are provided for your safety. It is very important you read them completely before installing the fixture. We strongly recommend that a licensed, professional electrician perform the installation.

Package Contents



A Crossbar
x 1



B Mounting Screw
x 2



C Ceiling Canopy
x 1

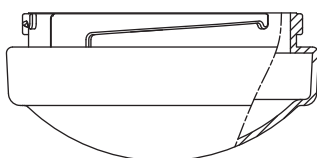

D Glass Shade
x 1

STEP 1 – Install Crossbar

A. Attach the Crossbar (A) to the outlet box and align the slot holes on the Crossbar (A) to mounting holes on the outlet box. Secure them together with outlet box screws (not supplied) and hand tighten until snug with screwdrivers.

Figure 1

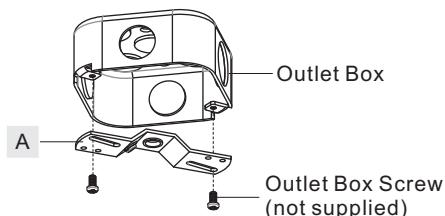

STEP 2 – Install Mounting Screws

A. Align Mounting Screws (B) to keyholes on the Ceiling Canopy (C) and mounting holes on the Crossbar (A). Thread Mounting Screws (B) into the mounting holes on the Crossbar (A).

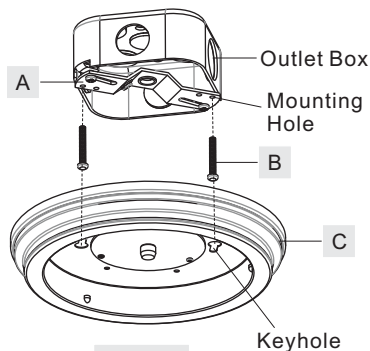

Figure 2

STEP 3 – Make Wire Connections

A. Wrap bare or green ground wire around green ground screw on the crossbar, no less than 2 inches from the end of the wire. Tighten the green ground screw.
B. Use standard wire connectors (not included) to make all wire connections. Twist connectors until wires are tightly joined together. Wrap each connection with approved electrical tape and carefully stuff all the connected wires into the Outlet Box.

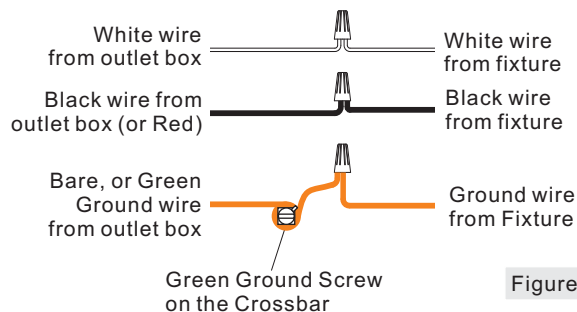

Figure 3

STEP 4 – Install Ceiling Canopy

A. Fit the heads of Mounting Screws (B) into keyholes on the Ceiling Canopy (C). Rotate the Ceiling Canopy (C) until heads of Mounting Screws (B) seat on the small ends of keyholes. Carefully release your hands and tight Mounting Screws (B) until snug.

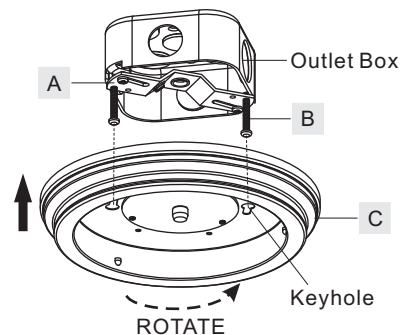

Figure 4

STEP 5 – Install Glass Shade

A. Attach the Glass Shade (D) onto the Ceiling Canopy (C) and rotate the Glass Shade (D) until it is seated on the embosses in the Ceiling Canopy (C) properly.

Your fixture is now assembled and ready to use. Enjoy!

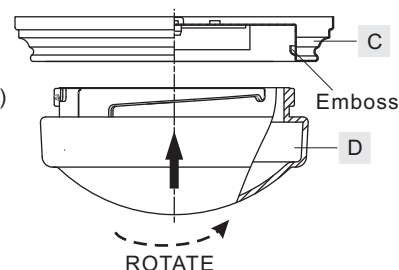

Figure 4

Thank you for purchasing a Quoizel product.
Need assistance with parts or assembly? Call Quoizel customer service at 1-800-645-3184
or visit us on-line at www.quoizel.com

QF3416BN

FINISH: BRUSHED NICKEL

NOTE: ALL DIMENSIONS ARE ROUNDED UP TO THE NEAREST 1/4"

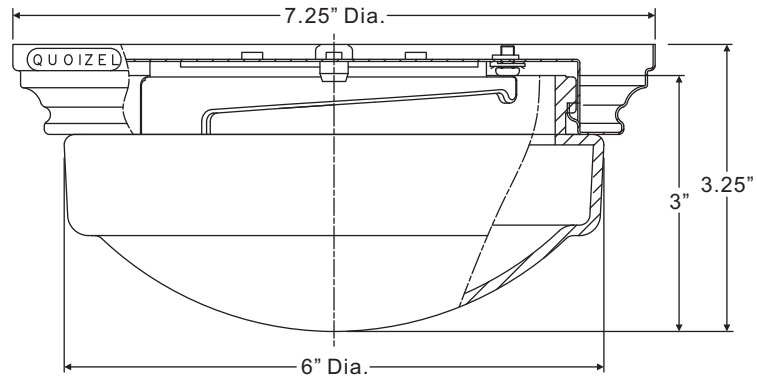

Thank you for purchasing a Quozel product.
Need assistance with parts or assembly? Call Quozel customer service at 1-800-645-3184
or visit us on-line at www.quozel.com