

PECLB SERIES

Central Lighting Micro Inverter

Specifications:

Description:

Designed for indoor installation in commercial or industrial applications, the PECLB Series micro inverter system provides Emergency AC power to lighting fixtures equipped with incandescent, fluorescent, CFL or LED lamps between 32 and 55 watts for 90 minutes. The lighting load can be installed at a distance of up to 1000 feet from the micro inverter. The enclosure is constructed of heavy-duty, 20 gauge steel with a white powder-coat finish.

Features:

- Dual input voltage 120/277 VAC, 60 Hz
- Overload and Short Circuit Protection
- Manual "TEST" button
- LED indicators for "AC-ON", "Charging-ON" and "Inverter-ON"
- Sealed lead calcium batter with a 10 year rated life

Operation:

When normal utility supplied power is interrupted, the PECLB Series micro inverter unit will automatically transfer to emergency mode in less than 1 second and begin supplying AC power to the load for 90 minutes. The unit is capable of operating normally on, normally off, or switched loads. A low voltage battery disconnect circuit will prevent "deep discharge" damage to the battery. AC lockout prevents battery discharge prior to initial unit power-up. The charging circuit will bring the batteries to full recharge within UL time standards. A "brown-out" circuit will automatically transfer the unit to emergency power if the utility voltage falls to a predetermined "low line" limit.

	PECLB-32	PECLB-55
Power Rating	32 VA/W	55 VA/W
Power Factor	0.44	
Temperature Range	20°C -30°C (68°F - 86°F)	
Weight	14 LB	18 LB
Max Input Current	120 VAC: 0.34A 277 VAC: 0.15A	120 VAC: 0.54A 277 VAC: 0.23A
System Voltage	12 VDC	
Recharge Time	96 Hours	

Warranty:

- Unit and Electronics (not including fuses): 3 years full
- Battery: 2 years full, 8 years pro-rata

Catalog number:

Base	Capacity	Finish	Mounting
PECLB	32 - 32 VA/W 55 - 55 VA/W	30 - White	S -Surface Wall T -Recessed Ceiling T-Grid

Images:



Surface Mount Model



Recessed Ceiling Model

Dimensions:

Surface Mount Housing

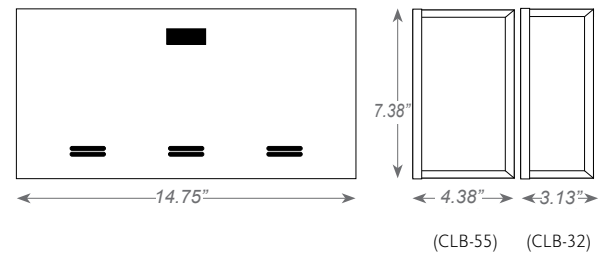

Ceiling T-grid Mount Housing

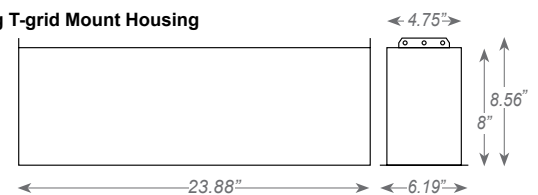

Compliances:

- UL924
- NFPA 101 and NFPA 70
- OSHA, State and Local Code compliant