

PCOSL SERIES

LED Dusk-to-Dawn

Specifications:

Features:

- Rugged die-cast aluminum housing with both 2-3/8" & 1-5/8" mast arm mount capability or as direct wall/surface mounting
- Textured gray powder paint provides corrosion resistance
- 56 mid power LEDs deliver 2906 lumens, 4000K and 80 CRI
- Symmetric LED lens installed standard
- Single 120V 50/60 Hz, driver with integral surge protection
- 120V twist-lock style photocontrol included
- Prismatic acrylic refractor included for security applications and glare content
- Provides zero uplight designed for environmentally friendly installations

Application:

The PCOSL Series is a multi-purpose dusk-to-dawn LED luminaire that provides general purpose area, security, roadway, self storage and landscape lighting. For operation in -35°C to 40°C ambient temperatures.

Compliances:

UL 1598 listed for use in wet locations
 Driver IP66 and RoHS compliant
 EPA = 0.5 Ft²

Warranty:

5 year warranty (Terms and Conditions Apply)

Images:



Dimensions:

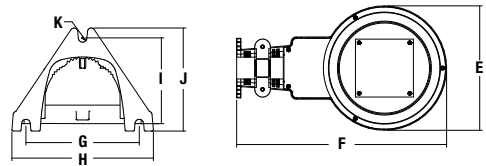
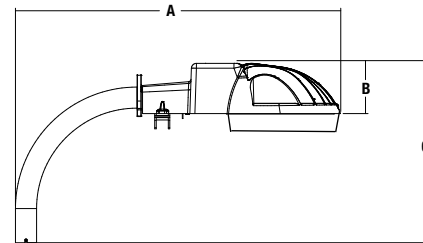

A	B	C	D	E	F
29.72"	4"	8.25"	16.19"	9.45"	16"
754 mm	152 mm	209 mm	411 mm	240 mm	406 mm
G	H	I	J	K	
3.62"	4.52"	2.74"	3.29"	.138"	
92 mm	115 mm	69 mm	84 mm	3.5 mm	

Catalog number:

Base	Lamp	Finish	Accessories (sold separately)
PCOSL	30 LED-LED, 30 Watts 2906 Lumens	82 - Metallic Gray	PCOSL-ARM - Alum godeg Arm

PCOSL SERIES

LED Dusk-to-Dawn

Photometric Data:

- Drive Current: 150 mA
- System Watts: 30 Watts
- Input Voltage: 120V
- Number of LEDs: 56
- Number of Drivers: 1

Ambient Temperature		Lumen Multiplier	
0°C	32°F	1.02	1.02
10°C	50°F	1.01	1.01
20°C	68°F	1.00	1.00
25°C	77°F	1.00	1.00
30°C	86°F	1.00	1.00
40°C	104°F	0.99	0.99
50°C	122°F	0.98	0.98

Performance Data	
Distribution Type	Symmetric
CCT	4000K
Lumens	2906
LPW	97
B	1
U	0
G	0

Operating Hours (All Models)						
Ambient Temperature	0	25,000	50,000	60,000	100,000	Calculated L70 (Hours)
40°C/104°F	0.99	0.94	0.91	0.89	0.84	>216,000