

Central Brass Company, Inc.
3325 S. Garfield Ave.
Commerce, CA 90040
(800) 321-8630
www.centralbrass.com

Tools:



Adjustable Wrench Power Drill Plumbers Putty Teflon Tape Rags



Model Number: 0366-N2 Series

Warnings and Notes:

Check with local plumbing code requirements before installation.

This product should be installed by a local listed plumber.

Do not use plumbers putty on threads.

Installation Steps:

Drinking Fountain-Wallmount

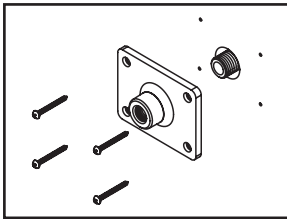

(1) The 3/8" pipe thread nipple must be kept with a length of 1/2" from finished wall. Apply Teflon tape at the thread end of pipe nipple stretch out from finished wall. Thread wall bracket to 3/8" pipe nipple and secure the wall bracket with supplied four screws.

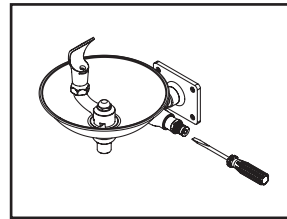

(4) With the help of flat head screwdriver, loosen the screw to decrease the timing and tighten the screw to increase the timing. The timing can be adjusted from 0 to 60 seconds depending on the inlet pressure and water temperature.

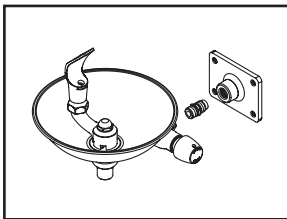

(2) Apply Teflon tape on both thread ends of brass nipple, thread and tighten brass nipple to wall bracket. Thread and tighten drinking fountain to brass nipple. Ensure the drinking fountain is in level position.

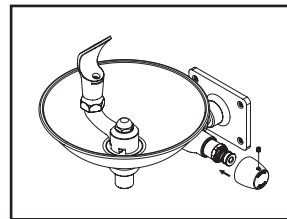

(5) Once the satisfactory timing has been adjusted, install the handle by tightening Allen screw.

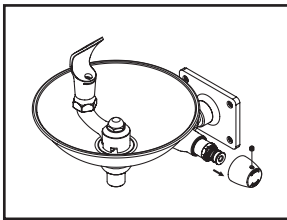

(3) The slow close cartridge is factory preset timing to 10 seconds@60 PSI. Depending on the inlet water pressure and water temperature this timing can vary. If timing need to be changed, remove the handle by loosening Allen screw.