



INSTALLATION

PIONEER INDUSTRIES, INC.
 3325 S. Garfield Ave.
 Commerce, CA 90040
 (800) 338-9468
 www.pioneerind.com

Tools:



Adjustable Wrench



Plumbers Putty



Teflon Tape



Rags

Model Number: 4MO611

Warnings and Notes:

Check with local plumbing code requirements before installation.
 This product should be installed by a local listed plumber.
Do not use plumbers putty on threads.



Installation Steps:

Two Handle Roman Tub Set With Handheld Showerhead

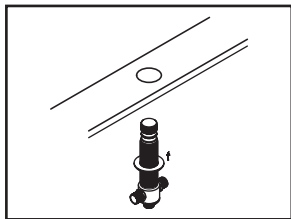

(1) Determine hole location :- This valve is designed for 8" to 16" center widespread installation. So decide the location of the mounting hole within that range.
 Note:- This product is for finished deck-mount or finished rim-mount installations only.

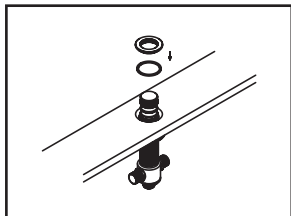

(2) Slide the diverter valve through the mounting hole from underneath of the mounting surface. Thread the top locknut as far as it threads from the top.

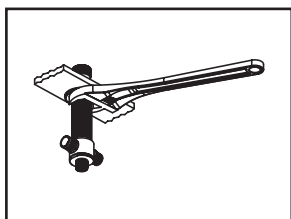

(3) Tighten the bottom locknut from the bottom.

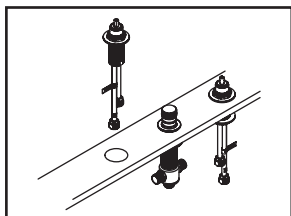

(4) Slide rubber & steel washer on the hot side valve from the top. Thread locknut from the top. Place the valve on the mounting hole.

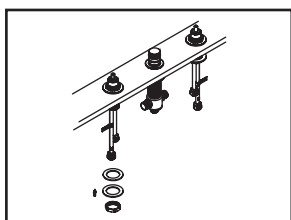

(5) Ensure the distance between finished surface and top of the valve is 1-3/4". Slide rubber & steel washer and tighten locknut onto the valve with help of 1-7/16" socket or adjustable wrench from underneath. Install cold side valve as the same way.

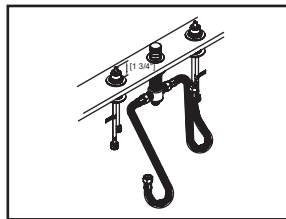

(6) Carefully install the flex hose to the valve outlet tube. Connect the other end of flex hose to the inlet of diverter valve. Do not over tighten the flex hose with adjustable wrench as it might damage the valve outlet tube. Connect valve inlet tube to water supply.

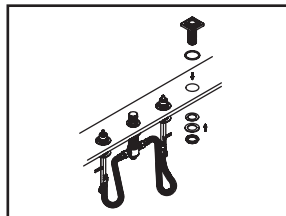

(7) Slide the hose holder with rubber washer through the hole. Slide the rubber & steel washer from the bottom. Thread locknut from the bottom to secure hose holder.

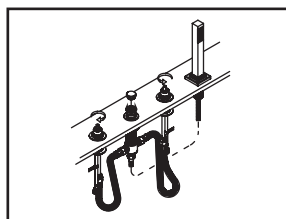

(8) Attach handheld showerhead to handheld shower hose, insert handheld shower hose down through hose holder and connect to diverter valve. Turn on water supplies to check for any leak.

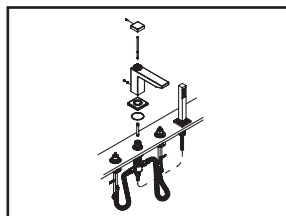

(9) Remove test plug from diverter valve. Place spout escutcheon with washer on diverter valve. Carefully slide spout on diverter valve so the O-ring on diverter valve does not get damaged. Thread diverter pull rod to diverter valve. Attach pull rod flange to diverter pull rod.

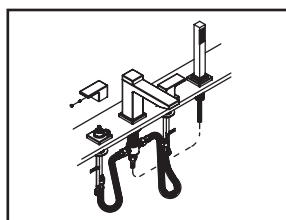

(10) Place valve escutcheon on both valve. Thread sleeve on valve to secure valve escutcheon. Ensure handles move in correct direction.; tighten Allen screw with help of Allen Wrench tool provided to install both side handles. Turn on both side handles and check diverter valve works properly.

Note:-After using Handheld Showerhead ensure to drain all water before placing on the holder.

