



# ENGINEERING EXCELLENCE

**Brentwood Series #3BR310**

**PARTS BREAKDOWN SHEET**

### DESCRIPTION

- Two Handle Lavatory Faucet
- Porcelain Lever Handles
- Gooseneck Spout Swivel 360°
- 4-7/8" Reach, 4-9/16" from Deck to Aerator
- Ceramic Disc Cartridges
- 3-Hole 4" Installation
- Brass Pop-Up Drain Assembly

### FINISHES

- PC Polished Chrome
- BN PVD Brushed Nickel
- ORB Oil Rubbed Bronze

### FLOW

- Aerator Limited to 1.5 GPM



#3BR310 SHOWN \* ADA 

### STANDARDS APPLICABLE

- ASME A112.18.1
- ANSI A117.1
- ANSI / NSF 61, SECTION 9
- CUPC / IAPMO LISTED / ADA COMPLIANT / Cal Green Compliant
- CONTAINS NO MORE THAN 0.25% WEIGHTED AVERAGE LEAD CONTENT



Model #: \_\_\_\_\_

Specific Features: \_\_\_\_\_

Project Name: \_\_\_\_\_

Submitted For: \_\_\_\_\_

Model	Description	Finishes	
#3BR310	Two Handle Lavatory Faucet	<input type="checkbox"/> PC	<input type="checkbox"/> Other _____



ENGINEERING EXCELLENCE

Pioneer: 1-800-338-9468  
 Commerce, CA 90040  
 www.pioneerind.com  
 Pioneer Industries, Inc. © 2016

	ITEM#	DESCRIPTION
A	X-1900010C,H*	Porcelain Lever Handle-Cold,Hot
B	X-4900037	Bonnet Nut
C	X-4900038	Gasket
D	X-390002C,H	Ceramic Disc Cartridge-Cold,Hot
E	X-4900095*	1.5 GPM Aerator
F	X-4300018	Base Gasket
G	X-4900008	Mounting Kit
H	X-4900004	Supply Nut
I	X-6300007*	Brass Pop-Up Drain Assembly
1	X-4900042C,H*	Button-Cold,Hot
2	X-4900061	Brentwood Handle Screw

\* Note- Please Specify finish\color code while ordering.

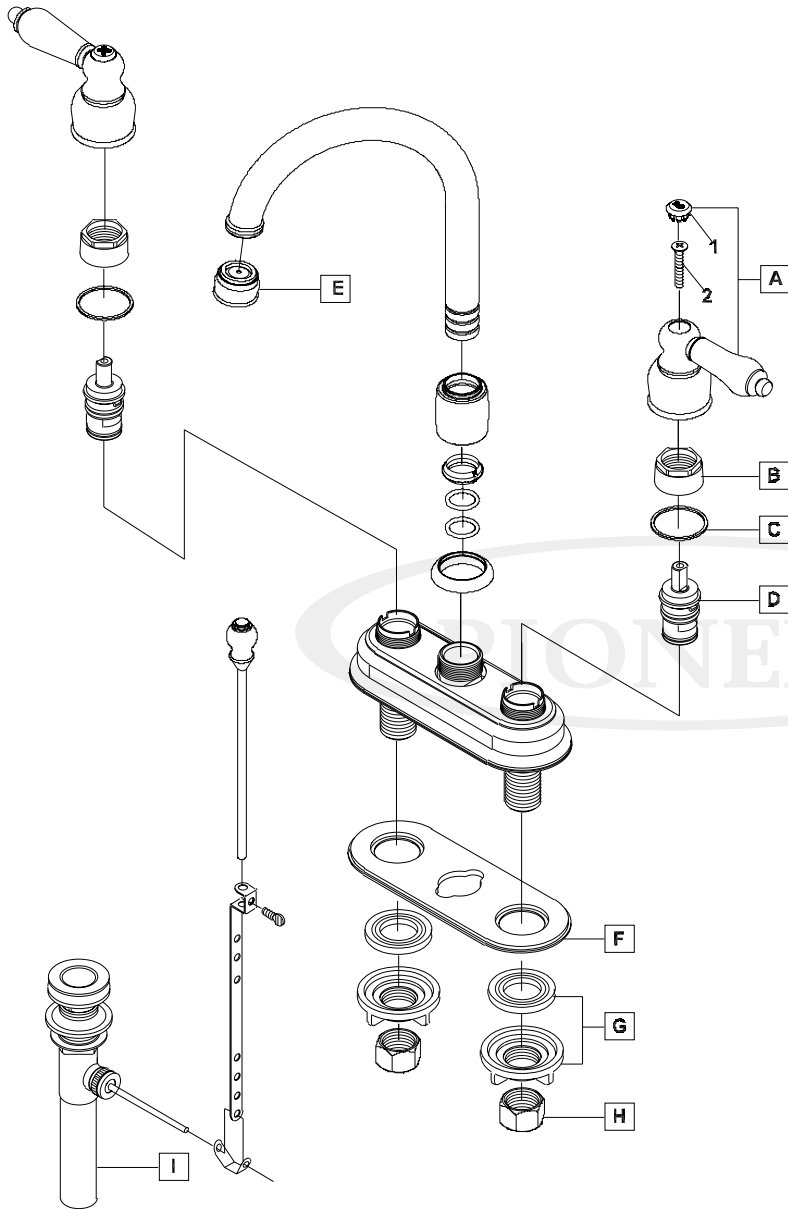

Product Diagram



ENGINEERING EXCELLENCE

Pioneer:1-800-338-9468  
 Commerce, CA 90040  
 www.pioneerind.com  
 Pioneer Industries, Inc. © 2016