



ENGINEERING EXCELLENCE

Motegi Series #2MT171H

PARTS BREAKDOWN SHEET

DESCRIPTION

- Single Handle Kitchen Faucet
- Metal Lever Handles
- Gooseneck Spout Swivel 360°
- 7-5/8" Reach, 8-1/2" from Deck to Aerator
- Ceramic Disc Cartridge with Temperature Limit Stop
- 2-Hole Installation
- Side Spray Assembly
- Easy-Install 30" Flex Supply Lines With 3/8" Connections

FINISHES

- PC Polished Chrome
- BN PVD Brushed Nickel
- SS PVD Stainless Steel



FLOW

- Aerator Limited to 1.5 GPM

#2MT171H SHOWN * ADA 

STANDARDS APPLICABLE

- ASME A112.18.1
- ANSI A117.1
- ANSI / NSF 61, SECTION 9
- CUPC / IAPMO LISTED / ADA COMPLIANT / Cal Green Compliant
- CONTAINS NO MORE THAN 0.25% WEIGHTED AVERAGE LEAD CONTENT

Model #: _____

Specific Features: _____

Project Name: _____

Submitted For: _____

Model	Description	Finishes	
#2MT171H	Single Handle Kitchen Faucet	<input type="checkbox"/> PC	<input type="checkbox"/> Other____



ENGINEERING EXCELLENCE

Pioneer: 1-800-338-9468
Commerce, CA 90040
www.pioneerind.com

Pioneer Industries, Inc. © 2016

DMPB2MT171H/REV. 08 2016

Page 1 of 2

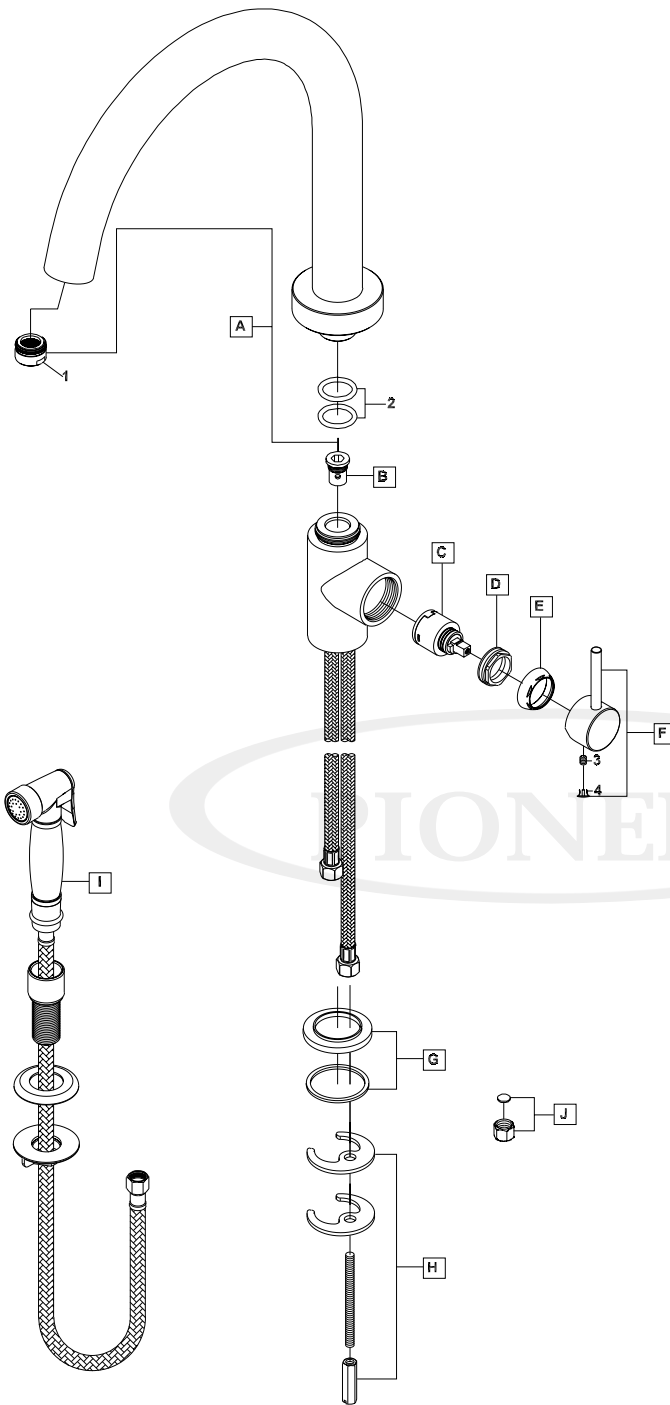

	ITEM#	DESCRIPTION
A	X-2200019*	Motegi Series Spout
B	X-4200016	Diverter Piston
C	X-3900003	Ceramic Disc Cartridge
D	X-4900018	Retainer Nut
E	X-4900017*	Retainer Sleeve
F	X-1900008*	Motegi Lever Handle
G	X-4300019*	Escutcheon
H	X-5900002	Mounting Kit
I	X-4200070*	Side Spray Assembly
1	X-4900089*	1.5 GPM Aerator
2	X-4900070	Spout O-Ring
3	X-4400024	Allen Screw
4	X-4900044*	Hole Cover

* Note: Please specify finish/color when ordering.

Product Diagram



ENGINEERING EXCELLENCE

Pioneer: 1-800-338-9468
 Commerce, CA 90040
 www.pioneerind.com
 Pioneer Industries, Inc. © 2016