



ENGINEERING EXCELLENCE

Legacy Series #2LG240

PARTS BREAKDOWN SHEET

DESCRIPTION

- Two Handle Kitchen Faucet
- ADA Wrist Blade Handles
- Hi-Arc Spout Swivel 360°
- 7-3/16" Reach, 11-3/16" From Deck to Aerator
- Ceramic Disc Cartridges
- 3-Hole 8" Installation

FINISHES

- PC Polished Chrome

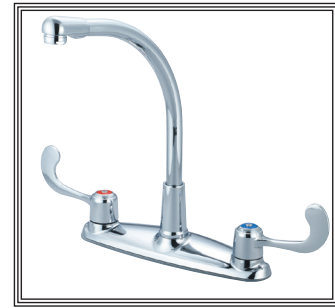

#2LG240 SHOWN * ADA 

STANDARDS APPLICABLE

- ASME A112.18.1
- ANSI A117.1
- CONTAINS NO MORE THAN 0.25% WEIGHTED AVERAGE LEAD CONTENT

FLOW

- Aerator Limited to 1.5 GPM

Model #: _____

Specific Features: _____

Project Name: _____

Submitted For: _____

Model	Description	Finishes	
#2LG240	Two Handle Kitchen Faucet	<input type="checkbox"/> PC	<input type="checkbox"/> Other____



ENGINEERING EXCELLENCE

Pioneer:1-800-338-9468
 Commerce, CA 90040
 www.pioneerind.com
 Pioneer Industries, Inc. © 2016

DMSP2LG240/REV. 08 2016
 Page 1 of 2

	ITEM#	DESCRIPTION
A	X-1900003C,H	ADA Wrist Blade Handle - Cold, Hot
B	X-4900007	Bonnet Nut
C	X-4200014	Deck Plate
D	X-3900002C	Ceramic Stem - Cold
E	X-3900002H	Ceramic Stem - Hot
F	X-4200006	Base Plate
G	X-4900008	Mounting Kit
H	X-4900004	Supply Nut
I	X-2200003	Legacy High-Arc Spout
1	X-4900010	Wrist Blade Handle Screw
2	X-4900011C,H	Wrist Blade Handle Index- Cold & Hot
3	X-4900081	1.5 GPM Aerator
4	X-4200017	Spout Sleeve
5	X-4900013	Spout Snap Ring
6	X-4900012	Spout O-Ring

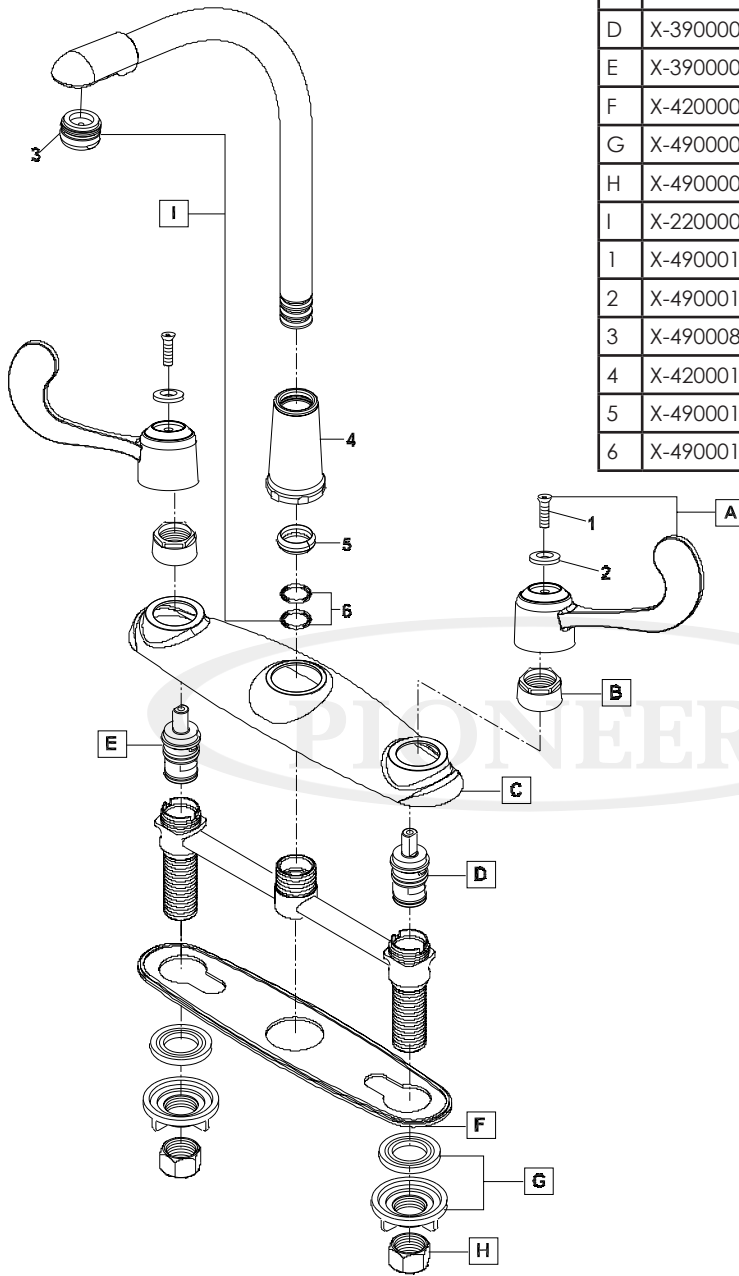

Product Diagram



ENGINEERING EXCELLENCE

Pioneer: 1-800-338-9468
 Commerce, CA 90040
 www.pioneerind.com
 Pioneer Industries, Inc. © 2016