



ENGINEERING EXCELLENCE

Americana Series #2AM501 PARTS BREAKDOWN SHEET

DESCRIPTION

- Two Handle Kitchen Bridge Faucet
- Metal Lever Handles
- Spout Swivel 360°
- 8-11/16" Reach, 9-7/16" from Deck to Aerator
- Ceramic Disc Cartridges
- 4-Hole 8" Installation
- Side Spray Assembly

FINISHES

- PC Polished Chrome
- BN PVD Brushed Nickel
- SS PVD Stainless Steel
- ORB Oil Rubbed Bronze
- MZ Moroccan Bronze

FLOW

- Aerator Limited to 1.5 GPM



#2AM501 SHOWN * ADA 

STANDARDS APPLICABLE

- ASME A112.18.1
- ANSI A117.1
- ANSI / NSF 61, SECTION 9
- CUPC / IAPMO LISTED / ADA COMPLIANT
- CONTAINS NO MORE THAN 0.25% WEIGHTED AVERAGE LEAD CONTENT

Model #: _____

Specific Features: _____

Project Name: _____

Submitted For: _____

Model	Description	Finishes
#2AM501	Two Handle Kitchen Bridge Faucet	<input type="checkbox"/> PC <input type="checkbox"/> Other _____



ENGINEERING EXCELLENCE

Pioneer: 1-800-338-9468
 Commerce, CA 90040
 www.pioneerind.com
 Pioneer Industries, Inc. © 2016

	ITEM#	DESCRIPTION
A	X-1200008C*	Lever Handle-Cold
B	X-1200008H*	Lever Handle-Hot
C	X-3200004C	Ceramic Cartridge-Cold
D	X-3200004H	Ceramic Cartridge-Hot
E	X-4200063*	Flange
F	X-4900008	Mounting Kit
G	X-4900004	Supply Nut
H	X-2200013*	Americana Spout
I	X-4200016	Diverter Piston
J	X-4200059*	Side Spray Assembly
K	X-4200049	Cap & Washer
1	X-4900042C*	Button-Cold
2	X-4900042H*	Button-Hot
3	X-4900035	Handle Screw
4	X-4900091*	1.5 GPM Aerator
5	X-4900012	Spout O-Rings

* Note- Please specify finish/color code while ordering.

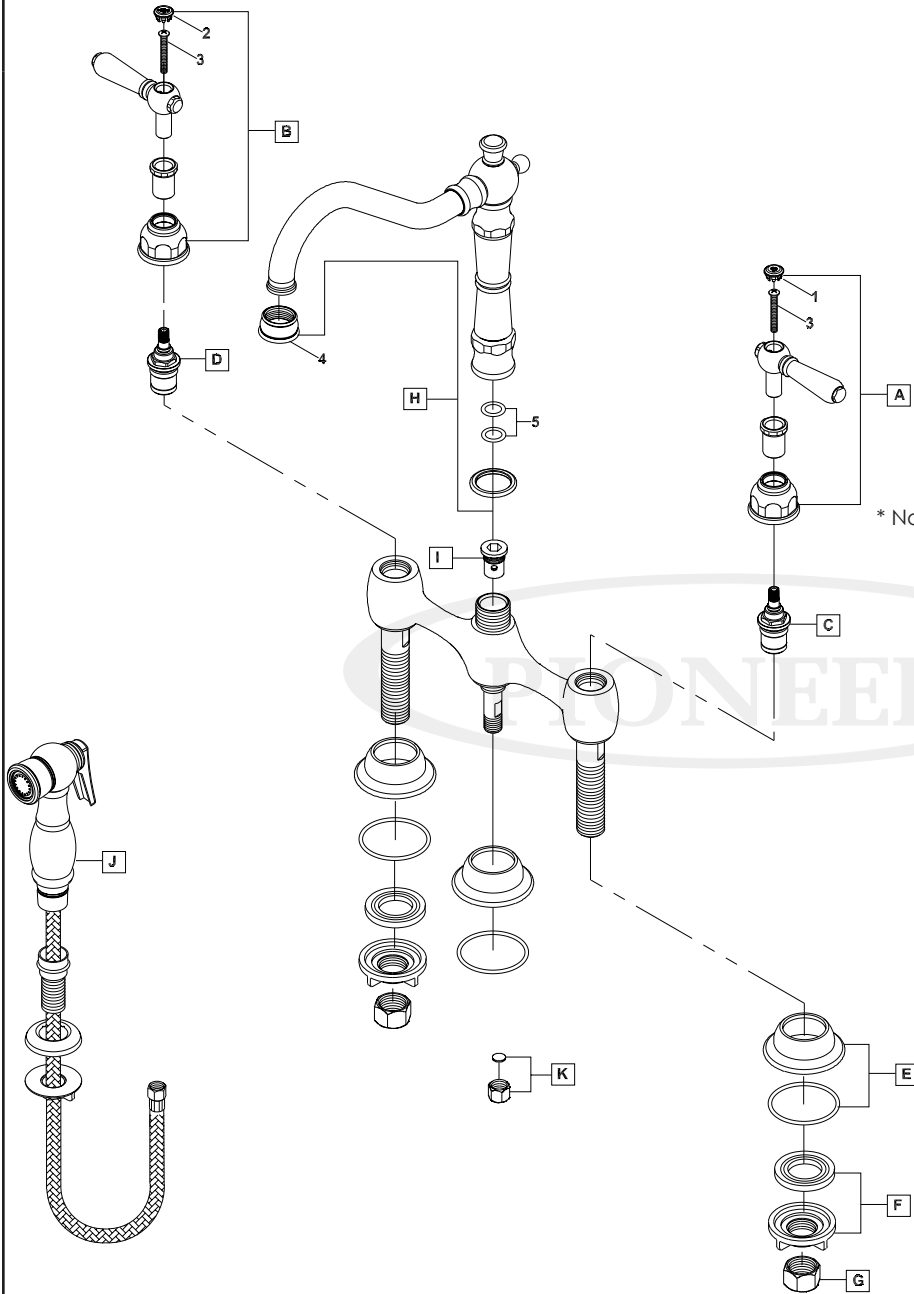

Product Diagram



ENGINEERING EXCELLENCE

Pioneer: 1-800-338-9468
 Commerce, CA 90040
 www.pioneerind.com
 Pioneer Industries, Inc. © 2016