

2

Mount Spout Holder

Una el soporte del grifo

Fixez le support robinet

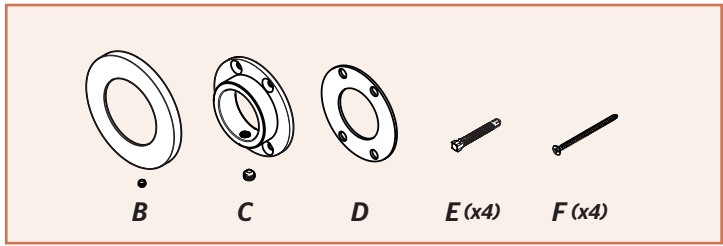
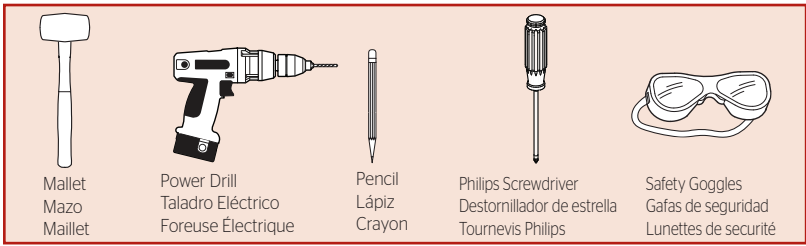

2A

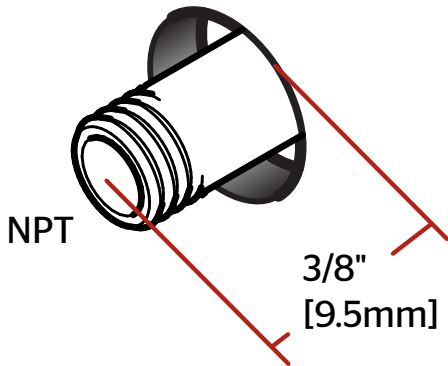

2B

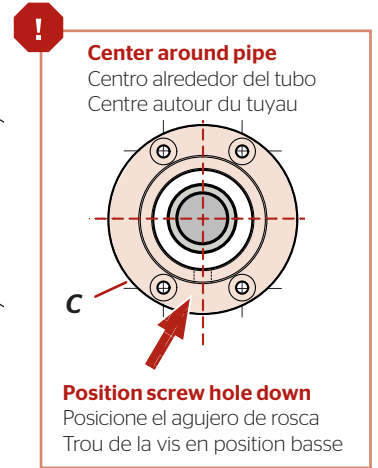
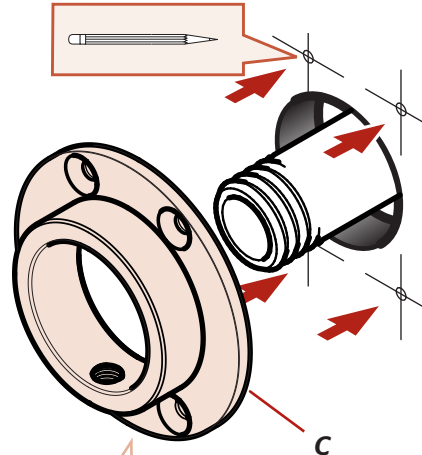

Use Holder (C) as hole template
Utilice el sostenedor para la plantilla del agujero
Employez le support pour le calibre de trou

2C

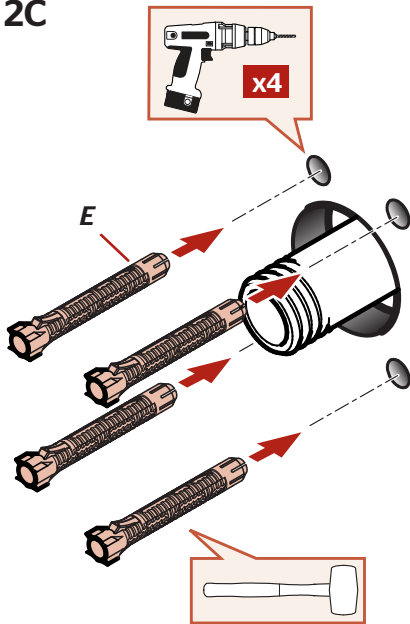

2D

Tip • Indicio • Conseil
Use tape to prevent gasket (D) from moving
Utilice cinta adhesiva para evitar que el sello (D) se mueva
Utilisez du ruban pour empêcher le joint (D) de bouger

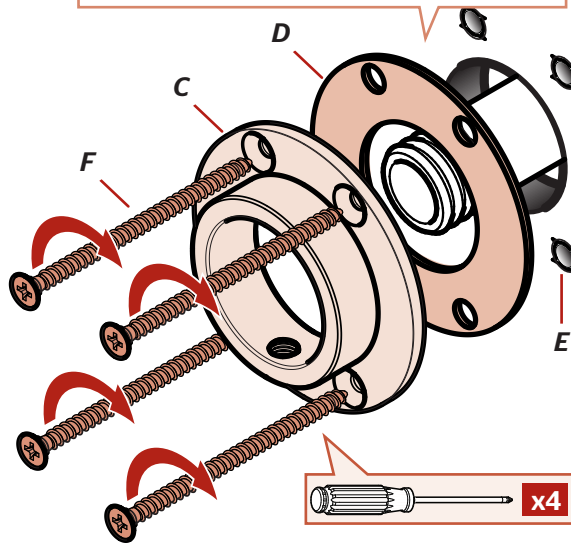

2E

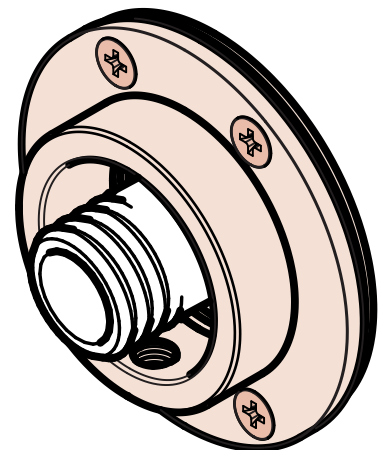

3

Attach Spout

Coloque el grifo

Fixez le robinet



PTFE plumber's tape
Cinta para plomería PTFE
Ruban PTFE de plombier

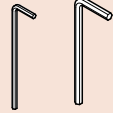

Hex Wrench
Llave hexagonal
Clé hexagonale

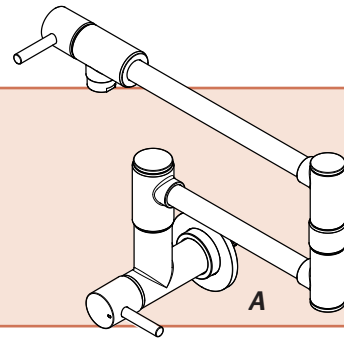

3A

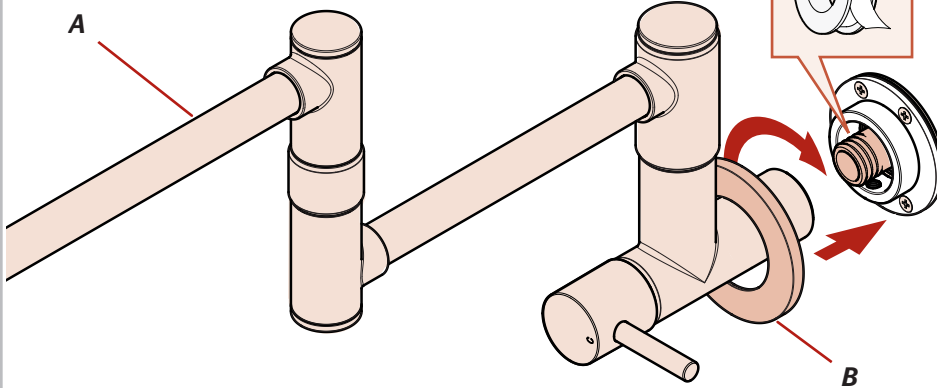

Apply PTFE Plumber's Tape or Thread Sealant according to manufacturer's instructions.

Coloque cinta PTFE o Sellador de Roscas de acuerdo con las instrucciones del fabricante.

Appliquez PTFE Plombiers bande ou le scellant de filets selon les instructions du fabricant.

3B

Turn on the water supply valve.

Abra la válvula de suministro de agua.

Ouvrez la vanne d'alimentation en eau.

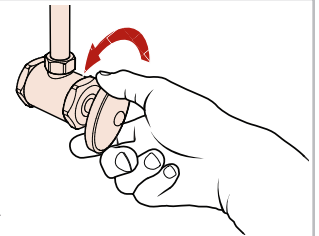

3C

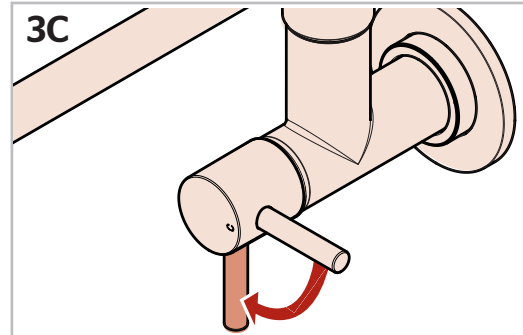

Open valve and check for leaks before proceeding.

Abra la válvula y compruebe si hay fugas antes de continuar.
Ouvrez la vanne et vérifiez s'il y a des fuites avant de continuer.

3D

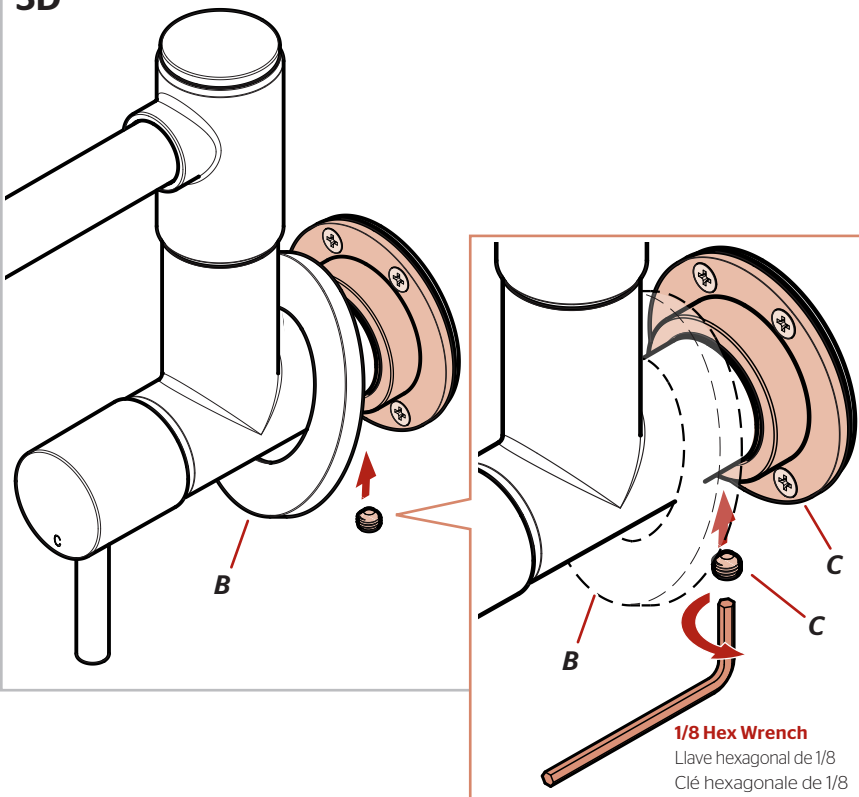

1/8 Hex Wrench

Llave hexagonal de 1/8
Clé hexagonale de 1/8

3E

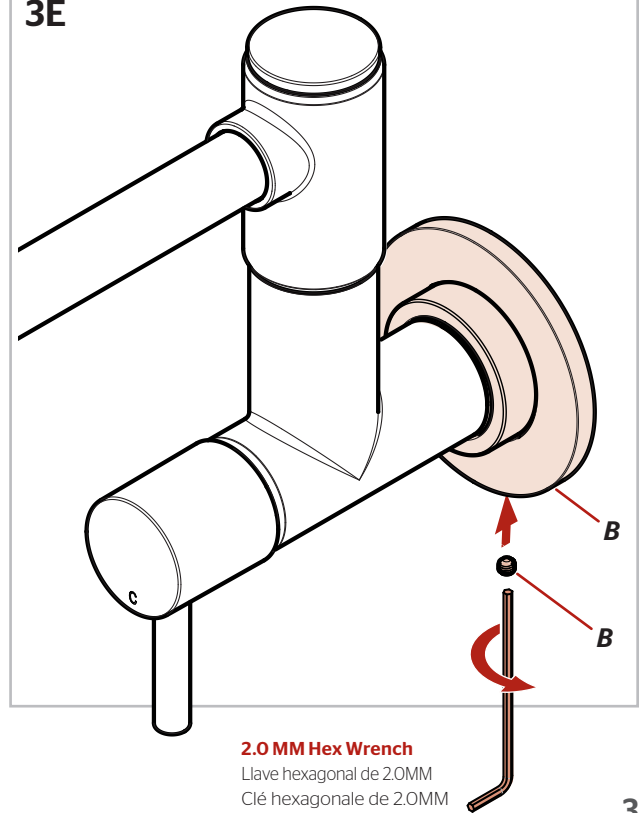

2.0 MM Hex Wrench

Llave hexagonal de 2.0MM
Clé hexagonale de 2.0MM

4

Turn On Water & Confirm Proper Installation

Active el suministro de agua y confirme que la instalación está adecuadamente efectuada

Ouvrez l'eau et confirmez que l'installation est correcte



Ensure both valves are in closed position.

Asegúrese de que ambas válvulas están en posición cerrada.

S'assurer que les deux valves sont en position fermée.

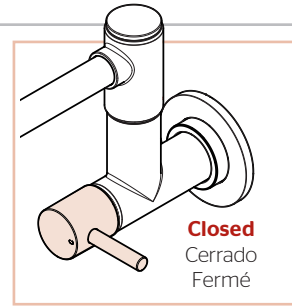
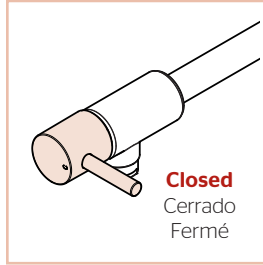

Open main valve first.

Abra la válvula principal de primera

Ouvrir le robinet principal d'abord

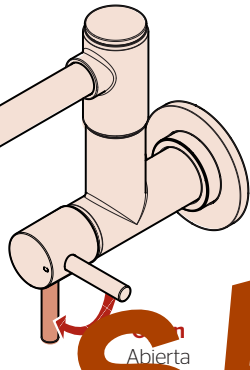

Slowly open end valve.

Abra lentamente

Ouvrez lentement

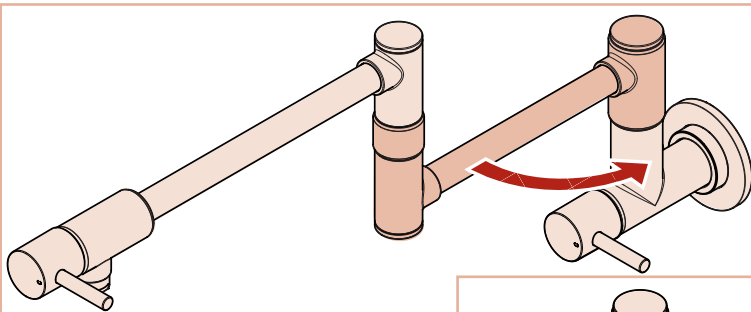
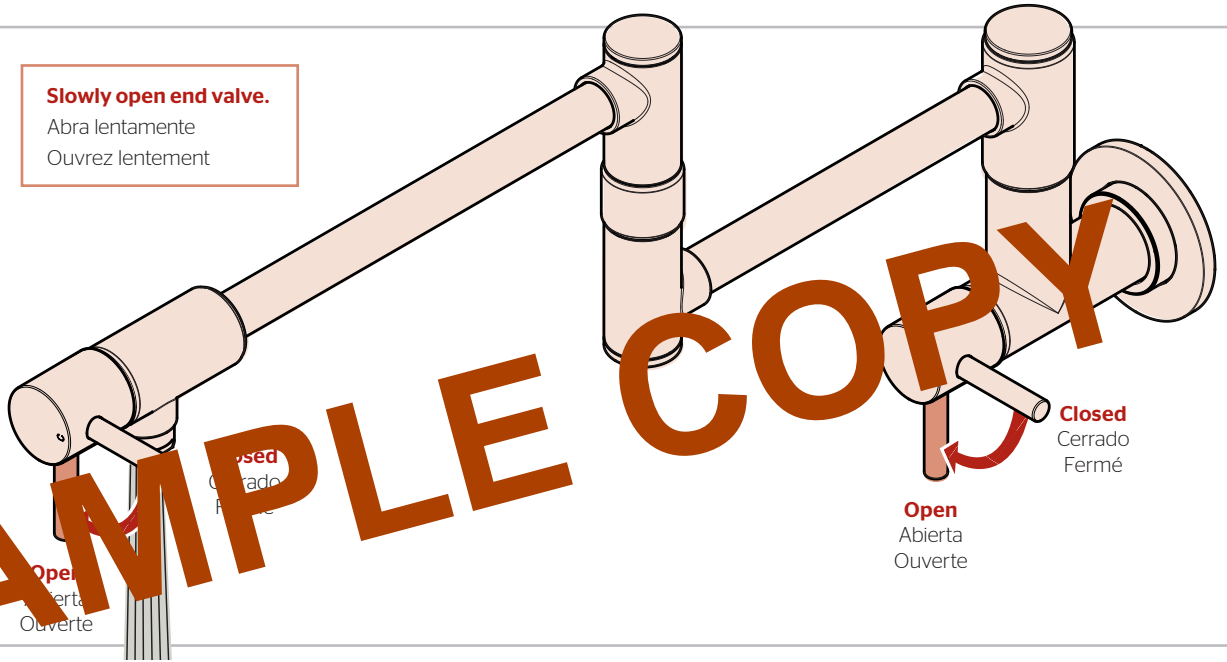

Stowing Faucet
Stowing Faucet
Rangement robinet

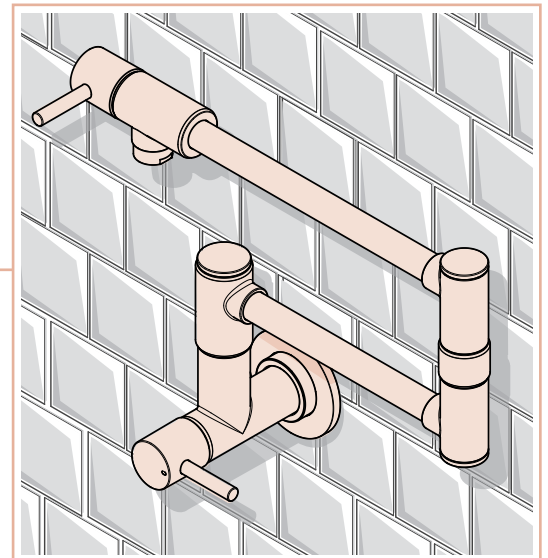
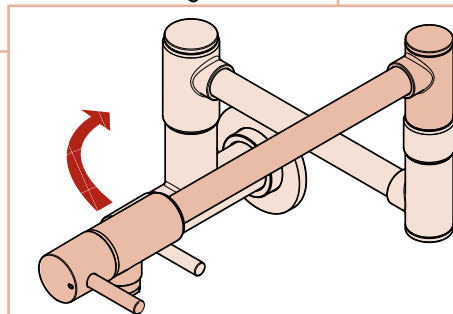

For Additional Installation Help:

Para la instalación adicionales de ayuda:

Pour aider à l'installation supplémentaires:

Pfister

1-800-PFAUCET (732-8238)
pfisterfaucets.com