

## Square Modern Tub Spout

- TBS-O2SHWB Finish(B)
- TBS-O2SHWBG Finish(BG)
- TBS-O2SHWC Finish(C)
- TBS-O2SHWD Finish(D)
- TBS-O2SHWK Finish(K)

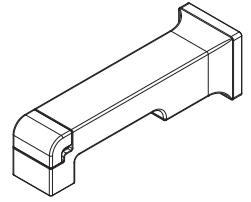

## Specifications

### Features

- All Metal Construction
- Unique Water Ribbon Flow
- Diverting Tub Spout
- Threaded 1/2" Male Copper Sweat Adapter Included (C X MNPT)
- Limited Lifetime Warranty

### Code Compliance

Pfister products are designed and manufactured in compliance with the following standards and codes:

- IAPMO Certified to ASME A112.18.1/CSA B125.1
- CEC Certified/CALGreen compliant

## Dimensions

