

016-NC1BG Finish(BG) ☐

016-NC1B Finish(B) ☐

016-NC1C Finish(C) ☐

016-NC1K Finish(K) ☐

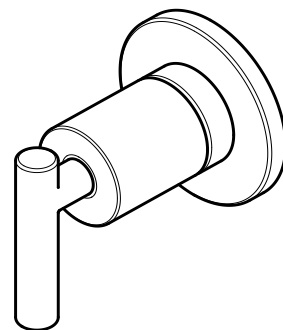

## Specifications

- All Metal Construction

### Features

- 015-3WDNS or 015-6WDS Valve Required, Sold Separately
- All Metal Construction
- SecurePfit™ with Anti Handle Wobble
- Optional Extension Kit Available, Order 951-3549 Separately
- Limited Lifetime Warranty

### Code Compliance

Pfister products are designed and manufactured in compliance with the following standards and codes:

- ADA Compliant - ANSI A117.1 (Lever Handle Only)



## Dimensions

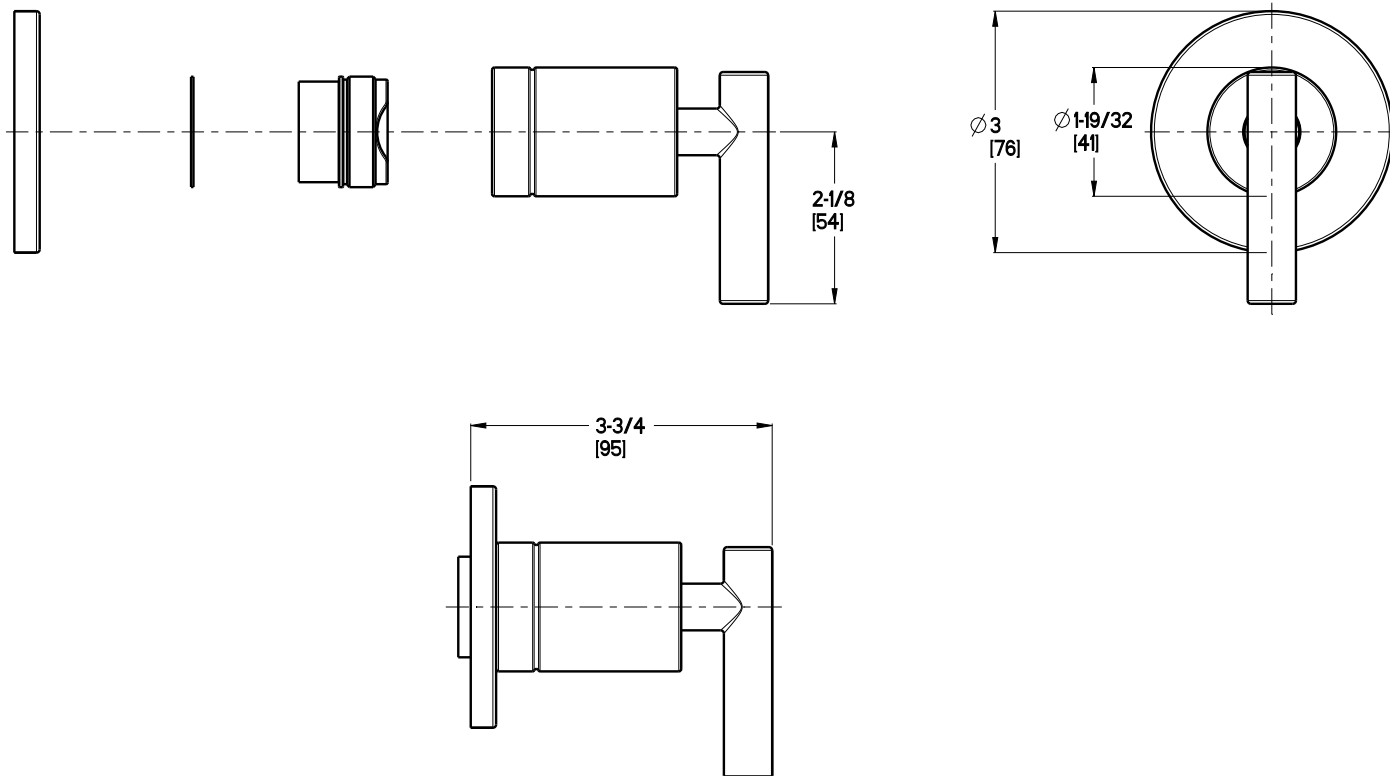

R89-1NCBG Finish(BG) ☐ R89-1NCC Finish(C) ☐ LG89-7NCC Finish(C) ☐ LG89-8NCC Finish(C) ☐  
 R89-1NCB Finish(B) ☐ R89-1NCK Finish(K) ☐ LG89-7NCK Finish(K) ☐ LG89-8NCK Finish(K) ☐

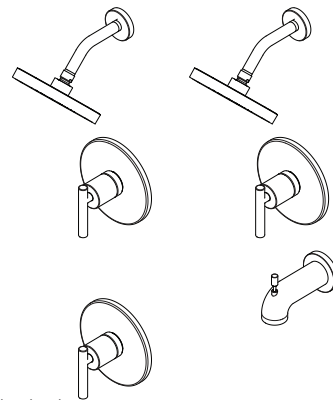

## Specifications

### Features

- 1.75 GPM Flow Rate (Showerhead)
- PVD Finish (K Finish Only)
- Raincan Showerhead
- Temperature Control Only
- Secure Pfit™ with Anti Handle Wobble
- Quick Connect Tub Spout (8NC Only)
- Removable Quick Connect for 1/2" IP Option (8NC Only)
- Tub & Shower Trim (8NC)
- Shower Only Trim (7NC)
- Valve Trim Only (1NC)
- Requires OX8/JX8 Valve (Sold Separately)
- Limited Lifetime Warranty

### Code Compliance

Pfister products are designed and manufactured in compliance with the following standards and codes:

- IAPMO Certified to ASME A112.18.1/CSA B125.1
- CEC Certified/CALGreen compliant
- EPA WaterSense Certified
- ADA Compliant - ANSI A117.1 (Lever Handle Only)



## Dimensions

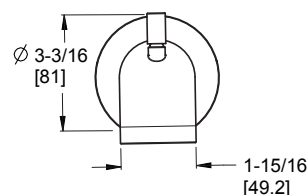
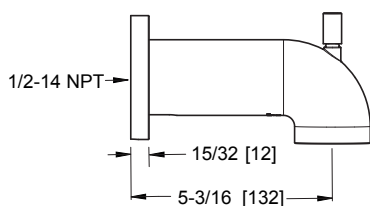
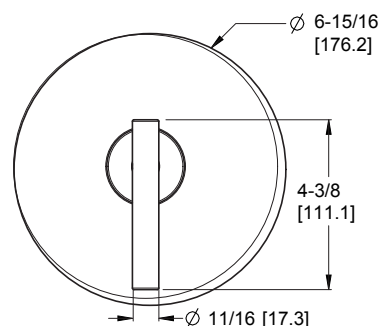
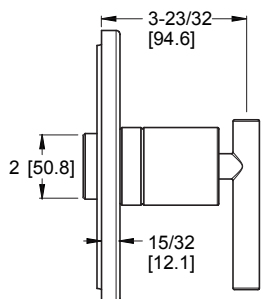
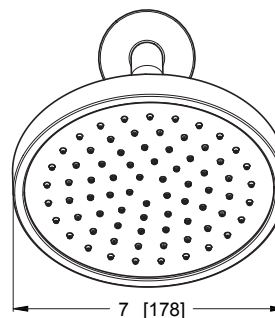
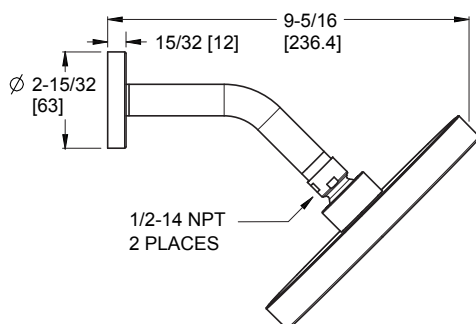

## Round Modern Handheld

- HSC-01SHWB Finish(B) ☐
- HSC-01SHWBG Finish(BG) ☐
- HSC-01SHWC Finish(C) ☐
- HSC-01SHWD Finish(D) ☐
- HSC-01SHWK Finish(K) ☐



## Specifications

### Features

- 1.75 GPM Flow Rate
- All Metal Construction
- Easy To Clean Nozzles
- Limited Lifetime Warranty



### Code Compliance

Pfister products are designed and manufactured in compliance with the following standards and codes:

- IAPMO Certified to ASME A112.18.1/CSA B125.1 including:
  - ASME A112.18.3 (Backflow Prevention)
- EPA WaterSense Certified
- CEC Certified/CALGreen compliant



## Dimensions

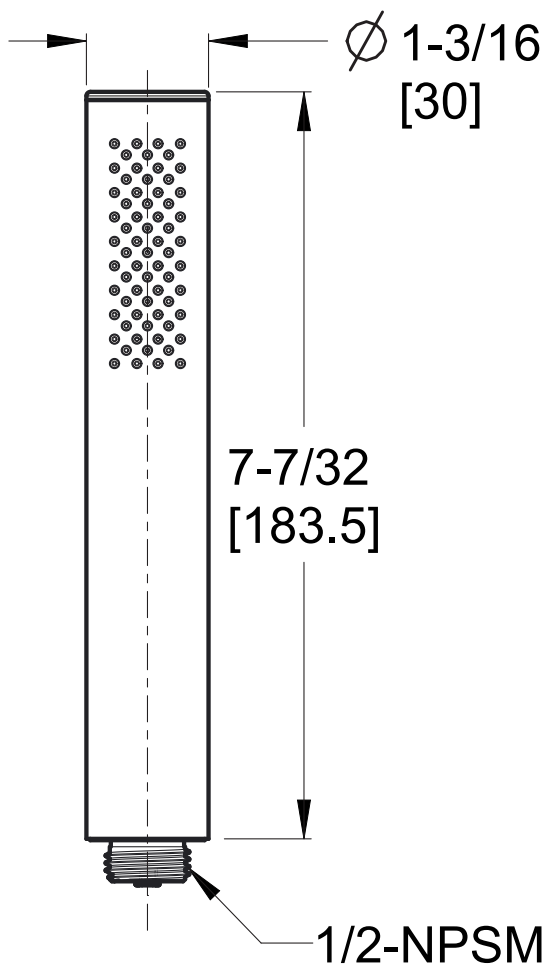

OX8-310A Finish(XX) ☐

OX8-340A Finish(XX) ☐

JX8-310A Finish(XX) ☐

JX8-340A Finish(XX) ☐

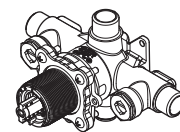
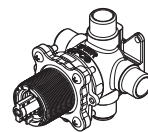

## Specifications

### Features

- Metal Stem
- Dual 1/2" I.P. or 1/2" Copper Sweat Connections
- Job Pack of 12 (JX8 Only)
- Integral Stops (340A Only)
- Back-to-Back Installation

- Temperature Limit Stop Included
- Anti-Scald Shower Cartridge
- Solid Brass Construction
- Spool Pressure Balance Valve
- Includes Plug for Shower Only
- Valve Only
- Pforever Warranty®

### Code Compliance

Pfister products are designed and manufactured in compliance with the following standards and codes:

- IAPMO Certified
- CSA B125 Certified
- ASME A112.18.1
- ASSE 1016
- ADA Compliant-ANSI A117.1 (Lever handles only)



## Dimensions

OX8-340A/ JX8-340

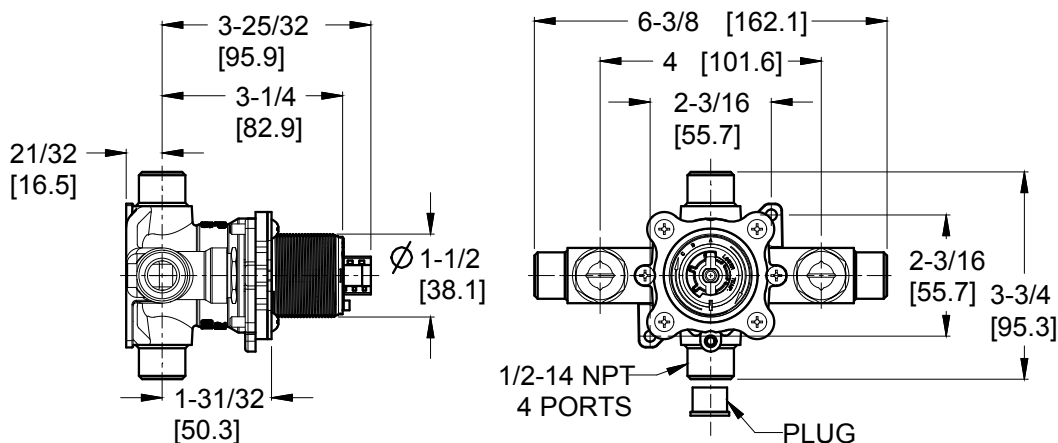

OX8-310A/ JX8-310

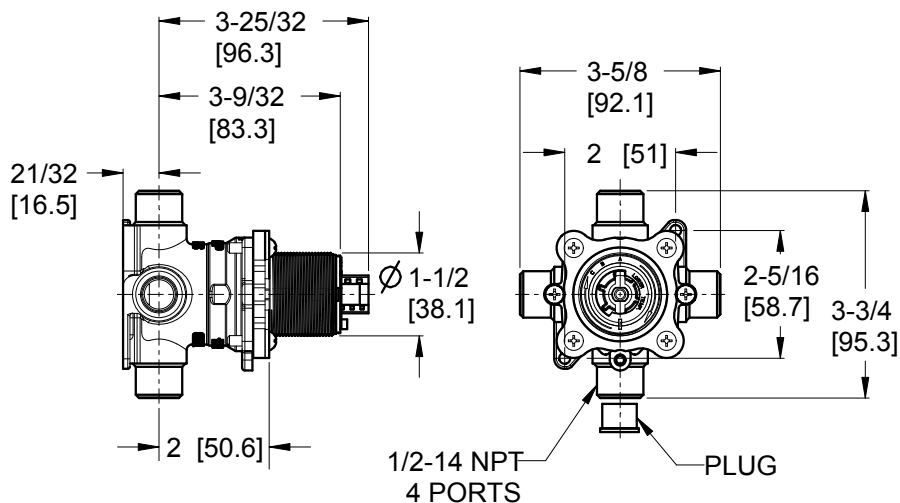

## Round 2-Piece Handheld Kit

- HSK-01SHWB Finish(B) ☐
- HSK-01SHWBG Finish(BG) ☐
- HSK-01SHWC Finish(C) ☐
- HSK-01SHWD Finish(D) ☐
- HSK-01SHWK Finish(K) ☐

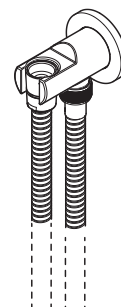

## Specifications

### Features

- Handheld Shower Sold Separately
- 60" Metal Hose
- All Metal Construction
- Valve Not Included
- Limited Lifetime Warranty

### Code Compliance

Pfister products are designed and manufactured in compliance with the following standards and codes:

- IAPMO Certified to ASME A112.18.1/CSA B125.1

## Dimensions

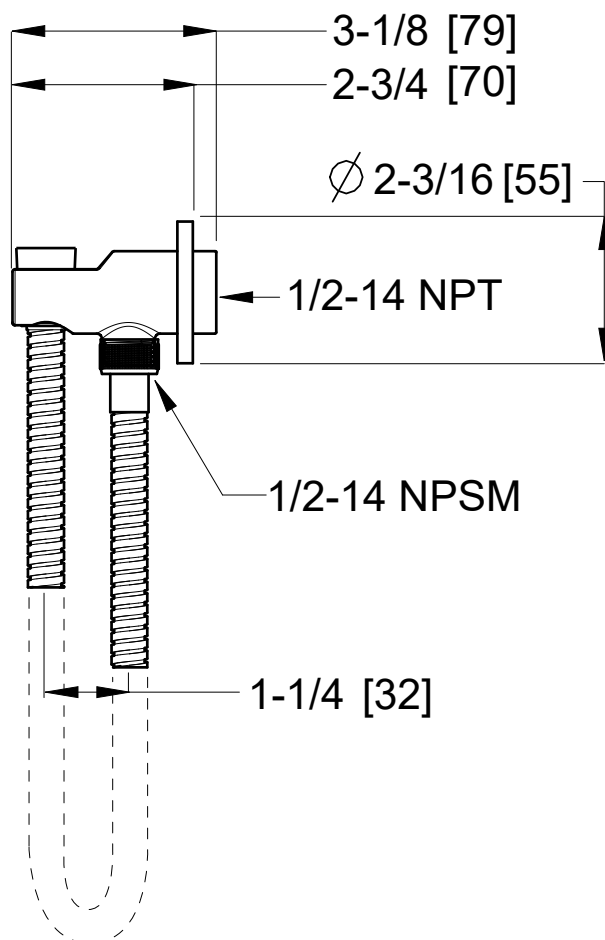

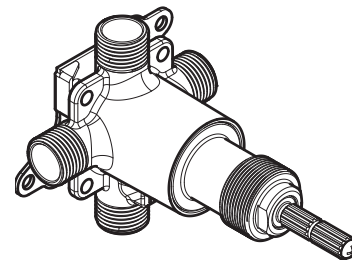

## Specifications

### Features

- All Metal Construction
- 6 Way Diverter
- Shared Functionality
- 4 Port Diverter
- Ceramic Disc Cartridge
- Requires 16 Series Diverter Trim (Sold Separately)
- Pforever Warranty®

### Code Compliance

Pfister products are designed and manufactured in compliance with the following standards and codes:

- IAPMO Certified to ASME A112.18.1/CSA B125.1
- ADA Compliant - ANSI A117.1 (Lever Handles Only)



## Dimensions

