

In-Wall Diverter Valve

015-4WDX Finish(XX)

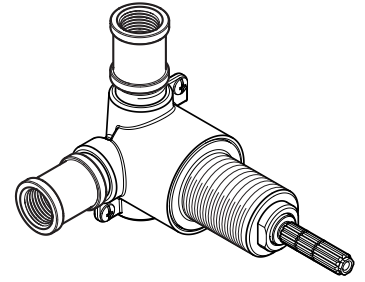

Specifications

Features

- All Metal Construction
- Pforever Warranty®

- All Metal Construction
- Pforever Warranty®

Code Compliance

Pfister products are designed and manufactured in compliance with the following standards and codes:



- IAPMO Certified
- CSA B125 Certified
- ASME A112.18.1
- ADA Compliant-ANSI A117.1 (Lever handles only)

Dimensions

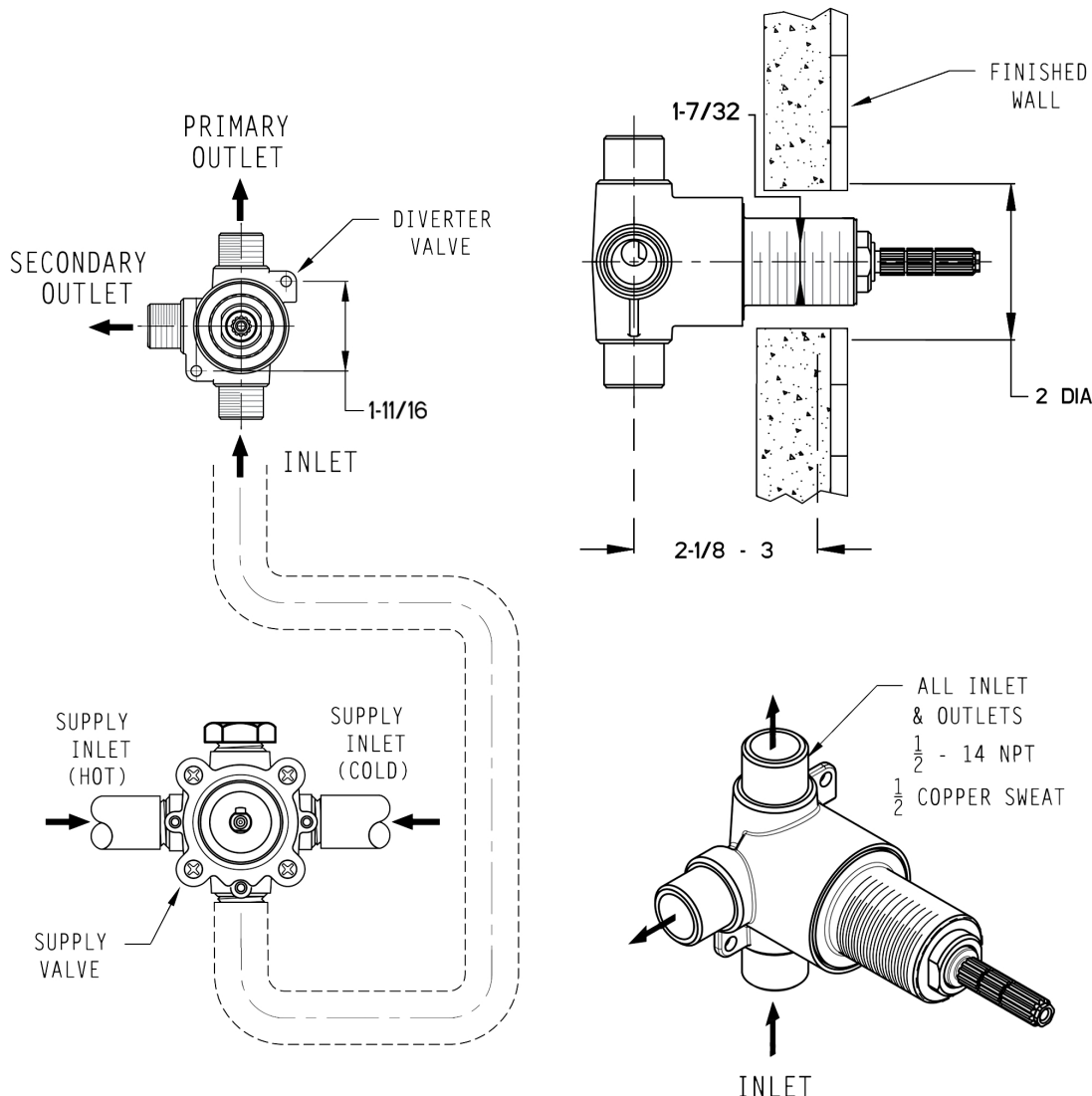

Pfirst Series™ Hand-Held Shower

- | | |
|----------------------------------------------|----------------------------------------------|
| O16-200C Finish(CC) <input type="checkbox"/> | G16-200C Finish(CC) <input type="checkbox"/> |
| O16-200K Finish(KK) <input type="checkbox"/> | G16-200K Finish(KK) <input type="checkbox"/> |
| O16-200U Finish(UU) <input type="checkbox"/> | G16-200U Finish(UU) <input type="checkbox"/> |
| O16-200Y Finish(YY) <input type="checkbox"/> | G16-200Y Finish(YY) <input type="checkbox"/> |

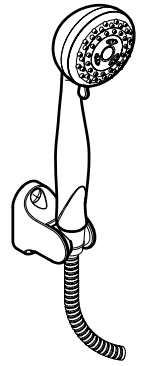

Specifications

- Valve Not Included
- 3 Function Hand Shower
- Includes Back Flow Prevention System
- 60" Metal Hose with Matching Finish

Features

- 28" Brass Slide Bar
- 3 Function Hand Shower with Dual Check Valves
- 60" Metal Hose with Matching Finish
- Includes Back Flow Prevention
- Includes Hand Shower, Hose, Slide Bar, and Drop Elbow
- Self-Cleaning Spray Head
- 2.5 GPM Shower Head (O16 Only)
- 2.0 GPM Shower Head (G16 Only)
- Pforever Warranty®

Code Compliance

Pfister products are designed and manufactured in compliance with the following standards and codes:

- IAPMO Certified
- CSA B125 Certified
- ASME A112.18.1
- Cal Green Compliant (O16 Only)



Dimensions

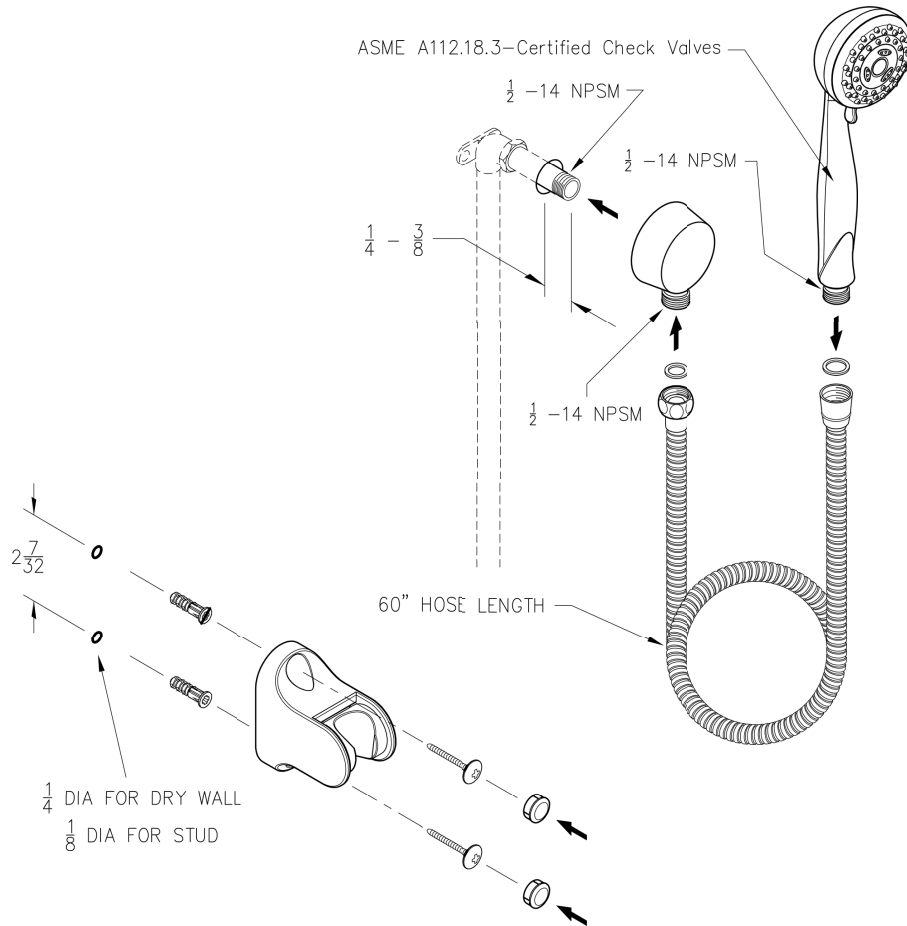

Avalon™ Diverter Trim

- 016-CB1C Finish(CC)
- 016-CB1K Finish(KK)
- 016-CB1Y Finish(Y)

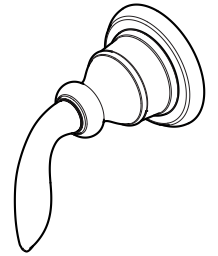

Specifications

Features

- All Metal Construction
- Pforever Warranty®

- All Metal Construction

Code Compliance

Pfister products are designed and manufactured in compliance with the following standards and codes:

- IAPMO Certified
- CSA B125 Certified
- ASME A112.18.1
- ADA Compliant-ANSI A117.1 (Lever handles only)



Dimensions

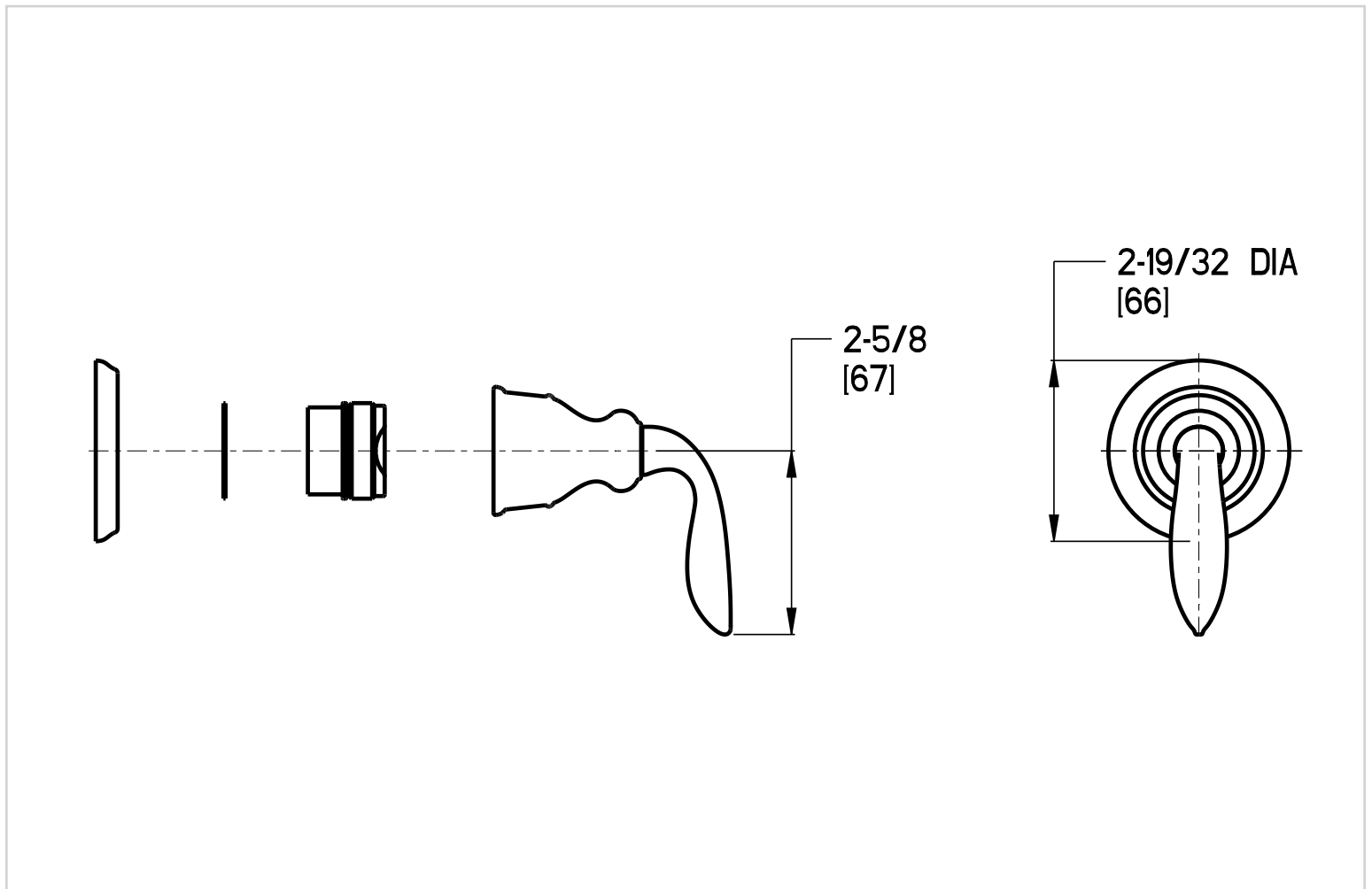

Avalon™ Shower Trim

- G89-7CBC Finish(PC)
- G89-7CBK Finish(KK)
- G89-7CBY Finish(Y Y)

- G89-8CBC Finish(PC)
- G89-8CBK Finish(KK)
- G89-8CBY Finish(Y Y)

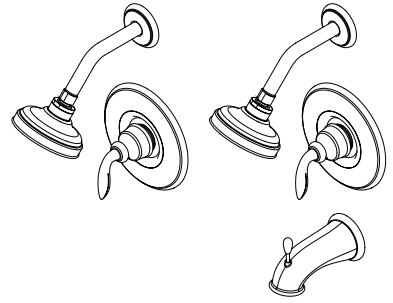

Specifications

- Single Control
- Trim Only, Valve Not Included

Features

- EZ Clean
- Tub Options
- Round Flange
- Lever Handle
- Quick Trim Installation- Attaches Without Tools, No Exposed Screws
- Fits OX8, OX9, and JX8 Valve Bodies
- Shower Only (7CB Only)
- Metal Tub Spout (8CB Only)
- Threaded Tub Spout (8CB Only)
- Tub & Shower (8CB Only)
- 2.0 GPM Shower Head
- Mini Rain Can Shower Head
- Trim Only, Valve Not Included
- Pforever Warranty®

Code Compliance

Pfister products are designed and manufactured in compliance with the following standards and codes:

- IAPMO Certified
- CSA B125 Certified
- ASME A112.18.1
- Cal Green Compliant
- ADA Compliant-ANSI A117.1 (Lever handles only)



Dimensions

