

Atmosphere Vortex® - Dryer Exhaust Duct Power Ventilator



Models:

VTX-DEDPV (4" duct dimension)



Exhaust Fan with Integrated Pressure Sensors

Solving the problem in locations with longer duct lengths, this smart, in-line venting solution improves venting for commercial and residential clothing dryers especially as dryer locations are more variable in today's construction landscape.

KEY FEATURES

Energy Efficient - Reduces drying time and power consumption with Pressure Sensor detection and regulation of air flow. Maintains 1,200 FPM air velocity.

Pressure Sensor Detection - Detects when air is flowing through the ventilation duct. Will turn on for 10 minutes and shut off for 15 seconds. It will turn back on if there is still positive pressure from the dryer.

Roof or Wall Exhaust

10-Year Warranty

Other Details

- LED Light on remote panel indicates proper or problematic fan operation to the dryer operator.
- Homeowner will be notified in the event of a blockage.
- High temperature thermal fuse will shut down the fan in case of a dryer fire.
- Certified to UL 705 dryer exhaust duct power ventilator for gas and electric dryers.



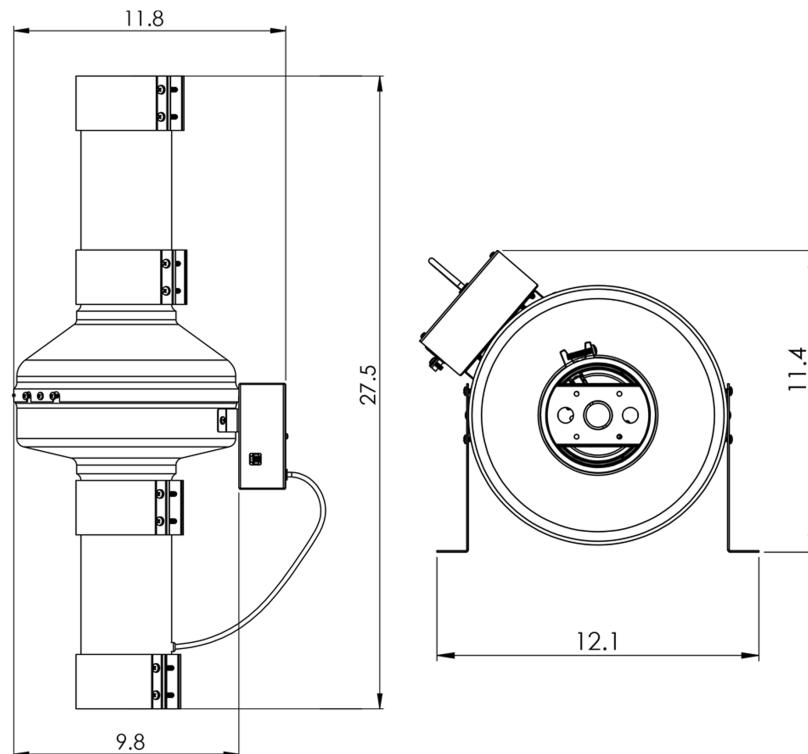

VTX-DEDPV Performance Data

ALL VTX PRODUCTS INCORPORATE MOTORS SUITABLE FOR 120 Volts AC 60Hz ELECTRICAL SUPPLY ONLY

Duct Dia.	RPM	Volts	Rated Watts	Max Amos	Static Pressure in Inches W.G.												Max Ps
					0"	0.125"	0.2"	0.25"	0.375"	0.5"	0.75"	1"	1.25"	1.5"	2"		
4"	2970	120	68	0.56	198	184	175	169	156	143	121	96	69	41	0	1.852"	

Performance certified is for installation type D - Ducted outlet. Speed (RPM) shown is nominal. Performance is based on actual speed of test. Performance ratings include the effects of appurtenances (accessories) Inlet Duct, Inlet Duct, Inlet Bell, Outlet Duct

This model requires a lint trap. There are 3 Atmosphere lint trap models:

- Slim Lint Trap - Model # - SLT
- Lint Trap - Model # - LT4
- Lint Trap - Model # - LT4S

