



OLYMPIA FAUCETS, INC.
3325 S. Garfield Ave.
Commerce, CA 90040
(888) 772-7701
www.olympiafaucets.com

INSTALLATION

Tools:



Adjustable Wrench



Silicone Sealant



Teflon Tape



Rags

Model Number: P-4335

Warnings and Notes:

Check with local plumbing code requirements before installation.

This product should be installed by a local listed plumber.

Do not use plumbers putty on threads.



Installation Steps:

Shower Holder

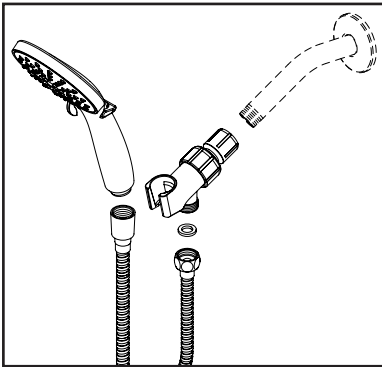

(1) Apply Teflon tape on the threaded end of shower arm, hand tighten inlet end of handheld shower holder to shower arm threaded end then tighten and align handheld shower holder with help of adjustable wrench. With washer inside the hose connection nut hand tighten hose connection nut to outlet end of handheld shower holder then tighten hose connection nut with help of adjustable wrench.

Exploded Drawing:

* Note: Please specify finish/color when ordering.

	ITEM #	DESCRIPTION
A	OP-660008*	1.75 GPM Handheld Showerhead
B	OP-460027*	60" SST Hose
C	OP-460040*	Shower Arm Mount Handheld Shower Holder
1	OP-460025	Washers

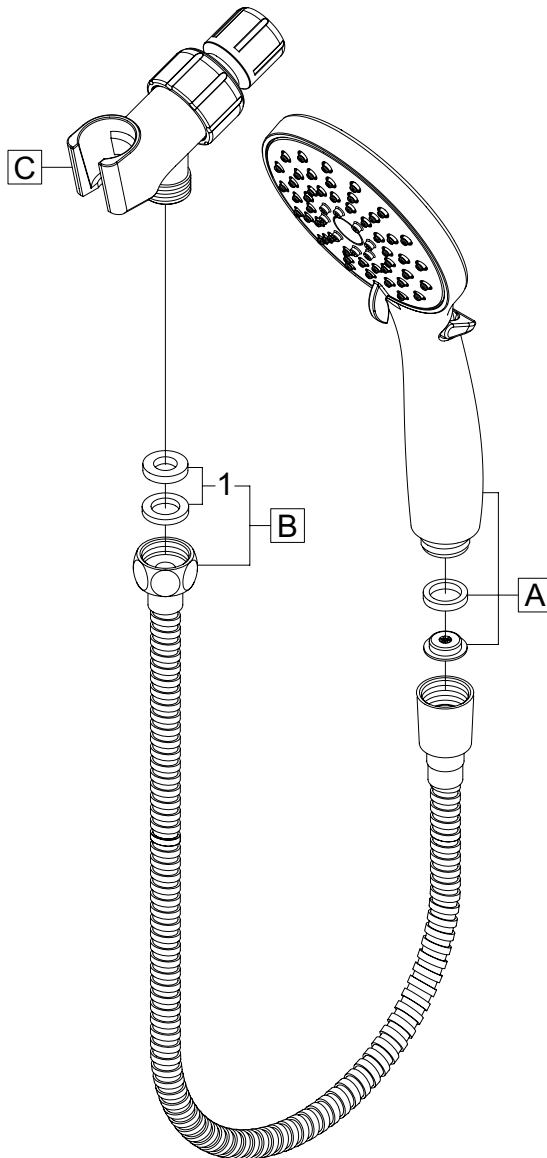

OLYMPIA

For more care information or trouble shooting inquiries
about your Olympia product, Please call:
OLYMPIA FAUCETS, INC. (888) 772-7701
Monday-Friday 8 AM to 8 PM EST (5 AM to 5 PM PST)
www.olympiafaucets.com