

NOTES:

1. FIT / FORM / FUNCTION SHALL FOLLOW PS-E.008.

BILL OF MATERIAL (CURRENT LEVEL)

ITEM	PT/ASSY	DESCRIPTION	TYPE	QTY.
1	92515	WATTS FLOOR DRAIN COLLAR ICL-US (CAST IRON-GREY)	PART	1
2	91596	WATTS FLOOR DRAIN HUB B2L-2 (2" PVC WHITE)	PART	1
3	92521	SCRW, 5/16-18 X 3/4 HEX CAP HD 304/316 STAINLESS STEEL	PART	4

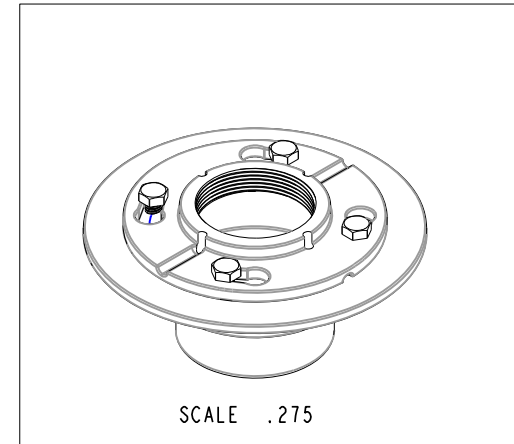
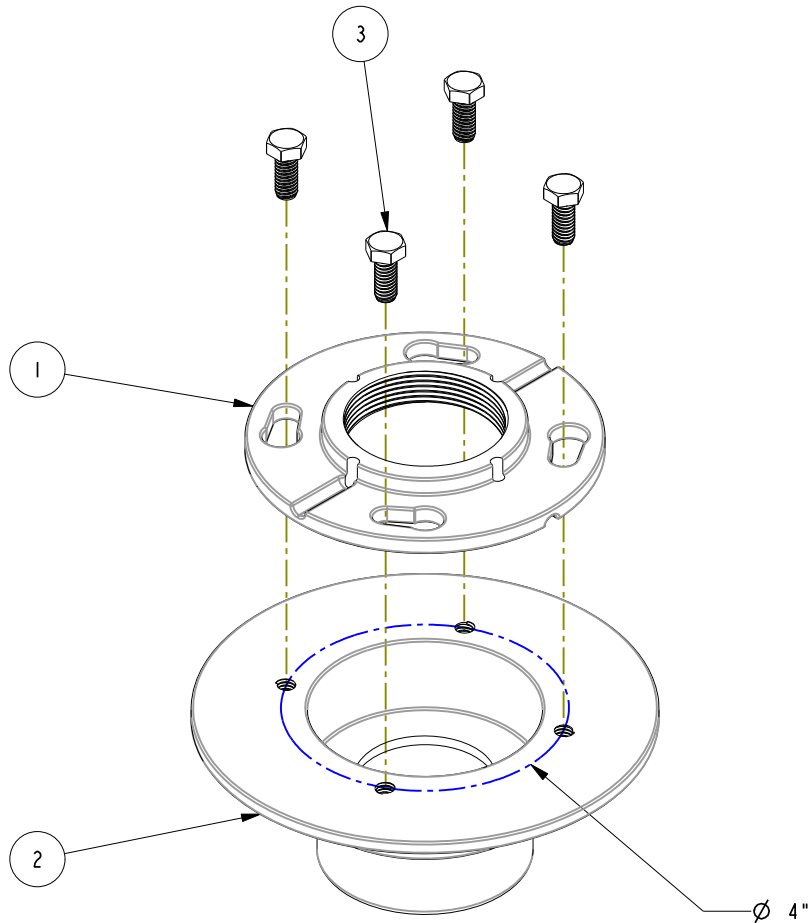

ZONE	REV	DESCRIPTION	DATE	APPROVED
B	EN-3668		7/26/18	J. A.
A	EN-2190		06/18/12	-
-	-	EN-1714	12/30/11	-

COPYRIGHT 2005 BRASSTECH, INC. THESE DRAWINGS AND THE DESIGNS DEPICTED HEREIN ARE THE PROPRIETARY PROPERTY OF BRASSTECH. ANY USE OR REPRODUCTION IS SUBJECT TO THE EXPRESS APPROVAL OF BRASSTECH. UNAUTHORIZED USE IS STRICTLY PROHIBITED. ALL RIGHTS RESERVED.

TESTING	ASSEMBLY	PLATING	POLISHING	MACHINING	TOOLING FIXTURE #
-	-	-	-	-	
					REMOVE ALL BURRS AND SHARP EDGES

UNITS ARE: INCHES [MM]	TOLERANCES ARE:	FRACTIONS DECIMALS	ANGLES
		±1/16"	±1°
		.X ±.1 (2,5)	
		.XX ±.06 (1,5)	
(X.XXX) DENOTES CRITICAL DIMS. ALL THREADS ARE CRITICAL			
DRAWN	J. AMOZOC	7/26/18	
CHECKED	V. VU	7/26/18	
APPROVED	V. VU	7/26/18	

BRASSTECH 2001 CARNEGIE AVE. SANTA ANA, CA 92705 (949) 417-5207
INCORPORATED

FLOOR DRAIN BODY ASM

DWG NO. 278P-01

SCALE .375 REF. - SHEET | OF 3

↓

SPECIFICATION DWG

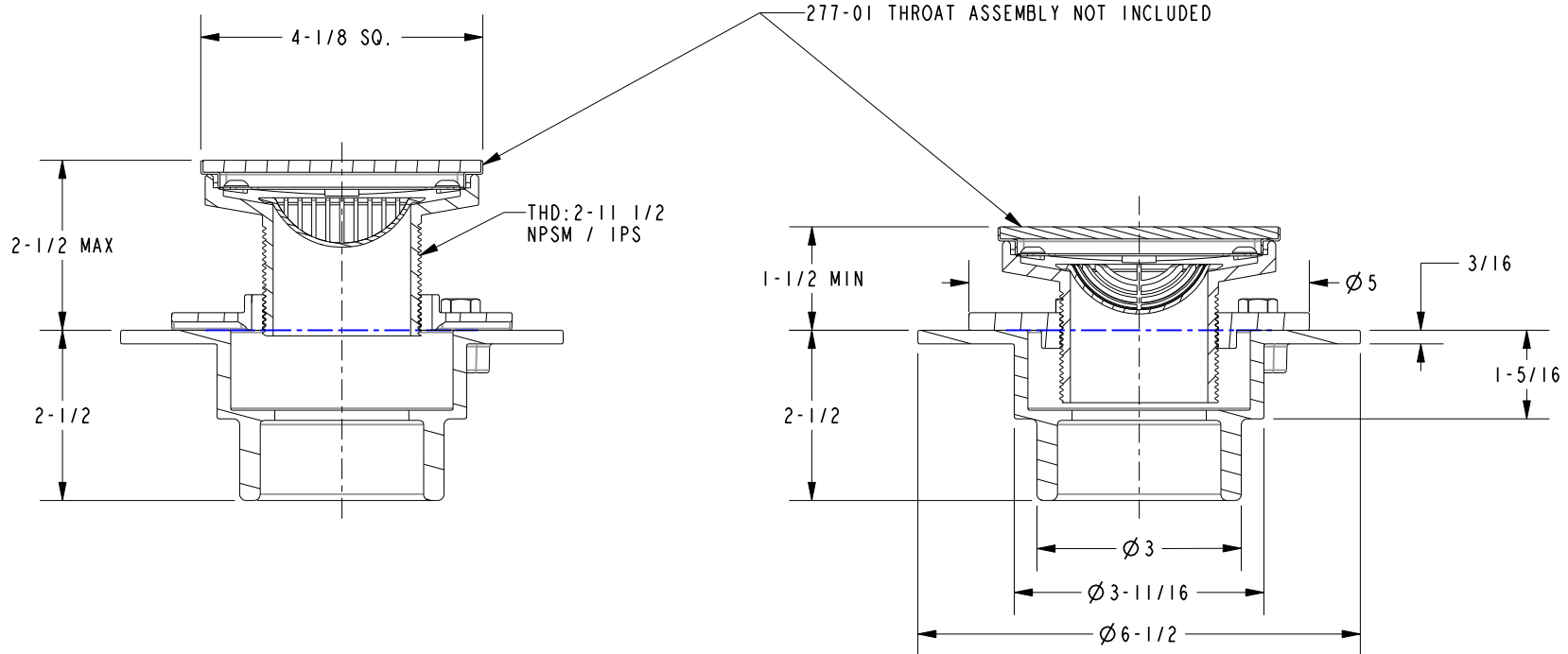

DIMENSIONS ARE IN INCHES AND AN APPROXIMATION OF A TYPICAL INSTALLATION

COPYRIGHT 2005 BRASSTECH, INC. THESE DRAWINGS AND THE DESIGNS DEPICTED HEREIN ARE THE PROPRIETARY PROPERTY OF BRASSTECH. ANY USE OR REPRODUCTION IS SUBJECT TO THE EXPRESS APPROVAL OF BRASSTECH. UNAUTHORIZED USE IS STRICTLY PROHIBITED. ALL RIGHTS RESERVED.

BRASSTECH		<small>2001 CARNEGIE AVE. SANTA ANA, CA 92705 (949) 417-5207</small>	
INCORPORATED			
<small>DWG NO.</small>	278P-01	<small>REV</small> B	
<small>SCALE</small>	.375	<small>REF.</small>	-
		<small>SHEET</small>	2 OF 2

SIZE	UNIT	PER CTRM DWG	DATE	REV.
A4	INCH	XXX	XX-XX-XX	X

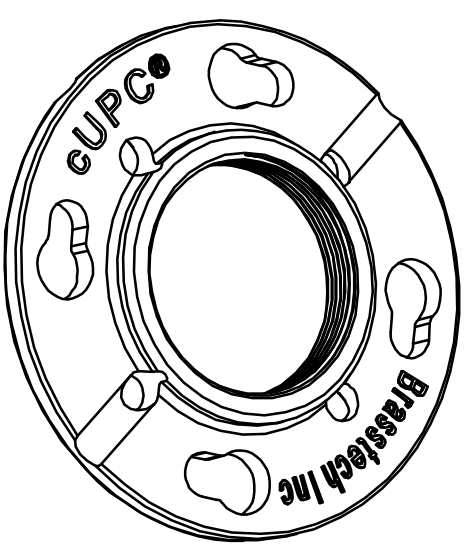
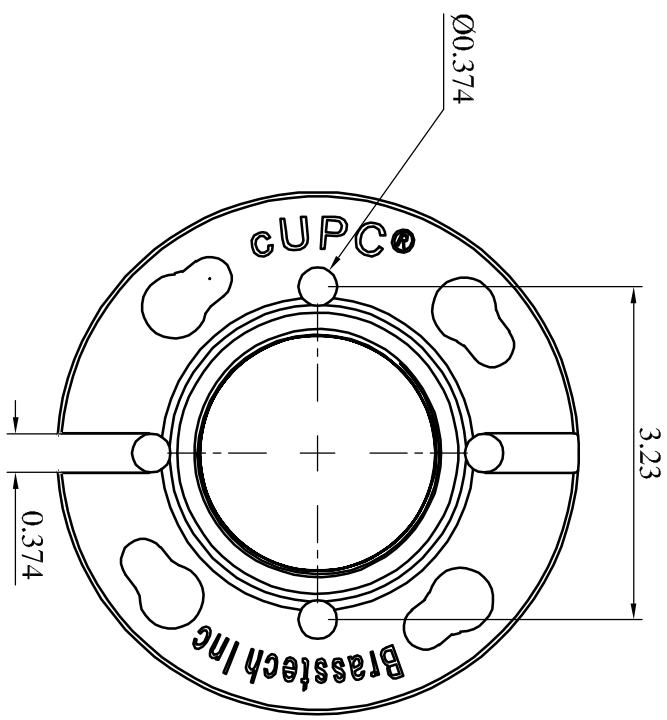

DO NOT SCALE DRAWING

UNIPLUMBURG ENTERPRISE CO. LTD.

TOLERANCES :
 UNLESS OTHERWISE SPECIFIED
 .XX ± .010 ANGLES ± 1/2°
 .XXX ± .005 FRACTION ± 1/64

W.T.: _____ gms

MATERIAL : HT200

FINISH : XXX

TITLE
FLOOR DRAIN COLLAR ICL-US

ITEM No. _____

92515

REV. **A**

DRAWN _____

Makey 5/29/18

SCALE 1 : 1

PROJECTION

APR. _____

FILE XXX

SHEET : 1 / 1

XXX