

NOTES:

1. TO INSPECT ASSEMBLY, FOLLOW FIRST ARTICLE AND IN PROCESS INSPECTION SHEET.
2. PUT THESE ITEMS IN SEPARATE PLASTIC BAGS.
3. TORQUE 135 +/-5 LB-IN.
4. APPLY THIN COAT OF SILICON GREASE FOR ALL O-RINGS BEFORE INSTALLATION.
5. APPLY LOCTITE 242, IF SCREW DOES NOT HAVE NYLON PATCH.
6. APPLY LOCTITE 680.
7. PULL OUT HOSE AND APPLY SILICON GREASE, BETWEEN HOUSE AND SPOUT, 10" FROM OUTLET TO HOSE.
8. TORQUE SWIVEL NUT TO 10 +/-2 LB-IN.
9. TORQUE TO 10 +/-2 LB-FT.
10. TORQUE TO 7 +/-2 LB-IN.
11. PARTIALLY THREAD MOUNTING KIT ONTO SHANK.
12. DO NOT DOCK SPRAY HEAD TO SPOUT WHEN PACKAGING.

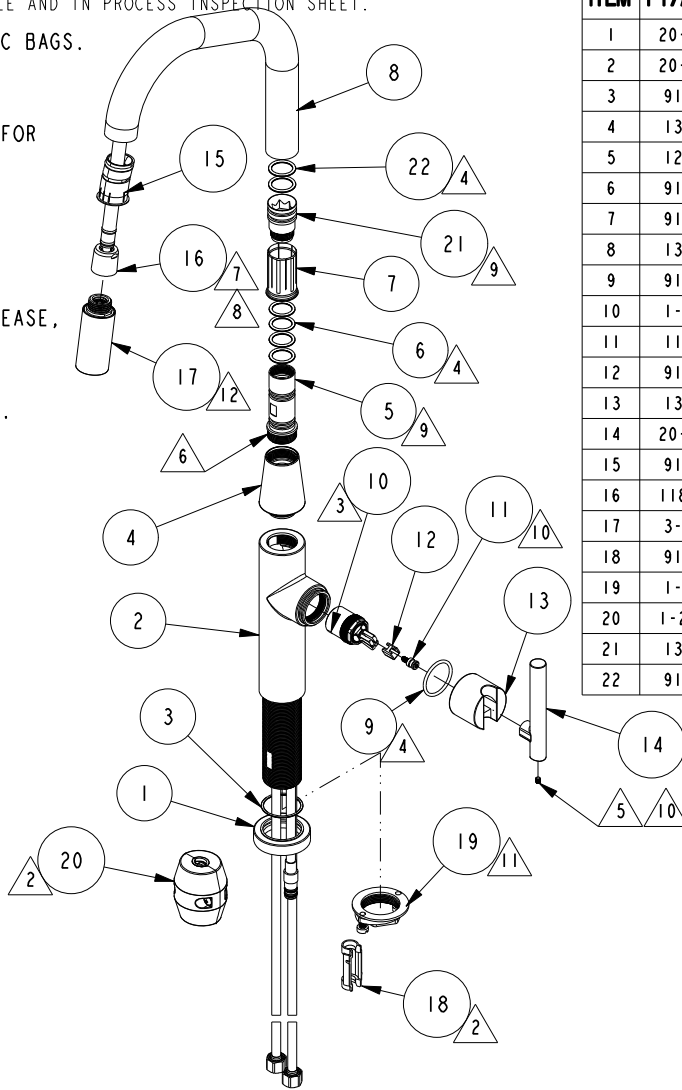

BILL OF MATERIAL (CURRENT LEVEL)

ITEM	PT/ASSY	DESCRIPTION	TYPE	QTY.
1	20-390	ESCUTCHEON ASM	ASSEMBLY	1
2	20-245	MAIN BODY ASM	ASSEMBLY	1
3	91764	O-RING, #2-027, EP, 50 DURO - GREY	PART	1
4	13862	TAPERED UPPER BODY	PART	1
5	12667	SPOUT ADAPTER	PART	1
6	91030	O-RING, #2- 115, EPDM, 65-75 DURO, NSF 61	PART	4
7	91712	SLEEVE	PART	1
8	13663	PULLDOWN SPOUT	PART	1
9	91505	O-RING, #2-123, EPDM, 65-75 DURO	PART	1
10	1-371	CARTRIDGE	PART	1
11	11874	HANDLE ADAPTER SCREW	PART	1
12	91534	CARTRIDGE STEM INSERT	PART	1
13	13825	HANDLE HUB, CONTEMP	PART	1
14	20-389	HANDLE ASM	ASSEMBLY	1
15	91544	MAGNET DOCKING	ASSEMBLY	1
16	11877A	HOSE, PULLDOWN, GREY	ASSEMBLY	1
17	3-480	SPRAY HEAD, EAST LINEAR	ASSEMBLY	1
18	91568	RETAINER CLIP	PART	1
19	1-256	MOUNTING KIT	ASSEMBLY	1
20	1-286A	WEIGHT	ASSEMBLY	1
21	13464	ADAPTER EXTENSION	PART	1
22	91114	O-RING, #2- 116, EPDM, 65-75 DURO, NSF 61	PART	2

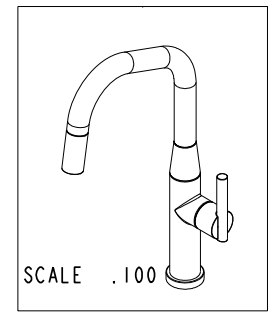

TESTING	-	-	-
ASSEMBLY	-	-	-
PLATING	-	-	-
POLISHING	-	NEXT ASSY	USED ON
MACHINING	-	APPLICATION	
TOOLING FIXTURE #		REMOVE ALL BURRS AND SHARP EDGES	

BRASSTECH 2001 CARNEGIE AVE.
INCORPORATED SANTA ANA, CA 92705
(949) 417-5207

25MM PULL DOWN

DWG NO. **1400-5143** REV -

SCALE .150 REF. - SHEET 1 OF 2

COPYRIGHT 2005 BRASSTECH, INC. THESE DRAWINGS AND THE DESIGNS DEPICTED HEREIN ARE THE PROPRIETARY PROPERTY OF BRASSTECH. ANY USE OR REPRODUCTION IS SUBJECT TO THE EXPRESS APPROVAL OF BRASSTECH. UNAUTHORIZED USE IS STRICTLY PROHIBITED. ALL RIGHTS RESERVED.

ZONE	REV	DESCRIPTION	DATE	APPROVED
-	-	EN-4579	11/18/22	J.M.

