

NOTES:

1. TO INSPECT ASSEMBLY, FOLLOW FIRST ARTICLE AND IN PROCESS INSPECTION SHEET.

2. APPLY LOCTIE 680

**BILL OF MATERIAL (CURRENT LEVEL)**

ITEM	PT/ASSY	DESCRIPTION	TYPE	QTY.
1	10086	TUB SPOUT	PART	1
2	10438	BASE - ROPE RING W/S SPOUT	PART	1
3	10852	WIDESPREAD SPOUT RING	PART	1
4	91755	O-RING, #2-142, EPDM, 50 DURO - GREY	PART	1

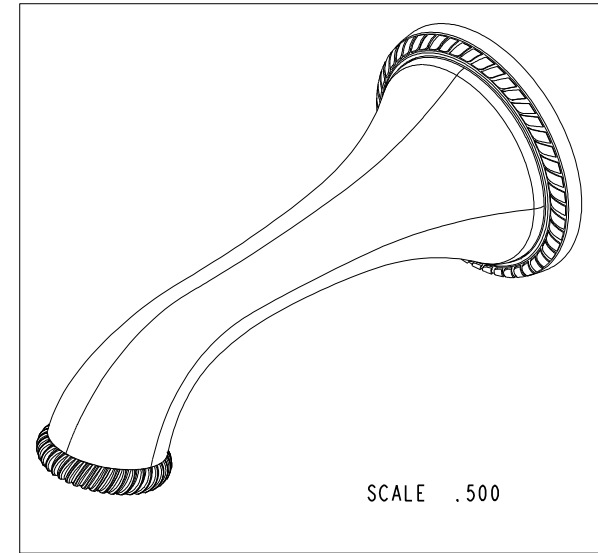
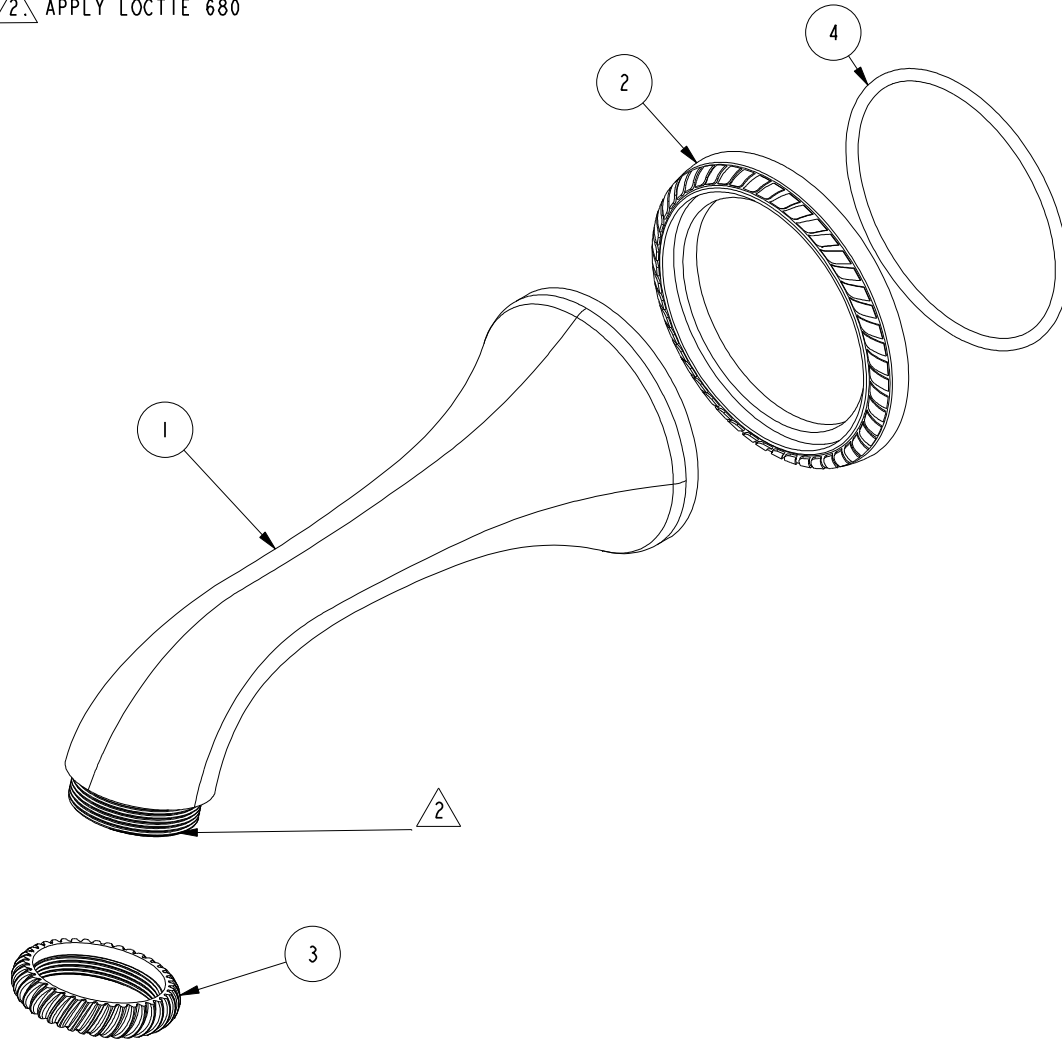

ZONE	REV	DESCRIPTION	DATE	APPROVED
-	C	EN-4300ii	01/22/21	R.S.
-	B	EN-3722	02/08/19	C.G.
-	A	EN-3320	5/22/17	J.A.

COPYRIGHT 2005 BRASSTECH, INC. THESE DRAWINGS AND THE DESIGNS DEPICTED HEREIN ARE THE PROPRIETARY PROPERTY OF BRASSTECH. ANY USE OR REPRODUCTION IS SUBJECT TO THE EXPRESS APPROVAL OF BRASSTECH. UNAUTHORIZED USE IS STRICTLY PROHIBITED. ALL RIGHTS RESERVED.

TESTING	-	-	-
ASSEMBLY	-	-	-
PLATING	-	3-982	982
POLISHING	-	NEXT ASSY	USED ON
MACHINING	-	APPLICATION	
TOOLING FIXTURE #	REMOVE ALL BURRS AND SHARP EDGES		

UNITS ARE: INCHES [MM]			
TOLERANCES ARE:			
FRACTIONS	DECIMALS	ANGLES	
±1/16"	.X ±.1 [2.5]	±1°	
	.XX ±.06 [1.5]		
(X.XXX) DENOTES CRITICAL DIMS.			
ALL THREADS ARE CRITICAL			
DRAWN	MANJUNATH	02/08/19	
CHECKED	C.G.	02/08/19	
APPROVED	C.G.	02/08/19	

**BRASSTECH** 2001 CARNEGIE AVE.  
INCORPORATED SANTA ANA, CA 92705  
(949) 417-5207

**WALL TUB SPOUT ASM**

DWG NO.	2-250	REV	C
SCALE	.625	REF.	-
SHEET	1	OF	2

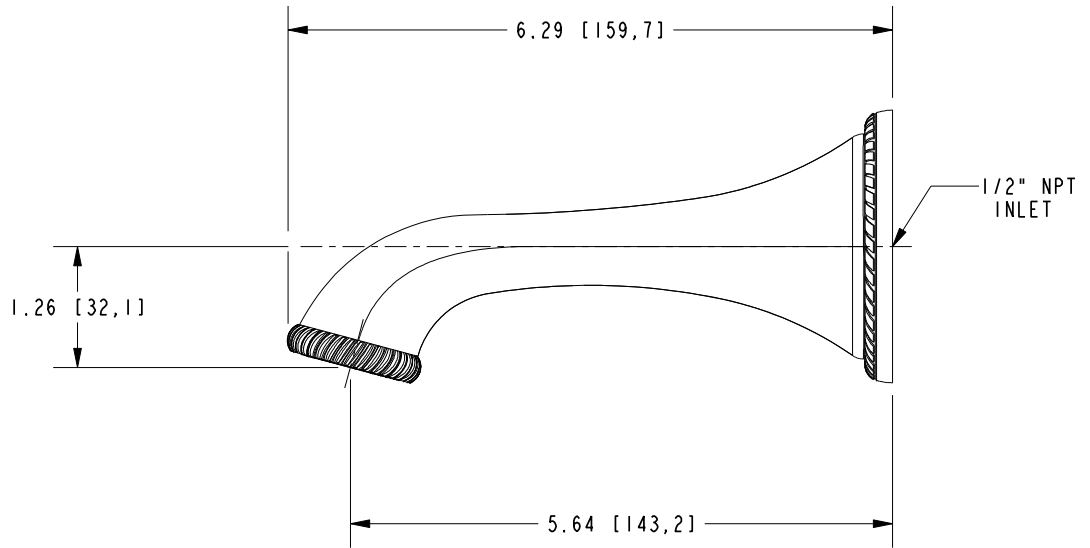
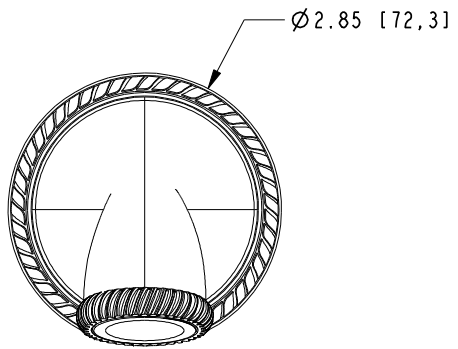

<b>BRASSTECH</b>		2001 CARNEGIE AVE. SANTA ANA, CA 92705 (949) 417-5207	
INCORPORATED			
DWG NO.	2-250	REV	C
SCALE	.500	REF.	-
		SHEET	2 OF 2