

Following these mounting instructions with the hardware included will be more than sufficient to support vanity installation.

### Vanity Installation Hardware

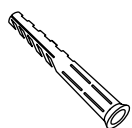

x4

Wall  
Anchor

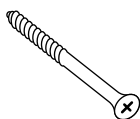

x4

Long  
Screw

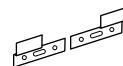

x1

Mounting  
Bracket  
Set

### Tools You May Need

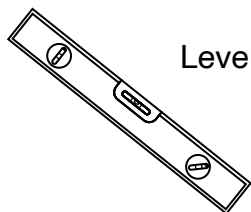

Level

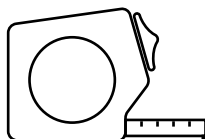

Tape  
Measure

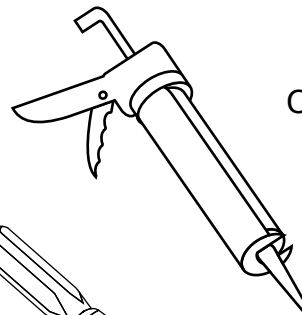

Caulk



Hammer

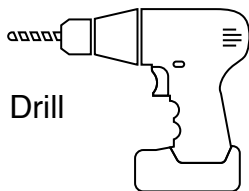

Drill

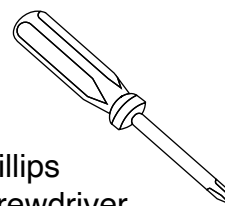

Phillips  
Screwdriver

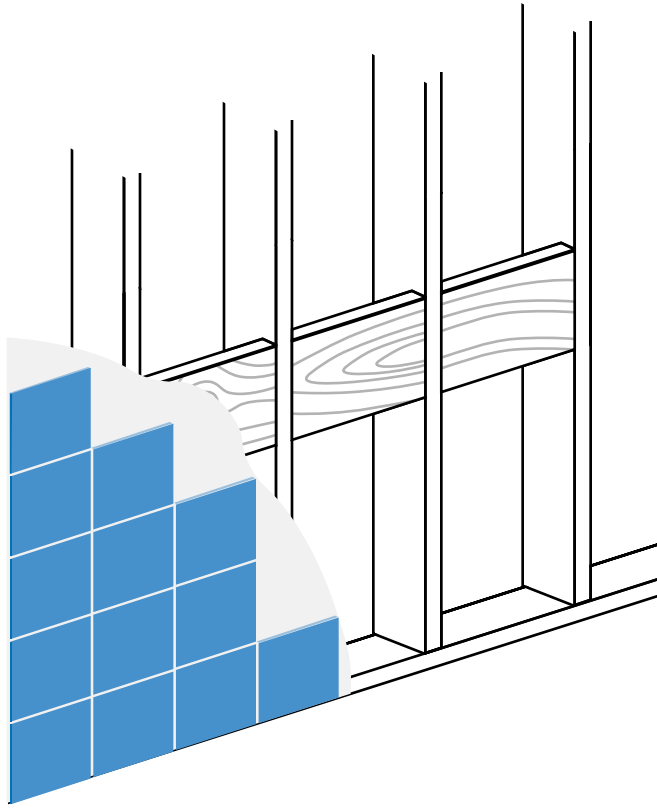

## 1. Prepare Location

---

Locate studs in the wall. If the studs do not line up with the vanity mounting brackets, be sure to add sufficient wall supports behind the finished wall.

## 2. Mount Vanity Bracket

---

Mark the desired height of the vanity on the wall. Mark the location of the vanity. Drill pilot holes and install the mounting brackets. Check position with a level.

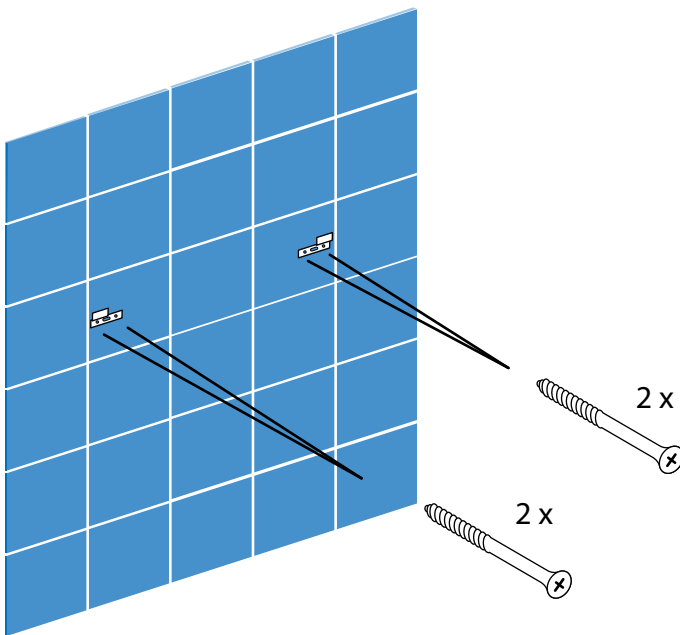

### 3. Install Vanity Base

---

Remove drawers. Rest vanity on mounting brackets. Check for level. Use a phillips head screwdriver to adjust.

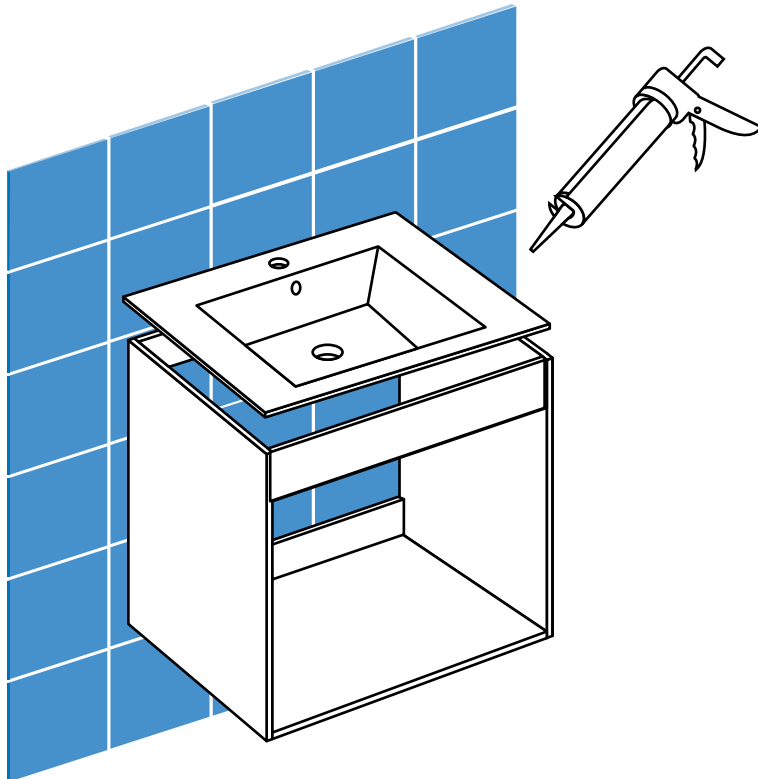
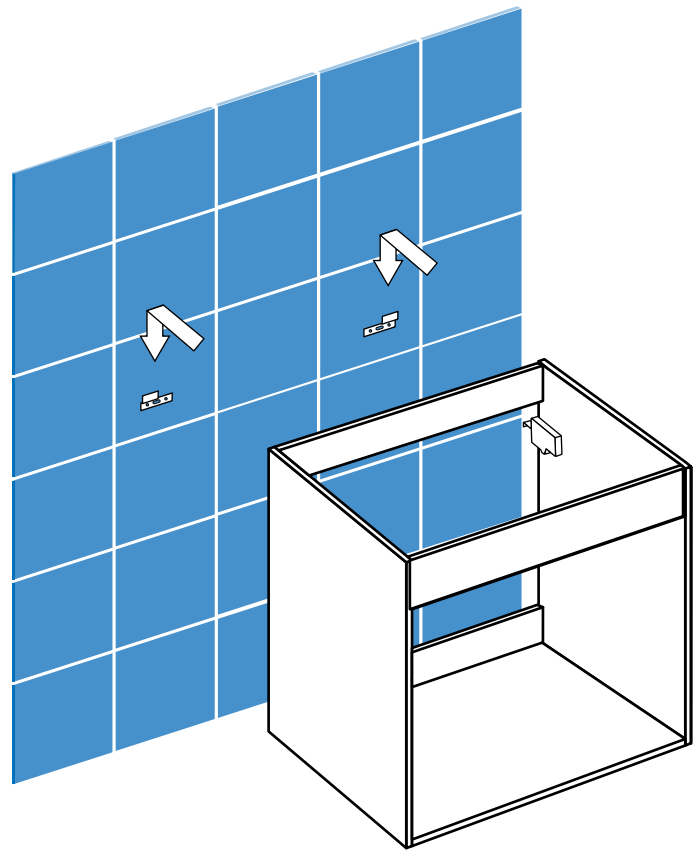
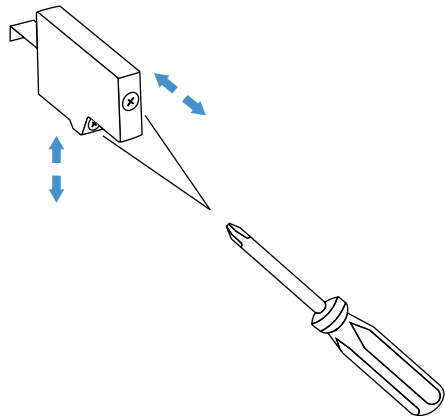

### 4. Drop in Sink

---

Install the sink with a bead of silicon and finish with a bead of caulk between the sink and wall.

## 5. Install Handles

Screw on handles with phillips screwdriver. Replace drawers.

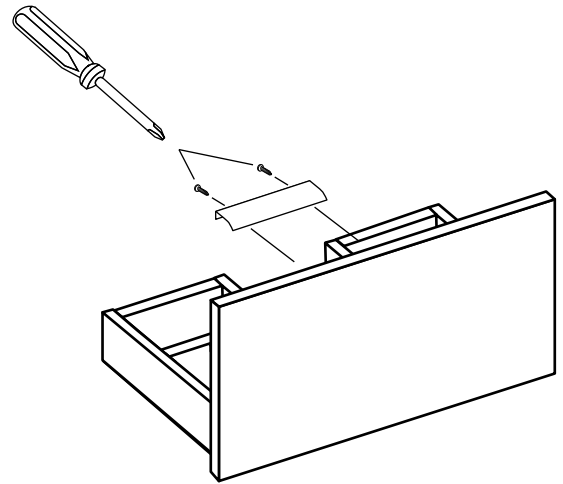
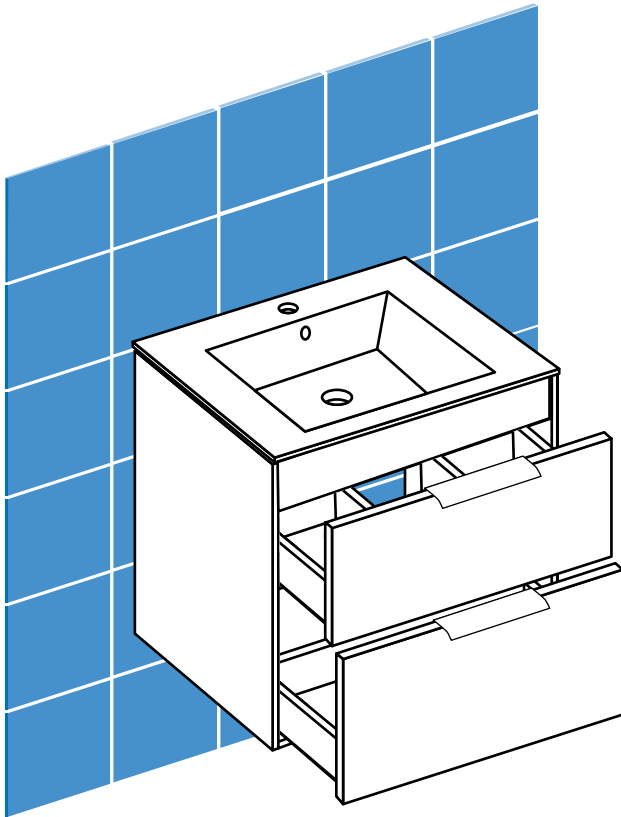

## 6. Vanity Accessories

Complete your installation by adding the preferred plumbing accessories, such as the faucet, click clack drain, p-trap and angle valves to your vanity.

