

MTI BASICS® Collection Tubs

MBXFSX5832A

58" x 32" x 22"

Acrylic Freestanding Tub

Weight 128 lbs / 58 kg

Max Fill 50 gal to overflow

NOTE: Filling this tub to the maximum may require an above average size or dedicated water heater.



Shown with faucet installed
(not supplied by MTI)



Features a 6.5" wide flat deck surface on the drain side for mounting faucetry.

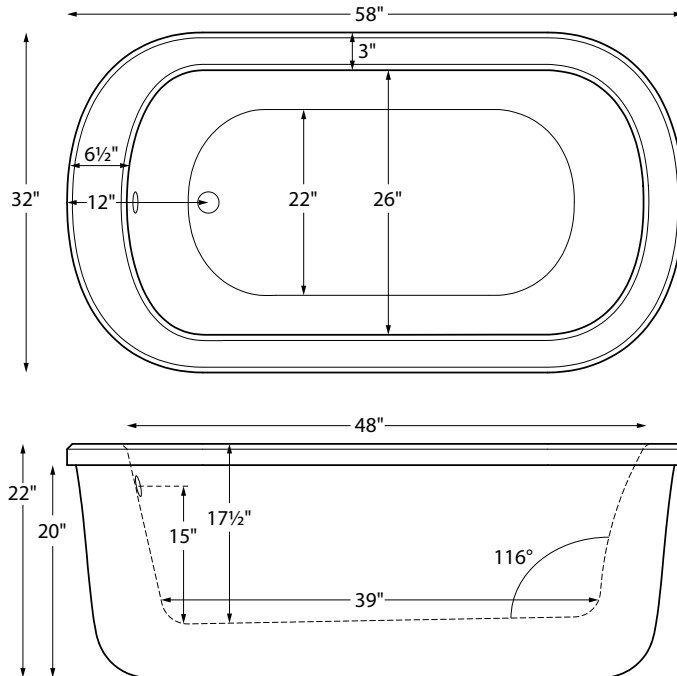

Options Must be ordered at time of purchase

Standard White (no charge)
Color Upgrade: Biscuit (MTISCOLOR)

Quick Ship / Priority Call for availability
Soaker (QSHIPMTIS)

Quick Connect Drain Kit
Standard (MBQUICK)
Cast Iron (MBQUICKCI)

Accessories

Lift and Turn Drain & Overflow
Chrome (MBWOC)
White (MBWOW)
Brushed Nickel (MBWOBN)

Pillows
Soft Pillow
White (MBPSW) Black (MBPSB)
Roll-Up Pillow
Light Aqua (MBPRUC) Black (MBRUB)

Soaker

Soaking bath - No jets. Includes pre-leveled foam base.

Part # MBXFSX5832A

Soaker with Virtual Spout

Soaking bath - No jets. Includes Virtual Spout integrated high-flow tub filler (see important ordering information), pre-leveled foam base.

Part # MBXFSX5832AVS

Wilkins Dual Check Valve, model 700XL, ASSE® Listed 1024. CSA® Certified CSA B64.6)

Anti-siphon Cash Acme Vacuum Breaker ASSE1001/CSA B64.1.1

Optional Quick Connect Drain Kit shown below.



Features a larger space underneath the tub for an above floor rough-in for quick and easy installation.

Important Ordering and Installation Information

- Designed to install on a finished floor that is flat and level.
- Features extra space to accommodate plumbing connections.
- No access panel as standard.
- May be ordered with access panel. Panel will be visible behind waste and overflow.
- The Virtual Spout is installed below the water level of the tub. Wilkins dual check valve and an Acme in-wall vent included. Some areas of the country require additional backflow prevention. Check local codes.
- Options listed cannot be combined with Designer Collection options.

• Before discarding tub crate, check for accessories that may be packaged inside.
• All product measurements are $\pm 1/2"$.
• Specifications and configurations are subject to change without notice.
• Measurements herein supersede all others published prior to publication date below.