

Melinda 10

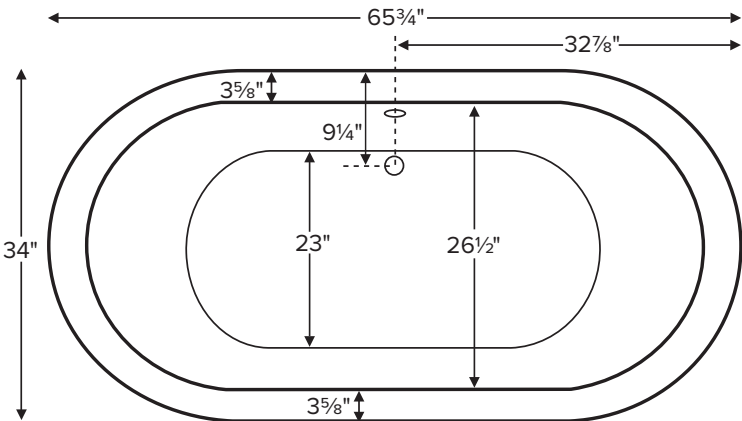

Melinda 10 is a Clawfoot tub.  
Shown above with feet powder-coated in white.  
(white is available for an upcharge)

MODEL 204		
65.75" x 34" x 24"		
FREESTANDING 80 gal to overflow		
Acrylic CXL™	DoloMatte™	
140 lbs / 64 kg	<SOAKER>	158 lbs / 72 kg
Filling this tub to the maximum may require an above average size or dedicated water heater.		



Requires use of a wall-mounted or freestanding tub filler.

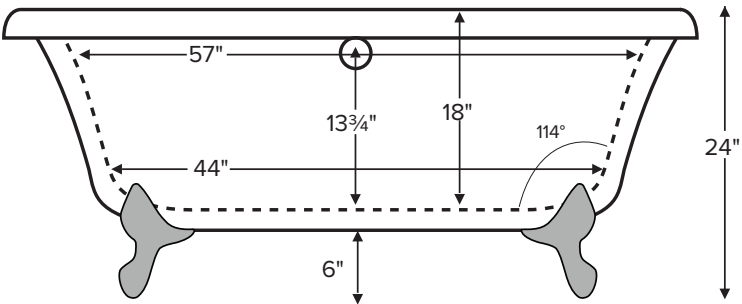

Drain Rough-In Measurements

A	B	C
1 3/4"	9 1/4"	7 1/2"

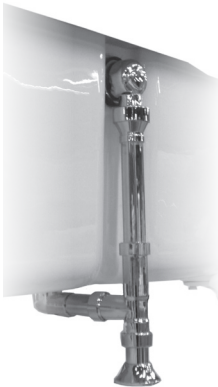
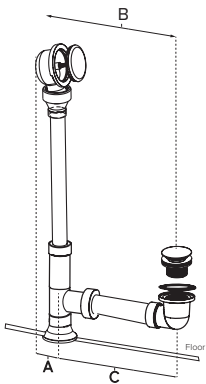

Photo of drain installation

- Before discarding tub crate, check for accessories that may be packaged inside.
- All product measurements are  $\pm 1/2"$ .
- Specifications and configurations are subject to change without notice.
- Measurements herein supersede all others published prior to publication date below.

CSA Certified C/US; ANSI Z124.1

See the Installation & Operation Manual for more details.

MTI's Customer Service:  
Monday-Friday 8am-6pm EST  
**800-783-8827** or [service@mtibaths.com](mailto:service@mtibaths.com)

IMPORTANT ORDERING & INSTALLATION INFORMATION

- Drain kit sold separately. MTI's decorative exposed drain kit is recommended to ensure a perfect fit.
- Faucet valves cannot be installed on this tub model.
- Solid brass ball and claw-design feet are standard in chrome or brushed nickel finish.
- Feet are available powder-coated in white for an upcharge.
- Additional powder-coated colors are also available, for an upcharge, and require an extended lead time. Availability based on the universal RAL color chart, see [ralcolor.com](http://ralcolor.com). Please provide RAL color code on order
- MTI's decorative exposed drain kit is recommended to ensure a perfect fit.
- Specifications and configurations are subject to change without notice.
- Measurements are  $\pm 1/2"$  and are subject to change without notice.
- Measurements herein supersede all others published prior to publication date shown below.



Melinda 10  
MODEL 204  
65.75" x 34" x 24"

Hydrotherapy Packages	Package Contents	Acrylic CXL™		DoloMatte™	
		Part #	MSRP	Part #	MSRP
Soaker	Soaking bath - no jets; clawfoot tub.	S204	\$5,950	S204DM	\$6,750

<b>Options</b> <i>Must be ordered at time of purchase.</i>
<b>Standard Colors</b> White (CWH) DoloMatte available in matte white only. Biscuit (CBS) Not available for DoloMatte. <i>Please call for availability of special colors.</i>
<b>Quick Ship</b> reduces lead time (QSPRI) <b>\$400</b> <i>Please call for availability</i>
<b>Textured, Slip-Resistant Bottom</b> (TXTBTM) <b>\$105</b>
<b>Clawfoot Color Options</b> <ul style="list-style-type: none"> <li>• Chrome (CLAWC), Brushed Nickel (CLAWBN) - no charge</li> <li>• Powder Coated White upcharge (CLAWWH) - <b>\$835</b></li> <li>• Additional Powder Coated Colors upcharge (CLAWSF) - <b>\$2,145</b>  Availability based on the universal RAL color chart  see ralcolor.com.  Please provide RAL color code on order</li> </ul>
<b>Drain Kit - Toe Tap Design with Decorative Exposed Piping</b> <ul style="list-style-type: none"> <li>• Chrome (DKSSCS) <b>\$845</b></li> <li>• Brushed Nickel (DKSSBNS) <b>\$935</b></li> </ul>

Accessories	
Pillows from <b>\$150</b>	
Teak Bath Mat (TKMAT3018) <b>\$740</b> <i>Custom sizes also available. Contact MTI for details and pricing.</i>	
Floor-Mounted High-Flow Tub Filler two designs available	
Contemporary Chrome (FILLC) <b>\$1,480</b> Brushed Nickel (FILLBN) <b>\$1,710</b>	Traditional Chrome (FILLTC) <b>\$1,505</b> Brushed Nickel (FILLTBN) <b>\$1,745</b>
Faucet Stand SculptureStone® Standard	
Small 3-hole capacity <b>14¼" w x 21¾" h</b> Matte (STAND) <b>\$670</b>	Large 5-hole capacity <b>22" w x 21¾" h</b> Matte (STANDL) <b>\$790</b>
+ <b>\$400 gloss finish upcharge</b> (SSGLOSSNK)	