

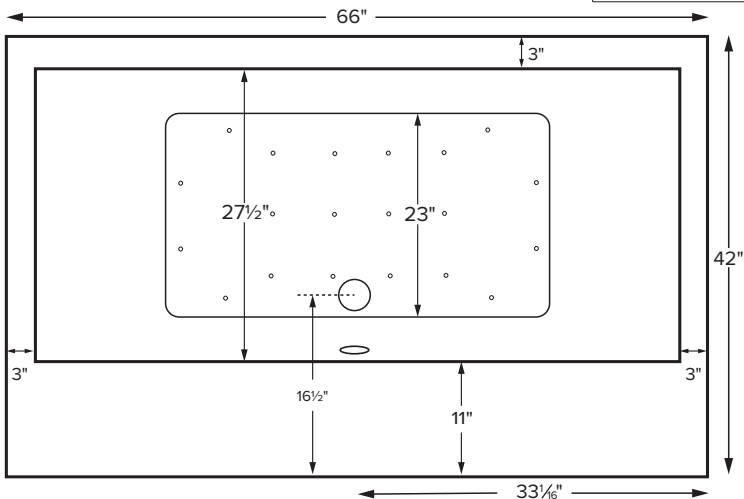

Available as a freestanding model or finished on 1, 2 or 3 sides for various installation applications.

Metro 3  
with Sculpted Finish®

MODEL 175A		
66 x 42" x 24"		
FREESTANDING or ALCOVE 80 gal to overflow		
Acrylic CXL™	DoloMatte™	
160 lbs / 73 kg	<SOAKER>	180 lbs / 82 kg
Filling this tub to the maximum may require an above average size or dedicated water heater.		



Features a flat 11" deck surface on the drain side for mounting faucetry. Drain kit sold separately.  
Shown as Air Bath

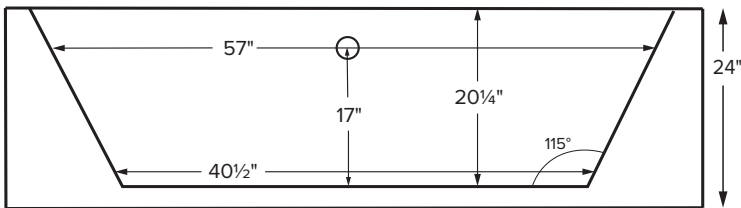

ELECTRICAL COMPONENTS & SPECIFICATIONS

Hydrotherapy Package	Components Included	GFCI/110V
Microbubbles	Microbubbles pump	1-15 amp
Air Massage	heated blower	1-15 amp
Microbubbles with Air	Microbubbles pump, heated blower	1-20 amp
Air Massage Elite	heated blower, chromatherapy	1-15 amp
Microbubbles with Air Elite	Microbubbles pump, heated blower, chromatherapy	2-15 amp

Electrical requirements may change with the addition of optional therapy components. For more information go to [mtibaths.com](http://mtibaths.com).

CSA Certified C/US; ANSI Z124.1  
CSA Certified C/US; ANSI 112.19.7

See the Installation & Operation Manual for more details.  
MTI's Customer Service: Monday-Friday 8am-6pm EST  
800-783-8827 or [service@mtibaths.com](mailto:service@mtibaths.com)

- Options and accessories may be packaged inside the tub crate. Always check packaging before discarding.
- All product measurements are  $\pm 1/2"$ .
- Specifications and configurations are subject to change without notice.
- Measurements herein supersede all others published prior to publication date below.

CSA # MTDS-175A

CSA # MTDS-175D

©2022 by MTI Baths, Inc. Modification Rights Reserved

IMPORTANT ORDERING & INSTALLATION INFORMATION

- Before ordering or installing, please consider future access to equipment.
- Unless ordering Sculpted Finish on 4 sides, please include a diagram specifying which sides will need to be finished, along with location of optional tile flange(s).
- Drain is not included with this tub model.
- When ordering an air bath, the air blower must be remote mounted.
- Microbubbles system components must be installed on a non-Sculpted Finish side. Components will extend beyond the perimeter of the tub. Call MTI for specific details regarding the desired installation before placing the order.
- Radiance placed on floor locations will affect placement of air jets.
- Hydrotherapy equipment may ship loose for remote installation. See package content on the following page for details. Specifications and configurations are subject to change without notice.



For more information on hydrotherapy packages  
please visit: [mtibaths.com/wellness/](https://mtibaths.com/wellness/)

**Metro 3**  
with Sculpted Finish®  
MODEL 175A  
66 x 42" x 24"

Hydrotherapy Packages	Package Contents	Sculpted Finish Sides	Acrylic CXL™		DoloMatte™	
			Part #	MSRP	Part #	MSRP
Soaker	Soaking bath - no jets, pre-leveled foam base	4-sides sculpted	<b>S175A4</b>	<b>\$9,465</b>	<b>S175D4</b>	<b>\$10,215</b>
		3-sides sculpted	<b>S175A3</b>	<b>\$8,750</b>	<b>S175D3</b>	<b>\$9,500</b>
		2-sides sculpted	<b>S175A2</b>	<b>\$7,045</b>	<b>S175D2</b>	<b>\$7,795</b>
		1-side sculpted	<b>S175A1</b>	<b>\$6,625</b>	<b>S175D1</b>	<b>\$7,375</b>
Microbubbles	1 infusion port, microbubbles pump, pre-leveled foam base	4-sides sculpted	n/a	n/a	n/a	n/a
		3-sides sculpted	<b>M175A3</b>	<b>\$12,070</b>	<b>M175D3</b>	<b>\$12,820</b>
		2-sides sculpted	<b>M175A2</b>	<b>\$10,365</b>	<b>M175D2</b>	<b>\$11,115</b>
		1-side sculpted	<b>M175A1</b>	<b>\$9,945</b>	<b>M175D1</b>	<b>\$10,695</b>
Air Massage	20 air jets, heated air blower, pre-leveled foam base	4-sides sculpted	<b>AST175A4</b>	<b>\$13,115</b>	<b>AST175D4</b>	<b>\$13,865</b>
		3-sides sculpted	<b>AST175A3</b>	<b>\$12,400</b>	<b>AST175D3</b>	<b>\$13,150</b>
		2-sides sculpted	<b>AST175A2</b>	<b>\$10,695</b>	<b>AST175D2</b>	<b>\$11,445</b>
		1-side sculpted	<b>AST175A1</b>	<b>\$10,275</b>	<b>AST175D1</b>	<b>\$11,025</b>
Air Massage Elite	30 air jets, heated air blower, Chromatherapy LED lighting, Spa Mode, pre-leveled foam base	4-sides sculpted	<b>AE175A4</b>	<b>\$15,015</b>	<b>AE175D4</b>	<b>\$15,765</b>
		3-sides sculpted	<b>AE175A3</b>	<b>\$14,300</b>	<b>AE175D3</b>	<b>\$15,050</b>
		2-sides sculpted	<b>AE175A2</b>	<b>\$12,595</b>	<b>AE175D2</b>	<b>\$13,345</b>
		1-side sculpted	<b>AE175A1</b>	<b>\$12,175</b>	<b>AE175D1</b>	<b>\$12,925</b>
Microbubbles with Air Massage	1 infusion port, microbubbles pump, 20 air jets, heated air blower, pre-leveled foam base	4-sides sculpted	n/a	n/a	n/a	n/a
		3-sides sculpted	<b>ASTM175A3</b>	<b>\$15,120</b>	<b>ASTM175D3</b>	<b>\$15,870</b>
		2-sides sculpted	<b>ASTM175A2</b>	<b>\$13,415</b>	<b>ASTM175D2</b>	<b>\$14,165</b>
		1-side sculpted	<b>ASTM175A1</b>	<b>\$12,995</b>	<b>ASTM175D1</b>	<b>\$13,745</b>
Microbubbles with Air Massage Elite	1 infusion port, microbubbles pump, 30 air jets, heated air blower, Chromatherapy LED lighting, Spa Mode, pre-leveled foam base	4-sides sculpted	n/a	n/a	n/a	n/a
		3-sides sculpted	<b>AEM175A3</b>	<b>\$16,920</b>	<b>AEM175D3</b>	<b>\$17,670</b>
		2-sides sculpted	<b>AEM175A2</b>	<b>\$15,215</b>	<b>AEM175D2</b>	<b>\$15,965</b>
		1-side sculpted	<b>AEM175A1</b>	<b>\$14,795</b>	<b>AEM175D1</b>	<b>\$15,545</b>

**Microbubbles system components must be installed on a non-Sculpted Finish® side.**

**Components will extend beyond the perimeter of the tub. Call MTI for specific details regarding the desired installation before placing order.**

For more customized applications, additional hydrotherapies may possibly be integrated in Sculpted Finish® tubs, depending on the types of therapy and the installation application. Visit [mtibaths.com](https://mtibaths.com) or call MTI at 800.783.8827.

## RECOMMENDED SENSORY THERAPIES

### Chromatherapy

(LE) **\$800** underwater lighting  
2 LED lights included

### Audiotherapy

(STEREOBT) **\$1,390** 2 transducers  
with bluetooth and amplifier  
(BTREMOTE) **\$600** bluetooth remote

(STEREOH202) **\$1,575** 4 transducers  
amplifier not included

### Thermaltherapy

(RAD100) **\$1,595** Radiance®  
2 heated zones included  
Zones may be specified  
on Metro tub deck.



For more information on options and accessories go to Acrylic Tub Options on [mtibaths.com](http://mtibaths.com)

Metro 3 with Sculpted Finish®  
MODEL 175A

Options <i>Must be ordered at time of purchase.</i>	
<b>Standard Color</b> White (CWH)	
<b>Textured, Slip-Resistant Bottom</b> (TXTBTM) <b>\$105</b> Compliant with ASTM C 1028-07 friction coefficient.	
<b>Ozonator</b> (OZONE) <b>\$515</b>	
<b>Virtual Spout</b> high-flow integrated tub filler (FPMJ) <b>\$450</b> <i>Must be located on same side as tub deck. Specify location when ordering.</i>	
Installation Options <i>Must be ordered at time of purchase.</i>	
<b>Tile Flange</b> Factory Installed rigid ABS 1 Side (TFK1) <b>\$175</b> 2 Sides (TFK2) <b>\$185</b> 3 Sides (TFK3) <b>\$200</b> Field Install Kit (TFKNI) <b>\$185</b> Includes rigid ABS & adhesive	

**IMPORTANT:** *Must specify flange location(s) on order of Factory-Installed Flange.*

Accessories	
<b>Pillows from \$180</b>	
<b>Teak Bath Mat</b> (TKMAT3018) <b>\$815</b> <i>Custom sizes also available. Contact MTI for details and pricing.</i>	
<b>Teak Tub Tray</b> Slatted (TK-TRAY1) <b>\$500</b> Solid (TK-TRAY2) <b>\$570</b>	
<b>Floor-Mounted High-Flow Tub Filler</b> two designs available	
Contemporary Chrome (FILLC) <b>\$1,480</b> Brushed Nickel (FILLBN) <b>\$1,710</b>	Traditional Chrome (FILLTC) <b>\$1,505</b> Brushed Nickel (FILLTBN) <b>\$1,745</b>

## Drains & Overflow Kits *Toe Tap Rectangular Overflow must be ordered at time of purchase*

<b>Cable Driven</b>	
<b>Drain Finishes</b> – PVC Drain Kit	
White/Bone/Biscuit (WOCDW) <b>\$440</b>	
Chrome (WOCD) <b>\$410</b>	
Brushed Nickel (WOCDN) <b>\$490</b>	
Polished Nickel (WOCDPN) <b>\$540</b>	
Oil-Rubbed Bronze <sup>†</sup> (WOCDOR) <b>\$550</b>	
Polished Brass (WOCDBR) <b>\$690</b>	
Special Finishes* (WOCDSF) <b>\$1,135</b>	
<i>MTI does not offer a brass body cable drain kit.</i>	
<b>Lift &amp; Turn</b>	
<b>Drain Finishes</b> – PVC Drain Kit	
Chrome (WOC) <b>\$185</b>	
White (WOW) <b>\$245</b>	
Brushed Nickel (WOBN) <b>\$305</b>	

<b>Toe Tap</b>	
<b>Round Overflow</b> – PVC Drain Kit	
Chrome (WOTTC) <b>\$380</b>	
Brushed Nickel (WOTTBN) <b>\$385</b>	
Polished Nickel (WOTTPN) <b>\$385</b>	
Special Finishes* (WOTTSF) <b>\$1,145</b>	
<b>Round Overflow</b> – Solid Brass Drain	
Chrome (WOTTSBC) <b>\$810</b>	
Brushed Nickel (WOTTSBBN) <b>\$810</b>	
Polished Nickel (WOTTSBPN) <b>\$810</b>	
<b>Rectangular Overflow</b> – PVC Drain Kit	
Chrome (WOTRC) <b>\$470</b>	
Brushed Nickel (WOTRBN) <b>\$430</b>	
White (WOTRW) <b>\$525</b>	

## Slim-Line Overflow with Toe Tap Drain *Must be ordered at time of purchase.*

- Low profile overflow is factory installed
- Overflow measures 4.5" x 1"
- Provides a deeper soak
- Not available for commercial applications

<b>Slim-Line Overflow with Toe Tap Drain</b>	
PVC Drain	
Chrome (SLOT) <b>\$500</b>	
Brushed Nickel (SLOTBN) <b>\$530</b>	
Polished Nickel (SLOTPN) <b>\$555</b>	
White (SLOTW) <b>\$430</b>	

<b>Slim-Line Overflow with Toe Tap Drain</b>	
Solid Brass Drain	
Chrome (SLOTSBC) <b>\$930</b>	
Brushed Nickel (SLOTSBBN) <b>\$935</b>	
Polished Nickel (SLOTSBPN) <b>\$935</b>	
White (SLOTSBW) <b>\$965</b>	



Optional Slim-Line overflow

<sup>†</sup> MTI has selected an oil-rubbed bronze finish that is compatible with Delta and many other manufacturers. To ensure best match, order as a Special Finish and submit a sample.  
\* Allow 2-4 weeks lead time for Special Finishes. Send sample for best match.