

Melinda 10

MODEL #: 204
65.75" x 34" x 24"



Melinda 10 is a Clawfoot tub.
Shown above with feet powder-coated in white.
(white is available for an upcharge)

GENERAL SPECIFICATIONS

Material - Acrylic

Installation - Freestanding

Soaker Weight - 140 lbs / 64 kg

Maximum Fill - 80 gal to overflow

NOTE: Filling this tub to the maximum may require an above average size or dedicated water heater.

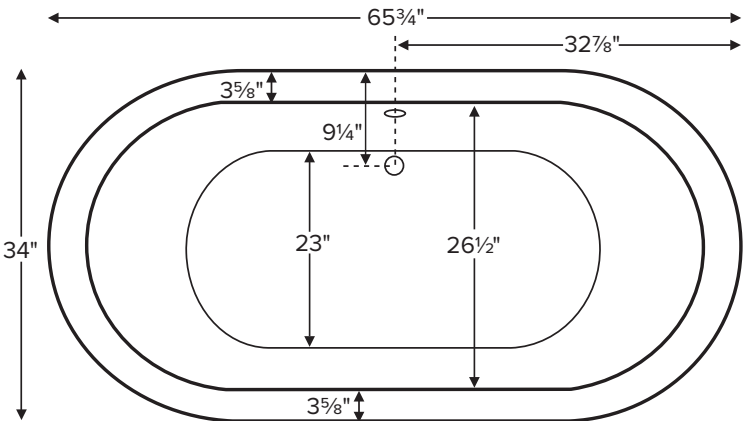

Drain Rough-In
Measurements

A	B	C
1 3/4"	9 1/4"	7 1/2"

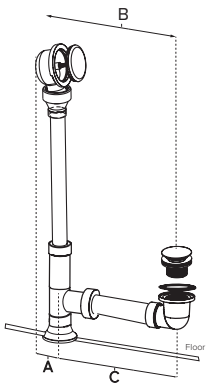

Requires use of a wall-mounted or freestanding tub filler.

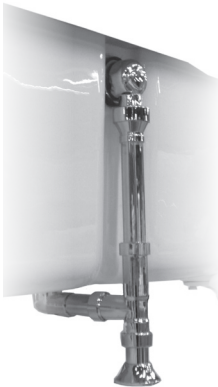
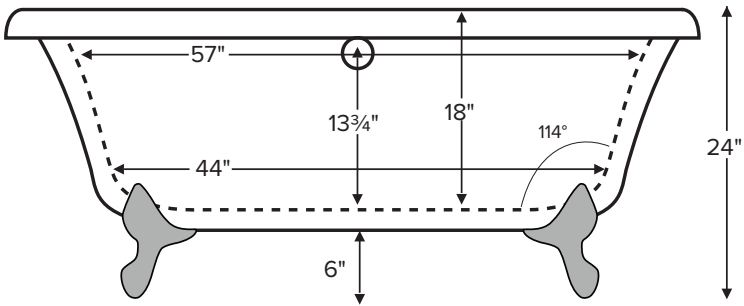

Photo of drain installation

- Before discarding tub crate, check for accessories that may be packaged inside.
- All product measurements are $\pm 1/2"$.
- Specifications and configurations are subject to change without notice.
- Measurements herein supersede all others published prior to publication date below.

CSA Certified C/US; ANSI Z124.1

See the [Installation & Operation Manual](#) for more details.

MTI's Customer Service:
Monday-Friday 8am-6pm EST
800-783-8827 or service@mtibaths.com

IMPORTANT ORDERING & INSTALLATION INFORMATION

- Drain kit sold separately. MTI's decorative exposed drain kit is recommended to ensure a perfect fit.
- Faucet valves cannot be installed on this tub model.
- Solid brass ball and claw-design feet are standard in chrome or brushed nickel finish.
- Feet are available powder-coated in white for an upcharge.
- Additional powder-coated colors are also available, for an upcharge, and require an extended lead time. Availability based on the universal RAL color chart, see ralcolor.com. Please provide RAL color code on order
- MTI's decorative exposed drain kit is recommended to ensure a perfect fit.
- Specifications and configurations are subject to change without notice.
- Measurements are $\pm 1/2"$ and are subject to change without notice.
- Measurements herein supersede all others published prior to publication date shown below.



Melinda 10
MODEL #: 204
65.75" x 34" x 24"

Hydrotherapy Packages	Package Contents	Part #	MSRP
Soaker	Soaking bath - no jets; clawfoot tub.	S204	\$5,055

Options

Must be ordered at time of purchase.

Standard Colors White (CWH)
Biscuit (CBS)

Please call for availability of special colors.

Quick Ship reduces lead time (QSPRI) **\$380**

Please call for availability

Textured, Slip-Resistant Bottom (TXTBTM) **\$100**
Compliant with ASTM C 1028-07 friction coefficient.

Clawfoot Color Options

- Chrome (CLAWC), Brushed Nickel (CLAWBN) - no charge
- Powder Coated White upcharge (CLAWWH) - \$795
- Additional Powder Coated Colors upcharge (CLAWSF) - \$2,045
Availability based on the universal RAL color chart
see ralcolor.com.
Please provide RAL color code on order

Drain Kit - Toe Tap Design with Decorative Exposed Piping

- Chrome (DKSSC) \$805
- Brushed Nickel (DKSSBN)

Accessories

Pillows from \$145

Teak Bath Mat (TKMAT3018) **\$390**

Custom sizes also available. Contact MTI for details and pricing.

Floor-Mounted High-Flow Tub Filler two designs available

Contemporary Chrome (FILLC) \$1,680 Brushed Nickel (FILLBN) \$1,850	Traditional Chrome (FILLTC) \$1,680 Brushed Nickel (FILLTBN) \$1,845
---	--

Faucet Stand SculptureStone® Standard

Small 3-hole capacity
14¼" w x 21¾" h
Matte (STAND) **\$515**

Large 5-hole capacity
22" w x 21¾" h
Matte (STANDL) **\$610**

+\$310 gloss finish upcharge (SSGLOSSENK)