

Parisian® 2

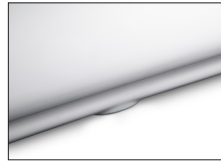

Back of tub designed to accommodate rear drain.

MODEL 178	
72" x 40" x 23.375"	
FREESTANDING 87 gal to overflow	
Acrylic CXL™	DoloMatte™
280 lbs / 127 kg	<SOAKER> 315 lbs / 143 kg
Filling this tub to the maximum may require an above average size or dedicated water heater.	

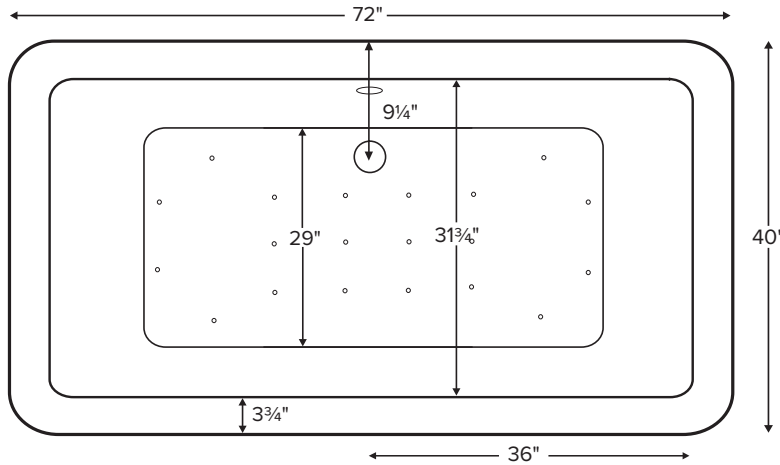

**IMPORTANT:**  
Must have access to the drain from underneath the tub for installation and servicing.

Drain Rough-In Measurements

A	B	C
4 1/2"	9 1/4"	4 3/4"

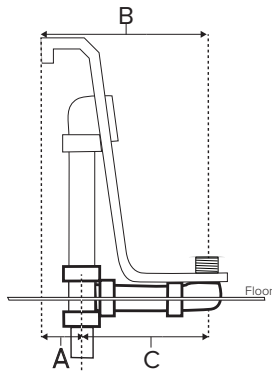

Requires use of a wall-mounted or freestanding tub filler.  
Shown with Air Massage Package.

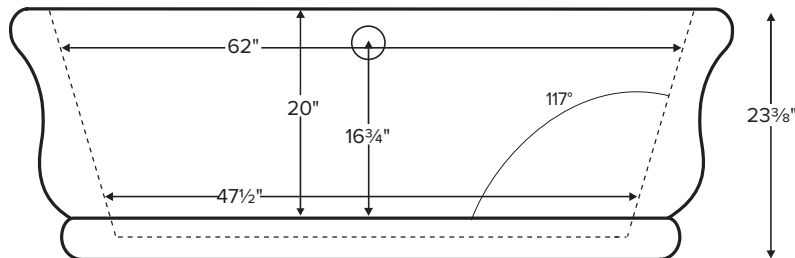

**ELECTRICAL COMPONENTS & SPECIFICATIONS**

Hydrotherapy Package	Components Included	110V GFCI
Air Massage	heated blower	1-15 amp
Air Massage Elite	heated blower, chromatherapy	1-15 amp

Electrical requirements may change with the addition of optional therapy components.  
See specific option details or installation information.  
CSA Certified C/US; ANSI Z124.1 and ANSI 112.19.7

**IMPORTANT ORDERING & INSTALLATION INFORMATION:**

- Before ordering or installing, please consider future access to equipment.
- No access panel. Tub features factory installed overflow with toe tap drain.
- Air baths require job site preparations for remote mounting the blower and required check valve. Check valve must be installed higher than the rim of the tub.
- Hydrotherapy equipment may ship loose for remote installation depending on tub model. See package content on the following page for details.
- Radiance placed on floor locations will affect placement of air jets.
- Faucet valves cannot be installed on this tub model.
- All tubs are in accordance with CSA B45.5/APMO Z124 standard and compliant with ASTM C 1028-07 coefficient of friction. Dolomatte meets ANSI A137.1/A326.3 coefficient of friction and AS HB198:2014 pendulum slip resistance testing.

- Before discarding tub crate, check for accessories that may be packaged inside.
- All product measurements are ±1/2".
- Specifications and configurations are subject to change without notice.
- Measurements herein supersede all others published prior to publication date below.

See the Installation & Operation Manual for more details.  
MTI's Customer Service: Monday-Friday 8am-6pm EST  
**800-783-8827** or service@mtibaths.com



Parisian® 2

MODEL 178

72" x 40" x 23.375"

Hydrotherapy Packages	Package Contents	Acrylic CXL™		DoloMatte™	
		Part #	MSRP	Part #	MSRP
Soaker	Soaking bath - no jets; includes a pre-leveled foam base and factory-installed overflow with toe-tap drain kit in chrome.	<b>S178</b>	<b>\$11,705</b>	<b>S178DM</b>	<b>\$12,505</b>
Air Massage	20 air jets, heated air blower, pre-leveled foam base and factory-installed overflow with toe-tap drain kit in chrome. Blower and control boxes must be remote located.	<b>AST178</b>	<b>\$15,355</b>	<b>AST178DM</b>	<b>\$16,155</b>
Air Massage Elite	30 air jets, heated air blower, Chromatherapy LED lighting, Spa Mode, pre-leveled foam base and factory-installed overflow with toe-tap drain kit in chrome. Blower and control boxes must be remote located.	<b>AE178</b>	<b>\$17,255</b>	<b>AE178DM</b>	<b>\$18,055</b>

RECOMMENDED SENSORY THERAPIES

**Chromatherapy**

(LE) **\$800** underwater lighting  
2 LED lights included

**Audiotherapy**

(STEREOBT) **\$1,390** 2 transducers  
with bluetooth and amplifier  
(BTREMOTE) **\$600** bluetooth remote

(STEREOH202) **\$1,575** 4 transducers  
amplifier not included

**Thermltherapy**

(RAD100) **\$1,595** Radiance®  
2 heated zones included

**Options** *Must be ordered at time of purchase.*

**Standard Colors** White (CWH)

*Please call for availability of special colors.*

**Quick Ship** reduces lead time (QSPRI) **\$430**

*Please call for availability*

**Textured, Slip-Resistant Bottom** (TXTBTM) **\$105**

**Accessories**

**Pillows from \$180**

**Teak Bath Mat** (TKMAT3018) **\$815**

*Custom sizes also available. Contact MTI for details and pricing.*

**Floor-Mounted High-Flow Tub Filler** two designs available

Contemporary

Chrome (FILLC) **\$1,480**

Brushed Nickel (FILLBN) **\$1,710**

Traditional

Chrome (FILLTC) **\$1,505**

Brushed Nickel (FILLTBN) **\$1,745**

**Faucet Stand** SculptureStone® Standard

**Small** 3-hole capacity

**14¼" w x 21¾" h**

Matte (STAND) **\$725**

**Large** 5-hole capacity

**22" w x 21¾" h**

Matte (STANDL) **\$855**

**+\$430 gloss finish upcharge** (SSGLOSSSNK)

**Drains & Overflow Kits** *Must be ordered at time of purchase*

**Toe Tap with Round Overflow** – PVC Drain Kit

*Overflow is factory installed*

Chrome (WOTTC) included

Brushed Nickel (WOTTBNU) substitute free of charge

**Finish Upcharge**

White (WOTTWU) **\$35**

Polished Nickel (WOTTENU) **\$60**

Oil-Rubbed Bronze+ (WOTTORU) **\$65**

Special Finishes+ (WOTTSFU) **\$790**

