

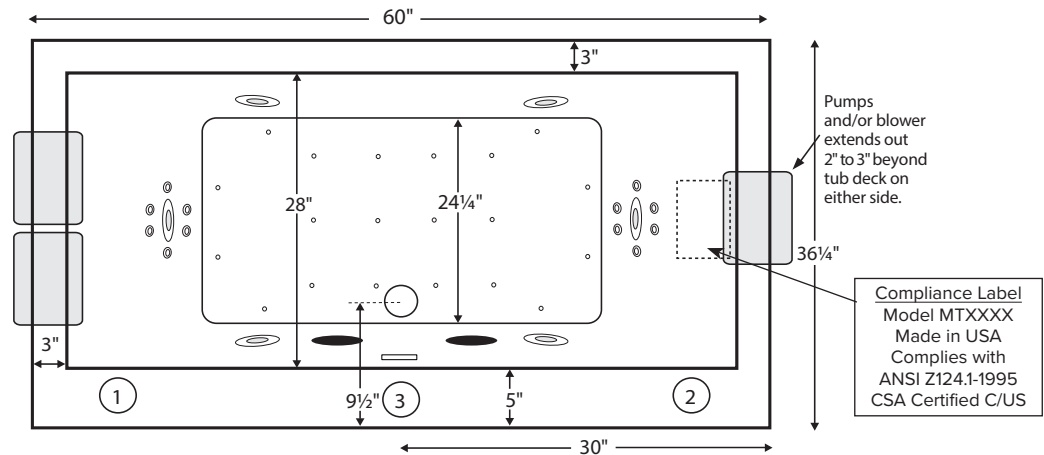

Designer Collection Tubs

Kahlo 1

MODEL 119		
60" x 36.25" x 19.5"		
DROP-IN or UNDERMOUNT 72 gal to overflow		
Acrylic CXL™	DoloMatte™	
85 lbs / 39 kg	<SOAKER>	96 lbs / 44 kg
115 lbs / 52 kg	<PLUMBED>	126 lbs / 57 kg
Filling this tub to the maximum may require an above average size or dedicated water heater.		



The tub features a round integrated overflow with direct toe tap drain connection directly above rough-in pipe. Numbered areas on tub deck represent possible locations to install cleaning systems, faucets and other fixtures. Shown with Air Massage and Ultra Whirlpool Package.

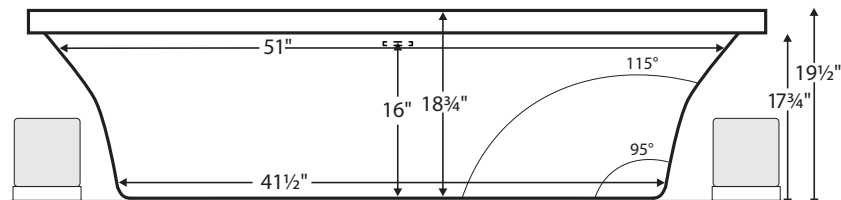

IMPORTANT ORDERING & INSTALLATION INFORMATION

- Before ordering or installing, please consider future access to equipment.
- Add proper bedding compound to fully level and support bottom of tub.
- When equipped with an air bath package, pre-leveled foam base or frame system, overall tub height is increased by approx. 2-3" and is designed to install on a flat, level subfloor.
- Radiance placed on airbath floor will affect placement of air jets.
- System components may extend beyond the perimeter of deck.
- Please measure tub **on-site** before building tub decking.
- Advise MTI when planning to use a glass enclosure. Relocation of controls may be necessary.
- Suction and control locations may vary.

ELECTRICAL COMPONENTS & SPECIFICATIONS

Hydrotherapy Package	Components Included	GFCI / 110V
Standard Whirlpool	2-bhp pump	1-15 amp
Stream Bath	1/2-bhp, ozone	1-20 amp
Microbubbles	Microbubbles pump	1-15 amp
Ultra Whirlpool	2-bhp pump x 2, inline heater, ozone	2-20 amp
Air Massage	heated blower	1-15 amp
Air Massage Elite	heated blower, chromatherapy	1-15 amp
Air Massage w/ Stream Bath	1/2-bhp pump, heated blower, ozone	1-20 amp
Air Massage Elite w/ Stream Bath	1/2-bhp pump, heated blower, chromatherapy, ozone	1-20 amp

Electrical requirements may change with the addition of optional therapy components. See specific option details or installation information.
CSA Certified C/US; ANSI Z124.1 and ANSI 112.19.7

Hydrotherapy Package	Components Included	GFCI / 110V
Microbubbles with Air	Microbubbles pump, heated blower	1-20 amp
Microbubbles with Air Elite	Microbubbles pump, heated blower, chromatherapy	2-15 amp
Air with Whirlpool	2-bhp pump, heated blower	2-15 amp
Air with Ultra Whirlpool	2-bhp pump x 2, inline heater, heated blower, ozone	2-20 amp
Air Elite with Whirlpool	2-bhp pump, heated blower, chromatherapy	2-15 amp
Air Elite with Ultra Whirlpool	2-bhp pump x 2, inline heater, heated blower, chromatherapy, ozone	2-20 amp

See the Installation & Operation Manual for more details.
MTI's Customer Service Monday-Friday 8am-6pm EST
800-783-8827 or service@mtibaths.com

- Before discarding tub crate, check for accessories that may be packaged inside.
- All product measurements are $\pm 1/2"$.
- Specifications and configurations are subject to change without notice.
- Measurements herein supersede all others published prior to publication date below.



- Aromatherapy is eliminated for undermount applications
- Air Baths, Pre-Leveled Foam Base or Frame Systems increase overall height by 2-3".

Kahlo 1
MODEL 119
60" x 36.25" x 19.5"

Hydrotherapy Packages	Package Contents	Acrylic CXL™		DoloMatte™	
		Part #	MSRP	Part #	MSRP
Soaker	Soaking bath - no jets	S119-DI	\$2,930	S119DM-DI	\$3,530
		S119-UM		S119DM-UM	
Stream Bath	6 side vents, 2 end vents, 1/2 bhp pump, Ozone	SM119-DI	\$5,475	SM119DM-DI	\$6,075
		SM119-UM		SM119DM-UM	
Microbubbles	1 microbubbles infusion port and pump	M119-DI	\$6,250	M119DM-DI	\$6,850
		M119-UM		M119DM-UM	
Air Massage	20 air jets, heated air blower, Aromatherapy, pre-leveled foam base	AST119-DI	\$6,580	AST119DM-DI	\$7,180
		AST119-UM		AST119DM-UM	
Air Massage Elite	30 air jets, heated air blower, Aromatherapy, Chromatherapy LED lighting, Spa Mode, pre-leveled foam base	AE119-DI	\$8,480	AE119DM-DI	\$9,080
		AE119-UM		AE119DM-UM	
Stream Bath with Air Massage	6 side vents, 2 end vents, 1/2 bhp pump, Ozone, 20 air jets, heated air blower, Aromatherapy, pre-leveled foam base	ASTSM119-DI	\$8,625	ASTSM119DM-DI	\$9,225
		ASTSM119-UM		ASTSM119DM-UM	
Stream Bath with Air Massage Elite	6 side vents, 2 end vents, 1/2 bhp pump, Ozone, 30 air jets, heated air blower, Aromatherapy, Chromatherapy LED lighting, Spa Mode, pre-leveled foam base	AESM119-DI	\$10,725	AESM119DM-DI	\$11,325
		AESM119-UM		AESM119DM-UM	
Microbubbles with Air Massage	1 microbubbles infusion port and pump, 20 air jets, heated air blower, Aromatherapy, pre-leveled foam base	ASTM119-DI	\$9,300	ASTM119DM-DI	\$9,900
		ASTM119-UM		ASTM119DM-UM	
Microbubbles with Air Massage Elite	1 microbubbles infusion port and pump, 30 air jets, heated air blower, Aromatherapy, Chromatherapy LED lighting, Spa Mode, pre-leveled foam base	AEM119-DI	\$11,100	AEM119DM-DI	\$11,700
		AEM119-UM		AEM119DM-UM	
Standard Whirlpool	6 point-massage jets, 2-bhp pump	P119-DI	\$5,295	P119DM-DI	\$5,895
		P119-UM		P119DM-UM	
Ultra Whirlpool	6 point-massage jets, 12 micro-jets with Tsubo massage, 2 2-bhp pumps, inline heater, Ozone	P119U-DI	\$7,290	P119UDM-DI	\$7,890
		P119U-UM		P119UDM-UM	
Air Massage with Standard Whirlpool	6 point-massage jets, 2-bhp pump, 20 air jets, heated air blower, Aromatherapy, pre-leveled foam base	AW119-DI	\$8,945	AW119DM-DI	\$9,545
		AW119-UM		AW119DM-UM	
Air Massage with Ultra Whirlpool	6 point-massage jets, 12 micro-jets with Tsubo massage, 2 2-bhp pumps, inline heater, 20 air jets, heated air blower, Aromatherapy, Ozone, pre-leveled foam base	AU119-DI	\$10,940	AU119DM-DI	\$11,540
		AU119-UM		AU119DM-UM	
Air Massage Elite with Standard Whirlpool	6 point-massage jets, 2-bhp pump, 30 air jets, heated air blower, Aromatherapy, Chromatherapy LED lighting, Spa Mode, pre-leveled foam base	AEAP119-DI	\$10,845	AEAP119DM-DI	\$11,445
		AEAP119-UM		AEAP119DM-UM	
Air Massage Elite with Ultra Whirlpool	6 point-massage jets, 12 micro-jets with Tsubo massage, 2 2-bhp pumps, inline heater, 30 air jets, heated air blower, Aromatherapy, Ozone, Chromatherapy LED lighting, Spa Mode, pre-leveled foam base	AEAP119U-DI	\$11,940	AEAP119UDM-DI	\$12,540
		AEAP119U-UM		AEAP119UDM-UM	

RECOMMENDED SENSORY THERAPIES

Chromatherapy

(LE) **\$800** underwater lighting
2 LED lights included

Audiotherapy

(STEREOBT) **\$1,390** 2 transducers
with bluetooth and amplifier
(BTREMOTE) **\$600** bluetooth remote

(STEREOH202) **\$1,575** 4 transducers
amplifier not included

Thermaltherapy

(RAD100) **\$1,595** Radiance®
2 heated zones included
(HTISOAK) **\$825**

For more information on options and accessories go to Acrylic Tub Options at mtibaths.com

Kahlo 1
MODEL 119

Options *Must be ordered at time of purchase.*

Standard Colors White (CWH)
Biscuit (CBS)

Please call for availability of special colors.

Quick Ship reduces lead time (QSPRI) **\$430**

Please call for availability

Inline Heater maintains water temperature
For Soaker or Air Baths (HTISOAK) \$825
Includes a recirculating pump

Cannot be combined with Microbubbles.

Virtual Spout high-flow integrated tub filler (FPMJ) **\$450**

Must specify stub-out location on order. See page 1 for location options.

Grab Bars from **\$330**

Selections vary. Personalization available.

Textured, Slip-Resistant Bottom (TXTBTM) \$105

Compliant with ASTM C 1028-07 friction coefficient.

Accessories

Pillows from **\$180**

Teak Bath Mat (TKMAT3018) \$815

Custom sizes also available. Contact MTI for details and pricing.

Teak Tub Tray

Slatted (TK-TRAY1) **\$500** Solid (TK-TRAY2) **\$570**

Installation Options *Must be ordered at time of purchase.*

Pre-Leveled Foam Base (PLFOAM) \$295

All airbaths include a pre-leveled foam base.

Pre-Leveled Frame and Foam Base (PLF) \$740

Pre-Leveled Frame and Foam Base with Skirting (Acrylic CXL™ tubs only)

For pricing and details go to mtibaths.com

Drains & Overflow Kits *Must be ordered at time of purchase*

Integrated Toe Tap

Slotted Overflow

PVC drain - Chrome (SLOTIOC) included

Finish Upcharge

Brushed Nickel (SLOTIOBNU) **+\$65**

Polished Nickel (SLOTIOPNU) **+\$105**

White (SLOTIOWHU) **+\$65**

Round Overflow

Chrome (RIOBC) may substitute slotted overflow

Finish Upcharge

Brushed Nickel (RIOBN) **+\$120**

Polished Nickel (RIOPN) **+\$120**

White (RIOWH) **+\$120**

Hydrotherapy Equipment & Cleaning Systems

Must be ordered at time of purchase.

Inline Heater maintains water temperature

For Whirlpools or Stream Bath (HTI) \$570

Uses existing pump

Cannot be combined with Microbubbles.

Whirlpool Cleaning Systems

Fill-Flush (FFSO) \$590

Simple Touch (FFE) \$1,020

Must specify stub-out location on order. See page 1 for location options.

Whirlpool Jets Pump upgrade may be advisable for optimal performance when adding jets.

Point-Massage Jet

Extra Point-Massage Jet (EJ) **\$315**

Micro-Jet from **\$360**

Jet styles and packages vary. Personalization available.

Pump Upgrade - 3-bhp (PUMP3) \$315

Jet Trim Kits

For Standard Whirlpool

Chrome (TRC) **\$270**, Brushed Nickel (TRBN) **\$725**

For Ultra Whirlpool

Chrome (TRCU) **\$370**, Brushed Nickel (TRBNU) **\$960**

Other finishes available.

Ozonator (OZONE) \$515

Cannot be added to soakers or airbaths without combination hydrotherapy package or HTISOAK.

Tile Flange

Factory-Installed on 3 sides - rigid ABS (TFK3) \$200

Field Install Kit - includes rigid ABS & adhesive (TFKNI) \$185

IMPORTANT: *Must specify flange location(s) on order of Factory-Installed Flange. Not available with optional Low-Profile Rim.*