

*Warning! The release (backing) paper is very slippery. Immediately discard the release paper as you work. Do NOT walk or stand on the release paper.*

Read the complete instructions before beginning the installation.

### **TOOLS REQUIRED**

Straight blade utility knife (use carefully), wood block, and a clean, soft cloth.

### **WALL PREPARATION**

The wall surface must be thoroughly dry, smooth, and free from dirt, wallpaper, vinyl wall covering, grease, old adhesives, and other extraneous material. DO NOT apply directly over outside walls in contact with earth (such as unfinished basement walls) or over ceramic tile, metals, or other impervious surfaces because poor adhesion may result.

### **PREPARING THE WALL BASE FOR INSTALLATION**

Remove the wall base from the carton. LAY THE ROLL FLAT, RELEASE PAPER DOWN, FOR 24 HOURS OR UNTIL THE WALL BASE LIES TOTALLY FLAT ON THE FLOOR. Acclimatization and installation should only take place between 70 and 80 degrees Fahrenheit.

### **PLANNING THE INSTALLATION BEFORE YOU START**

The adhesive on this product is very strong and you will not be able to move this wall base once you remove the release paper and stick the wall base to the wall. Therefore, make sure to size and position the wall base correctly before removing the paper.

### **POSITIONING THE WALL BASE ON THE WALL WITHOUT REMOVING THE RELEASE PAPER**

Do not remove the paper. Position the wall base where you think is the best place to start. (Think about this before you begin!) With a pencil and using the starting edge of the wall base as a straight edge, mark the starting point on the wall. Then, on the base, mark where any corners will need to be made.

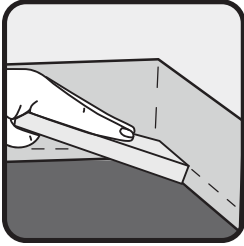
**APPLYING THE WALL BASE TO THE WALL**

Making sure that the wall base is level on the wall with the toe pressed firmly on the floor, remove the release paper several feet ahead of the application point. Apply hard hand pressure on the wall base where it contacts the wall and floor as you apply the wall base to the wall. Be sure to flex out any toe kinks or other irregularities. Using a very smooth, clean block of wood, apply pressure on the toe to assure the toe lies flat against the wall and floor. Do not drag the wood over the surface of the wall base as you may damage the surface.

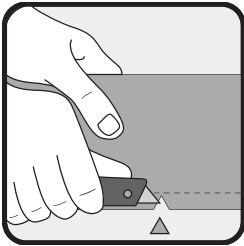
**MAKING INSIDE CORNERS**

Make sure that you have correctly marked on the wall base exactly where you want to make the corner. Leaving the release paper on and with care, cut a V-notch into the toe with a sharp utility knife where you want the corner. Fold the base inward at the point of the notch until you are satisfied with how the corner looks. Remove the paper and apply to the wall corner with care.

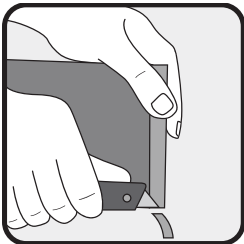
**MAKING OUTSIDE CORNERS**

Make sure that you have correctly marked on the wall base exactly where you want to make the corner. With the release paper on, carefully shave a ¼-inch-wide strip with a utility knife. The depth of the strip should be half the thickness (no more) of the wall base where the corner will be made. Pre-bend the corner along the strip. Remove the rest of the release paper and apply the pre-bent wall base to the wall corner. Do not make corners using the last 6 inches of the roll.

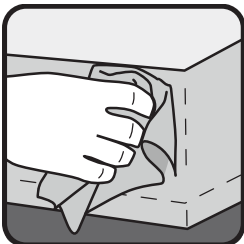
**AFTER WALL BASE IS INSTALLED**

When the installation is complete, rub the freshly installed wall base with a soft, clean cloth to ensure that the wall base is fully and properly stuck to the wall.