



COMMERCIAL

DESCRIPTION

- Thermostatic mixing valve, with adjustable temperature control cartridge
- All brass construction with vandal resistant cap
- 1/2" FNPT connections with 3/8" compression adapter
- Hot and cold check valves prevent possible backflow on water supply inlets
- Stainless steel internal strainer protect against line trash

OPERATION

- Factory preset at 115-120° F (46-49° C)
- Adjustable from 95° F (35° C) to 120° F (49° C), with a $\pm 3.5^\circ$ F ($\pm 2^\circ$ C) temperature accuracy
- Working pressure: maximum = 125 psi, minimum = 20 psi
- Flow rate at 45 PSI = 10 gpm, maximum flow rate = 14.8 gpm
- Cold water supply = 39° to 80° F, hot water supply = 120° to 180° F

CARTRIDGE

- Paraffin based thermostatic engine

STANDARDS

- Third party certified to CSA B-125.3, ASSE 1070 and all applicable requirements referenced therein

WARRANTY

- 5 year limited warranty

Pressure Loss (psi)	Flow Rate (gpm)
10	4.98
20	7.10
30	9.94
45	10.53
60	12.15
80	13.86

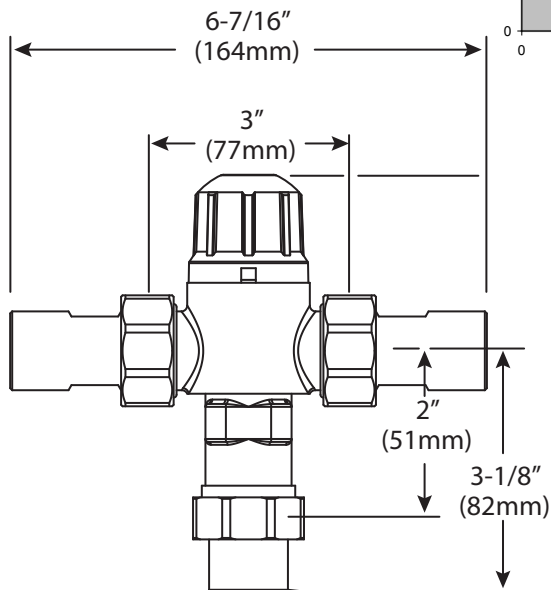

Specifications

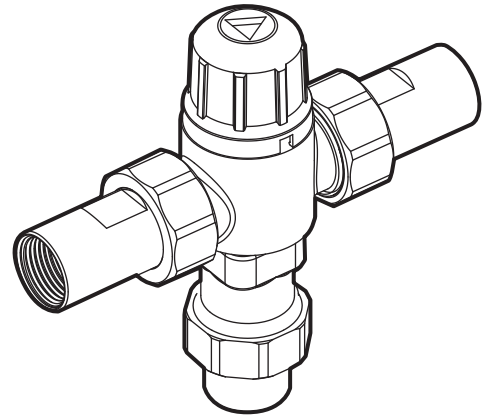

Adjustable Temperature Thermostatic Mixing Valve

Model: 104465

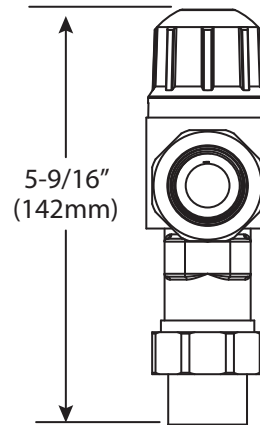
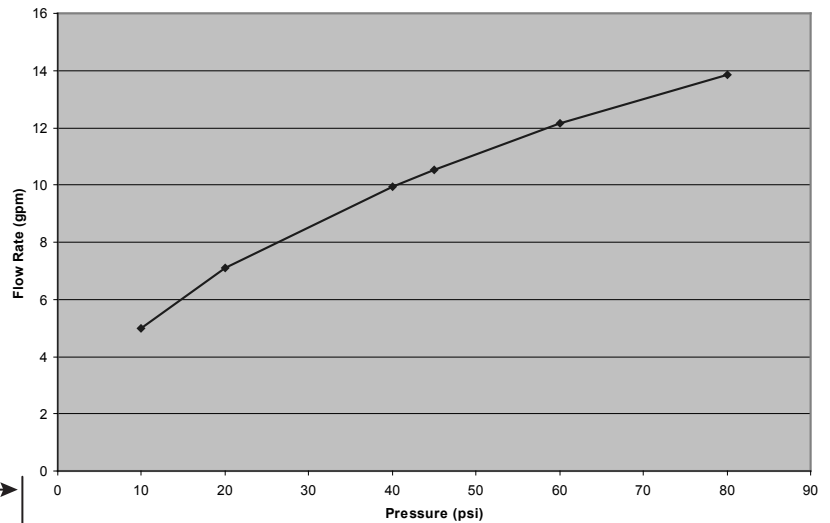

CRITICAL DIMENSIONS

(DO NOT SCALE)