

# OUTDOOR UNIT

**Revision B:**

• MXZ-2C20/3C24/3C30/4C36/5C42NA4 -  U1  
and MXZ-2C20/3C24/3C30NAHZ4 -  U1  
have been added.

OBD702 REVISED EDITION-A is void.

# TECHNICAL DATA



**No. OBD702  
REVISED EDITION-B**

**Models**

MXZ-2C20NA2 -  U1,  U4

MXZ-2C20NA3 -  U1

MXZ-2C20NA4 -  U1

MXZ-3C24NA

MXZ-3C24NA2 -  U1

MXZ-3C24NA3 -  U1

MXZ-3C24NA4 -  U1

MXZ-3C30NA

MXZ-3C30NA2 -  U1

MXZ-3C30NA3 -  U1

MXZ-3C30NA4 -  U1

MXZ-4C36NA

MXZ-4C36NA2 -  U1

MXZ-4C36NA3 -  U1

MXZ-4C36NA4 -  U1

MXZ-5C42NA

MXZ-5C42NA2 -  U1

MXZ-5C42NA3 -  U1

MXZ-5C42NA4 -  U1

MXZ-2C20NAHZ

MXZ-2C20NAHZ2 -  U1

MXZ-2C20NAHZ3 -  U1

MXZ-2C20NAHZ4 -  U1

MXZ-3C24NAHZ

MXZ-3C24NAHZ2 -  U1

MXZ-3C24NAHZ3 -  U1

MXZ-3C24NAHZ4 -  U1

MXZ-3C30NAHZ

MXZ-3C30NAHZ2 -  U1

MXZ-3C30NAHZ3 -  U1

MXZ-3C30NAHZ4 -  U1

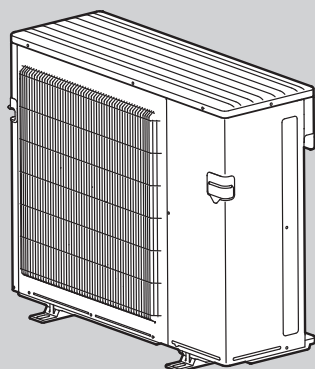

MXZ-3C24NA  
MXZ-3C24NA2  
MXZ-3C24NA3  
MXZ-3C24NA4

MXZ-3C30NA  
MXZ-3C30NA2  
MXZ-3C30NA3  
MXZ-3C30NA4

MXZ-4C36NA  
MXZ-4C36NA2  
MXZ-4C36NA3  
MXZ-4C36NA4

## CONTENTS

1. POSITION OF THE CENTER OF GRAVITY .....2
2. MAX. HEATING CAPACITY IN LOW AMBIENT TEMPERATURE.....3
3. CAPACITY CORRECTION RATIO CURVE FOR PIPING LENGTH .....7
4. PART LOAD CAPACITY CHART .....8

### Revision A:

• MXZ-2C20NA2-<sup>[U4]</sup>, MXZ-2C20NA3-<sup>[U1]</sup>, MXZ-3C24NA, MXZ-3C24NA3-<sup>[U1]</sup>, MXZ-3C30NA, MXZ-3C30NA3-<sup>[U1]</sup>, MXZ-4C36NA, MXZ-4C36NA3-<sup>[U1]</sup>, MXZ-5C42NA, MXZ-5C42NA3-<sup>[U1]</sup>, MXZ-2C20NAHZ, MXZ-2C20NAHZ3-<sup>[U1]</sup>, MXZ-3C24NAHZ, MXZ-3C24NAHZ3-<sup>[U1]</sup>, MXZ-3C30NAHZ and MXZ-3C30NAHZ3-<sup>[U1]</sup> have been added.  
 OBD702 is described in M-E0764 (Published: Nov. 2018.)

### Revision B:

• MXZ-2C20/3C24/3C30/4C36/5C42NA4-<sup>[U1]</sup> and MXZ-2C20/3C24/3C30NAHZ4-<sup>[U1]</sup> have been added.

## 1 POSITION OF THE CENTER OF GRAVITY

MXZ-2C20NA2-<sup>[U1]</sup>, <sup>[U4]</sup>  
 MXZ-2C20NA3-<sup>[U1]</sup>  
 MXZ-2C20NA4-<sup>[U1]</sup>

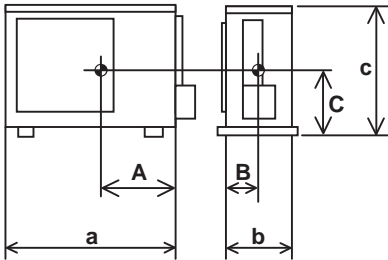

MXZ-3C24NA  
 MXZ-3C24NA2-<sup>[U1]</sup>  
 MXZ-3C24NA3-<sup>[U1]</sup>  
 MXZ-3C24NA4-<sup>[U1]</sup>  
 MXZ-3C30NA  
 MXZ-3C30NA2-<sup>[U1]</sup>  
 MXZ-3C30NA3-<sup>[U1]</sup>  
 MXZ-3C30NA4-<sup>[U1]</sup>  
 MXZ-4C36NA  
 MXZ-4C36NA2-<sup>[U1]</sup>  
 MXZ-4C36NA3-<sup>[U1]</sup>  
 MXZ-4C36NA4-<sup>[U1]</sup>  
 MXZ-5C42NA  
 MXZ-5C42NA2-<sup>[U1]</sup>  
 MXZ-5C42NA3-<sup>[U1]</sup>  
 MXZ-5C42NA4-<sup>[U1]</sup>  
 MXZ-2C20NAHZ  
 MXZ-2C20NAHZ2-<sup>[U1]</sup>  
 MXZ-2C20NAHZ3-<sup>[U1]</sup>  
 MXZ-2C20NAHZ4-<sup>[U1]</sup>  
 MXZ-3C24NAHZ  
 MXZ-3C24NAHZ2-<sup>[U1]</sup>  
 MXZ-3C24NAHZ3-<sup>[U1]</sup>  
 MXZ-3C24NAHZ4-<sup>[U1]</sup>  
 MXZ-3C30NAHZ  
 MXZ-3C30NAHZ2-<sup>[U1]</sup>  
 MXZ-3C30NAHZ3-<sup>[U1]</sup>  
 MXZ-3C30NAHZ4-<sup>[U1]</sup>

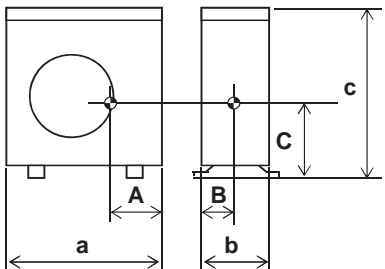

Unit: inch (mm)

Model name	A	B	C	a	b	c
MXZ-2C20NA2- <sup>[U1]</sup> , <sup>[U4]</sup> MXZ-2C20NA3- <sup>[U1]</sup> MXZ-2C20NA4- <sup>[U1]</sup>	11-1/32 (280)	6-3/32 (155)	13 (330)	33-1/16 (840)	13 (330)	27-15/16 (710)
MXZ-3C24NA MXZ-3C24NA2- <sup>[U1]</sup> MXZ-3C24NA3- <sup>[U1]</sup> MXZ-3C24NA4- <sup>[U1]</sup> MXZ-3C30NA MXZ-3C30NA2- <sup>[U1]</sup> MXZ-3C30NA3- <sup>[U1]</sup> MXZ-3C30NA4- <sup>[U1]</sup>	14-3/8 (365)	6-5/16 (160)	12-27/32 (326)	37-13/32 (950)	13 (330)	31-11/32 (796)
MXZ-5C42NA MXZ-5C42NA2- <sup>[U1]</sup> MXZ-5C42NA3- <sup>[U1]</sup> MXZ-5C42NA4- <sup>[U1]</sup> MXZ-2C20NAHZ MXZ-2C20NAHZ2- <sup>[U1]</sup> MXZ-2C20NAHZ3- <sup>[U1]</sup> MXZ-2C20NAHZ4- <sup>[U1]</sup>	12 (305)	5-29/32 (150)	17-23/32 (450)	37-13/32 (950)	13 (330)	41-17/64 (1048)
MXZ-4C36NA MXZ-4C36NA2- <sup>[U1]</sup> MXZ-4C36NA3- <sup>[U1]</sup> MXZ-4C36NA4- <sup>[U1]</sup> MXZ-3C24NAHZ MXZ-3C24NAHZ2- <sup>[U1]</sup> MXZ-3C24NAHZ3- <sup>[U1]</sup> MXZ-3C24NAHZ4- <sup>[U1]</sup> MXZ-3C30NAHZ MXZ-3C30NAHZ2- <sup>[U1]</sup> MXZ-3C30NAHZ3- <sup>[U1]</sup> MXZ-3C30NAHZ4- <sup>[U1]</sup>						

# 2

## MAX. HEATING CAPACITY IN LOW AMBIENT TEMPERATURE

MXZ-2C20NA2-[U1], [U4]

MXZ-2C20NA3-[U1]

MXZ-2C20NA4-[U1]

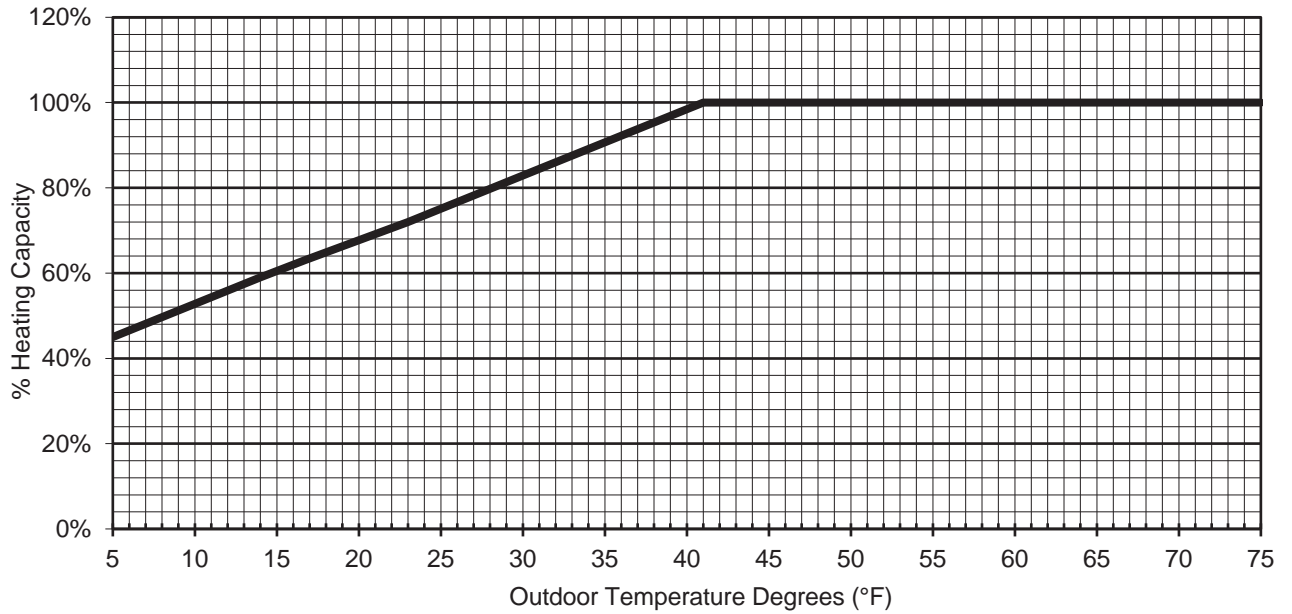

### HEATING CAPACITY

Outdoor Temperature Degrees (°F)	5.0	14.0	23.0	32.0	41.0	41.9	50.0	75.0
% Heating Capacity	45%	59%	72%	86%	100%	100%	100%	100%

MXZ-3C24NA

MXZ-3C24NA2-[U1]

MXZ-3C24NA3-[U1]

MXZ-3C24NA4-[U1]

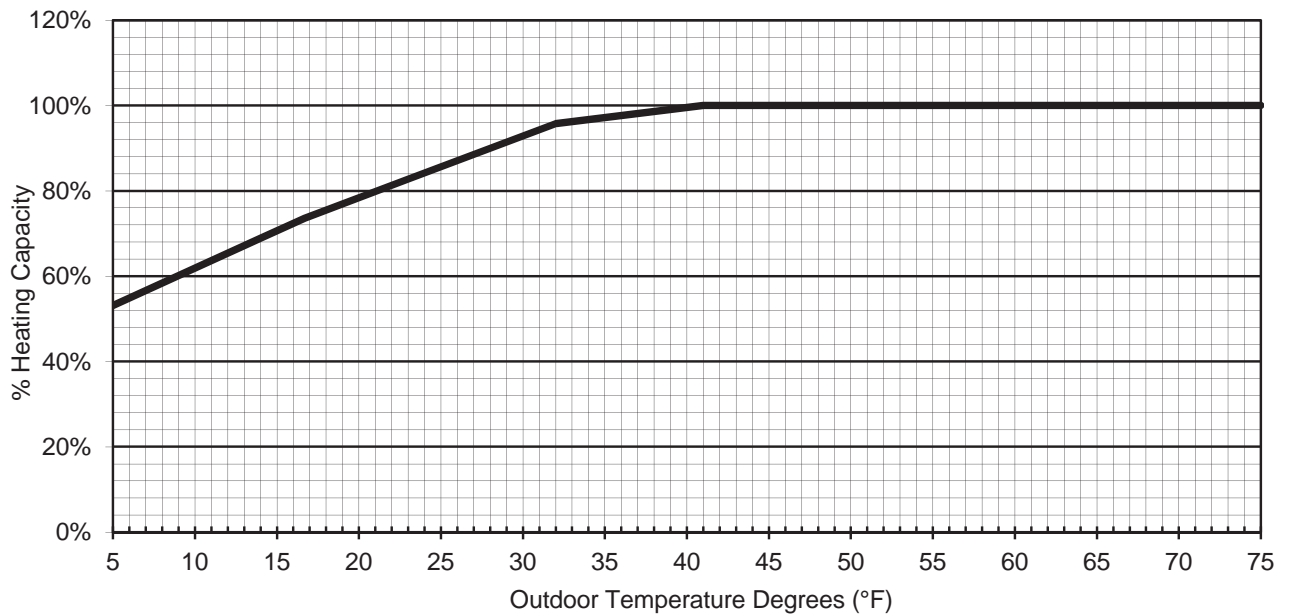

### HEATING CAPACITY

Outdoor Temperature Degrees (°F)	5.0	14.0	23.0	32.0	41.0	50.0	75.0
% Heating Capacity	53%	69%	83%	96%	100%	100%	100%

**MXZ-3C30NA**

**MXZ-3C30NA2-U1**

**MXZ-3C30NA3-U1**

**MXZ-3C30NA4-U1**

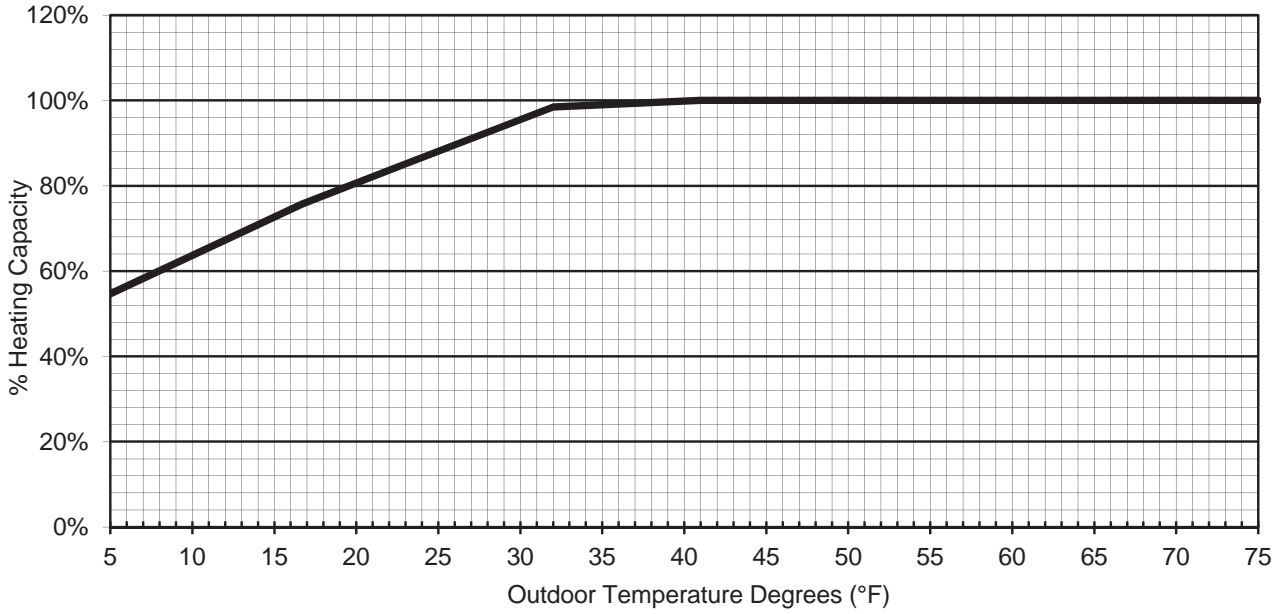

**HEATING CAPACITY**

Outdoor Temperature Degrees (°F)	5.0	14.0	23.0	32.0	41.0	50.0	75.0
% Heating Capacity	55%	71%	85%	98%	100%	100%	100%

**MXZ-4C36NA**

**MXZ-4C36NA2-U1**

**MXZ-4C36NA3-U1**

**MXZ-4C36NA4-U1**

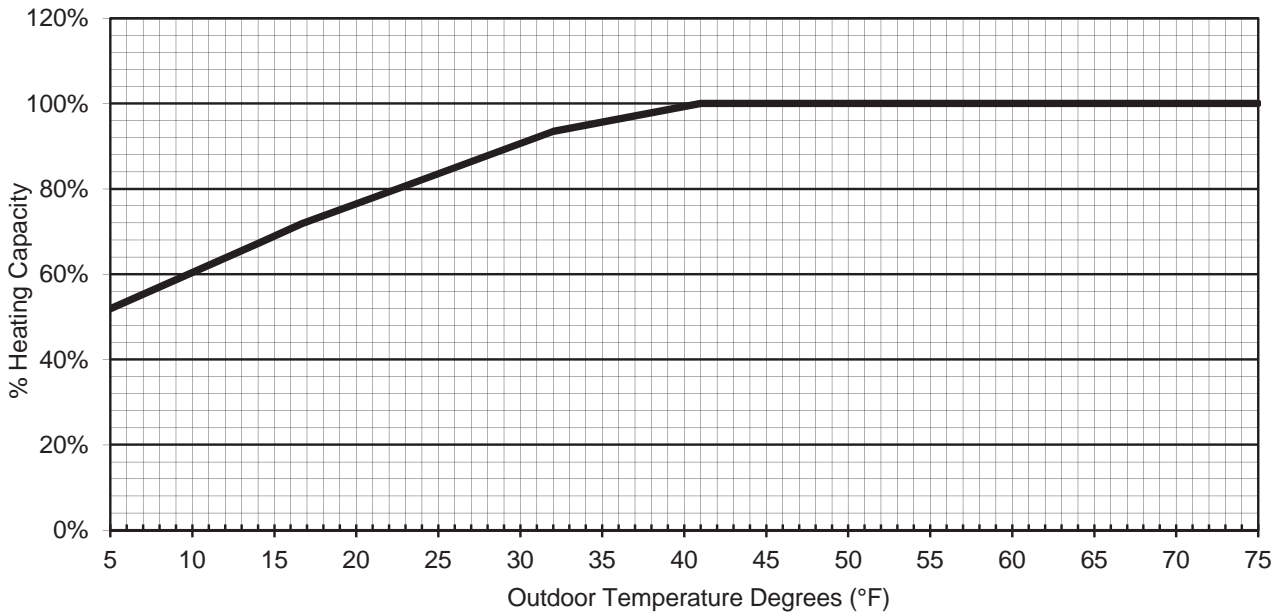

**HEATING CAPACITY**

Outdoor Temperature Degrees (°F)	5.0	14.0	23.0	32.0	41.0	50.0	75.0
% Heating Capacity	52%	67%	81%	93%	100%	100%	100%

**MXZ-5C42NA**

**MXZ-5C42NA2-U1**

**MXZ-5C42NA3-U1**

**MXZ-5C42NA4-U1**

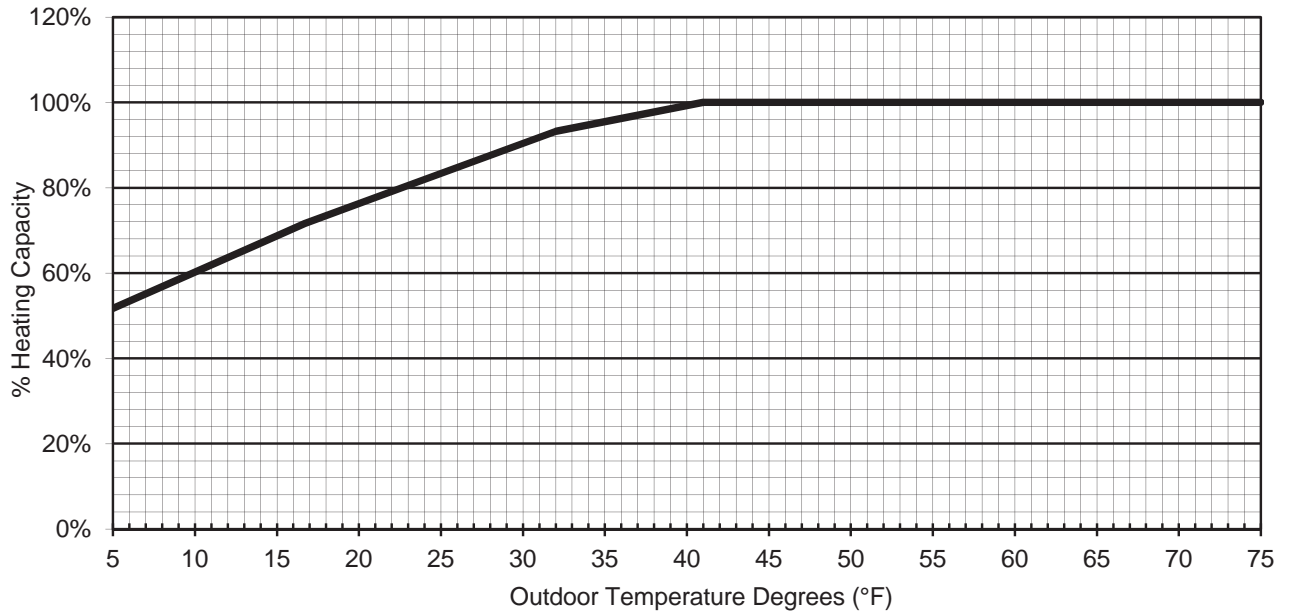

**HEATING CAPACITY**

Outdoor Temperature Degrees (°F)	5.0	14.0	23.0	32.0	41.0	50.0	75.0
% Heating Capacity	52%	67%	81%	93%	100%	100%	100%

**MXZ-2C20NAHZ**

**MXZ-2C20NAHZ2-U1**

**MXZ-2C20NAHZ3-U1**

**MXZ-2C20NAHZ4-U1**

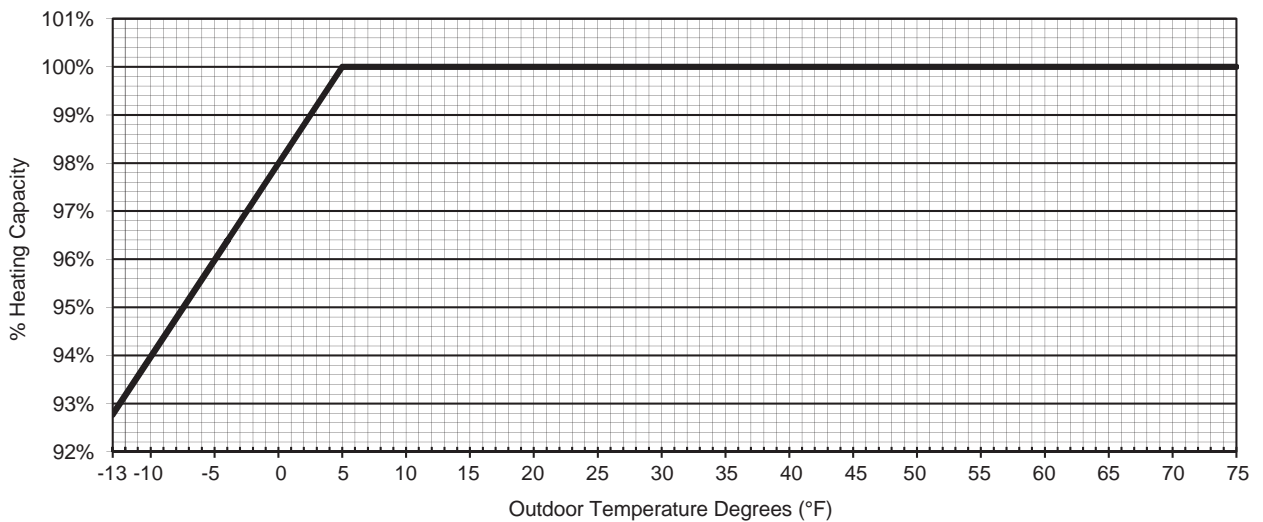

**HEATING CAPACITY**

Outdoor Temperature Degrees (°F)	-13.0	-4.0	5.0	14.0	23.0	32.0	41.0	50.0	75.0
% Heating Capacity	93%	96%	100%	100%	100%	100%	100%	100%	100%

**MXZ-3C24NAHZ**

**MXZ-3C24NAHZ2 - [U1]**

**MXZ-3C24NAHZ3 - [U1]**

**MXZ-3C24NAHZ4 - [U1]**

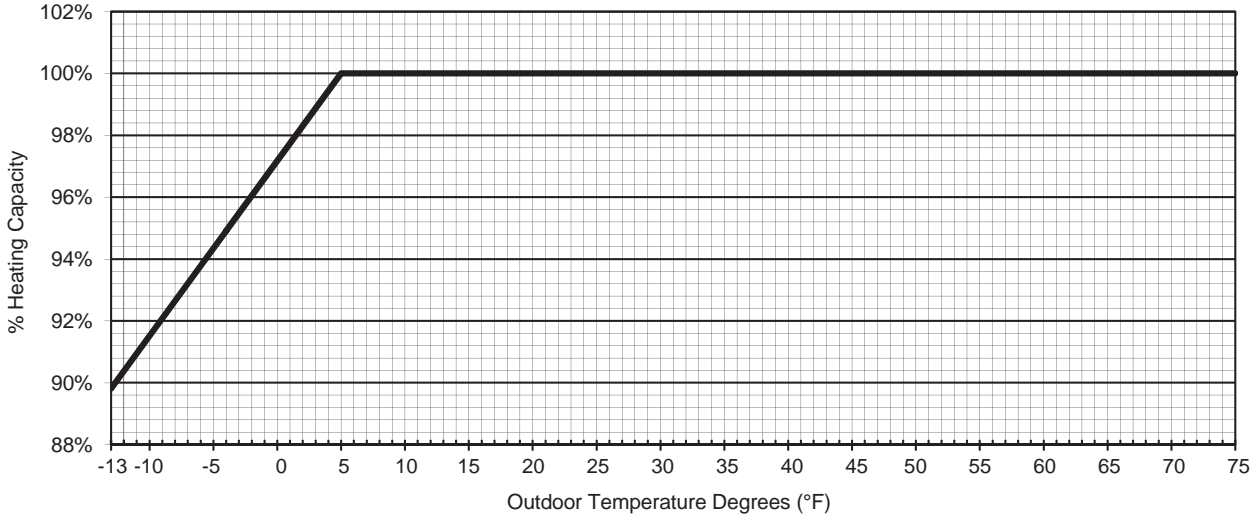

**HEATING CAPACITY**

Outdoor Temperature Degrees (°F)	-13.0	-4.0	5.0	14.0	23.0	32.0	41.0	50.0	75.0
% Heating Capacity	90%	95%	100%	100%	100%	100%	100%	100%	100%

**MXZ-3C30NAHZ**

**MXZ-3C30NAHZ2 - [U1]**

**MXZ-3C30NAHZ3 - [U1]**

**MXZ-3C30NAHZ4 - [U1]**

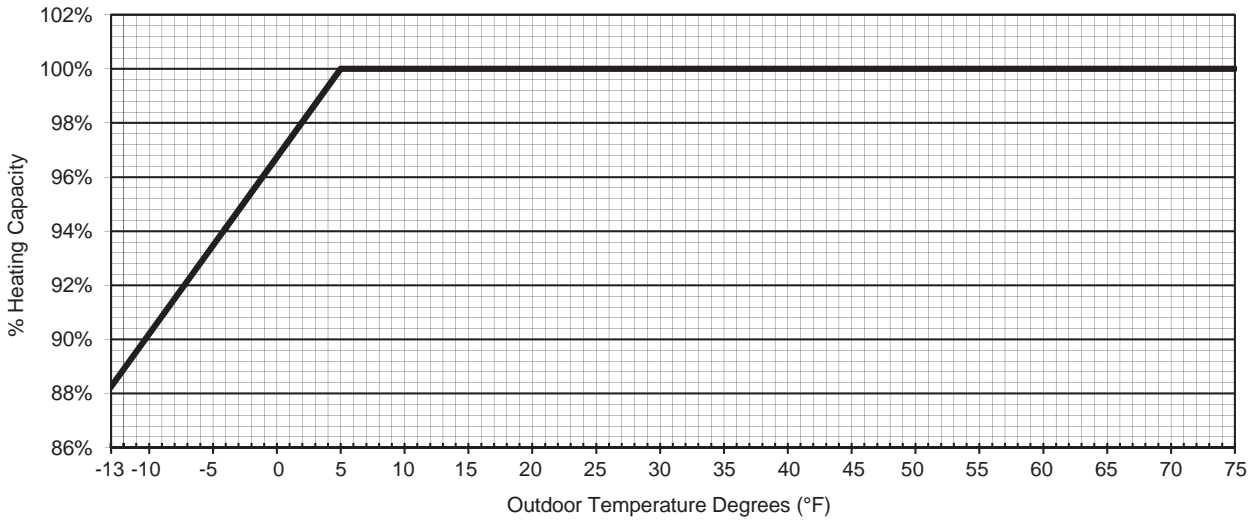

**HEATING CAPACITY**

Outdoor Temperature Degrees (°F)	-13.0	-4.0	5.0	14.0	23.0	32.0	41.0	50.0	75.0
% Heating Capacity	88%	94%	100%	100%	100%	100%	100%	100%	100%

# 3

## CAPACITY CORRECTION RATIO CURVE FOR PIPING LENGTH

MXZ-2C20NA2 - [U1], [U4]	MXZ-2C20NA3 - [U1]	MXZ-2C20NA4 - [U1]	
MXZ-3C24NA	MXZ-3C24NA2 - [U1]	MXZ-3C24NA3 - [U1]	MXZ-3C24NA4 - [U1]
MXZ-3C30NA	MXZ-3C30NA2 - [U1]	MXZ-3C30NA3 - [U1]	MXZ-3C30NA4 - [U1]
MXZ-4C36NA	MXZ-4C36NA2 - [U1]	MXZ-4C36NA3 - [U1]	MXZ-4C36NA4 - [U1]
MXZ-5C42NA	MXZ-5C42NA2 - [U1]	MXZ-5C42NA3 - [U1]	MXZ-5C42NA4 - [U1]
MXZ-2C20NAHZ	MXZ-2C20NAHZ2 - [U1]	MXZ-2C20NAHZ3 - [U1]	MXZ-2C20NAHZ4 - [U1]
MXZ-3C24NAHZ	MXZ-3C24NAHZ2 - [U1]	MXZ-3C24NAHZ3 - [U1]	MXZ-3C24NAHZ4 - [U1]
MXZ-3C30NAHZ	MXZ-3C30NAHZ2 - [U1]	MXZ-3C30NAHZ3 - [U1]	MXZ-3C30NAHZ4 - [U1]

Correction ratio of capacity according to the length of piping (cooling)

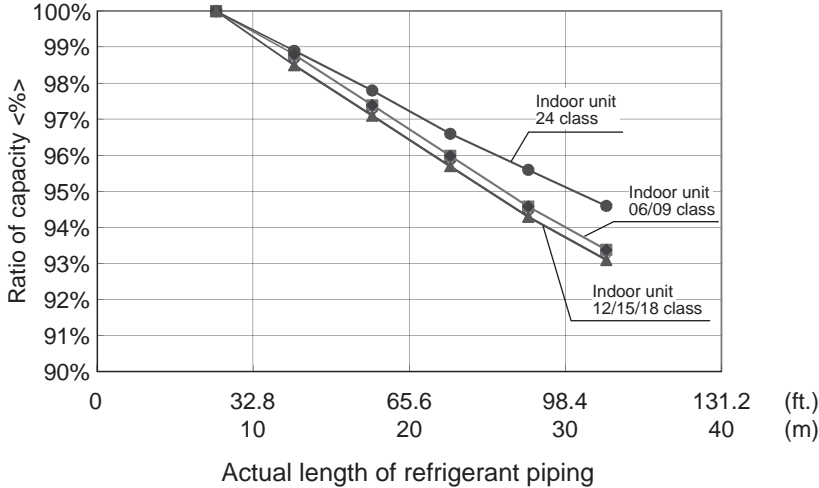

Correction ratio of capacity according to the length of piping (heating)

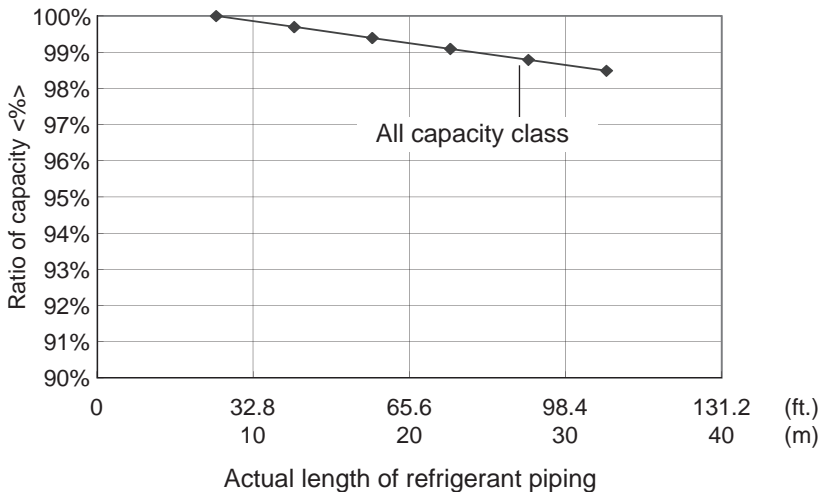

The length intended for the capacity calculation, which counts the length of refrigerant piping and the number of bends, is called actual length.

**Length of refrigerant piping (ft.) + ( Number of bends × 0.984 ft. ) = Actual length of refrigerant piping (ft.)**  
**[Length of refrigerant piping (m) + ( Number of bends × 0.3 m ) = Actual length of refrigerant piping (m)]**

# PART LOAD CAPACITY CHART

MXZ-2C20NA2-U1, U4      MXZ-2C20NA3-U1      MXZ-2C20NA4-U1

## 1) COOLING

Rated Q[Btu/h): 18000  
W: 1417  
Max. Q[Btu/h): 20000

Indoor W.B. Outdoor D.B. (°F) (°C)	72°F / 22.2°C					67°F / 19.4°C					64°F / 17.8°C					61°F / 16.1°C							
	Max.	Rated	75%	50%	25%	Min.	Max.	Rated	75%	50%	25%	Min.	Max.	Rated	75%	50%	25%	Min.	Max.	Rated	75%	50%	25%
115 46.1	Q[Btu/h]	17275	14400	10800	7200	- 7473	17059	14220	10665	7110	- 7379	16627	13860	10395	6930	- 7192	15332	12780	9585	6390	- 6632		
	W	2324	1346	852	576	- 882	2495	1445	915	619	- 947	2569	1488	942	637	- 974	2398	1389	879	594	- 909		
110 43.3	Q[Btu/h]	19797	18360	13770	9180	- 8360	18028	16720	12540	8360	- 7613	17468	16200	12150	8100	- 7376	13780	12780	9585	6390	- 5819		
	W	2551	1700	1076	728	- 936	2466	1644	1040	704	- 905	2355	1570	994	672	- 864	1909	1273	806	545	- 700		
106 41.1	Q[Btu/h]	20887	18720	14040	9360	- 8562	19012	17040	12780	8520	- 7794	18075	16200	12150	8100	- 7410	14259	12780	9585	6390	- 5846		
	W	2577	1644	1040	704	- 903	2488	1587	1005	679	- 872	2324	1482	938	634	- 814	1874	1195	757	512	- 657		
102 38.9	Q[Btu/h]	21820	19080	14310	9540	- 8763	19853	17360	13020	8680	- 7973	18526	16200	12150	8100	- 7440	14615	12780	9585	6390	- 5869		
	W	2561	1587	1005	679	- 871	2470	1530	969	655	- 840	2250	1394	883	597	- 765	1805	1118	708	479	- 613		
98 36.7	Q[Btu/h]	22297	19440	14580	9720	- 8961	20278	17680	13260	8840	- 8149	18581	16200	12150	8100	- 7467	14658	12780	9585	6390	- 5891		
	W	2448	1530	969	655	- 839	2358	1474	933	631	- 808	2090	1306	827	559	- 716	1665	1041	659	445	- 570		
94 34.4	Q[Btu/h]	22440	19800	14850	9900	- 9165	20400	18000	13500	9000	- 8332	18360	16200	12150	8100	- 7498	14484	12780	9585	6390	- 5915		
	W	2392	1474	933	631	- 805	2300	1417	897	606	- 774	1978	1219	771	522	- 666	1564	964	610	412	- 527		
90 32.2	Q[Btu/h]	22440	19800	14850	9900	- 9353	20400	18000	13500	9000	- 8503	18360	16200	12150	8100	- 7652	14484	12780	9585	6390	- 6037		
	W	2392	1474	933	631	- 773	2300	1417	897	606	- 743	1978	1219	771	522	- 639	1564	964	610	412	- 505		
86 30	Q[Btu/h]	22440	19800	14850	9900	- 9539	20400	18000	13500	9000	- 8672	18360	16200	12150	8100	- 7805	14484	12780	9585	6390	- 6157		
	W	2392	1474	933	631	- 740	2300	1417	897	606	- 712	1978	1219	771	522	- 612	1564	964	610	412	- 484		
82 27.8	Q[Btu/h]	22440	19800	14850	9900	- 9726	20400	18000	13500	9000	- 8842	18360	16200	12150	8100	- 7958	14484	12780	9585	6390	- 6278		
	W	2392	1474	933	631	- 708	2300	1417	897	606	- 681	1978	1219	771	522	- 585	1564	964	610	412	- 463		
78 25.6	Q[Btu/h]	22440	19800	14850	-	- 9907	20400	18000	13500	-	- 9007	18360	16200	12150	-	- 8106	14484	12780	9585	-	- 6395		
	W	2392	1474	933	-	- 676	2300	1417	897	-	- 650	1978	1219	771	-	- 559	1564	964	610	-	- 442		
74 23.3	Q[Btu/h]	22440	19800	14850	-	- 10096	20400	18000	13500	-	- 9179	18360	16200	12150	-	- 8261	14484	12780	9585	-	- 6517		
	W	2392	1474	933	-	- 643	2300	1417	897	-	- 618	1978	1219	771	-	- 532	1564	964	610	-	- 420		
70 21.1	Q[Btu/h]	22440	19800	14850	-	- 10275	20400	18000	13500	-	- 9341	18360	16200	12150	-	- 8407	14484	12780	9585	-	- 6632		
	W	2392	1474	933	-	- 611	2300	1417	897	-	- 588	1978	1219	771	-	- 506	1564	964	610	-	- 400		
66 18.9	Q[Btu/h]	22440	19800	14850	-	- 10452	20400	18000	13500	-	- 9502	18360	16200	12150	-	- 8552	14484	12780	9585	-	- 6746		
	W	2392	1474	933	-	- 580	2300	1417	897	-	- 558	1978	1219	771	-	- 480	1564	964	610	-	- 379		
62 16.7	Q[Btu/h]	22440	19800	14850	-	- 10627	20400	18000	13500	-	- 9661	18360	16200	12150	-	- 8694	14484	12780	9585	-	- 6859		
	W	2392	1474	933	-	- 549	2300	1417	897	-	- 528	1978	1219	771	-	- 454	1564	964	610	-	- 359		
58 14.4	Q[Btu/h]	22440	19800	14850	-	- 10808	20400	18000	13500	-	- 9825	18360	16200	12150	-	- 8843	14484	12780	9585	-	- 6976		
	W	2392	1474	933	-	- 549	2300	1417	897	-	- 528	1978	1219	771	-	- 454	1564	964	610	-	- 359		
54 12.2	Q[Btu/h]	22440	19800	14850	-	- 10868	20400	18000	13500	-	- 9880	18360	16200	12150	-	- 8892	14484	12780	9585	-	- 7015		
	W	2392	1474	933	-	- 487	2300	1417	897	-	- 468	1978	1219	771	-	- 402	1564	964	610	-	- 318		
50 10	Q[Btu/h]	22440	19800	14850	-	- 11146	20400	18000	13500	-	- 10133	18360	16200	12150	-	- 9120	14484	12780	9585	-	- 7194		
	W	2392	1474	933	-	- 456	2300	1417	897	-	- 438	1978	1219	771	-	- 377	1564	964	610	-	- 298		
46 7.8	Q[Btu/h]	22440	19800	14850	-	- 11312	20400	18000	13500	-	- 10284	18360	16200	12150	-	- 9256	14484	12780	9585	-	- 7302		
	W	2392	1474	933	-	- 426	2300	1417	897	-	- 410	1978	1219	771	-	- 353	1564	964	610	-	- 279		
42 5.6	Q[Btu/h]	22440	19800	14850	-	- 11477	20400	18000	13500	-	- 10434	18360	16200	12150	-	- 9391	14484	12780	9585	-	- 7408		
	W	2392	1474	933	-	- 396	2300	1417	897	-	- 381	1978	1219	771	-	- 328	1564	964	610	-	- 259		
38 3.3	Q[Btu/h]	22440	19800	14850	-	- 11648	20400	18000	13500	-	- 10589	18360	16200	12150	-	- 9530	14484	12780	9585	-	- 7518		
	W	2392	1474	933	-	- 365	2300	1417	897	-	- 351	1978	1219	771	-	- 302	1564	964	610	-	- 239		
34 1.1	Q[Btu/h]	22440	19800	14850	-	- 11146	20400	18000	13500	-	- 10133	18360	16200	12150	-	- 9119	14484	12780	9585	-	- 7194		
	W	2392	1474	933	-	- 377	2300	1417	897	-	- 363	1978	1219	771	-	- 312	1564	964	610	-	- 247		
30 -1.1	Q[Btu/h]	22440	19800	14850	-	- 11313	20400	18000	13500	-	- 10285	18360	16200	12150	-	- 9256	14484	12780	9585	-	- 7302		
	W	2392	1474	933	-	- 347	2300	1417	897	-	- 334	1978	1219	771	-	- 287	1564	964	610	-	- 227		
26 -3.3	Q[Btu/h]	22440	19800	14850	-	- 11487	20400	18000	13500	-	- 10443	18360	16200	12150	-	- 9398	14484	12780	9585	-	- 7414		
	W	2392	1474	933	-	- 315	2300	1417	897	-	- 303	1978	1219	771	-	- 261	1564	964	610	-	- 206		
22 -5.6	Q[Btu/h]	22440	19800	14850	-	- 11660	20400	18000	13500	-	- 10600	18360	16200	12150	-	- 9540	14484	12780	9585	-	- 7526		
	W	2392	1474	933	-	- 284	2300	1417	897	-	- 273	1978	1219	771	-	- 235	1564	964	610	-	- 186		
18 -7.8	Q[Btu/h]	22440	19800	14850	-	- 11823	20400	18000	13500	-	- 10748	18360	16200	12150	-	- 9674	14484	12780	9585	-	- 7631		
	W	2392	1474	933	-	- 254	2300	1417	897	-	- 244	1978	1219	771	-	- 210	1564	964	610	-	- 166		
14 -10	Q[Btu/h]	22440	19800	14850	-	- 11985	20400	18000	13500	-	- 10895	18360	16200	12150	-	- 9806	14484	12780	9585	-	- 7736		
	W	2392	1474	933	-	- 225	2300	1417	897	-	- 216	1978	1219	771	-	- 186	1564	964	610	-	- 147		

\* It may not reach the above capacities in low ambient temperatures.  
\* An air outlet guide is needed for ambient temperatures below 41°F.



**MXZ-2C20NA2 - U1, U4    MXZ-2C20NA3 - U1    MXZ-2C20NA4 - U1**

**2) HEATING**

**Rated**  
 Q(Btu/h): 22000    **Max.**  
 W: 1641    Q(Btu/h): 25500

Indoor D.B. Outdoor W.B. (°F) (°C)			80°F / 26.7°C					70°F / 21.1°C					60°F / 15.6°C							
			Max.	Rated	75%	50%	25%	Min.	Max.	Rated	75%	50%	25%	Min.	Max.	Rated	75%	50%	25%	Min.
65	18.3	Q[Btu/h]	23908	28087	21065	14043	-	13902	24738	29062	21796	14531	-	14385	25500	29957	22468	14978	-	14828
		W	2650	1948	1642	1040	-	1638	2550	1875	1580	1001	-	1576	2500	1838	1549	981	-	1545
60	15.6	Q[Btu/h]	23819	26498	19873	13249	-	12794	24707	27485	20614	13743	-	13270	25500	28368	21276	14184	-	13697
		W	2675	1896	1599	1013	-	1470	2575	1825	1539	975	-	1416	2500	1772	1494	946	-	1374
55	12.8	Q[Btu/h]	23719	24909	18682	12454	-	11695	24671	25909	19431	12954	-	12164	25500	26779	20084	13389	-	12573
		W	2700	1843	1554	984	-	1310	2625	1792	1511	957	-	1273	2500	1707	1439	911	-	1213
50	10.0	Q[Btu/h]	23607	23320	17490	-	-	13966	24631	24332	18249	-	-	14572	25500	25190	18893	-	-	15085
		W	2700	1790	1509	-	-	1681	2575	1707	1439	-	-	1603	2500	1657	1397	-	-	1556
45	7.2	Q[Btu/h]	23480	21731	16298	-	-	12590	24586	22755	17066	-	-	13183	25500	23601	17701	-	-	13673
		W	2725	1753	1478	-	-	1457	2575	1656	1396	-	-	1377	2500	1608	1356	-	-	1336
40	4.4	Q[Btu/h]	19857	18128	13596	-	-	11884	20878	19061	14296	-	-	12496	20912	19091	14318	-	-	12515
		W	2333	1699	1432	-	-	1271	2226	1621	1367	-	-	1213	2140	1559	1314	-	-	1166
35	1.7	Q[Btu/h]	17184	16698	-	-	-	14686	18155	17642	-	-	-	15516	18916	18381	-	-	-	16166
		W	1991	1625	-	-	-	1968	1901	1551	-	-	-	1878	1810	1477	-	-	-	1789
30	-1.1	Q[Btu/h]	16204	16116	-	-	-	13153	17217	17124	-	-	-	13975	17990	17893	-	-	-	14602
		W	1661	1534	-	-	-	1660	1601	1479	-	-	-	1600	1510	1395	-	-	-	1509
25	-3.9	Q[Btu/h]	14421	14607	-	-	-	11728	15427	15626	-	-	-	12546	16175	16383	-	-	-	13154
		W	1413	1465	-	-	-	1430	1338	1387	-	-	-	1354	1250	1296	-	-	-	1266
20	-6.7	Q[Btu/h]	12787	13097	-	-	-	13179	13794	14128	-	-	-	14217	14522	14874	-	-	-	14967
		W	1164	1335	-	-	-	1843	1102	1264	-	-	-	1745	1030	1182	-	-	-	1631
15	-9.4	Q[Btu/h]	11354	11588	-	-	-	11687	12376	12631	-	-	-	12739	13095	13364	-	-	-	13479
		W	961	1205	-	-	-	1526	910	1141	-	-	-	1445	850	1067	-	-	-	1351
10	-12.2	Q[Btu/h]	10003	10078	-	-	-	10282	11050	11133	-	-	-	11357	11767	11855	-	-	-	12094
		W	800	1066	-	-	-	1283	752	1002	-	-	-	1206	690	919	-	-	-	1106
5	-15.0	Q[Btu/h]	8779	8569	-	-	-	9008	9871	9635	-	-	-	10128	10599	10346	-	-	-	10875
		W	672	965	-	-	-	1085	622	893	-	-	-	1003	560	804	-	-	-	904



**MXZ-3C24NA MXZ-3C24NA2-U1 MXZ-3C24NA3-U1 MXZ-3C24NA4-U1**

**2) HEATING**

**Rated**  
Q(Btu/h): 25000  
W: 1750

**Max.**  
Q(Btu/h): 30600  
W: 2580

Indoor D.B. Outdoor W.B. (°F) (°C)			80°F/26.7°C					70°F / 21.1°C					60°F/15.6°C							
			Max.	Rated	75%	50%	25%	Min.	Max.	Rated	75%	50%	25%	Min.	Max.	Rated	75%	50%	25%	Min.
65	18.3	Q[Btu/h]	28690	31917	23938	15958	-	13402	29686	33025	24769	16512	-	13867	30600	34042	25531	17021	-	14294
		W	2735	2059	1736	1100	-	864	2632	1981	1670	1058	-	832	2580	1943	1638	1037	-	816
60	15.6	Q[Btu/h]	28583	30111	22583	15056	-	12479	29648	31233	23425	15617	-	12944	30600	32236	24177	16118	-	13360
		W	2761	2004	1689	1070	-	849	2657	1929	1626	1030	-	818	2580	1873	1579	1000	-	794
55	12.8	Q[Btu/h]	28463	28306	21229	14153	-	11526	29606	29442	22081	14721	-	11988	30600	30431	22823	15215	-	12391
		W	2786	2017	1700	1077	-	833	2657	1924	1622	1027	-	795	2580	1868	1574	997	-	772
50	10.0	Q[Btu/h]	28328	26500	19875	13250	-	10574	29558	27650	20737	13825	-	11033	30600	28625	21469	14313	-	11422
		W	2786	1909	1609	1019	-	809	2683	1838	1550	982	-	779	2580	1768	1490	944	-	749
45	7.2	Q[Btu/h]	28175	24694	18521	12347	-	9625	29503	25858	19394	12929	-	10079	30600	26819	20115	13410	-	10453
		W	2812	1876	1582	1002	-	792	2683	1790	1509	956	-	756	2580	1721	1451	919	-	727
40	4.4	Q[Btu/h]	23556	20600	15450	10300	-	8679	24768	21660	16245	10830	-	9125	25743	22513	16884	11256	-	9484
		W	2742	1822	1536	973	-	768	2616	1738	1465	928	-	732	2516	1671	1409	892	-	704
35	1.7	Q[Btu/h]	22104	18975	14231	9488	-	7767	23354	20047	15036	10024	-	8206	24332	20888	15666	10444	-	8550
		W	2658	1669	1407	891	-	744	2536	1593	1342	850	-	710	2439	1531	1291	818	-	683
30	-1.1	Q[Btu/h]	22078	18314	13735	-	-	10611	23459	19459	14594	-	-	11275	24512	20333	15249	-	-	11781
		W	2594	1629	1374	-	-	1235	2476	1555	1311	-	-	1179	2358	1481	1249	-	-	1123
25	-3.9	Q[Btu/h]	21147	16599	12449	-	-	10009	22623	17757	13318	-	-	10707	23719	18617	13963	-	-	11226
		W	2506	1518	1280	-	-	1212	2392	1449	1222	-	-	1157	2278	1380	1163	-	-	1101
20	-6.7	Q[Btu/h]	20522	14883	11163	-	-	9396	22138	16055	12041	-	-	10136	23306	16902	12677	-	-	10671
		W	2484	1446	1219	-	-	1221	2352	1370	1155	-	-	1156	2198	1280	1079	-	-	1080
15	-9.4	Q[Btu/h]	20174	13168	9876	-	-	8789	21989	14353	10765	-	-	9579	23267	15187	11390	-	-	10136
		W	2397	1256	1059	-	-	1197	2270	1189	1002	-	-	1134	2121	1111	937	-	-	1060
10	-12.2	Q[Btu/h]	20062	11453	-	-	-	11194	22161	12651	-	-	-	12365	23599	13472	-	-	-	13167
		W	2306	917	-	-	-	1801	2184	868	-	-	-	1705	2041	811	-	-	-	1594
5	-15.0	Q[Btu/h]	19307	9738	-	-	-	10736	21709	10949	-	-	-	12071	23310	11756	-	-	-	12962
		W	2353	966	-	-	-	1858	2177	894	-	-	-	1719	1961	805	-	-	-	1548

\* Above data is for heating operation without any frost.



**MXZ-3C30NA MXZ-3C30NA2-U1 MXZ-3C30NA3-U1 MXZ-3C30NA4-U1**

**2) HEATING**

**Rated**  
 Q(Btu/h): 28600  
 W: 2150

**Max.**  
 Q(Btu/h): 36000  
 W: 3300

Indoor D.B. Outdoor W.B. (°F) (°C)			80°F/26.7°C					70°F / 21.1°C					60°F/15.6°C							
			Max.	Rated	75%	50%	25%	Min.	Max.	Rated	75%	50%	25%	Min.	Max.	Rated	75%	50%	25%	Min.
65	18.3	Q[Btu/h]	33753	36513	27385	18256	-	16752	34925	37781	28335	18890	-	17334	36000	38944	29208	19472	-	17868
		W	3498	2530	2133	1351	-	1081	3366	2434	2052	1300	-	1040	3300	2387	2012	1274	-	1019
60	15.6	Q[Btu/h]	33627	34447	25835	17224	-	15599	34880	35731	26798	17865	-	16180	36000	36878	27659	18439	-	16700
		W	3531	2462	2075	1314	-	1062	3399	2370	1998	1265	-	1022	3300	2301	1939	1228	-	992
55	12.8	Q[Btu/h]	33486	32382	24286	16191	-	14407	34830	33681	25261	16841	-	14985	36000	34813	26109	17406	-	15489
		W	3564	2453	2068	1310	-	1042	3399	2340	1972	1249	-	993	3300	2272	1915	1213	-	964
50	10.0	Q[Btu/h]	33328	30316	22737	15158	-	13218	34774	31632	23724	15816	-	13791	36000	32747	24560	16374	-	14278
		W	3564	2345	1977	1252	-	1011	3432	2258	1904	1206	-	974	3300	2172	1831	1160	-	936
45	7.2	Q[Btu/h]	33148	28250	21188	14125	-	12031	34710	29582	22186	14791	-	12598	36000	30681	23011	15341	-	13067
		W	3597	2293	1933	1224	-	990	3432	2187	1844	1168	-	945	3300	2103	1773	1123	-	908
40	4.4	Q[Btu/h]	27713	23566	17675	11783	-	10848	29139	24779	18584	12390	-	11407	30286	25754	19316	12877	-	11856
		W	3516	2238	1887	1195	-	960	3354	2135	1800	1140	-	916	3225	2053	1731	1096	-	880
35	1.7	Q[Btu/h]	26005	21707	16281	10854	-	9709	27475	22934	17201	11467	-	10258	28626	23895	17921	11948	-	10688
		W	3408	2051	1729	1095	-	930	3251	1957	1649	1045	-	887	3126	1881	1586	1005	-	853
30	-1.1	Q[Btu/h]	25975	20951	15713	-	-	13264	27599	22261	16696	-	-	14093	28838	23261	17445	-	-	14726
		W	3326	2014	1698	-	-	1544	3175	1923	1621	-	-	1474	3024	1831	1544	-	-	1404
25	-3.9	Q[Btu/h]	24879	18989	14242	-	-	12511	26616	20314	15236	-	-	13384	27905	21298	15974	-	-	14032
		W	3213	1852	1562	-	-	1515	3067	1768	1491	-	-	1446	2921	1684	1420	-	-	1377
20	-6.7	Q[Btu/h]	24144	17027	12770	-	-	11746	26045	18367	13775	-	-	12670	27419	19336	14502	-	-	13339
		W	3185	1790	1509	-	-	1526	3016	1695	1429	-	-	1445	2818	1584	1335	-	-	1350
15	-9.4	Q[Btu/h]	23734	15064	11298	-	-	10986	25870	16420	12315	-	-	11974	27373	17374	13030	-	-	12670
		W	3073	1543	1301	-	-	1497	2910	1461	1231	-	-	1417	2719	1365	1151	-	-	1324
10	-12.2	Q[Btu/h]	23603	13102	-	-	-	13992	26072	14473	-	-	-	15456	27763	15411	-	-	-	16458
		W	2957	1204	-	-	-	2251	2800	1140	-	-	-	2131	2617	1065	-	-	-	1992
5	-15.0	Q[Btu/h]	22860	11140	-	-	-	13420	25704	12525	-	-	-	15089	27600	13449	-	-	-	16202
		W	3017	1187	-	-	-	2322	2790	1098	-	-	-	2148	2514	989	-	-	-	1935

\* Above data is for heating operation without any frost.



**MXZ-4C36NA MXZ-4C36NA2-U1 MXZ-4C36NA3-U1 MXZ-4C36NA4-U1**

**2) HEATING**

**Rated**  
 Q(Btu/h): 36000  
 W: 3020

**Max.**  
 Q(Btu/h): 43000  
 W: 4020

Indoor D.B.		80°F/26.7°C						70°F / 21.1°C						60°F/15.6°C					
Outdoor W.B.		Max.	Rated	75%	50%	25%	Min.	Max.	Rated	75%	50%	25%	Min.	Max.	Rated	75%	50%	25%	Min.
(°F)	(°C)																		
65	18.3	Q[Btu/h]	47408	45960	34470	22980	- 20103	49054	47556	35667	23778	- 20801	50565	49020	36765	24510	- 21441		
		W	4713	3553	2995	1897	- 1297	4536	3419	2882	1826	- 1248	4447	3352	2826	1790	- 1223		
60	15.6	Q[Btu/h]	43369	43360	32520	21680	- 18719	44986	44976	33732	22488	- 19416	46430	46420	34815	23210	- 20040		
		W	4632	3458	2915	1846	- 1274	4459	3328	2806	1777	- 1227	4329	3231	2724	1726	- 1191		
55	12.8	Q[Btu/h]	39633	40760	30570	20380	- 17289	41224	42396	31797	21198	- 17983	42609	43820	32865	21910	- 18587		
		W	4543	3402	2868	1817	- 1250	4333	3245	2735	1733	- 1192	4207	3150	2656	1682	- 1157		
50	10.0	Q[Btu/h]	36347	38160	28620	19080	- 15861	37924	39816	29862	19908	- 16550	39262	41220	30915	20610	- 17133		
		W	4411	3294	2777	1759	- 1214	4248	3172	2674	1694	- 1169	4084	3050	2571	1629	- 1124		
45	7.2	Q[Btu/h]	33506	35560	26670	17780	- 14438	35085	37236	27927	18618	- 15118	36389	38620	28965	19310	- 15680		
		W	4319	3198	2696	1708	- 1188	4121	3051	2572	1629	- 1134	3962	2934	2473	1567	- 1090		
40	4.4	Q[Btu/h]	27993	29664	22248	14832	- 13018	29434	31190	23393	15595	- 13688	30592	32418	24314	16209	- 14227		
		W	4185	3144	2650	1679	- 1151	3993	2999	2529	1602	- 1099	3840	2884	2431	1540	- 1056		
35	1.7	Q[Btu/h]	26268	27324	20493	13662	- 11651	27752	28868	21651	14434	- 12310	28915	30078	22559	15039	- 12825		
		W	4057	2880	2428	1538	- 1116	3871	2748	2317	1468	- 1065	3722	2643	2228	1411	- 1024		
30	-1.1	Q[Btu/h]	26237	26372	19779	-	- 15917	27878	28021	21016	-	- 16912	29129	29279	21959	-	- 17671		
		W	3960	2852	2404	-	- 1853	3780	2722	2295	-	- 1768	3600	2593	2185	-	- 1684		
25	-3.9	Q[Btu/h]	25131	23902	17927	-	- 15013	26885	25570	19178	-	- 16061	28187	26809	20107	-	- 16839		
		W	3825	2580	2175	-	- 1817	3651	2462	2076	-	- 1735	3477	2345	1977	-	- 1652		
20	-6.7	Q[Btu/h]	24388	21432	16074	-	- 14095	26308	23119	17339	-	- 15204	27696	24339	18254	-	- 16006		
		W	3791	2537	2139	-	- 1831	3590	2402	2025	-	- 1734	3355	2245	1893	-	- 1620		
15	-9.4	Q[Btu/h]	23974	18962	14222	-	- 13183	26131	20668	15501	-	- 14369	27649	21869	16402	-	- 15204		
		W	3658	2167	1827	-	- 1796	3464	2052	1730	-	- 1701	3237	1918	1617	-	- 1589		
10	-12.2	Q[Btu/h]	23841	16492	-	-	- 16790	26335	18217	-	-	- 18547	28043	19399	-	-	- 19750		
		W	3520	1828	-	-	- 2701	3333	1731	-	-	- 2558	3115	1618	-	-	- 2390		
5	-15.0	Q[Btu/h]	23100	14022	-	-	- 16104	25973	15766	-	-	- 18107	27888	16929	-	-	- 19442		
		W	3591	1667	-	-	- 2787	3322	1542	-	-	- 2578	2993	1389	-	-	- 2322		

\* Above data is for heating operation without any frost.

**MXZ-5C42NA MXZ-5C42NA2-U1 MXZ-5C42NA3-U1 MXZ-5C42NA4-U1**

**1) COOLING**

**Rated**  
**Q(Btu/h): 40500**  
**W: 4403**  
**Max. Q(Btu/h): 43000**

Indoor W.B. Outdoor D.B. (°F) (°C)	72°F / 22.2°C					67°F / 19.4°C					64°F / 17.8°C					61°F / 16.1°C				
	Max.	Rated	75%	50%	25% Min.	Max.	Rated	75%	50%	25% Min.	Max.	Rated	75%	50%	25% Min.	Max.	Rated	75%	50%	25% Min.
115 46.1 Q[Btu/h] W	41193	32400	24300	16200	- 13953	39649	31185	23389	15593	- 13430	39134	30780	23085	15390	- 13255	36044	28350	21263	14175	- 12209
110 43.3 Q[Btu/h] W	43628	40176	30132	20088	- 14817	40901	37665	28249	18833	- 13891	37822	34830	26123	17415	- 12845	30786	28350	21263	14175	- 10456
106 41.1 Q[Btu/h] W	46187	42525	31894	21263	- 15750	41788	38475	28856	19238	- 14250	37830	34830	26123	17415	- 12900	30791	28350	21263	14175	- 10500
102 38.9 Q[Btu/h] W	47140	42930	32198	21465	- 16128	42693	38880	29160	19440	- 14606	38245	34830	26123	17415	- 13085	31130	28350	21263	14175	- 10650
98 36.7 Q[Btu/h] W	47827	43740	32805	21870	- 16487	43398	39690	29768	19845	- 14960	38084	34830	26123	17415	- 13128	30999	28350	21263	14175	- 10686
94 34.4 Q[Btu/h] W	48180	44550	33413	22275	- 16860	43800	40500	30375	20250	- 15327	37668	34830	26123	17415	- 13181	30660	28350	21263	14175	- 10729
90 32.2 Q[Btu/h] W	48180	44550	33413	22275	- 17241	43800	40500	30375	20250	- 15673	37668	34830	26123	17415	- 13479	30660	28350	21263	14175	- 10971
86 30 Q[Btu/h] W	48180	44550	33413	22275	- 17618	43800	40500	30375	20250	- 16017	37668	34830	26123	17415	- 13774	30660	28350	21263	14175	- 11212
82 27.8 Q[Btu/h] W	48180	44550	33413	22275	- 17998	43800	40500	30375	20250	- 16361	37668	34830	26123	17415	- 14071	30660	28350	21263	14175	- 11453
78 25.6 Q[Btu/h] W	48180	44550	33413	22275	- 18373	43800	40500	30375	20250	- 16702	37668	34830	26123	17415	- 14364	30660	28350	21263	14175	- 11692
74 23.3 Q[Btu/h] W	48180	44550	33413	22275	- 18763	43800	40500	30375	20250	- 17057	37668	34830	26123	17415	- 14669	30660	28350	21263	14175	- 11940
70 21.1 Q[Btu/h] W	48180	44550	33413	22275	- 19133	43800	40500	30375	20250	- 17394	37668	34830	26123	17415	- 14959	30660	28350	21263	14175	- 12176
66 18.9 Q[Btu/h] W	48180	44550	33413	22275	- 19501	43800	40500	30375	20250	- 17728	37668	34830	26123	17415	- 15246	30660	28350	21263	14175	- 12410
62 16.7 Q[Btu/h] W	48180	44550	33413	22275	- 19867	43800	40500	30375	20250	- 18061	37668	34830	26123	17415	- 15532	30660	28350	21263	14175	- 12642
58 14.4 Q[Btu/h] W	48180	44550	33413	22275	- 20246	43800	40500	30375	20250	- 18405	37668	34830	26123	17415	- 15828	30660	28350	21263	14175	- 12884
54 12.2 Q[Btu/h] W	48180	44550	33413	22275	- 20606	43800	40500	30375	20250	- 18733	37668	34830	26123	17415	- 16110	30660	28350	21263	14175	- 13113
50 10 Q[Btu/h] W	48180	44550	33413	22275	- 20963	43800	40500	30375	20250	- 19057	37668	34830	26123	17415	- 16389	30660	28350	21263	14175	- 13340
46 7.8 Q[Btu/h] W	48180	44550	33413	22275	- 21318	43800	40500	30375	20250	- 19380	37668	34830	26123	17415	- 16667	30660	28350	21263	14175	- 13566
42 5.6 Q[Btu/h] W	48180	44550	33413	22275	- 20500	43800	40500	30375	20250	- 18636	37668	34830	26123	17415	- 16027	30660	28350	21263	14175	- 13045
38 3.3 Q[Btu/h] W	48180	44550	33413	22275	- 20878	43800	40500	30375	20250	- 18980	37668	34830	26123	17415	- 16323	30660	28350	21263	14175	- 13286
34 1.1 Q[Btu/h] W	48180	44550	33413	22275	- 20868	43800	40500	30375	20250	- 18971	37668	34830	26123	17415	- 16315	30660	28350	21263	14175	- 13280
30 -1.1 Q[Btu/h] W	48180	44550	33413	22275	- 19445	43800	40500	30375	20250	- 17677	37668	34830	26123	17415	- 15202	30660	28350	21263	14175	- 12374
26 -3.3 Q[Btu/h] W	48180	44550	33413	22275	- 19822	43800	40500	30375	20250	- 18020	37668	34830	26123	17415	- 15497	30660	28350	21263	14175	- 12614
22 -5.6 Q[Btu/h] W	48180	44550	33413	22275	- 20212	43800	40500	30375	20250	- 18374	37668	34830	26123	17415	- 15802	30660	28350	21263	14175	- 12862
18 -7.8 Q[Btu/h] W	48180	44550	33413	22275	- 20583	43800	40500	30375	20250	- 18711	37668	34830	26123	17415	- 16092	30660	28350	21263	14175	- 13098
14 -10 Q[Btu/h] W	48180	44550	33413	22275	- 20952	43800	40500	30375	20250	- 19047	37668	34830	26123	17415	- 16380	30660	28350	21263	14175	- 13333

\* It may not reach the above capacities in low ambient temperatures.  
 \* An air outlet guide is needed for ambient temperatures below 41°F.



**MXZ-5C42NA MXZ-5C42NA2-U1 MXZ-5C42NA3-U1 MXZ-5C42NA4-U1**

**2) HEATING**

**Rated**  
Q(Btu/h): 45000  
W: 3575

**Max.**  
Q(Btu/h): 53600

Indoor D.B. Outdoor W.B. (°F) (°C)	80°F/26.7°C						70°F / 21.1°C						60°F/15.6°C					
	Max.	Rated	75%	50%	25%	Min.	Max.	Rated	75%	50%	25%	Min.	Max.	Rated	75%	50%	25%	Min.
65 18.3 Q[Btu/h]	49353	54003	40502	27002	-	24012	51679	55878	41909	27939	-	24846	53600	57599	43199	28799	-	25611
W	6714	4522	3812	2415	-	1442	6406	4353	3670	2324	-	1389	6160	4226	3563	2257	-	1348
60 15.6 Q[Btu/h]	49353	50948	38211	25474	-	22397	51679	52847	39635	26423	-	23232	53600	54544	40908	27272	-	23977
W	6714	4359	3675	2328	-	1407	6406	4196	3537	2241	-	1355	6160	4074	3434	2175	-	1315
55 12.8 Q[Btu/h]	49353	47893	35920	23947	-	20727	51679	49815	37361	24908	-	21559	53600	51489	38616	25744	-	22283
W	6714	4153	3501	2218	-	1384	6406	3961	3339	2115	-	1320	6160	3845	3242	2053	-	1281
50 10.0 Q[Btu/h]	49353	44838	33629	22419	-	19060	51679	46784	35088	23392	-	19888	53600	48434	36325	24217	-	20589
W	6714	4038	3404	2156	-	1347	6406	3889	3278	2076	-	1297	6160	3739	3152	1997	-	1248
45 7.2 Q[Btu/h]	49353	41783	31337	20892	-	17398	51679	43752	32814	21876	-	18218	53600	45379	34034	22689	-	18895
W	6714	3905	3292	2085	-	1323	6406	3726	3141	1990	-	1262	6160	3583	3020	1913	-	1214
40 4.4 Q[Btu/h]	40982	34855	26141	17428	-	15739	43091	36649	27487	18324	-	16549	44787	38091	28568	19046	-	17200
W	6433	3963	3341	2116	-	1286	6138	3781	3188	2019	-	1227	5902	3636	3065	1942	-	1180
35 1.7 Q[Btu/h]	37993	32106	24079	16053	-	14141	40140	33920	25440	16960	-	14941	41822	35342	26506	17671	-	15567
W	6093	3598	3033	1921	-	1239	5868	3465	2921	1850	-	1193	5642	3331	2808	1779	-	1147
30 -1.1 Q[Btu/h]	37222	30987	23240	-	-	17756	39549	32925	24694	-	-	18867	41325	34403	25802	-	-	19713
W	5802	3713	3130	-	-	1702	5588	3575	3014	-	-	1639	5373	3438	2898	-	-	1576
25 -3.9 Q[Btu/h]	34714	28085	21064	-	-	16503	37136	30045	22534	-	-	17655	38936	31501	23625	-	-	18510
W	5460	2982	2514	-	-	1653	5307	2899	2444	-	-	1607	5103	2787	2350	-	-	1545
20 -6.7 Q[Btu/h]	32562	25183	18887	-	-	15240	35125	27165	20374	-	-	16440	36979	28598	21449	-	-	17307
W	5172	3096	2610	-	-	1621	5027	3009	2537	-	-	1575	4834	2894	2439	-	-	1515
15 -9.4 Q[Btu/h]	30781	22280	16710	-	-	14001	33551	24285	18214	-	-	15261	35500	25696	19272	-	-	16147
W	4894	2587	2181	-	-	1590	4894	2587	2181	-	-	1590	4574	2418	2038	-	-	1486
10 -12.2 Q[Btu/h]	29238	19378	-	-	-	17313	32297	21405	-	-	-	19124	34392	22794	-	-	-	20364
W	4563	2224	-	-	-	2201	4434	2161	-	-	-	2139	4305	2098	-	-	-	2076
5 -15.0 Q[Btu/h]	27926	16476	-	-	-	19414	31399	18525	-	-	-	21829	33715	19892	-	-	-	23439
W	4277	1856	-	-	-	2725	4156	1804	-	-	-	2648	4035	1751	-	-	-	2571

\* Above data is for heating operation without any frost.



**MXZ-2C20NAHZ MXZ-2C20NAHZ2-U1 MXZ-2C20NAHZ3-U1 MXZ-2C20NAHZ4-U1**  
**2) HEATING**

**Rated**                      **MAX.**  
 Q(Btu/h): 22000      Q(BTU/H): 25500  
 W: 1612              W: 3650

Indoor D.B.			80°F/26.7°C					70°F / 21.1°C					60°F/15.6°C							
Outdoor W.B.			Max.	Rated	75%	50%	25%	Min.	Max.	Rated	75%	50%	25%	Min.	Max.	Rated	75%	50%	25%	Min.
(°F)	(°C)																			
65	18.3	Q[Btu/h]	37925	27614	20711	-	-	17793	39317	28627	21471	-	-	18446	40493	29484	22113	-	-	18998
		W	3338	1897	1599	-	-	1065	3213	1826	1540	-	-	1026	3119	1773	1495	-	-	996
60	15.6	Q[Btu/h]	34415	26178	19634	-	-	16433	35746	27191	20393	-	-	17069	36873	28048	21036	-	-	17607
		W	3185	1837	1549	-	-	1044	3066	1768	1491	-	-	1005	2977	1717	1447	-	-	976
55	12.8	Q[Btu/h]	31200	24742	18557	-	-	15028	32478	25755	19316	-	-	15644	33559	26612	19959	-	-	16164
		W	3056	1753	1477	-	-	1031	2915	1671	1409	-	-	983	2830	1623	1368	-	-	955
50	10.0	Q[Btu/h]	28412	23306	17479	-	-	13628	29648	24319	18239	-	-	14221	30692	25176	18882	-	-	14722
		W	2897	1645	1386	-	-	1008	2790	1584	1335	-	-	971	2682	1523	1284	-	-	934
47	7.2	Q[Btu/h]	26099	22444	16833	-	-	12258	27278	23457	17593	-	-	12811	28274	24314	18236	-	-	13279
		W	2763	1632	1376	-	-	995	2636	1557	1313	-	-	949	2535	1498	1262	-	-	913
42	4.4	Q[Btu/h]	21738	18907	14180	-	-	10869	22787	19819	14864	-	-	11394	23673	20590	15443	-	-	11837
		W	2602	1687	1422	-	-	972	2483	1609	1357	-	-	927	2388	1548	1305	-	-	892
35	1.7	Q[Btu/h]	24347	18909	14182	-	-	17584	25495	19800	14850	-	-	18412	26515	20592	15444	-	-	19149
		W	3517	1956	1649	-	-	1652	3386	1884	1588	-	-	1591	3256	1811	1527	-	-	1530
32	-1.1	Q[Btu/h]	24810	19960	14970	-	-	16350	25979	20900	15675	-	-	17121	27018	21736	16302	-	-	17806
		W	3363	2064	1740	-	-	1607	3239	1988	1676	-	-	1547	3114	1911	1611	-	-	1488
27	-3.9	Q[Btu/h]	23317	19960	14970	-	-	15251	24416	20900	15675	-	-	15969	25392	21736	16302	-	-	16608
		W	3187	2066	1742	-	-	1553	3098	2008	1693	-	-	1509	2979	1931	1628	-	-	1451
22	-6.7	Q[Btu/h]	22024	19960	14970	-	-	14281	23062	20900	15675	-	-	14954	23984	21736	16302	-	-	15552
		W	3058	2173	1832	-	-	1520	2973	2112	1781	-	-	1478	2858	2031	1712	-	-	1421
17	-9.4	Q[Btu/h]	20975	19960	14970	-	-	13478	21964	20900	15675	-	-	14113	22842	21736	16302	-	-	14678
		W	2947	2280	1922	-	-	1495	2947	2280	1922	-	-	1495	2754	2131	1797	-	-	1397
12	-12.2	Q[Btu/h]	24102	19960	14970	-	-	15134	25237	20900	15675	-	-	15847	26247	21736	16302	-	-	16481
		W	3675	2560	2158	-	-	1780	3571	2487	2097	-	-	1730	3467	2415	2036	-	-	1680
5	-15.0	Q[Btu/h]	23511	19960	14970	-	-	14559	24619	20900	15675	-	-	15245	25603	21736	16302	-	-	15855
		W	3499	2666	2247	-	-	1748	3400	2590	2184	-	-	1699	3301	2515	2120	-	-	1649
2	-17.8	Q[Btu/h]	23405	19298	-	-	-	17480	24521	20217	-	-	-	18313	25501	21025	-	-	-	19045
		W	3903	2991	-	-	-	2491	3611	2766	-	-	-	2305	3253	2492	-	-	-	2076
-3	-20.6	Q[Btu/h]	23334	16540	-	-	-	17164	24509	17373	-	-	-	18027	25485	18065	-	-	-	18746
		W	3247	2542	-	-	-	2143	3155	2470	-	-	-	2083	3063	2398	-	-	-	2022
-8	-23.3	Q[Btu/h]	23074	13782	-	-	-	17147	24322	14528	-	-	-	18074	25286	15104	-	-	-	18791
		W	2971	2442	-	-	-	2083	2887	2373	-	-	-	2024	2803	2304	-	-	-	1965
-13	-26.1	Q[Btu/h]	22740	-	-	-	-	17188	24079	-	-	-	-	18117	25112	-	-	-	-	17836
		W	2719	-	-	-	-	2024	2805	-	-	-	-	1966	2565	-	-	-	-	1909

\* Above data is for heating operation without any frost.



**MXZ-3C24NAHZ MXZ-3C24NAHZ2 - U1 MXZ-3C24NAHZ3 - U1 MXZ-3C24NAHZ4 - U1**  
**2) HEATING**

**Rated** **Max.**  
 Q(Btu/h): 25000 Q(Btu/h): 30600  
 W: 1725 W: 4540

Indoor D.B.			80°F/26.7°C						70°F / 21.1°C						60°F/15.6°C					
Outdoor W.B.			Max.	Rated	75%	50%	25%	Min.	Max.	Rated	75%	50%	25%	Min.	Max.	Rated	75%	50%	25%	Min.
(°F)	(°C)																			
65	18.3	Q[Btu/h]	38201	31380	23535	-	-	17806	39602	32531	24398	-	-	18459	40788	33505	25129	-	-	19011
		W	4804	2030	1712	-	-	1512	4625	1954	1648	-	-	1456	4490	1898	1600	-	-	1413
60	15.6	Q[Btu/h]	35737	29748	22311	-	-	16600	37120	30899	23174	-	-	17242	38290	31873	23905	-	-	17785
		W	4569	1966	1657	-	-	1457	4398	1892	1595	-	-	1403	4270	1837	1549	-	-	1362
55	12.8	Q[Btu/h]	33297	28116	21087	-	-	15402	34661	29267	21950	-	-	16033	35814	30241	22681	-	-	16567
		W	4377	1875	1581	-	-	1415	4175	1789	1508	-	-	1350	4053	1737	1464	-	-	1310
50	10.0	Q[Btu/h]	30978	26484	19863	-	-	14266	32325	27635	20726	-	-	14886	33464	28609	21457	-	-	15411
		W	4157	1767	1490	-	-	1363	4003	1702	1435	-	-	1313	3849	1637	1380	-	-	1262
47	7.2	Q[Btu/h]	28707	25505	19129	-	-	13145	30003	26656	19992	-	-	13738	31099	27630	20722	-	-	14240
		W	3975	1751	1476	-	-	1324	3793	1670	1408	-	-	1263	3647	1606	1354	-	-	1214
42	4.4	Q[Btu/h]	24119	21486	16114	-	-	12203	25282	22522	16891	-	-	12791	26266	23398	17549	-	-	13289
		W	3801	1805	1522	-	-	1282	3627	1722	1452	-	-	1223	3487	1656	1396	-	-	1176
35	1.7	Q[Btu/h]	28722	21488	16116	-	-	11359	30076	22500	16875	-	-	11894	31279	23400	17550	-	-	12370
		W	5571	2093	1765	-	-	1232	5364	2016	1699	-	-	1187	5158	1938	1634	-	-	1141
32	-1.1	Q[Btu/h]	28495	22681	17011	-	-	16716	29838	23750	17813	-	-	17503	31031	24700	18525	-	-	18203
		W	5297	2201	1856	-	-	2054	5101	2120	1787	-	-	1978	4904	2038	1718	-	-	1902
27	-3.9	Q[Btu/h]	26862	22681	17011	-	-	15625	28127	23750	17813	-	-	16361	29252	24700	18525	-	-	17016
		W	5006	2219	1870	-	-	1946	4865	2156	1818	-	-	1891	4678	2074	1748	-	-	1818
22	-6.7	Q[Btu/h]	25439	22681	17011	-	-	14651	26638	23750	17813	-	-	15341	27703	24700	18525	-	-	15955
		W	4791	2326	1961	-	-	1867	4657	2260	1906	-	-	1814	4478	2174	1832	-	-	1744
17	-9.4	Q[Btu/h]	24284	22681	17011	-	-	13830	25429	23750	17813	-	-	14481	26446	24700	18525	-	-	15061
		W	4608	2433	2051	-	-	1800	4608	2433	2051	-	-	1800	4307	2274	1917	-	-	1682
12	-12.2	Q[Btu/h]	29309	22681	17011	-	-	17351	30690	23750	17813	-	-	18169	31918	24700	18525	-	-	18896
		W	6161	2746	2315	-	-	2524	5986	2669	2250	-	-	2453	5812	2591	2184	-	-	2381
5	-15.0	Q[Btu/h]	28644	22681	17011	-	-	16654	29993	23750	17813	-	-	17439	31193	24700	18525	-	-	18136
		W	5827	2852	2405	-	-	2413	5662	2772	2337	-	-	2345	5497	2691	2269	-	-	2277
2	-17.8	Q[Btu/h]	28531	21929	-	-	-	19653	29890	22974	-	-	-	20590	31085	23893	-	-	-	21413
		W	6482	3200	-	-	-	3471	5996	2960	-	-	-	3211	5402	2667	-	-	-	2893
-3	-20.6	Q[Btu/h]	28593	18795	-	-	-	19138	30032	19742	-	-	-	20101	31228	20528	-	-	-	20902
		W	5274	2720	-	-	-	2899	5125	2643	-	-	-	2817	4975	2566	-	-	-	2735
-8	-23.3	Q[Btu/h]	27683	15662	-	-	-	18885	29180	16509	-	-	-	19906	30337	17163	-	-	-	20695
		W	5190	2614	-	-	-	2734	5043	2540	-	-	-	2657	4896	2466	-	-	-	2579
-13	-26.1	Q[Btu/h]	27301	-	-	-	-	18752	28923	-	-	-	-	19766	29277	-	-	-	-	20550
		W	4835	-	-	-	-	2512	4698	-	-	-	-	2440	4561	-	-	-	-	2369

\* Above data is for heating operation without any frost.



**MXZ-3C30NAHZ MXZ-3C30NAHZ2 - U1 MXZ-3C30NAHZ3 - U1 MXZ-3C30NAHZ4 - U1**  
**2) HEATING**

**Rated** **Max.**  
 Q(Btu/h): 28600 Q(Btu/h): 36000  
 W: 2096

Indoor D.B.			80°F/26.7°C						70°F / 21.1°C						60°F/15.6°C					
Outdoor W.B.			Max.	Rated	75%	50%	25%	Min.	Max.	Rated	75%	50%	25%	Min.	Max.	Rated	75%	50%	25%	Min.
(°F)	(°C)																			
65	18.3	Q[Btu/h]	44408	32309	24231	16154	- 17806	46038	33494	25121	16747	- 18459	47416	34497	25872	17248	- 19011			
		W	4468	2837	2392	1515	- 1512	4301	2731	2302	1458	- 1456	4176	2651	2235	1416	- 1413			
60	15.6	Q[Btu/h]	41544	30628	22971	15314	- 16600	43152	31814	23860	15907	- 17242	44512	32816	24612	16408	- 17785			
		W	4249	2747	2316	1467	- 1457	4091	2644	2229	1412	- 1403	3971	2567	2164	1371	- 1362			
55	12.8	Q[Btu/h]	38708	28948	21711	14474	- 15402	40293	30134	22600	15067	- 16033	41634	31136	23352	15568	- 16567			
		W	4071	2621	2209	1399	- 1415	3882	2499	2107	1335	- 1350	3769	2426	2046	1296	- 1310			
50	10.0	Q[Btu/h]	36012	27268	20451	13634	- 14266	37578	28453	21340	14227	- 14886	38902	29456	22092	14728	- 15411			
		W	3866	2496	2104	1333	- 1363	3723	2404	2027	1284	- 1313	3579	2311	1949	1234	- 1262			
47	7.2	Q[Btu/h]	33372	26260	19695	13130	- 13145	34878	27445	20584	13723	- 13738	36152	28448	21336	14224	- 14240			
		W	3697	2460	2073	1313	- 1324	3527	2347	1978	1253	- 1263	3392	2256	1902	1205	- 1214			
42	4.4	Q[Btu/h]	28038	22122	16591	11061	- 12203	29390	23188	17391	11594	- 12791	30534	24091	18068	12045	- 13289			
		W	3535	2522	2126	1347	- 1282	3373	2407	2029	1285	- 1223	3243	2314	1951	1236	- 1176			
35	1.7	Q[Btu/h]	33390	22124	16593	11062	- 11359	34963	23166	17375	11583	- 11894	36362	24093	18069	12046	- 12370			
		W	5181	2925	2466	1562	- 1232	4989	2817	2375	1504	- 1187	4797	2708	2283	1446	- 1141			
32	-1.1	Q[Btu/h]	33125	23353	17514	-	- 16716	34686	24453	18340	-	- 17503	36074	25431	19073	-	- 18203			
		W	4926	3049	2571	-	- 2054	4744	2936	2475	-	- 1978	4561	2823	2380	-	- 1902			
27	-3.9	Q[Btu/h]	31227	23353	17514	-	- 15625	32698	24453	18340	-	- 16361	34006	25431	19073	-	- 17016			
		W	4655	3127	2636	-	- 1946	4525	3039	2562	-	- 1891	4351	2922	2463	-	- 1818			
22	-6.7	Q[Btu/h]	29573	23353	17514	-	- 14651	30967	24453	18340	-	- 15341	32205	25431	19073	-	- 15955			
		W	4456	3250	2739	-	- 1867	4331	3159	2663	-	- 1814	4164	3037	2560	-	- 1744			
17	-9.4	Q[Btu/h]	28231	23353	17514	-	- 13830	29561	24453	18340	-	- 14481	30743	25431	19073	-	- 15061			
		W	4286	3373	2843	-	- 1800	4286	3373	2843	-	- 1800	4005	3152	2657	-	- 1682			
12	-12.2	Q[Btu/h]	34072	23353	17514	-	- 17351	35678	24453	18340	-	- 18169	37105	25431	19073	-	- 18896			
		W	5729	3864	3257	-	- 2524	5567	3755	3165	-	- 2453	5405	3645	3073	-	- 2381			
5	-15.0	Q[Btu/h]	33298	23353	17514	-	- 16654	34867	24453	18340	-	- 17439	36262	25431	19073	-	- 18136			
		W	5419	3986	3360	-	- 2413	5266	3873	3265	-	- 2345	5113	3760	3170	-	- 2277			
2	-17.8	Q[Btu/h]	33167	22578	19033	-	- 19653	34747	23654	19940	-	- 20590	36136	24600	18450	-	- 21413			
		W	6029	4472	3770	-	- 3471	5577	4136	3487	-	- 3211	5024	3726	3141	-	- 2893			
-3	-20.6	Q[Btu/h]	33239	19352	-	-	- 19138	34912	20326	-	-	- 20101	36303	21136	-	-	- 20902			
		W	4905	3801	-	-	- 2899	4766	3693	-	-	- 2817	4627	3586	-	-	- 2735			
-8	-23.3	Q[Btu/h]	33242	16125	-	-	- 18885	35040	16998	-	-	- 19906	36429	17671	-	-	- 20695			
		W	4827	3652	-	-	- 2734	4690	3549	-	-	- 2657	4554	3445	-	-	- 2579			
-13	-26.1	Q[Btu/h]	32334	-	-	-	- 18752	34137	-	-	-	- 19766	35530	-	-	-	- 20550			
		W	4740	-	-	-	- 2512	4606	-	-	-	- 2440	4472	-	-	-	- 2369			

\* Above data is for heating operation without any frost.

# **mitsubishi electric corporation**

HEAD OFFICE: TOKYO BUILDING, 2-7-3, MARUNOUCHI, CHIYODA-KU, TOKYO 100-8310, JAPAN

© Copyright 2018 MITSUBISHI ELECTRIC CORPORATION

Issued: Oct. 2022. No. OBD702 REVISED EDITION-B

Issued: Dec. 2021. No. OBD702 REVISED EDITION-A

Published: Nov. 2018. No. OBD702 IN M-E0764

Made in Japan

Specifications are subject to change without notice.