

## Ravello Vanity: N242-V36-BW N242-V36-DPO N242-V36-SBL Assembly/Installation Instructions

### Step 1 Notes: PROPER HANDLING OF COUNTERTOP TOP

Please remove the top from the vanity .

Carefully lift the top vertically with two people

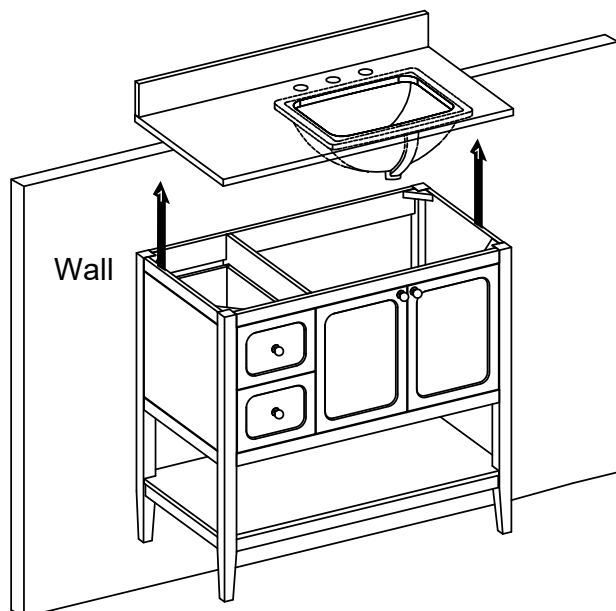

*Rotate the countertop and sink from flat position and lift top vertically.*

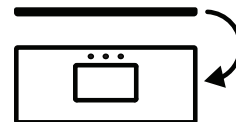

*Lift top vertically with two people.*

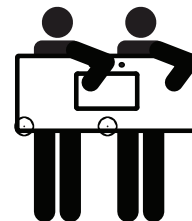

**NEVER LIFT OR CARRY THE VANITY TOP FLAT.**

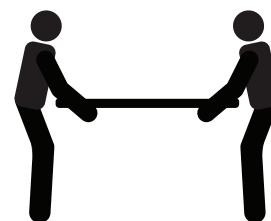

Step 2: Place the top and backsplash face down onto a scratch-free surface such as a foam sheet that came in the packaging.

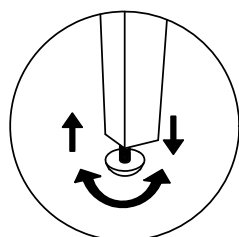
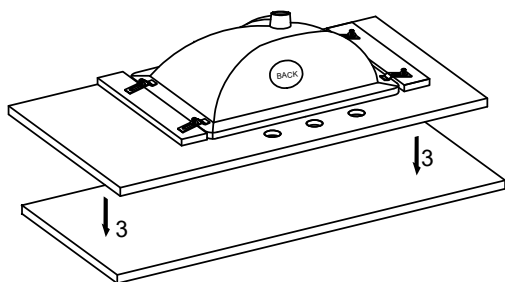

Step 3 Notes: Once the vanity is in place, against the wall, and level from front to back and side to side drill a hole through the vanity mounting area and into the wall studs (as illustrated in diagram). Using appropriate mounting hardware (not included), secure the vanity to a wall stud. If possible, secure the vanity to two wall studs for increased stability.

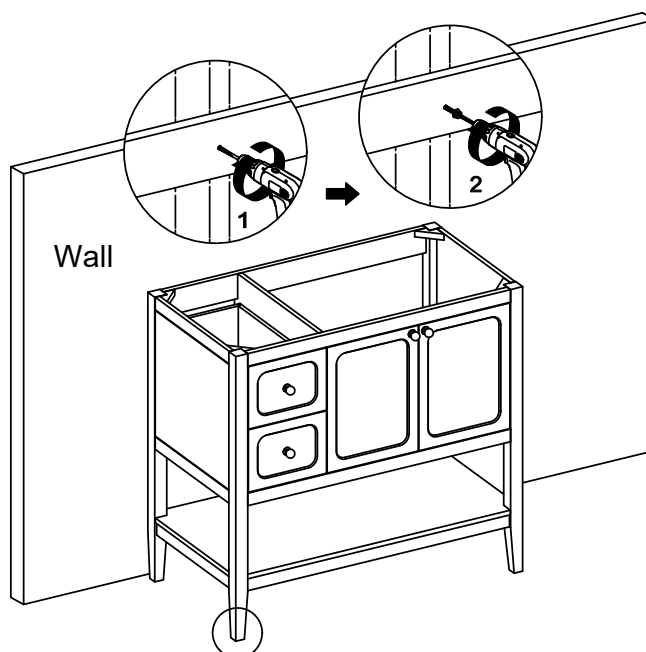



## Ravello Vanity: N242-V36-BW N242-V36-DPO N242-V36-SBL Assembly/Installation Instructions

Step 4 Notes: Apply stain free silicone caulk (not included) to the top edge of vanity.

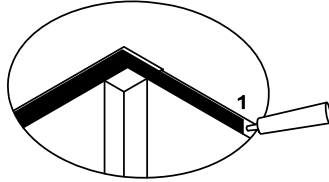

Step 5 Notes: Carefully lift the top vertically with two people and gently lower the vanity top onto the cabinet base and set it in place. Wipe away any excess caulk with a soft cloth, and wait approximately 24 hours for it to dry.

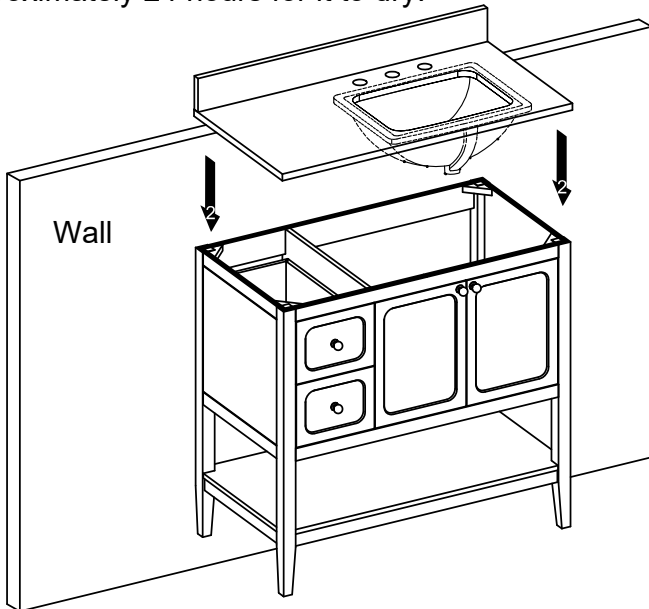

*Rotate the countertop and sink from flat position and lift top vertically.*

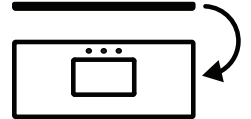

*Lift top vertically with two people.*

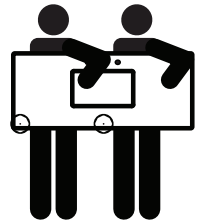

**NEVER LIFT OR CARRY THE VANITY TOP FLAT.**

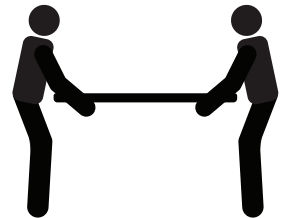

Step 6 Notes: Apply silicone caulk (not included) to unpolished side and bottom of backsplash. Position backsplash on top and against wall. Clean any excess caulk before allowing to dry.

