

Product Description & Information

The bathtub filler faucet upholds the timeless essence of antique faucet design while incorporating the benefits of modern day technology and convenience. Introduce a nostalgic look to your bathroom with our tub filler faucet that has two ergonomic lever handles, a corrosion and tarnish resistant finish, and an elegant brass hand-shower that produces a truly enjoyable bathing experience.

CAREFULLY READ THIS INSTRUCTION MANUAL BEFORE INSTALLING AND USING THIS PRODUCT.

PLEASE KEEP THIS INSTRUCTION MANUAL FOR FUTURE REFERENCE FOR PRODUCT OPERATION AND MAINTENANCE.

Features:

- Elegant Brass Hand Shower
- Solid Brass Construction
- Ceramic Disc Cartridge
- Swivel Spout

Package Contents :

- 1- Freestanding Tub Filler Faucet
- 1- Installation Accessories
- 1- Hand Shower And Hose
- 2- Cover Plate

TOOLS YOU WILL NEED:



Plumber' s putty



Pipe tape

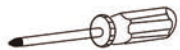

Phillips screwdriver



Pliers



Adjustable wrench

Cleaning and Care

Care should be exercised when cleaning this product. Although its finish is extremely durable, it can be damaged by harsh abrasives and cleaning pads. To clean, use a light, non-abrasive cleaning solution or cleaning polish.

Installation Instruction

Product Features:

Elegant Brass Hand Shower
Solid Brass Construction
Ceramic Disc Cartridge
Swivel Spout

Bathtub Filler Faucet Manual

Caution: This instructions book is written for universal use and subject to specification variance of actual parts.

The product is cUPC certified.

Original certification model code:DF-02024-2



For easy installation of your faucet please do the following:

- Thoroughly read all instruction before installing the enclosed faucet.
- Read and understand all warnings, care and maintenance information.

Product Diagram and Parts

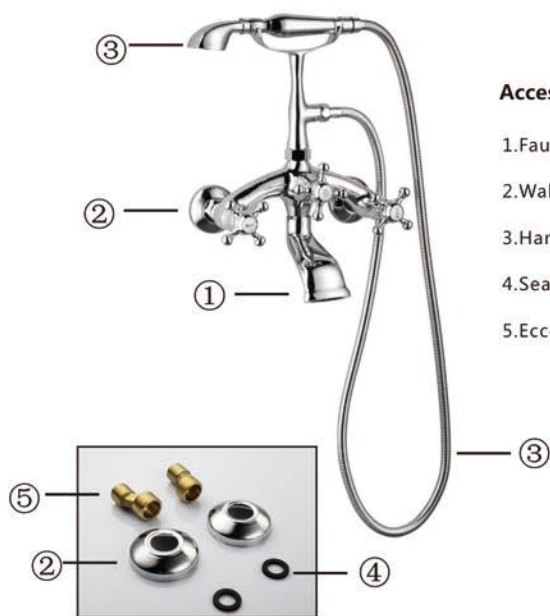

Accessory List:

1. Faucet Spout
2. Wall Cap × 2
3. Hand Shower and Hose
4. Seal washers × 2
5. Eccentric Nut × 2

Faucet Installation Steps

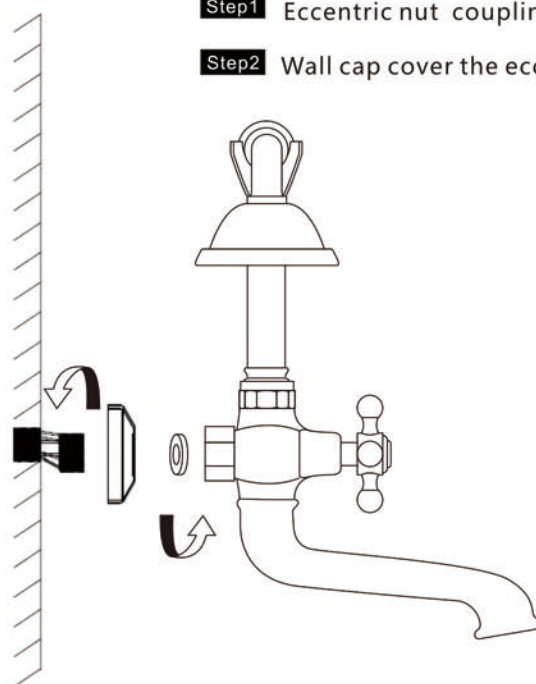

Step1 Eccentric nut couplings to wall.

Step2 Wall cap cover the eccentric nut.

Step3 Install two seal washers into couplings.
Align faucet with inlets of couplings and tighten.

Faucet Installation Steps

Faucet Installation Steps

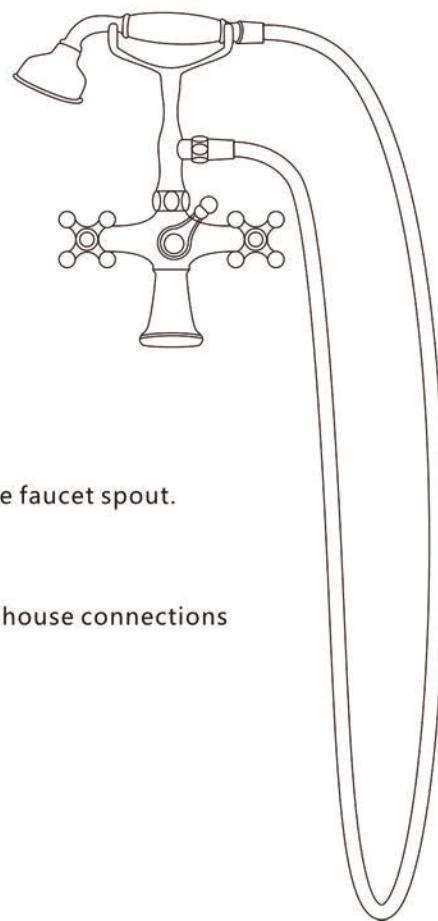

Step4 Install the hose to the hand shower and the faucet.
Confirm the faucet spout and hand shower functionality.

- a. Turn the faucet cross handle to the on position initiating flow through the faucet spout.
- b. Confirm proper hot and cold flow through spout.
- c. Remove the hand shower and direct towards the bath.
- d. Turn the diverter lever to direct flow from the spout to the hand shower.
- e. With water now flowing through the hand shower check all hand shower house connections for leaks and confirm proper flow through the hand shower.
- f. Turn faucet lever handle off.