

Faucet Installation Instructions

MNO821

- Please read these instructions carefully before starting the installation to avoid any unnecessary damage.
- Please check if the product is in a good condition after opening the package.
- Please keep these instructions after installation for reference.
- All illustration and dimensions provided by these instructions are only for reference. For the installation, please refer to the actual product.
- Before installing and using this product, user shall carefully read and understand the content of these instructions.

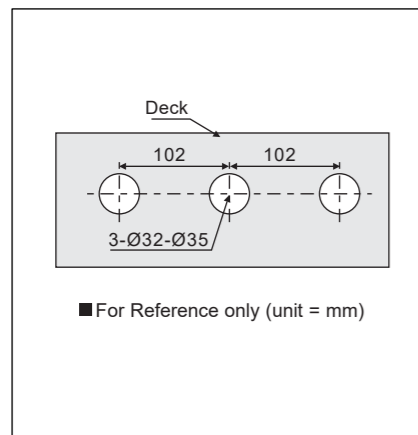

Step 1 Locating the faucet

Please read the installation dimensions carefully before drilling holes as shown. It can be adjusted as actual required. Take off bottom installing components and insert the faucet into the deck hole, then adjust it to an appropriate position.

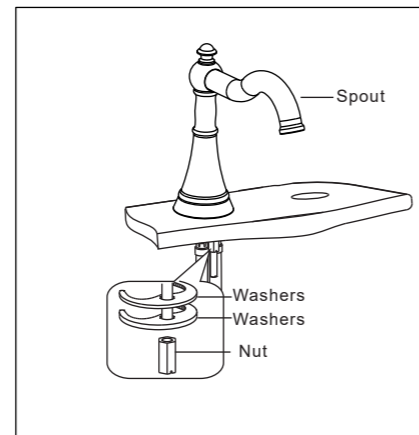

Step 2

Install the fitting of the spout from bottom to top. Then insert the spout into the fixing hole and adjust the position. Fasten the bolts with wrench and fix the spout on the deck.

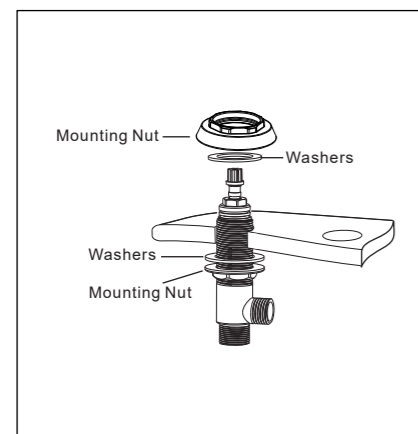

Step 3

Take off the handle and the nut. Insert valve assembly through the mounting hole from below and turn on the nut from above to appropriate position.

Secure the valve on the deck by tightening nut from below with wrench after appropriately adjusting.

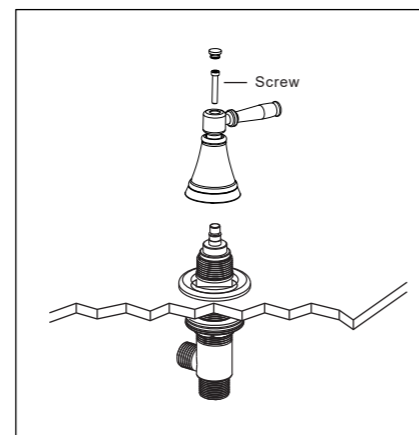

Step 4

As shown, install parts and fasten the handle on the valve core with screw. Rotate the handle to check if it is in order.

MISENO

For additional assistance or service call: 1-855-480-2915 or visit our website www.miseno.com

Faucet Installation Instructions

MNO821

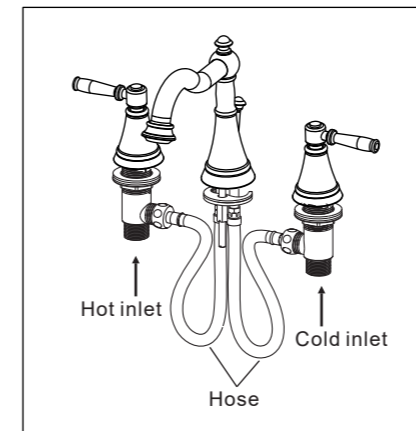

Step 5

Connect valve body and spout with hose as shown on picture. Connect water supply lines to bottom openings of handle valve stems.

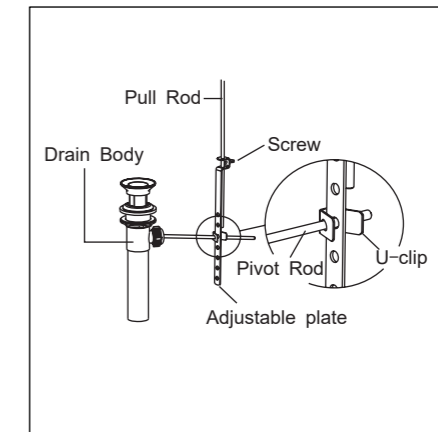

Step 6

Install the pop-up drain in the bott outlet of the lavatory as shown. Install washer above and below both the drain body and the lavatory to avoid leakage. Connect the stopper to the drain pipe. After installation, pull the pull rod up and down to check the stopper for proper movement and stopping water.

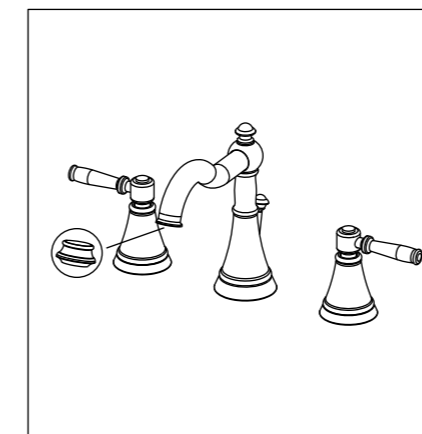

Step 7

Important: After installation is complete remove aerator and turn faucet on for two minutes to flush out any debris from the water lines. While water is running check for leaks.

Maintenance: Clean with warm water, soft cotton cloth and non-abrasive liquid dish soap. Towel dry. Never use acids, harsh abrasives or detergents.

MISENO

For additional assistance or service call: 1-855-480-2915 or visit our website www.miseno.com

Faucet Installation Instructions

MNO821

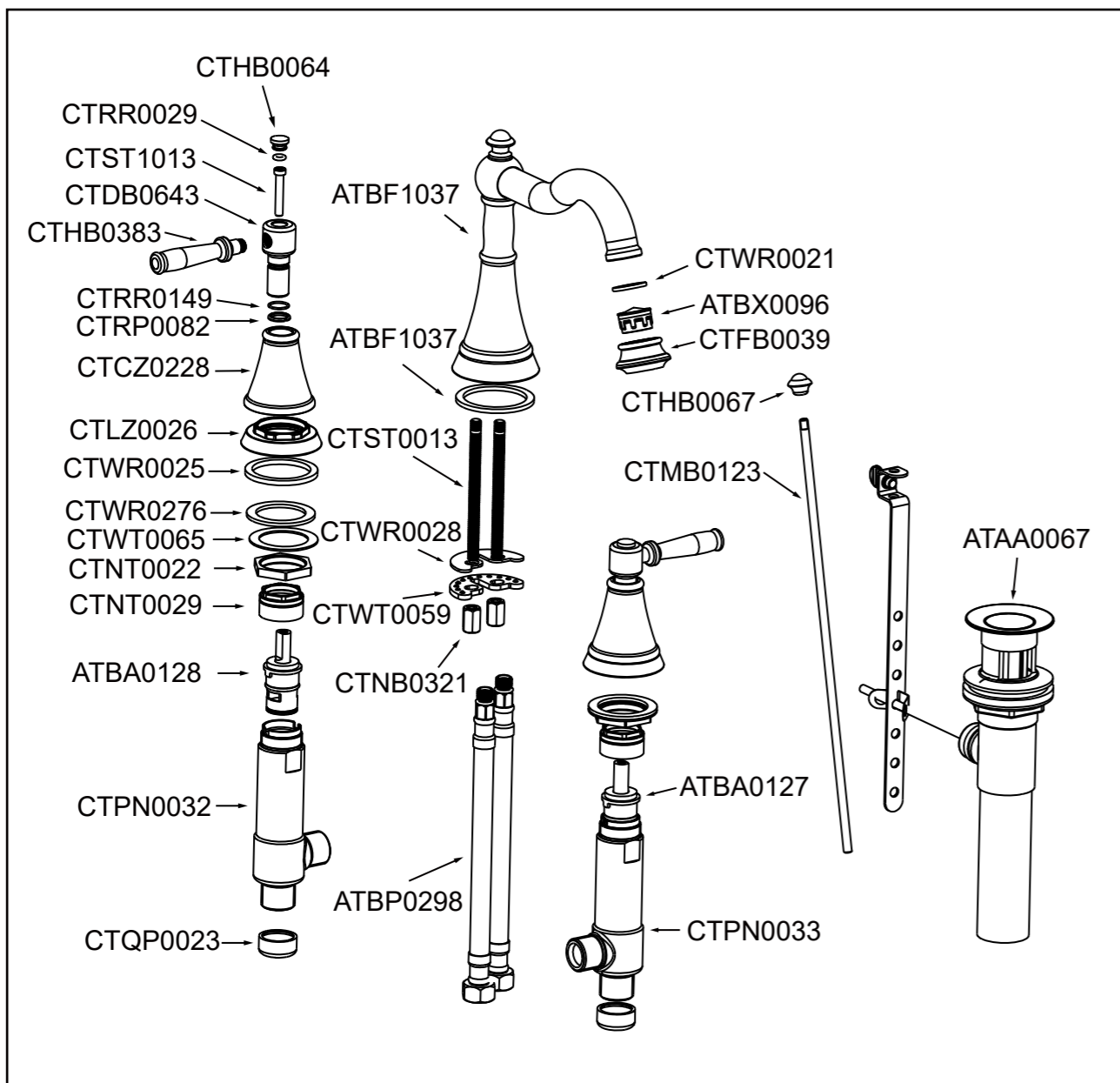

Finish Codes	*Specify Finish
CP	Polished Chrome
BN	Brushed Nickel
VB	Vintage Bronze

MISENO

For additional assistance or service call: 1-855-480-2915 or visit our website www.miseno.com