



## FEATURES

- RFID: Can be paired with existing MIFARE/NFC 13.56MHz systems or used separately
- Public and Private user modes
- Key override
- Up to 80,000 cycles per pair of AA batteries
- Batteries included
- Battery condition indicator
- Audible actuation (can be turned on/off)

## PROGRAMMING OPTIONS

Change master card, add user card, delete all user cards, delete single user card (with & without user card), set private mode & public mode, set audio, auto unlock, set read speed mode.

## ORDERING OPTIONS

**Finishes:** Silver (S), Black (B), Custom (C)\*  
**Push to Lock SLAM Latch (3)\***

## DIMENSIONS & SPECIFICATIONS

### External Dimensions:

- Length: 136mm (5.35in)
- Width: 37mm (1.46in)
- Depth: 30mm (1.18in)

**Mounting Hole Shape:** 2 or 3 point mounting

**Spindle Length:** 24mm standard, 20mm by special order\*

**Power:** 2 x AA Battery (Alkaline)

**Low Battery:** LED lights with battery condition indicator

**Material:** Zinc diecast

**Finish:** Powder coated

**Standard Cam Capability:** 1/4" to 1 1/2"

For Internal Use

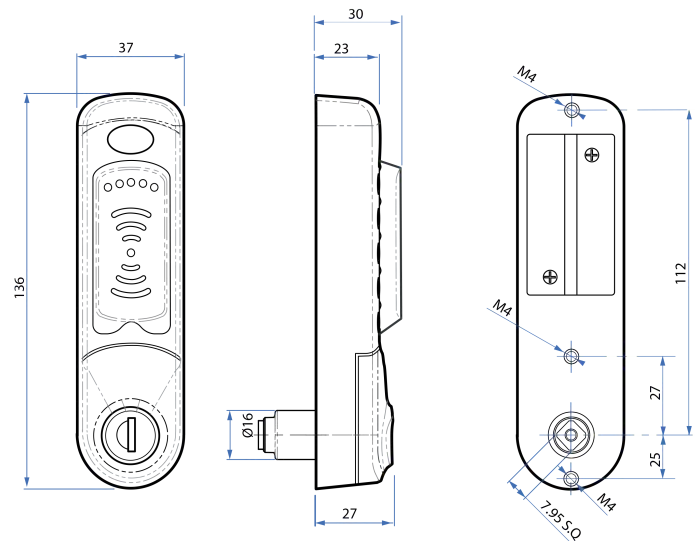

## ORDERING INFORMATION

Order # for EC-783 shown above is EC-783B

PART #	FINISH	SLAM LATCH	FLUSH FIT
EC-783	(S) SILVER (B) BLACK (C) CUSTOM*	(3) SLAM 	SEE PAGE 9

\*Contact LockeyUSA for minimum order quantities and lead times for special/custom orders.