

Wastewater

GP Series - Automatic



(U.S. Patent No. 7,237,736)

Applications

- Residential sewage waste transfer where high-head conditions exist

Features

- Powerful 2HP, 3450 RPM motor to handle the demands of grinding domestic sewage
- Mechanical float switch for automatic operation
- Start/Run components encased in oil-free chamber — requires no control panel
- Mechanical seal: carbon/ceramic
- Short motor shaft reduces deflection
- Corrosion resistant brass impeller
- Seven-vane, angled face, non-clogging impeller
- Tight cutting clearances for superior cutting action, grinding 414,000 cuts per minute
- Epoxy coated finish for corrosion resistance and durability
- Built-in overload protection prevents over-current and over-temperature damage
- GLK - Grinder Leg Kit included

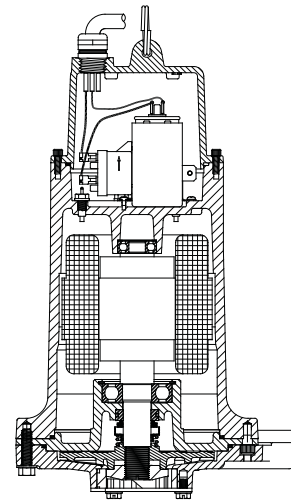

Little GIANT
Pumps. People. Partnerships.

Engineering Data

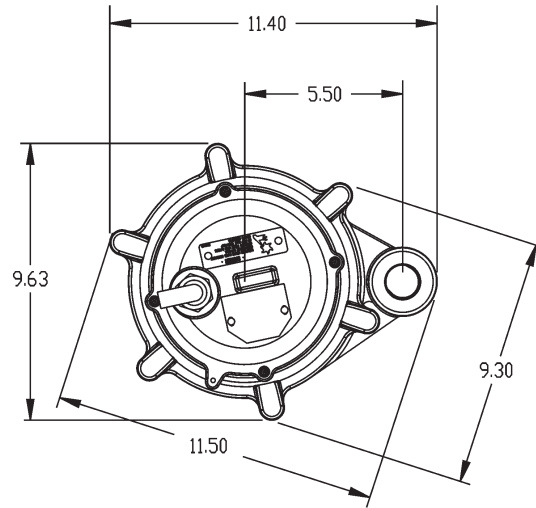
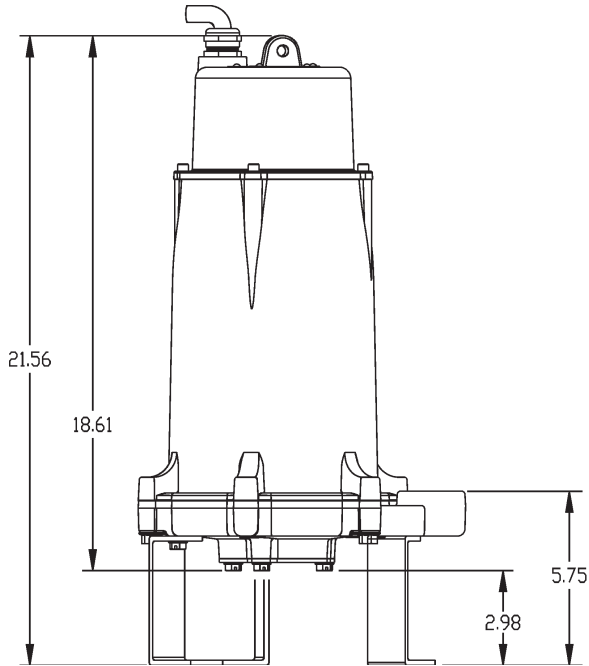

Leg Kit (Included)
GLK — Item No. 599078

Specifications

| Model No. | Item No. | Listing | HP | Volts | Hz | Full Load Amps/Watts | Performance (GPM@Head) | | | | | | Shutoff | P.S.I. | Weight (lb.) |
|------------|----------|---------|----|-------|----|----------------------|------------------------|-----|-----|-----|------|------|---------|--------|--------------|
| | | | | | | | 20' | 40' | 60' | 80' | 100' | 120' | | | |
| GP-A231-20 | 520875 | UL/CSA | 2 | 230 | 60 | 13.9/3200 | 32 | 31 | 30 | 25 | 20 | 10 | 130' | 56 | 104 |
| GP-A201-20 | 520885 | UL/CSA | 2 | 208 | 60 | 13.9/3200 | 32 | 31 | 30 | 25 | 20 | 10 | 130' | 56 | 104 |

Construction

| | |
|---------------------|--|
| Motor Cover | Cast iron with epoxy coating |
| Motor Cover O-Ring | Nitrile |
| Motor Design | Single phase, capacitor start, capacitor run |
| Insulation Class | F |
| Overload Protection | Internal, on winding thermal protector |
| Motor Shaft | AISI 300 series stainless steel |
| Ball Bearing-Upper | Single row ball, 6203 |
| Ball Bearing-Lower | Single row ball, 6306 |
| Seal Housing | Cast iron with epoxy coating |
| Mechanical Seal | Carbon/ceramic |
| Volute | Cast iron with epoxy coating |
| Impeller | Brass |
| Rotating Cutter | 2 blade design, AISI 440C stainless steel, through hardened to Rockwell 55-60C |
| Stationary Cutter | AISI 440C stainless steel, hardened to Rockwell 55-60C |
| External Hardware | 300 series stainless steel |
| Power Cable | Type SOOW/or SOW 14/3 AWG |

Performance Data

