

Catalog Number
Notes
Type

## FEATURES & SPECIFICATIONS

**INTENDED USE** — LED downlight for retrofit of installed 6" nominal commercial "pan-style" housings with incandescent, compact fluorescent (CFL), or high intensity discharge (HID) sources. Compatible range is 5 3/4" to 6 7/8". All installation can be performed from the room side without removing the existing fixture. Multiple lumen packages to replace the installed base of CFL or HID sources with energy savings up to 50%. See Lumen Equivalency Chart.

**CONSTRUCTION** — Innovative housing design that simultaneously retaining and centers the fixture in the existing mounting pan.

**OPTICS** — LED light source with diffuse lens recessed in a reflector with a 55-degree cutoff. Aluminum full reflectors are optically designed to maximize lumen output and to provide superior glare control.

Anodized trim colors for open reflectors are clear diffuse, pewter or wheat. White polyester powder coat also available.

Minimum CRI of 80.

**ELECTRICAL** — Proprietary electrical design allows for excellent line voltage dimming down to 10% light output on 120V product. The zero inrush design enables maximum loading of incandescent dimmers. This enables customers to add dimming of a low cost without pulling additional wires. For compatible dimmers and dimming range, refer to Dimmer Compatibility Chart.

The system maintains 70% lumen output at more than 50,000 hours.

**LISTINGS** — CSA certified to US and Canadian safety standards. Wet location listed. ENERGY STAR® certified.

**WARRANTY** — 5-year limited warranty. Complete warranty terms located at [www.acuitybrands.com/CustomerResources/Terms\\_and\\_conditions.aspx](http://www.acuitybrands.com/CustomerResources/Terms_and_conditions.aspx)

Note: Specifications subject to change without notice.

# RV6 LED

**6" OPEN LED  
Non-IC  
Retrofit Downlight**

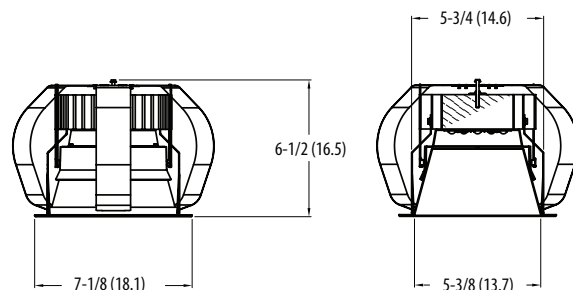

### Specifications

Aperture:	5-5/16 (13.5)	Max. ceiling opening:	6-7/8 (17.5)
Overlap trim:	7-1/8 (18.1)	Min. ceiling opening:	5-3/4 (14.6)
Height:	6-1/2 (16.5)	Max. ceiling thickness:	2 (5.1)
Length:	7 (17.8)		

All dimensions are inches (centimeters) unless otherwise indicated.

LUMEN EQUIVALENCY CHART*						
	RV6 35/06		RV6 35/10		RV6 35/15	
	120V	277V	120V	277V	120V	277V
Delivered lumens (lm)	615	790	900	1200	1475	1580
Nominal wattage (W)	9	10.5	14	16	22.5	23
Comparable fluorescent	18W CFL		26W CFL		32W CFL	
Comparable incandescent	65W BR30		120W BR40		150W A21	
Comparable halogen PAR	50W		75W		90W	

\* Data based on LM-79 test reports.

## ORDERING INFORMATION

Lead times will vary depending on options selected. Consult with your sales representative.

**Example: RV6 35/15 R06AR 120**

RV6 Series	Color temperature	Lumens	Reflector	Trim color	Finish	Voltage	Options	
RV6	27/ 2700 K	06 600 lumens <sup>1</sup>	R06	AR Clear	(blank) Semi-specular	120	TRW White painted flange	
	30/ 3000 K	10 1000 lumens <sup>1</sup>		PR Pewter	LD Matte-diffuse		277	TRBL Black painted flange
	35/ 3500 K	15 1500 lumens <sup>1</sup>		WTR Wheat	LS Specular			
	40/ 4000 K			WR White <sup>2</sup>				

### Accessories: Order as separate catalog number.

<a href="#">EAC ISSM 375</a>	Compact interruptible emergency AC power system
<a href="#">EAC ISSM 125</a>	Compact interruptible emergency AC power system
RK2 SDT 347277120 395VA AD JZ	347V step down transformer mounted in box installed by others
GRA68 JZ	Oversized trim ring with 8" outside diameter. Refer to <a href="#">TECH-GOOF RINGS</a> for more options.
RV6RGIN	6" rough-in frame. Refer to <a href="#">RV ROUGH-IN FRAMES</a> .
RV6RGIN IFB	6" install from below, rough-in frame. Refer to <a href="#">RV ROUGH-IN FRAMES</a> .

### Notes

- 1 Approximate lumen output.
- 2 Not available with finishes.

# RV6 LED

## PHOTOMETRICS

Distribution Curve	Distribution Data	Output Data	Coefficient of Utilization	Illuminance Data at 30" Above Floor for a Single Luminaire
--------------------	-------------------	-------------	----------------------------	--

**RV6 35/15 R06AR 120**, input watts: 21, delivered lumens: 1433, LM/W = 68, test no. LTL25291.

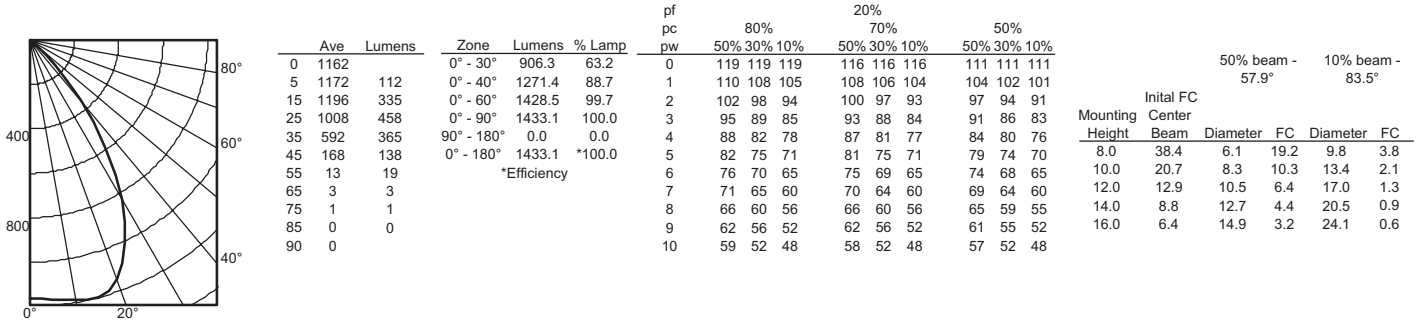

**RV6 35/10 R06AR 120**, input watts: 14, delivered lumens: 889, LM/W = 64, test no. LTL25276.

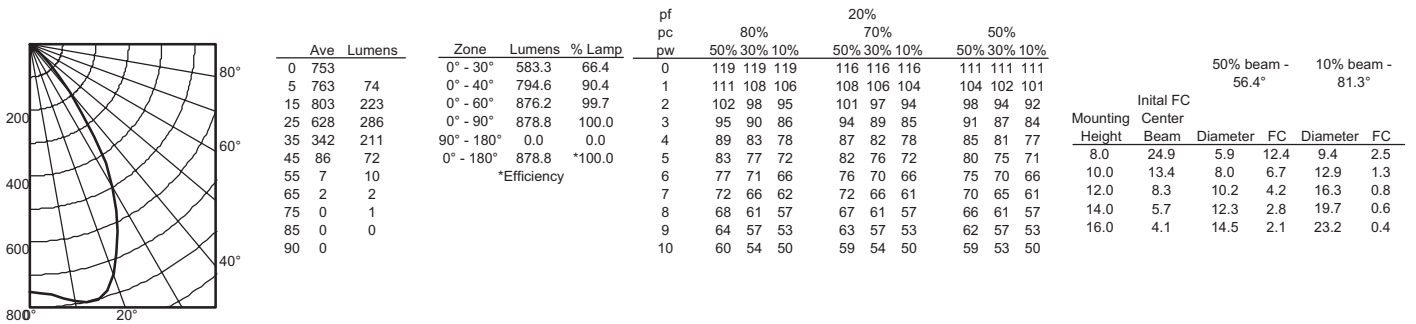

**RV6 35/06 R06AR 120**, input watts: 8, delivered lumens: 604, LM/W = 76, test no. LTL25277.

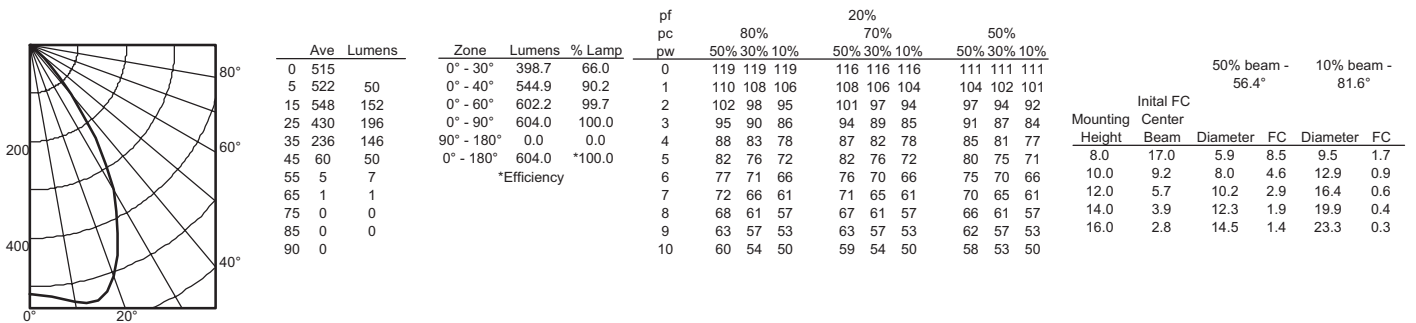

### Notes

- Tested in accordance with IESNA LM-79-08.
- Tested to current IES and NEMA standards under stabilized laboratory conditions.
- Actual performance may differ as a result of end-user environment and application.
- Actual wattage may differ by +/- 10% when operating between 120-277V +/- 10%.

# RV6 LED

## ADDITIONAL DATA

Color temperature	Lumen multiplier
27K	0.83
30K	0.94
35K	1.00 (baseline)
40K	1.03

Trim color	Lumen multiplier
Clear (AR)	1.01
Pewter (PR)	0.97
Wheat (WTR)	0.98
White (WR)	1.00

ENERGY DATA*	
Min. starting temp	-18°C (0°F)
Min. power factor	0.80
Input frequency	50/60 Hz
*Values at non-dimming line voltage.	

ELECTRICAL DATA*		
Lumen package	Input current	
	120V	277V
600 lm	0.07 A	0.04 A
1000 lm	0.12 A	0.06 A
1500 lm	0.18 A	0.09 A
* Values at non-dimming line voltage.		

DIMMER COMPATIBILITY CHART			
Manufacturer	Model/Series	Part numbers	Comments
Sensor Switch	nlight	nSP5 PCD 2W	
Lutron	Diva C-L	DVCL-153P	
	Diva	DVELV-300P	
	Diva	DVELV-600P	
	Skylark Contour	CT-603P	
	Skylark Contour C-L	CTCL-153P	
Leviton	Decora	6674-P	
	Decora	6633P	
	IllumaTech™	IPX06-70Z (for 277V)	Dims to 40%
	TRIMATRON	6681++	
	TRIMATRON	6684++	
++ Must have at least 40W on dimmer circuit.			