

# LIEBHERR

## Use and Care Manual

Combined fridge-freezer

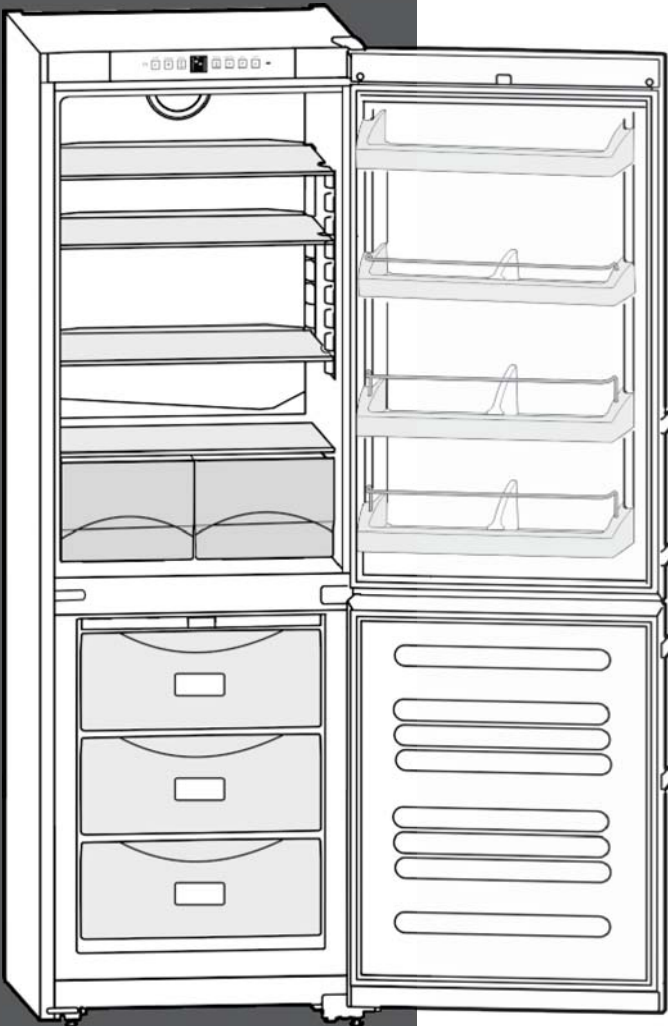

CS1200  
070616 7086186 - 00

# The appliance at a glance

## Contents

<b>1</b>	<b>The appliance at a glance.....</b>	<b>2</b>
1.1	Additional benefits.....	2
1.2	Overview of the appliance and accessories.....	3
1.3	Range of appliance use.....	3
1.4	Conformity.....	3
1.5	Installation dimensions.....	4
1.6	Energy saving.....	4
1.7	Example of food arrangement.....	4
<b>2</b>	<b>General safety information.....</b>	<b>4</b>
<b>3</b>	<b>Controls and displays.....</b>	<b>5</b>
3.1	Operating and control elements.....	5
3.2	Temperature display.....	5
<b>4</b>	<b>Start-up.....</b>	<b>6</b>
4.1	Transporting the appliance.....	6
4.2	Setting up the appliance.....	6
4.3	Changing the door hinges.....	7
4.4	Installation into a fitted kitchen.....	9
4.5	Disposal of packaging.....	9
4.6	Connecting the appliance.....	9
4.7	Switch on the device.....	10
<b>5</b>	<b>Operation.....</b>	<b>10</b>
5.1	Door alarm.....	10
5.2	Temperature alarm.....	10
5.3	Fridge compartment.....	10
5.4	Freezer compartment.....	12
<b>6</b>	<b>Maintenance.....</b>	<b>13</b>
6.1	Defrosting with NoFrost.....	13
6.2	Cleaning the appliance.....	13
6.3	Customer service.....	14
6.4	Appliance Information.....	14
<b>7</b>	<b>Troubleshooting.....</b>	<b>14</b>
<b>8</b>	<b>Putting appliance out of service.....</b>	<b>17</b>
8.1	Vacation Tips.....	17
8.2	Switch off device.....	17
8.3	Decommissioning .....	17
<b>9</b>	<b>Disposing of the appliance.....</b>	<b>17</b>
<b>10</b>	<b>Liebherr Warranty Plan.....</b>	<b>17</b>

Congratulations on the purchase of your new appliance. With this purchase, you have chosen all the advantages of the latest refrigeration technology, guaranteeing you a high-quality appliance with a long life span and high operating safety.

The equipment of your appliance gives you the highest level of day-to-day ease of operation.

Together we are making an active contribution to the conservation of our environment by purchasing this appliance which is manufactured in an environmentally friendly process with the use of recyclable materials.

We hope you enjoy your new appliance.

The manufacturer is constantly working to improve all models. Therefore please understand that we reserve the

right to make design, equipment and technical modifications.

To get to know all the benefits of your new appliance, please read the information contained in these instructions carefully.

The instructions apply to several models, so there may be differences. Sections which only apply to certain appliances are indicated with an asterisk (\*).

**Instructions for action are marked with a ►, the results of action are marked with a ▷.**

## 1 The appliance at a glance

### 1.1 Additional benefits

- CFC free
- Energy-optimized refrigerant circuit
- Energy-efficient insulation
- Low energy consumption
- User-friendly electronic controls
- The appliance defrosts automatically - no need to spend time defrosting
- Large refrigeration capacity
- Safety glass storage shelves
- Large freezing capacity
- Shelves can be removed to make space for large items.
- Freezer over-temperature alarm
- Quick-freeze feature for fresh food (SuperFrost)
- Frozen food temperature indicator
- All freezer drawers suitable for quick-freeze
- Bright LED interior light
- Door ajar alarm
- Handle grips on all extra-large drawers for easy transport
- Integrated transport grips on appliance housing
- Transport castors at back
- Easy to clean
- Door hinges can be reversed

## 1.2 Overview of the appliance and accessories

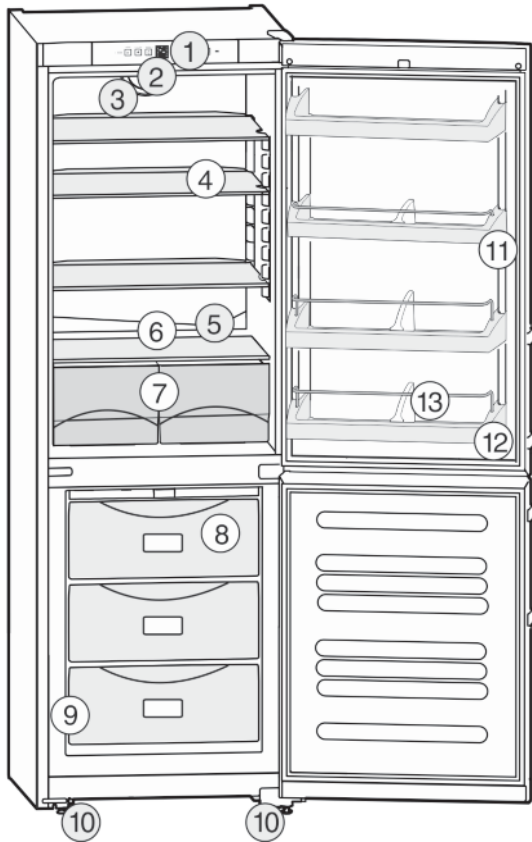

Fig. 1

- (1) Operating and control elements
- (2) Interior light
- (3) Fan
- (4) Installation area, adjustable
- (5) Drain hole
- (6) Coldest zone
- (7) Vegetable drawer
- (8) Freezer compartment
- (9) Rating plate
- (10) Adjustable feet
- (11) Storage rack for jars
- (12) Bottle shelf
- (13) Bottle rack

- Storage and cooling of medication, blood plasma, laboratory preparations or similar substances and products in accordance with the CMDCAS and FDA 510(k)
- Use in areas at risk of explosion

Incorrect appliance use can cause damage to the stored products or cause them to spoil.

### Climate ratings

The appliance is set to operate within specific ambient temperature limits according to its climate rating. The climate rating for your appliance is printed on the rating plate.

### Note

► To guarantee trouble-free operation, comply with the indicated ambient temperatures.

Climate rating	for ambient temperatures from
SN	50 °F (10 °C) to 90 °F (32 °C)
N	61 °F (16 °C) to 90 °F (32 °C)
ST	61 °F (16 °C) to 101 °F (38 °C)
T	61 °F (16 °C) to 110 °F (43 °C)

## 1.4 Conformity

The refrigerant circuit has been tested for leaks. The appliance complies with the relevant safety regulations and the directives UL250 and CAN/CSA C22.2 No.63-93.

## 1.3 Range of appliance use

### Normal use

The appliance is only suitable for cooling food for residential or other similar environments. This includes the following types of uses:

- in staff kitchens, bed and breakfasts,
- by guests in country homes, hotels, motels and other types of accommodations,
- for catering and similar wholesale services.

All other types of uses are not permitted.

### Foreseeable misuse

The following uses are specifically prohibited:

# General safety information

## 1.5 Installation dimensions

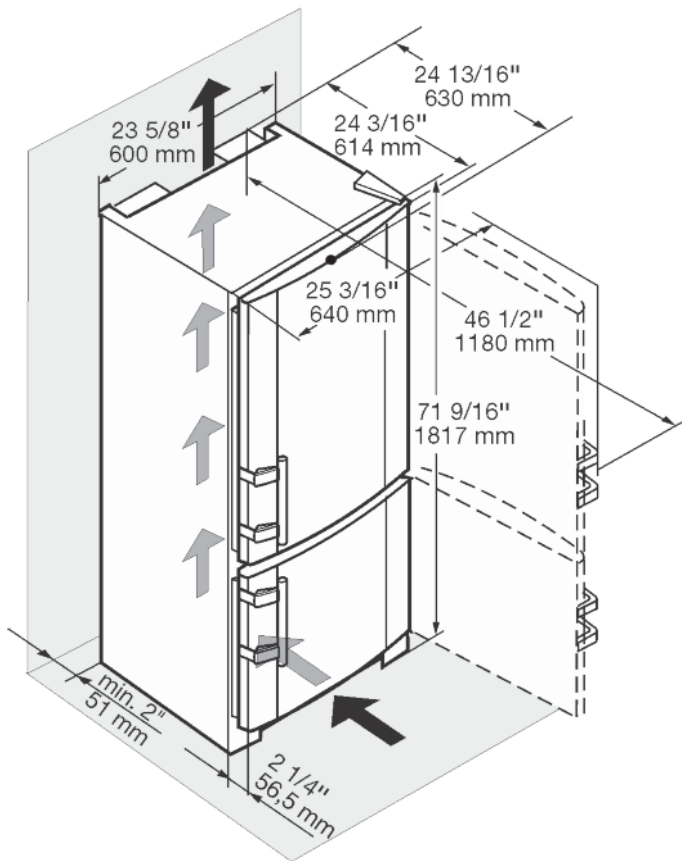

Fig. 2

## 1.6 Energy saving

- Always ensure good ventilation. Do not obstruct ventilation openings or grilles.
- Never block air slits in the fan.
- Do not install the appliance in direct sunlight or next to an oven, heater, or similar heat source.
- Energy consumption depends on installation conditions such as the ambient temperature (see 1.3) . If the ambient temperature differs from the standard temperature of 25 °C, energy consumption can change.
- Avoid opening the appliance door for any longer then necessary
- The lower the temperature is set the higher the energy consumption.
- Store food logically (see The appliance at a glance).
- All food stored in the appliance should be well wrapped and covered. This prevents frost buildup.
- Only take food out for as long as necessary so that it does not get too warm.
- Insertion of warm foods: first let the food cool down to room temperature.
- Defrost frozen food in the fridge
- If you intend to be away for an extended period, empty the fridge compartment and switch it off.

Dust deposits increase energy consumption:

- Once a year the dust should be removed from the refrigerating machine and the heat exchanger metal grid at the back of the appliance



## 1.7 Example of food arrangement

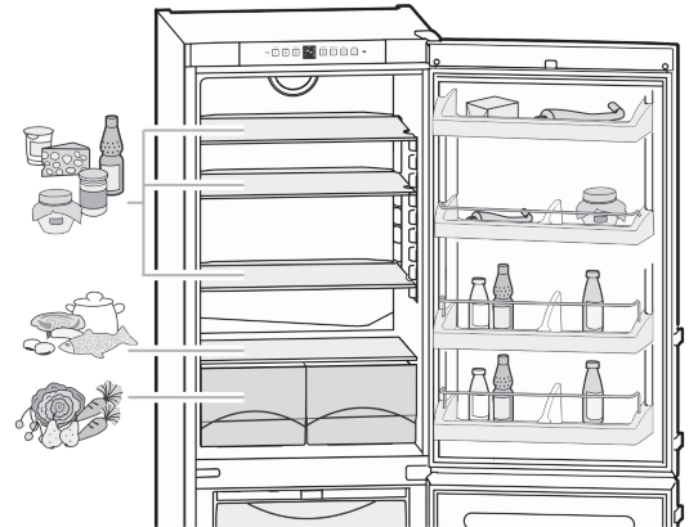

Fig. 3

## 2 General safety information

Read and follow these instructions. They contain safety advice which is important for safe and problem-free installation and operation. Always read and follow the safety advice.

### Dangers for the user:

- This appliance can be operated by children 8 years and older as well as by persons with reduced physical, sensory or mental capabilities or lack of experience and knowledge if they are supervised or have been instructed in the safe use of the appliance and understand the associated risks. Children must not play with the appliance. Cleaning and user maintenance must not be performed by children unless they are supervised.
- When disconnecting the appliance from the outlet, always take hold of the plug. Do not pull on the cable.
- Disconnect the power plug or switch off the power if a fault occurs.
- Do not damage the mains power line. Do not operate the appliance from a defective mains power line.

- Repairs, work on the appliance and replacement of the power cord should only be carried out by the customer service department.
- The appliance should only be assembled, connected and disposed of in accordance with the instructions.
- Please keep the instructions and pass them on to any future owner.
- Special-purpose lamps (filament lamps, LEDs, and fluorescent lamps) inside the appliance are intended to illuminate its interior compartments and are unsuitable for room illumination.

### Risk of fire:

- Do not operate the appliance near explosive gases.
- Do not store explosive materials or spray cans with flammable propellants, such as e.g. butane, propane, pentane, etc. in the appliance. You can recognize such spray cans by the printed contents or a flame symbol. Any leaking gasses can be ignited by electrical components.
- Keep burning candles, lamps and other objects with open flames away from the appliance so that they do not set it on fire.
- Alcoholic beverages or other containers holding alcohol must always be tightly sealed for storage purposes. Any leaking alcohol can be ignited by electrical components

### Tipover hazard:

- Do not stand or climb on the base, drawers, doors, etc. This applies in particular to children.

### Risk of food poisoning:

- Do not consume food that has passed its best before date.

### Danger of frostbite, feelings of numbness and pain:

- Avoid continued skin contact with the cold surfaces or chilled/frozen food or adopt protective measures, e. g. use gloves. Do not consume ice cream (especially sherbets) and ice cubes immediately when they are too cold.

### Risk of injury and damage:

- Hot steam may lead to injuries. Do not use any electrical heating or steam cleaning equipment, naked flames or defrosting sprays for defrosting
- Do not remove ice with sharp objects

### Risk of crushing:

- Do not hold onto the hinge when opening and closing the door. Fingers may get caught.



### California Proposition 65

- This product contains chemicals known to the state of California to cause cancer or reproductive harm.

### Symbols on the device:

	The symbol can be on the compressor. It refers to the oil in the compressor and refers to the following danger: Can be lethal if swallowed or inhaled. This notice only applies for recycling. There is no danger during normal operation.
---	--

### Follow the specific instructions in the other sections:

	DANGER	indicates a hazardous situation, which if not avoided, will result in death or serious injury.
	WARNING	indicates a hazardous situation, which if not avoided, could result in death or serious injury.
	CAUTION	indicates a hazardous situation, which if not avoided, will result in minor or moderate injury.
	NOTICE	indicates a hazardous situation, which if not avoided, could result in damage to property.
	Note	indicates useful advice and tips.

## 3 Controls and displays

### 3.1 Operating and control elements

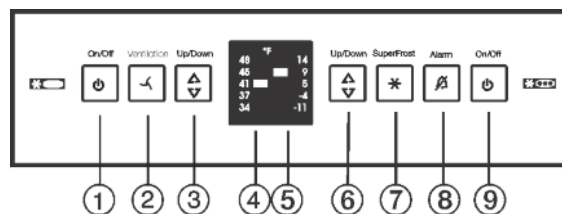

Fig. 4

- |   |  |
|---|--|
| (1) Fridge compartment On/Off button        | (6) Setting button for freezer compartment |
| (2) Ventilation button                      | (7) SuperFrost button                      |
| (3) Setting button for chiller compartment  | (8) Alarm button                           |
| (4) Fridge compartment temperature display  | (9) Freezer compartment On/Off button      |
| (5) Freezer compartment temperature display |  |

### 3.2 Temperature display

The following is displayed in normal operation:



# Start-up

- the freezer temperature set
- the fridge temperature set

The freezer compartment temperature display is flashing:

- the temperature setting has been changed
- after switch-on the temperature is not yet cold enough
- the temperature has risen several degrees

## 4 Start-up

### 4.1 Transporting the appliance



#### CAUTION

Risk of injury or damage if incorrectly transported.

- ▶ Transport the appliance in its packaging.
- ▶ Transport the appliance upright.
- ▶ Do not move the appliance on your own.

### 4.2 Setting up the appliance



#### WARNING

Risk of fire due to moisture!

If live parts or the power cord get wet, this can cause a short circuit.

- ▶ The appliance is designed for use in enclosed spaces. Do not operate the appliance in open space or in damp areas or where there is spray.



#### WARNING

Risk of fire due to short circuit.

If the power cable or plug of the appliance or another appliance and the back of the appliance touch each other the power cable or plug will be damaged by the vibrations of the appliance which could lead to a short circuit.

- ▶ Install the appliance so that it does not touch any plugs or power cables.
- ▶ Do not connect the appliance or other appliances to the sockets on the back of the appliance.



#### WARNING

Danger of fire and damage!

- ▶ Do not place devices that give off heat, e.g. microwaves, toasters, etc. on the appliance.



#### CAUTION

Risk of personal injury!

- ▶ Have two people move this appliance into place.



#### WARNING

Danger of fire and damage due to blocked ventilation openings!

- ▶ Never block the ventilation openings. Always ensure good ventilation!

#### NOTICE

Risk of damage for the finished floor surface!

- ▶ Protect the finished floor surface before you uncrate the unit.

Verify that:

- The floor under the appliance is flat and level.
- The floor can support the appliance's weight plus approximately 1200 pounds (544 kg) of food weight.
- The appliance is not placed in direct sunlight or near the stove, range top, radiators and similar heat sources.
- ▶ Examine the unit and packaging for shipping damage. Contact the carrier immediately if you suspect there is any damage.
- ▶ Note the type (model, number), index, appliance/serial number, date of purchase and where purchased (see 6.4).
- ▶ Remove anything attached to the rear or side walls of appliance that would prevent proper installation or impede proper ventilation.
- ▶ Remove the protective film from the outside of the appliance.

#### NOTICE

The stainless steel doors are treated with a high-grade surface coating and must not be cleaned with the supplied cleaning agent.



This would damage the surface coating.

- ▶ Wipe the coated **door surfaces** using a soft, clean cloth only.
- ▶ Apply a stainless steel cleaner only to the **stainless steel side walls** evenly, wiping with the grain. Subsequent cleaning becomes easier as a result.
- ▶ Wipe **painted side walls** with a clean, soft cloth only.

- ▶ Align the appliance so that it stands firmly and on a level by applying the accompanying spanner to the adjustable-height feet (A) and using a spirit level.
- ▶ Then support the door: Extend the adjustable foot at the turn hinge (B) until it rests on the floor and then make a further 90° turn.

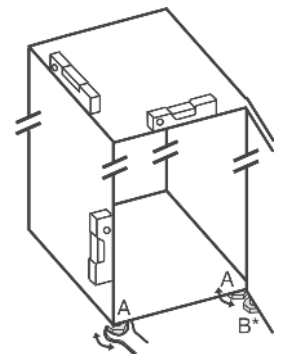

#### Note

- ▶ Clean the appliance (see 6.2).

If the appliance is set up in humid areas, condensation may build on the outside of the appliance.

- ▶ Always ensure proper ventilation.

## Note

If the gap between the rear of the appliance and the wall is less than 2 in. (51 mm), the power consumption level may increase.

## 4.3 Changing the door hinges

You can reverse the door hinges, if necessary:

Make sure you have the following tools on hand:

- Torx® 25
- Torx® 15
- Screwdriver
- Cordless screwdriver, if necessary
- Another person to help with the installation, if necessary

### 4.3.1 Removing the upper door

#### Note

- ▶ To prevent food items from falling out, take all food out of the door racks before removing the door.

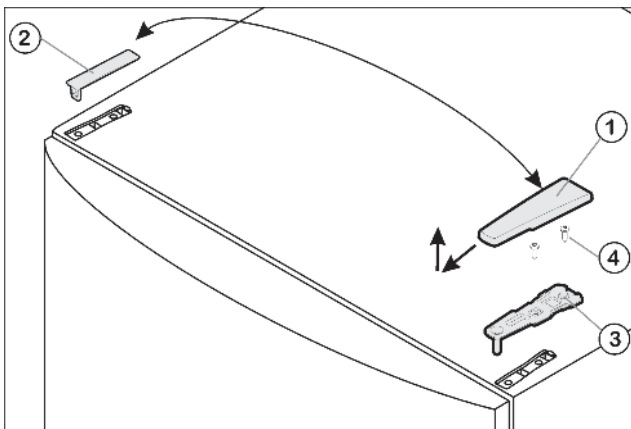

Fig. 5

- ▶ Close upper door.
- ▶ Pull the cover Fig. 5 (1) forward and up.
- ▶ Lift the cover Fig. 5 (2) off.

#### CAUTION

Risk of injury if the door tips out!

- ▶ Keep a steady grip on the door.
- ▶ Set the door down carefully.

- ▶ Unscrew the upper bearing bracket Fig. 5 (3) (2 Torx® 25 screws) Fig. 5 (4) and pull it upward to remove.
- ▶ Lift the upper door up and off and set it to the side.

### 4.3.2 Removing the lower door

- ▶ Close the lower door.

- ▶ Remove the center bearing pin Fig. 6 (11) from the bearing bracket and the lower door.
- ▶ Remove the plastic cap Fig. 6 (10).

#### CAUTION

Risk of injury if the door tips out!

- ▶ Keep a steady grip on the door.
- ▶ Set the door down carefully.

- ▶ Open the lower door.
- ▶ Unscrew the middle bearing bracket Fig. 6 (13) (2 Torx® 25 screws).
- ▶ Lift the door off upwards and set it to the side.

### 4.3.3 To swap over central bearing parts

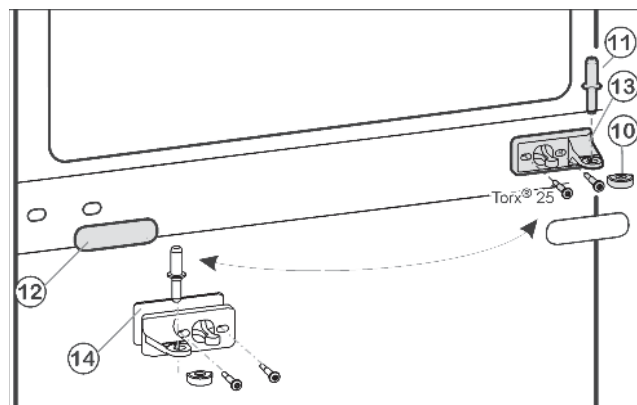

Fig. 6

- ▶ Carefully remove the cover trim Fig. 6 (12).
- ▶ Screw the middle bearing bracket Fig. 6 (13) with the supporting plate Fig. 6 (14) turned 180° onto the new hinge side (4 Nm).
- ▶ Turn the cover trim Fig. 6 (12) 180° and snap it back into place on the new handle side.

### 4.3.4 To swap over lower bearing parts

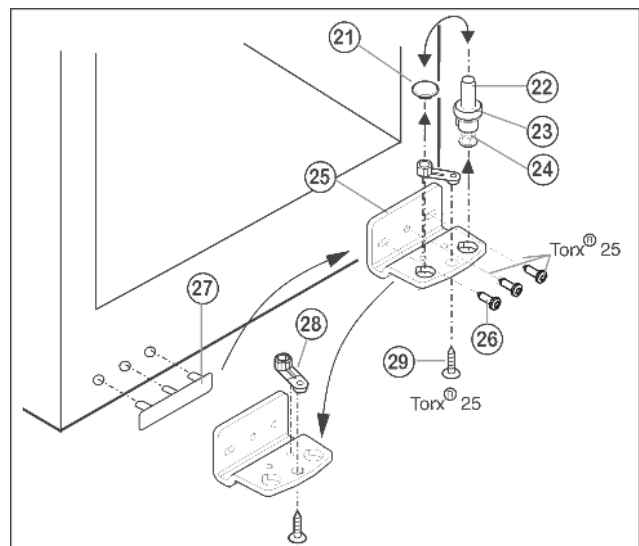

Fig. 7

## Start-up

- ▶ Unscrew the bearing pin *Fig. 7 (22)*, including the washer *Fig. 7 (23)* and adjustable foot *Fig. 7 (24)*, all the way and pull it out.
- ▶ Remove the plug *Fig. 7 (21)*.
- ▶ Unscrew the *Fig. 7 (25)* bearing bracket *Fig. 7 (26)*.
- ▶ Unscrew *Fig. 7 (28)* the bearing part *Fig. 7 (29)* and swap it over to the opposite positioning hole; then screw it in place.
- ▶ Carefully lift off the cover on the handle side *Fig. 7 (27)* and move it to the opposite side.
- ▶ Using a cordless screwdriver if necessary, secure the bearing bracket *Fig. 7 (25)* **tightly (to 4 Nm)** on the new hinge side.
- ▶ Insert the plug *Fig. 7 (21)* into the other hole.
- ▶ Insert the bearing pin *Fig. 7 (22)*, including the washer and adjustable foot, all the way. Make sure the detent lobe is pointing toward the back.

### 4.3.5 Swapping the handles

On both the top and bottom door:

- ▶ Swap the spring clip *Fig. 8 (31)*: Push the locating lug down. Pull the spring clip up and out.
- ▶ Insert the spring clip into the new hinge side again and push until it clicks into place.

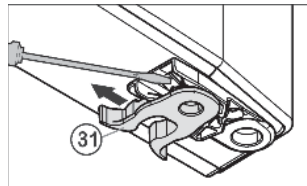

Fig. 8

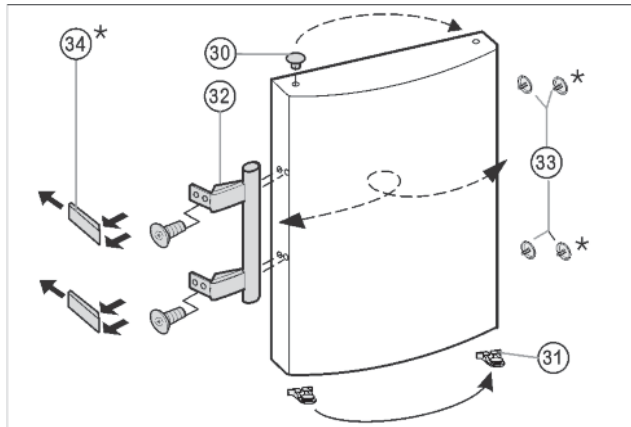

Fig. 9

- ▶ Pull the *Fig. 9 (30)* plugs out of the door bearing bushes and move them to the other side.
- ▶ Remove the door handles *Fig. 9 (32)*, plugs *Fig. 9 (33)* and pressure plates\* *Fig. 9 (34)* and swap them over to the opposite side.
- ▶ When fitting the pressure plates on the opposite side, make sure they engage correctly.\*

### 4.3.6 Fitting the lower door

- ▶ Position the lower door from above onto the bearing pins below *Fig. 7 (22)*.
- ▶ Close the door.
- ▶ Place the plastic cap *Fig. 6 (10)* back onto the center bearing bracket *Fig. 6 (13)*.

- ▶ Insert the center bearing pin *Fig. 6 (11)* on the new hinge side through the center bearing bracket *Fig. 6 (13)* into the lower door.

### 4.3.7 Fitting the upper door

- ▶ Place the upper door onto the center bearing pin *Fig. 6 (11)*.
- ▶ Insert the upper bearing bracket *Fig. 5 (3)* on the new hinge side into the door.
- ▶ Tighten the upper bearing bracket **(to 4 Nm)** (2 x Torx® 25 screws) *Fig. 5 (4)*. Make preliminary holes (optional) or use a cordless screwdriver.
- ▶ From the outside, position cover *Fig. 5 (1)* and cover *Fig. 5 (2)* on the opposite side and snap into place.

### 4.3.8 Aligning the doors

- ▶ Align the doors flush with the appliance housing, using the two oblong holes in the lower bearing bracket *Fig. 7 (25)* and in the center bearing bracket *Fig. 6 (13)* as a guide, if needed. To do so, unscrew the center screw on the lower bearing bracket *Fig. 7 (25)*.



#### WARNING

Risk of bodily injury due to the door falling off. If the bearing parts are not installed with the proper torque, the door may fall off. In addition, the door may not close, thus impairing the cooling performance of the appliance.

- ▶ Securely tighten the bearing brackets by applying a torque of 3 lb-ft (4 Nm).

- ▶ Check all screws and retighten if necessary.



## 4.4 Installation into a fitted kitchen

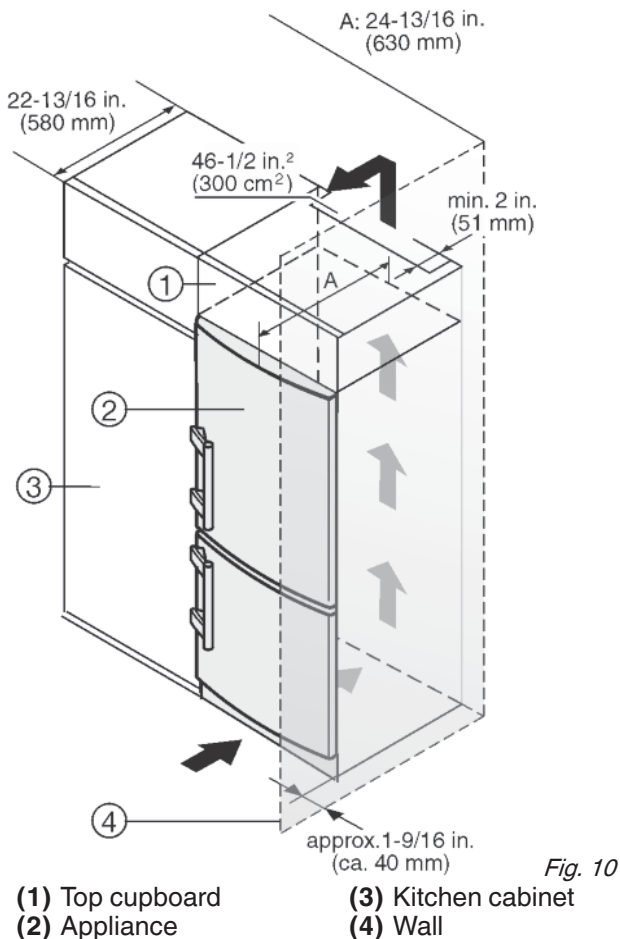

Fig. 10

The appliance can be built into kitchen cabinets. To bring the appliance Fig. 10 (2) up to the height of the fitted kitchen units, a top cupboard Fig. 10 (1) can be added above the appliance.

When converting kitchen cabinets (max. depth 22-13/16 " (580 mm)) the device can be set up directly beside the kitchen cabinet Fig. 10 (3). The appliance door projects (34 mm) at the side and in the center of the appliance (50 mm) from the front of the kitchen cabinet. This allows it to open and close properly.

Ventilation requirements:

- There must be a ventilation shaft at least 2 " (51 mm) deep at the back of the top cupboard over the entire width of the top cupboard.
- The cross section of the ventilation gap below the ceiling must be at least 46-1/2 in<sup>2</sup> (300 cm<sup>2</sup>).
- The bigger the ventilation gap, the more energy-saving the operation of the appliance.

If the appliance is installed with the hinges next to a wall Fig. 10 (4), the gap between the appliance and the wall must be at least 1-9/16 " (40 mm). This is how far the handle protrudes when the door is open.

## 4.5 Disposal of packaging



### WARNING

Danger of suffocation from packaging materials and films!  
 ► Do not allow children to play with packaging materials.

The packaging is made from recyclable materials:



- Corrugated card/cardboard
  - Parts made of foamed polystyrene
  - Films and bags from polyethylene
  - Packing bands from polypropylene
  - Wood frame nailed together with a polyethylene window\*
- Take the packaging material to an official collection point.

## 4.6 Connecting the appliance



### WARNING

Electrical shock hazard!

- Start-up should only take place once the appliance has been installed according to these instructions.
- Electrically ground appliance.
- Do not ground to a gas pipe.
- Check with a qualified electrician if you are not sure the appliance is properly grounded.
- Do not have a fuse in the neutral or grounding circuit.
- Do not use an extension cord, power bar or a multiple socket adapter.
- Do not use a power cord that is frayed or damaged.



### WARNING

Electrical shock hazard!

This appliance is equipped with a three-prong (grounding) polarized plug for your protection against possible shock hazards. Electrical Grounding Required.

- Do not remove the round grounding prong from the plug.
- Use only an grounded adapter.

- Wait 1 hour after installation before you plug in the appliance. This allows the refrigerant and system lubrication to reach equilibrium.
- Make sure incoming voltage is the same as the appliance rating. A 110-120 Volt, 60 Hz, 15 Amp electrical supply (20 Amp for side-by-side installations) circuit that is controlled by a circuit breaker or fuse is required.
- We recommend using a dedicated circuit for this appliance to prevent electrical overload.
- Follow all Federal, State and local electrical, fire and building codes and ordinances when installing the receptacle and / or the appliance.
- In some communities, a wall switch is required to turn power to the appliance ON and OFF.

# Operation

---

- To reduce the risk of fire, electric shock, or personal injury, installation work and electrical wiring must be done by a qualified electrician in accordance with all applicable codes and standards, including fire-rated construction.
- The Power Plug must be easily accessible so that the appliance can be disconnected from the mains quickly in an emergency. It must not be behind the back of the appliance.

## 4.7 Switch on the device

---

### Note

- ▶ To switch on the entire appliance, only the freezer compartment needs to be switched on. This automatically switches on the chiller compartment at the same time.

Switch on the device about 2 hours before starting to load it with any frozen goods.

### 4.7.1 Switching on the freezer compartment

- ▶ Press the Freezer compartment On/Off button *Fig. 4 (9)*.
- ▷ The appliance is switched on. The temperature display on the chiller compartment displays the temperature setting. The freezer compartment temperature display and the Alarm button will flash until the temperature is cold enough.
- ▷ Once all indicator LEDs on the temperature display light up, demonstration mode is enabled. Contact Customer Service.

### 4.7.2 Switching on the fridge compartment

### Note

- ▶ When the fridge compartment is switched on, the freezer compartment is also automatically switched on.
- ▶ Press Fridge compartment On/Off button *Fig. 4 (1)*.
- ▷ The interior light switches on whenever the door is opened.
- ▷ The temperature display lights up. Fridge compartment and freezer compartment are switched on.

## 5 Operation

### 5.1 Door alarm

For fridge and freezer compartments  
If the door is open for longer than 180 seconds, the acoustic warning sounds.

The acoustic warning stops automatically when the door is closed.



### 5.1.1 Switching off the door alarm

The acoustic warning can be switched off when the door is open. The acoustic warning remains switched off as long as the door is open. When the door is closed, the alarm function is active again.

- ▶ Press Alarm button *Fig. 4 (8)*.
- ▷ The door alarm stops.

### 5.2 Temperature alarm

If the freezer temperature is not cold enough, the acoustic warning sounds.

At the same time, the temperature display and the alarm button flash.



The cause of a temperature being too high may be

- hot fresh food was placed in the appliance
- when sorting and removing food from the appliance, too much warm ambient air got in
- the power was cut off for a while
- the appliance is faulty

The audible warning automatically ceases, the alarm button *Fig. 4 (8)* goes out and the temperature display stops flashing whenever the temperature has dropped far enough.

Whenever the alarm status remains enabled: (see Troubleshooting).

### Note

- If the temperature is not cold enough, food may spoil.
- ▶ Check the quality of the food. Do not consume spoiled food.

### 5.2.1 Switching off the temperature alarm

The acoustic warning can be switched off. When the temperature is cold enough again, the alarm function is active again.

- ▶ Press Alarm button *Fig. 4 (8)*.
- ▷ The acoustic warning ceases.

### 5.3 Fridge compartment

The natural circulation of air in the refrigerator compartment results in zones with differing temperatures. It is coldest directly above the vegetable drawers and at the rear wall. It is warmest at the top front of the compartment and in the door.

### 5.3.1 Refrigerating food

### Note

- ▶ Do not load the door with more than 40 lbs (18 kg) of food.

## Note

Insufficient ventilation results in an increase in energy consumption and reduction of the refrigerating performance.

▶ Never block the air slits in the fan.

- ▶ Use recyclable plastic, metal, aluminum and glass containers and cling film to wrap foods.
- ▶ Always use closed containers for liquids and for food that may give off or be tainted by odor or flavor transfer or cover them.
- ▶ Foods which give off a large amount of ethylene gas and those that are sensitive to this gas, such as fruit, vegetables and salad, should always be separated or wrapped so as not to reduce the storage life; for example, do not store tomatoes together with kiwi fruits or cabbage.
- ▶ Use the front floor area of the fridge compartment only to set down food to be refrigerated temporarily, e.g., when rearranging or sorting the contents of the fridge. Do not leave the food there, as it may be pushed back or tipped over when the door is closed.
- ▶ Do not store food too close together to enable sufficient air circulation.
- ▶ To ensure bottles do not tip over: move the bottle holder.

## 5.3.2 Setting the temperature

The temperature depends on the following factors:

- the number of times the door is opened
- the room temperature of the installation location
- the type, temperature and amount of food.

Recommended temperature setting: 41 °F (5 °C)

The temperature can be altered continuously. If the setting reaches 34 °F (2 °C) it starts again at 48 °F (9 °C).

- ▶ Calling up the temperature adjustment: Press the chiller compartment Set button *Fig. 4 (3)* once only.
- ▷ On the temperature display, the LED flashes the current temperature.
- ▶ Press the chiller compartment Set button *Fig. 4 (3)* repeatedly until the illuminated LEDs show the desired temperature.

## Note

- ▶ By pressing and holding down the Set button, a slightly colder value can be set within a small temperature range (e.g. between 41 °F (5 °C) and 45 °F (7 °C)). On the temperature display, the illuminated LEDs then show the next lower temperature range.

## 5.3.3 Fan

The fan allows you to rapidly cool large amounts of fresh food or to achieve a relatively even distribution of temperature across all the storage levels.



Re-circulated air cooling is advisable:

- at high room temperatures (from approx. 95 °F (35 °C))
- in the case of high humidity

Re-circulated air cooling has a somewhat higher energy consumption. To save energy, the fan automatically switches off when the door is open.

### Switching on the fan

- ▶ Briefly press Ventilation button *Fig. 4 (2)*.
- ▷ The Ventilation button lights up.
- ▷ The fan is on. On some appliances it only switches on when the compressor is running.

### Switching the fan off (default)

- ▶ Briefly press Ventilation button *Fig. 4 (2)*.
- ▷ The Ventilation button lights up.
- ▷ The fan is switched off.

## 5.3.4 Shelves

### Shifting or removing shelves



#### CAUTION

Danger of lacerations!

The storage shelf can shatter if dropped or mishandled. You could cut yourself on the pieces of broken glass.

- ▶ Only remove storage shelves when there is nothing on them.

Extension stops secure the shelves against being accidentally pulled out.

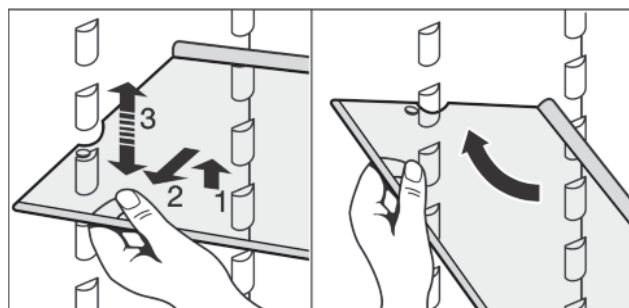
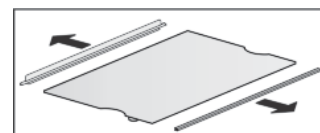

*Fig. 11*

- ▶ Lift up the shelf and pull it slightly forward.
- ▶ Adjust the shelf height by shifting the spacers in the runners.
- ▶ To remove the shelf completely, set it at an angle and pull it out towards you.
- ▶ Insert the shelf with the raised edge to the back pointing upwards.
- ▷ This prevents food from contacting and freezing to the back wall.

### To dismantle shelves

- ▶ The shelves can be dismantled for cleaning.



# Operation

## 5.3.5 Door racks

### Note

- ▶ Do not load the door with more than 40 lbs (18 kg) of food.

### Repositioning the door racks

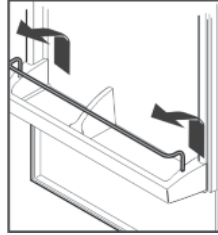

- ▶ Push rack up, pull forward, and reinsert in the reverse order.

### To dismantle door racks

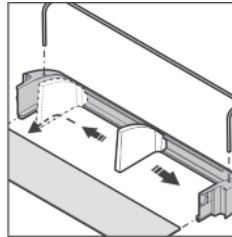

- ▶ The door racks can be dismantled for cleaning.

## 5.3.6 Removing the bottle holder

- ▶ Remove the bottle holder as per the illustration.
- ▶ Always take hold of the bottle holder by the plastic part.

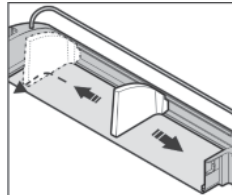

## 5.3.7 Vegetable drawers

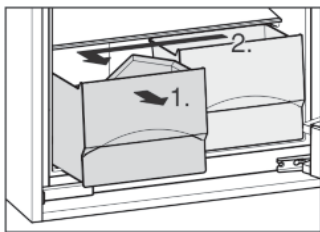

Fig. 12

## 5.4 Freezer compartment

You can store frozen food, make ice cubes and freeze fresh food in the freezer compartment.

### 5.4.1 Freezing food

Each drawer can hold up to 55.12 lbs (25 kg) of frozen food; each plate can hold up to 77.16 lbs (35 kg).

So that the food is rapidly frozen through to the core, do not exceed the following quantities per pack:

- fruit, vegetables up to 2.2 lb (1 kg)
- meat up to 5.51 lbs (2.5 kg)
- ▶ Pack the food in portions in freezer bags, reusable plastic, metal or aluminum containers.

### 5.4.2 Storage times

Guide values for the storage duration of various food-stuffs in the freezer compartment:	
Ice cream	2 to 6 months
Sausage, ham	2 to 6 months
Bread, bakery products	2 to 6 months
Game, pork	6 to 10 months
Fish, fatty	2 to 6 months
Fish, lean	6 to 12 months
Cheese	2 to 6 months
Poultry, beef	6 to 12 months
Vegetables, fruit	6 to 12 months

The storage times given are guidelines

### 5.4.3 Defrosting food

- in the fridge compartment
- in the microwave
- in the oven/fan oven
- at room temperature



### WARNING

Danger of food poisoning!

- ▶ Do not re-freeze defrosted food.

- ▶ Only take out the amount of food that is required. Use defrosted food as quickly as possible.

### 5.4.4 Setting the temperature

Recommended temperature setting: 0 °F (-18 °C)

The temperature can be altered continuously. If the setting reaches -11 °F (-24 °C) it starts again at 14 °F (-10 °C).

- ▶ Calling up the temperature adjustment: press the freezer compartment Set button Fig. 4 (6) once.
- ▷ On the freezer compartment temperature display, the flashing LEDs show the current temperature.
- ▶ Press the freezer compartment Set button Fig. 4 (6) repeatedly until the LEDs display the desired temperature.

### Note

- ▶ Press and hold down the Set button to set a slightly colder value within a small temperature range (e.g. between 5 °F (-15 °C) and -4 °F (-20 °C)). On the temperature display, the illuminated LEDs then show the next lower temperature range.

## 5.4.5 SuperFrost

With this function you can rapidly freeze fresh food through to the core. The appliance works with maximum refrigerating performance. The sound of the refrigeration unit may be temporarily louder as a result. \* \*

Depending on how much fresh food is to be frozen you must switch SuperFrost on in advance - for a small amount of food to be frozen, about 6 hours, for the maximum amount about 24 hours before putting the food in.

Package the food and place it inside across as wide an area as possible. Do not bring food that is to be frozen into contact with products that are already frozen to prevent these items from starting to thaw.

You do not need to switch SuperFrost on in the following cases:

- when placing frozen food in the freezer

### Freezing with SuperFrost

- ▶ Briefly press the SuperFrost button *Fig. 4 (7)*.
- ▷ The SuperFrost button lights up
- ▷ The freezer temperature will drop, and the appliance will operate at the maximum refrigerating capacity. When a small amount of food is to be frozen.
- ▶ Wait approx. 6 hrs.
- ▶ Place packaged food in the upper drawers. With the maximum amount of freezer goods in the unit (see type plate):
- ▶ wait for approx. 24 hrs.
- ▶ Remove upper drawers and place the food directly onto the upper shelves.
- ▷ SuperFrost switches off automatically after approx. 65 hrs.
- ▷ The SuperFrost button switches off whenever the freezing operation has ended.
- ▶ Place food inside the drawers and push them closed again.
- ▷ The appliance continues to work in normal energy-saving mode.

## 5.4.6 Drawers

### Note

Insufficient ventilation results in an increase in energy consumption and reduction of the refrigerating performance.

For appliances with NoFrost:

- ▶ Leave the bottom drawer in the appliance.
- ▶ Never block the air slits in the fan on the rear wall.

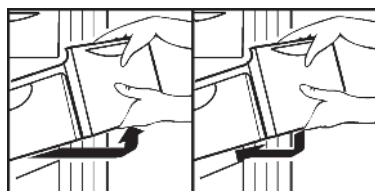

- ▶ To store frozen food directly on the shelves: pull the drawer forward and lift it out.

## 5.4.7 Shelves

- ▶ To remove shelf: lift it at the front and pull out forward.
- ▶ To reinsert shelf: simply slide it in as far as it will go.



## 5.4.8 VarioSpace

In addition to the drawers, you can also take out the shelves. This gives you space for large frozen items. Poultry, meat, large joints of game and tall bakery items can be frozen and then presented whole.

- ▶ Each drawer can hold up to 55.12 lbs (25 kg) of frozen food; each plate can hold up to 77.16 lbs (35 kg).

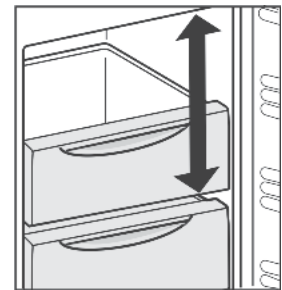

# 6 Maintenance

## 6.1 Defrosting with NoFrost

The NoFrost system defrosts the appliance automatically.

### Fridge compartment:

The defrosted water is evaporated by the heat of the compressor. Drops of water on the back wall are a functional feature and completely normal.

- ▶ Clean the drain opening regularly so that the defrosted water can flow away (see 6.2) .

### Freezer compartment:

The moisture condenses on the evaporator and is periodically defrosted and evaporated.

- ▶ The appliance does not need to be defrosted manually.

## 6.2 Cleaning the appliance



### WARNING

Danger of electric shock.

- ▶ Unplug refrigerator or disconnect power.



### WARNING

Risk of injury or damage due to hot steam.

Hot steam can cause scalding/burns and damage to surfaces.

- ▶ Do not use steam cleaners.



# Troubleshooting.

## NOTICE

Incorrect cleaning damages the appliance.

- ▶ Do not use concentrated cleaning agents.
- ▶ Do not use steel wool or sponges that scour or scratch.
- ▶ Do not use caustic or abrasive cleaning materials or those containing sand, chloride, or acids.
- ▶ Do not use chemical solvents.
- ▶ Do not damage or remove the rating plate on the inside of the appliance. It is vital for the customer service department.
- ▶ Do not pull off, kink or damage any cables or other components.
- ▶ Do not let cleaning water get into the drain gutter, the ventilation grille and electrical parts.
- ▶ Use soft cleaning cloths and a multi-purpose cleaning agent with a neutral pH value.
- ▶ Only use food-compatible cleaning and care agents inside the appliance.

- ▶ **Empty the appliance.**
- ▶ **Disconnect the power plug.**



- ▶ Clean the **plastic surfaces, outside and inside**, by hand using lukewarm water and a little dish washing liquid.

Do not apply stainless steel cleaning agents to glass or plastic surfaces so as not to scratch them. Initially darker areas and quite an intensive color of the stainless steel surfaces are normal.

## NOTICE

The stainless steel doors are treated with a high-grade surface coating and must not be cleaned with stainless steel cleaning agent.



This would damage the surface coating.

- ▶ Wipe the **coated door surfaces** and **painted side walls** with a soft, clean cloth only. If they are very dirty, use a little water or a neutral cleaner. A microfiber cloth can also be used.
- ▶ If the **stainless steel side walls** are dirty, clean them using a commercially available stainless steel cleaning agent. Then evenly apply the accompanying stainless steel care product, making strokes in the direction of the grain.

- ▶ To clean the **drain opening**: Remove deposits with a thin instrument, e.g. a cotton bud.

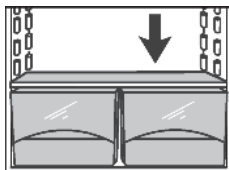

- ▶ Most of the **equipment parts** can be dismantled for cleaning: see the respective chapter.
- ▶ Clean **fittings** by hand using lukewarm water and a little dish washing liquid.

## After cleaning:

- ▶ Wipe the appliance and accessories dry.
- ▶ Connect the appliance and switch it on again.

- ▶ Switch on SuperFrost (see 5.4.5) .  
When the temperature is sufficiently cold:
- ▶ put the food back in the appliance.

## 6.3 Customer service

First check whether you can remedy the fault yourself (see Troubleshooting). If this is not the case, please contact a qualified service provider.



## WARNING

Risk of injury from repairs by non-professionals.

- ▶ Repairs and work on the appliance and the power supply cable not described in the Manual (see Maintenance) should only be carried out by a qualified service provider.

- ▶ Read the appliance designation

*Fig. 13 (1)*, service no. *Fig. 13 (2)* and serial no. *Fig. 13 (3)* from the rating plate. The rating plate is located inside the appliance on the left-hand side.

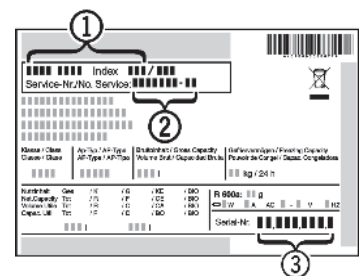

*Fig. 13*

- ▶ Notify a qualified service provider, specifying the fault, appliance designation *Fig. 13 (1)*, service no. *Fig. 13 (2)* and serial *Fig. 13 (3)* no.
- ▷ This will help us to provide you with a faster and more accurate service.
- ▶ Keep the appliance closed until the Customer Service engineer arrives.
- ▷ The food will stay cool longer.
- ▶ Disconnect the power plug (do not pull on the power cord to do this) or switch off the fuse.

## 6.4 Appliance Information

Make a note of this information when the appliance is installed:

Type Designation: \_\_\_\_\_  
 Service Number: \_\_\_\_\_  
 Appliance / Serial Number: \_\_\_\_\_  
 Date of purchase: \_\_\_\_\_  
 Where purchased: \_\_\_\_\_



## 7 Troubleshooting.

Your appliance is designed and manufactured for reliable operation and a long lifespan. If a malfunction nonetheless occurs during operation, please determine if the malfunction is due to an operating error. If a service call determines operator error, you will be charged for the

costs incurred, even during the warranty period. You may be able to rectify the following problems yourself:

Problem	Possible Cause	Correction
<b>The appliance does not work.</b>	The appliance is not switched on.	▶ Switch on the appliance.
	The power plug is not properly inserted in the wall socket.	▶ Check the power plug.
	The fuse in the wall socket is not OK.	▶ Check the fuse.
	Power failure	▶ Keep the appliance closed. ▶ Protect the food: place dry ice on top of the food or use an alternate freezer, if the power failure persists for some time. ▶ Do not re-freeze defrosted food.
<b>The compressor runs for a long time.</b>	When less refrigeration is required, the speed-controlled compressor switches to a low speed. Although the running time is increased as a result, energy is saved.	▶ This is normal in energy-saving models.
	SuperFrost function is activated.	▶ The compressor runs long to rapidly freeze food. This is normal.
<b>A LED at the lower rear of the appliance (for the compressor) flashes regularly every 15 seconds*.</b>	The inverter is equipped with a diagnostic LED.	▶ The flashing is normal.
<b>Noises are too loud.</b>	The different speed levels of speed-controlled* compressors can cause them to generate various noises during operation.	▶ These noises are normal.
<b>A gurgling sound</b>	This sound comes from the refrigerant flowing in the refrigeration circuit.	▶ The sound is normal.
<b>A faint clicking sound</b>	The sound always occurs when the refrigeration unit (the motor) automatically switches on or off.	▶ The sound is normal.
<b>A hum. It is briefly a little louder when the refrigeration unit (the motor) switches on.</b>	The refrigeration increases automatically when the SuperFrost function is activated, fresh food has just been placed in the appliance or the door has been left open for a while.	▶ The sound is normal.
	The ambient temperature is too high.	▶ Solution: (see 1.3)
<b>A low hum</b>	The sound occurs as a result of fan air flow.	▶ The sound is normal.
<b>Vibration noise</b>	The appliance is not standing firmly on the floor. As a result, adjoining units or objects are set into vibration by the running refrigeration unit.	▶ Align the appliance using the adjustable feet ▶ Move bottles and containers apart.

## Troubleshooting.

Problem	Possible Cause	Correction
<b>The SuperFrost button flashes together with the temperature display.</b>	There is a fault.	▶ Contact the customer service department (see Maintenance).
<b>All LEDs on the chiller compartment temperature display light up.</b>	The demo mode is activated.	▶ Contact the customer service department (see Maintenance).
<b>The outside surfaces of the appliance are hot*.</b>	The heat of the refrigerant circuit is used to prevent condensate from forming.	▶ This is normal.
<b>The temperature is not cold enough.</b>	The door of the appliance is not closed properly.	▶ Close the appliance door.
	Insufficient ventilation.	▶ Clear and clean the ventilation grille.
	The ambient temperature is too high.	▶ Solution: (see 1.3)
	The appliance was opened too frequently or for too long.	▶ Wait to see whether the required temperature resets itself by itself. If not, contact the customer service department (see Maintenance).
	Too much fresh food was placed inside without SuperFrost.	▶ Solution: (see 5.4.5)
	The appliance is too near to a heat source (stove, heater etc).	▶ Change location of appliance or the heat source.
<b>The interior light does not turn on.</b>	The appliance is not switched on.	▶ Switch on the appliance.
	The door was open for longer than 15 minutes.	▶ The interior light automatically switches itself off if the door has been open for about 15 minutes.
	The LED interior light is faulty or the cover is damaged	<div style="border: 1px solid red; padding: 5px;"> <p> <b>WARNING</b> Risk of injury from electrical shock. Live parts are under the cover. ▶ The LED interior light should only be replaced or repaired by the Customer Service department or by engineers trained to do so.</p> </div> <hr style="border: 1px solid red;"/> <div style="border: 1px solid red; padding: 5px;"> <p> <b>WARNING</b> Risk of injury from LED lamp! The lighting intensity of the LED light complies with laser class 1/1M. If the cover is faulty: ▶ Do not gaze directly at this lighting unit with optical lenses while very close to the light source. This can cause damage to your eyes.</p> </div>

## 8 Putting appliance out of service

### 8.1 Vacation Tips

**Short vacations:** If you will be away for less than four weeks

- ▶ Use all perishables.
- ▶ Freeze other items.
- ▶ Turn off the refrigerator compartment.

**Long vacations:** If you will be away for a month or more

- ▶ Remove all food from the appliance.
- ▶ Turn OFF the appliance.
- ▶ Clean the appliance (see 6.2) .
- ▶ Leave the door open to prevent unpleasant odors.
- ▷ This will also keep mold from building up.

### 8.2 Switch off device

#### Note

- ▶ To shut down the entire unit, all you need to do is to switch off the freezer compartment. This automatically shuts down the chiller unit at the same time.

#### 8.2.1 Switching off the freezer compartment

- ▶ On/Off button on the freezer compartment *Fig. 4 (9)* - press and hold down for at least 3 seconds:
- ▷ The temperature displays are dark. The entire device is switched off.

#### 8.2.2 Switching off the fridge compartment

- ▶ On/Off button on the chiller compartment *Fig. 4 (1)* - press and hold down for at least 3 seconds.
- ▷ The interior light is switched off.
- ▷ The temperature display for the chiller compartment is switched off.

#### Note

- ▶ If only the chiller compartment needs to be switched off, e.g. during vacation periods, always take care to ensure that the temperature display on the freezer compartment is lit.

### 8.3 Decommissioning

- ▶ Empty the appliance.
- ▶ Switch off the appliance (see Putting appliance out of service).
- ▶ Pull out the power plug.
- ▶ Clean the appliance (see 6.2) .



- ▶ Leave the door open to prevent bad smells.

## 9 Disposing of the appliance

Follow the local regulations for the disposal of appliances. Old appliances can be dangerous. Contact the local refuse collection department for additional information.



#### DANGER

There is a risk of suffocation.

Children playing can shut themselves in and suffocate.

- ▶ Take the door(s) off.
- ▶ Remove the drawers.
- ▶ Leave the storage shelves in the appliance so that children cannot easily climb into the appliance.



#### WARNING

Danger of electric shock.

- ▶ Cut off the plug from the power cord and discard.
- ▶ Cut off the power cord from the discarded appliance. Dispose of separately from the appliance.

Ensure during and after disposal that the appliance isn't stored in the vicinity of gasoline or other flammable vapors and liquids.

When disposing of the appliance, ensure that the refrigeration circuit is not damaged to prevent uncontrolled escape of the refrigerant it contains (data on type plate) and oil.

## 10 Liebherr Warranty Plan

**FULL TWO YEAR WARRANTY** - For two years from the date of original purchase, your Liebherr warranty covers all parts and labor to repair or replace any part of the product which proves to be defective in materials or workmanship.

**FULL FIVE YEAR WARRANTY** - For five years from the date of original purchase, your Liebherr warranty covers all parts and labor to repair or replace any components that prove to be defective in materials or workmanship in the sealed system. The "Sealed System" means only the compressor, condenser, evaporator, drier and all connecting tubing.

**LIMITED 6TH THROUGH 12TH YEAR WARRANTY** - From the 6<sup>th</sup> through 12<sup>th</sup> year from the date of original purchase, your Liebherr warranty covers all parts that prove to be defective in materials or workmanship in the Sealed System (parts only).

#### TERMS APPLICABLE TO EACH WARRANTY

All service provided by Liebherr under the warranty must be performed by authorized Liebherr service representatives, unless otherwise specified by Liebherr. Service will be provided in the home during normal business hours. This warranty applies only to products installed for normal residential use. Details regarding a non-residential warranty are available on request.

## Liebherr Warranty Plan

---

The warranty applies only to products installed in any one of the fifty states of the United States or the District of Columbia. The warranty does not cover any parts or labor to correct any defect caused by negligence, accident or improper use, maintenance, installation, service or repair, including but not limited to improper removal and reinstallation of the condensing unit.

**THE WARRANTIES DESCRIBED ABOVE ARE MADE EXPRESSLY IN LIEU OF ANY OTHER WARRANTIES, EXPRESSED OR IMPLIED, INCLUDING ANY IMPLIED WARRANTY OF MERCHANTABILITY OR FITNESS FOR A PARTICULAR PURPOSE, AND OF ANY OTHER OBLIGATION OR LIABILITY ON THE PART OF LIEBHERR. IN NO EVENT SHALL LIEBHERR BE LIABLE FOR SPECIAL, INCIDENTAL OR CONSEQUENTIAL DAMAGES ARISING FROM THE BREACH OF THESE WARRANTIES OR ANY OTHER WARRANTIES, WHETHER EXPRESS, IMPLIED OR STATUTORY.**

Some states do not allow the exclusion or limitation of incidental or consequential damages so the above limitation or exclusion may not apply to you. This warranty gives you specific legal rights and you may also have other legal rights which vary from state to state.

To receive parts and/or service and the name of the Liebherr authorized service representative nearest you, contact your Liebherr dealer or distributor or contact the Liebherr designated national service provider:

in the US: [Service-appliances.us@liebherr.com](mailto:Service-appliances.us@liebherr.com) or call 1-866-LIEBHER (1-866-543-2437).

in Canada: [www.euro-parts.ca](http://www.euro-parts.ca) or call 1-888-LIEBHER (1-888-543-2437).





**For Service in the U.S.:**

**Liebherr Service Center**

**Toll Free: 1-866-LIEBHER or 1-866-543-2437**

Service-appliances.us@liebherr.com  
PlusOne Solutions, Inc.  
3501 Quadrangle Blvd, Suite 120  
Orlando, FL 32817

**For Service in Canada:**

**Liebherr Service Center**

**Toll Free: 1-888-LIEBHER or 1-888-543-2437**

www.euro-parts.ca  
EURO-PARTS CANADA  
39822 Belgrave Road  
Belgrave, Ontario, N0G 1E0  
Phone: (519) 357-3320  
Fax: (519) 357-1326



[www.liebherr-appliances.com](http://www.liebherr-appliances.com)