

Faceframe, 1-3/8" Overlay

Part Number
HN0042

Crank
0mm

Opening
108°

Seq. #
1190

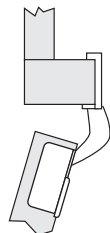
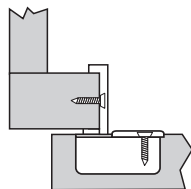
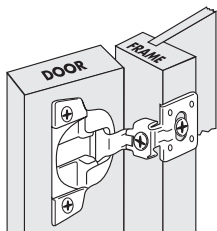

Before You Begin

- Read the Do-It-Yourself Installation Instructions completely before starting.
- Make sure all parts are included.

Parts List

- Two Face Frame Concealed Hinges
- Two Clip-On Mounting Plates
- Four #6x5/8" Flat Head Wood Screws
- Two #10x3/4" Flat Head Wood Screws

Recommended Tools

- #2 Phillips Screwdriver
- Pencil
- Metric and Inches Ruler
- Drill and 1/16" Drill bit for pilot holes
- Boring Bit 35mm (Forstner Bit) for hinge cup

Data

- See chart below for recommended number of hinges per door size.
- If hanging a door with a mirror or very wide door you will need additional hinges.

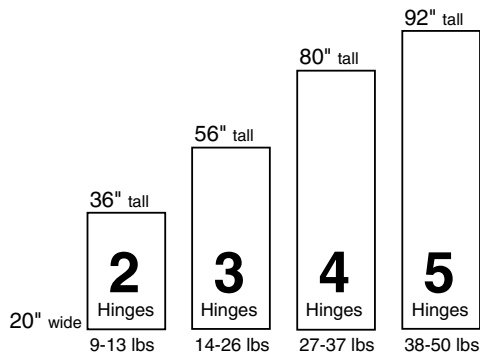

Verify product measurements prior to drilling. Printer configurations may not be set to print Mounting Template to actual size.

Vérifiez les mesures du produit avant de percer. Il se peut que les configurations de l'imprimante fassent que le gabarit de montage ne soit pas imprimé à la taille réelle.

Antes de perforar verifique las medidas del producto. Las configuraciones de la impresora pueda que no estén ajustadas para imprimir la Plantilla de Montaje al tamaño real.

Specifications

- Door thickness should be 5/8" (16mm) or 3/4" (19mm).
- Placing several cabinets together requires that an amount of the opening (reveal) must show between the doors for the doors to properly open and close.

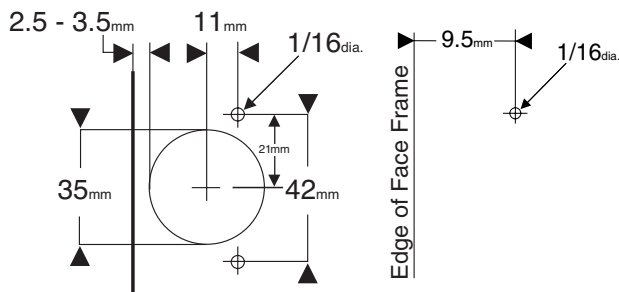

1. Marking Drill Holes

- Cut out hinge cup template for drilling hinge cup and screw pilot holes.
- Align hinge cup template to door and mark location of holes.
- Cut out mounting plate template for drilling screw pilot holes.
- Align mounting plate template to the edge of cabinet and mark location of holes.

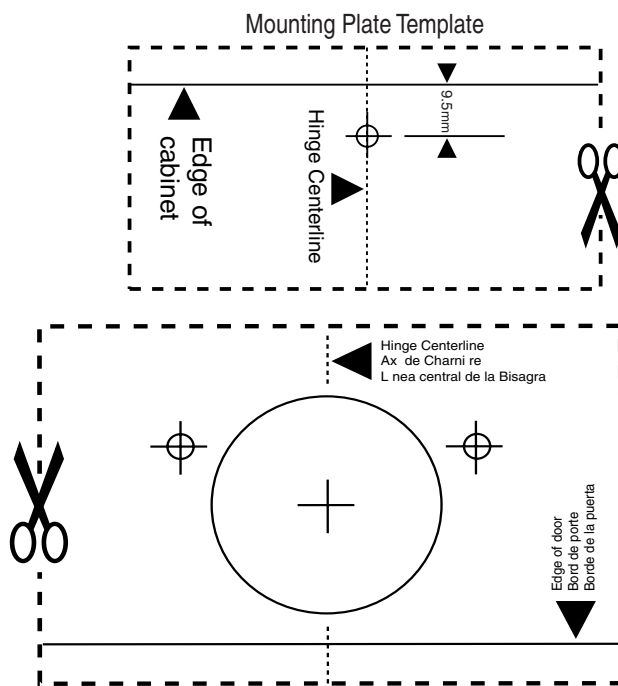

2. Installing Hinge to Door

- Drill hole 12.7mm (1/2") deep for hinge cup per template using 35mm boring bit. Do not drill through door face.
- Drill 1.5mm (1/16") pilot holes for screws per template. Do not drill through door face.
- Insert hinge into door and fasten with two #6x5/8" flat head wood screws.

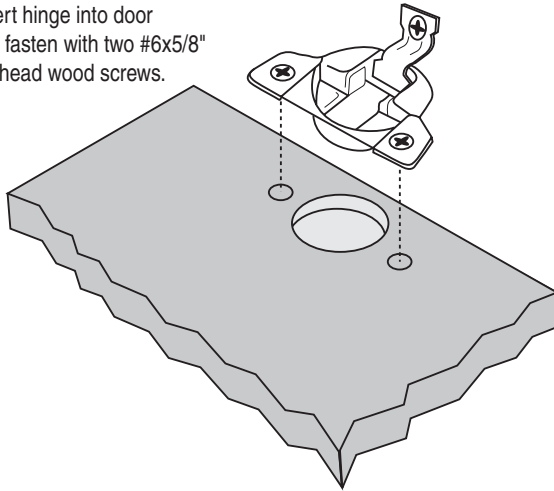

3. Installing Door to Cabinet

- Open hinge to full extension.
- Connect door to cabinet face frame as shown.

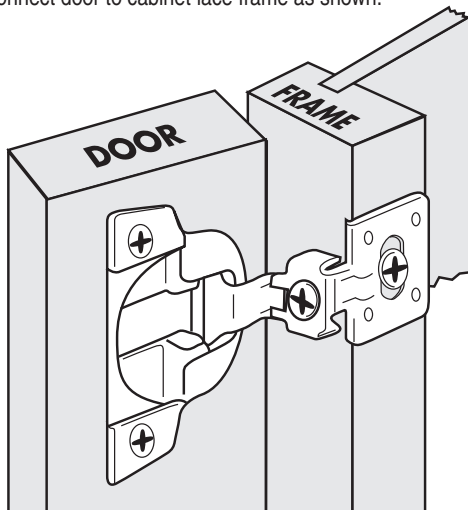

4. Hinge Adjustment

- Side Adjustment..... +/-2mm
Loosen screw 1, align door, tighten screw 1.
- Height Adjustment..... +/-2mm
Loosen screw 2, align door, tighten screw 2.

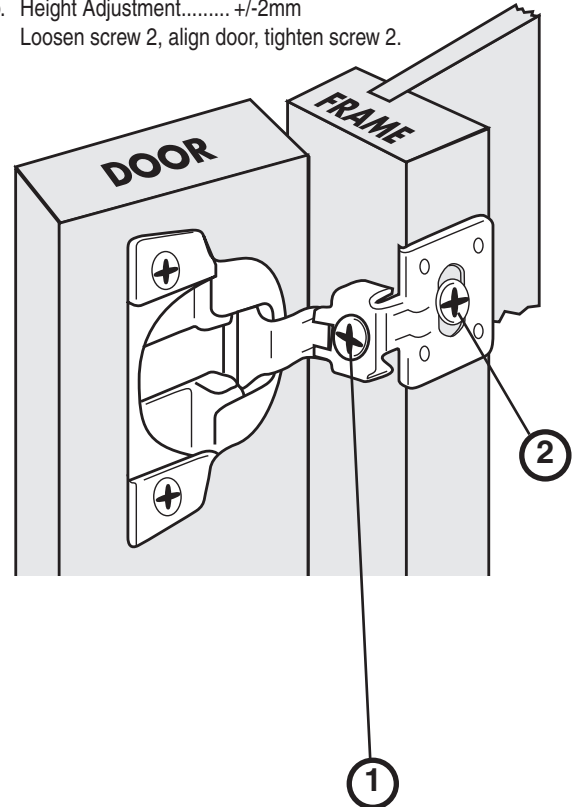

Mounting Plate Template

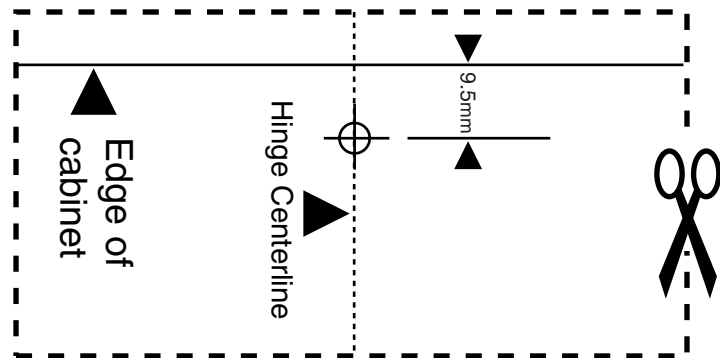

Verify product measurements prior to drilling. Printer configurations may not be set to print Mounting Template to actual size.

Vérifiez les mesures du produit avant de percer. Il se peut que les configurations de l'imprimante fassent que le gabarit de montage ne soit pas imprimé à la taille réelle.

Antes de perforar verifique las medidas del producto. Las configuraciones de la impresora pueda que no estén ajustadas para imprimir la Plantilla de Montaje al tamaño real.

