

# *the* radiant<sup>®</sup> *collection*

---

Smart Outlet, Wi-Fi

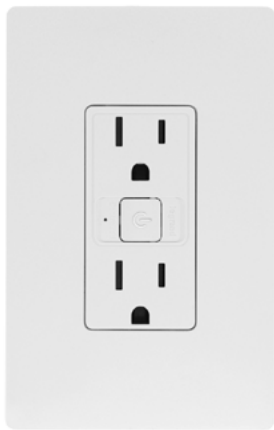

 **legrand**<sup>®</sup>

# before you start

Review this guide in its entirety. Consult an electrician with any questions or if you are unsure of your abilities.

**Warning:** Incorrect installation could result in death, serious injury, and/or damage to your home or devices.

**Caution:** To reduce the risk of injury and/or overheating and damage to other equipment:

- For dry, indoor use only.
- Do not use to power medical equipment.
- Not suitable as a disconnecting means.
- Do not use with loads exceeding the device load rating.
- Connect the smart outlet to a 120 VAC, 60 Hz power source ONLY.
- Always use copper wire to install the smart outlet and follow all applicable local and national electrical codes.

Visit [www.legrand.us/radiant/smart-lighting/support](http://www.legrand.us/radiant/smart-lighting/support) for support.

# what you need

## REQUIRED:

 Phillips-head screwdriver

 Flat blade screwdriver

## YOU MAY ALSO NEED:

Voltage tester, pliers, wire cutter, wire stripper, electrical tape, flashlight, wiring leads (included), and wire nuts (included)

# installation & setup

## 1 | turn off power to device at circuit breaker

Plug a light or a fan into the outlet and turn it on. Next go to the circuit breaker and turn off the breaker that connects to the outlet. Confirm that power is now out to BOTH receptacles.

**NOTE:** Ensure power is off to all devices in electrical box.

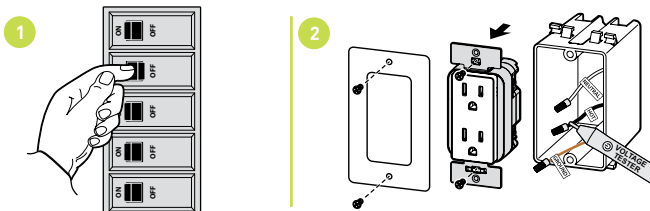

## 2 | remove existing device

Check for the following wires:

- a** HOT or LINE: Receives power from the circuit box. Referred to as “hot” for the purposes of this guide. Do not touch or let “hot” wires contact other wires.
- b** NEUTRAL: Creates a path to return current to the power source when the device is off. Required for your outlet installation.
- c** GROUND: Provides a safe path for electricity in the event of a short circuit.

### 3 | wire smart outlet

When connecting each wire, loosen the terminal screw, insert the wire into a terminal slot, and tighten the terminal screw until the wire is secured.

- a Connect the WHITE neutral wire on the outlet to the neutral wire in the box.
- b Connect the HOT wire in the box to the hot wire on the outlet.
- c Connect the GREEN ground wire on the switch to the ground wire in the box.

**NOTE:** This outlet can be optionally wired to control downstream outlets. For more information please see the resources section for this product on the [Legrand.us](http://Legrand.us) website.

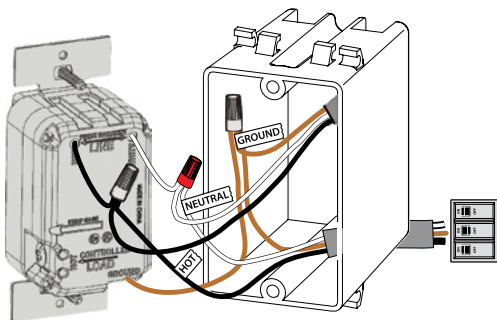

## 4 | secure smart outlet

- a Fold wires into electrical box, taking care not to pinch a wire.
- b Use included screws to secure outlet to electrical box. Do not fully tighten the screws.

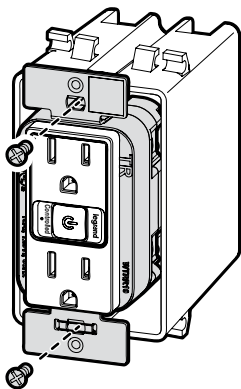

## 5 | test the smart outlet

**NOTE:** See *getting to know your outlet section* for feature details.

- a Turn the power on at the circuit breaker and check that the indicator light on the smart outlet is on to indicate that it is active.
- b Plug a lamp or device into the smart outlet.
- c Press the on/off button to turn the smart outlet on. Your lamp or device should become powered.
- d Press the on/off button to turn the smart outlet off. Your lamp or device should power off.

### TROUBLESHOOTING TIP:

If the device is not powering, visit [www.legrand.us/radiant/smart-lighting/support](http://www.legrand.us/radiant/smart-lighting/support) for support.

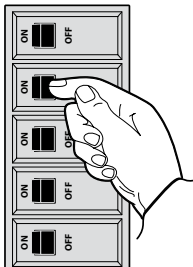

## 6 | attach wall plate

- a** Use the sub-plate screws (provided) to secure the sub-plate to the smart outlet.
- b** Tighten device screws to secure to the electrical box.
- c** Angle the  end of the wall plate over the top edge of the sub-plate. Push the screwless wall plate down and in until it "snaps" into place over the sub-plate.

**NOTE:** To remove the wall plate, place the tip of a flat blade screwdriver into the slot under the wall plate and twist gently.

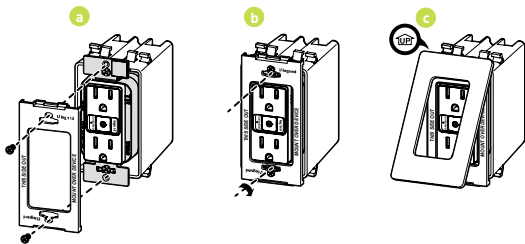

## 7 | set up your system

- a Download and launch the Smart Lights, Wi-Fi app by Legrand. The app is available on the App Store or on Google Play.

SCAN TO DOWNLOAD



- b Connect your smart outlet to your home network by following the step by step instructions in the app.
- c Use the app to control your smart outlet.

SCAN TO WATCH HOW  
TO SET UP THE APP





# getting to know your outlet

Item	Name	Description
1	Indicator Light	Indicates operation. See “Indicator Light Explanations” for detail.
2	On/Off Button	Turns the outlet on or off
3	Uncontrolled Outlet	“Always on” outlet

## INDICATOR LIGHT EXPLANATIONS

LED Color	State of Light	Explanation
●	Solid Amber	Factory default; ready to connect
⚙	Flashing Amber	Device is attempting to connect to the network
○	Solid White	Device is connected to your network and is switched off

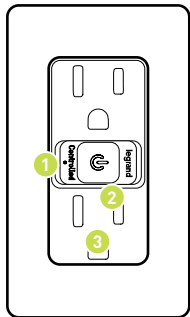

## RESET TO FACTORY DEFAULT

To manually reset the outlet to factory defaults press and hold the off button for 10 seconds until you see the LED blink then release. The device will reset in about 20 seconds after release.

# regulatory information

## FCC NOTICE

This device complies with Part 15 of the FCC rules. Operation is subject to the following two conditions: (1) this device may not cause harmful interference, and (2) this device must accept any interference received, including interference that may cause undesirable operation.

This equipment has been tested and found to comply with the limits for a Class B digital device, pursuant to Part 15 of the FCC Rules. These limits are designed to provide reasonable protection against harmful interference in a residential installation. This equipment generates, uses, and can radiate radio frequency energy and, if not installed and used in accordance with the instructions, may cause harmful interference to radio communications. However, there is no guarantee that interference will not occur in a particular installation.

If this equipment does cause harmful interference to radio or television reception, which can be determined by turning the equipment off and on, the user is encouraged to try to correct the interference by one or more of the following measures:

- Reorient or relocate the receiving antenna
- Increase the separation between the equipment and receiver
- Connect the equipment into an outlet on a circuit different from that to which the receiver is connected
- Consult the dealer or an experienced radio/TV technician for help

This equipment complies with FCC radiation exposure limits set forth for an uncontrolled environment. This equipment should be installed and operated with a minimum distance of 20 cm between the transmitter's radiating structure(s) and the body of the user or nearby persons.

**NOTE:** Any changes or modifications to this device that are not expressly approved by the manufacturer will void the warranty and the user's authority to operate the equipment.

FCC ID: A3LCWAM210S

## IC NOTICE

This device complies with Industry Canada license-exempt RSS standards. Operation is subject to the following two conditions: (1) this device may not cause interference; and (2) this device must accept any interference, including interference that may cause undesired operation of the device.

## RF EXPOSURE STATEMENT

This equipment meets the SAR evaluation limits given in RSS-102 Issue 5 requirements at the minimum separation distance of 15 mm to the human body. Note: Any changes or modifications to this device that are not expressly approved by the manufacturer, will void the warranty and the user's authority to operate the equipment.

IC ID: 649E-CWAM210S

WiFi® is a registered trademark of Wi-Fi Alliance®.



# warranty

This product is warranted under normal use against defects in workmanship and materials for as long as you own it. If the product fails due to a manufacturing defect during normal use, return it for a replacement at the store where purchased or contact technical support at 1-877-833-3303.

A dated sales receipt must be provided for all replacement requests (legible copies are acceptable).

Additional warranty details are available at <http://www.legrand.us> under your device's product page.

# specifications

Load	Rating
Resistive	120 VAC, 60 Hz, 15 A
Incandescent/halogen	1500 W
Ballast	15 A standard/electronic
Motor	½ HP

Legrand reserves the right to change specifications without notice.

# questions? we're here to help

PHONE: 1-877-833-3303

8:00 a.m. to 8:00 p.m. EST (M-F)

EMAIL: [smartlighting@legrand.us](mailto:smartlighting@legrand.us)

CHAT: <https://www.legrand.us/radiant/smart-lighting.aspx>

(Click on the  icon to open a dialogue box)

## faqs

**Q:** What are the additional wires in my wall box?

**A:** You may have the following application:

1. Your existing outlet may be controlled from a wall switch. The wire feeding power from the switch is not necessary and should be capped with a wire nut.

**Q:** Does the Smart Outlet control downstream outlets?

**A:** Yes. This outlet can be optionally wired to control downstream outlets. For more information please see the resources section for this product on the Legrand.us website.

**NOTE:** *In new construction, the smart outlet can be wired to control half-controlled outlets downstream.*

Contact an electrician if you are unsure of your abilities.



©2019 Legrand All Rights Reserved 153052 07/20 341283



**Legrand, North America**

50 Boyd Avenue  
Syracuse, NY 13209  
1-877-833-3303  
[www.legrand.us](http://www.legrand.us)