



**Wall Sconces**

**GENERAL PRODUCT INFORMATION:**



This product can mount to either a 4" square electrical box with round plaster ring or an octagon electrical box.

This product is suitable for indoor dry locations only.

This product can be dimmed with a standard incandescent dimmer.

Minimum volume of the electrical box must be 6 cubic inches (98 cubic centimeter).

This instruction shows a typical installation.

This instruction is for the following models:

- Ursula Galleria (GHB200\_IA50MPT)
- Mini-Dome I Galleria (GHB325\_IA50MPT)
- Mini-Dome II Galleria (GHB275\_IA50MPT)
- Cube Galleria (GHB285\_IA20MPT)
- Orbit Galleria (GHB273\_IA50MPT)
- Black Mini-Reflex Galleria (GHB358BRE\_IA35MPT)
- Mini-Reflex Galleria (GHB322\_IA50MPT)
- Calla Galleria (GHB352\_IA50MPT)

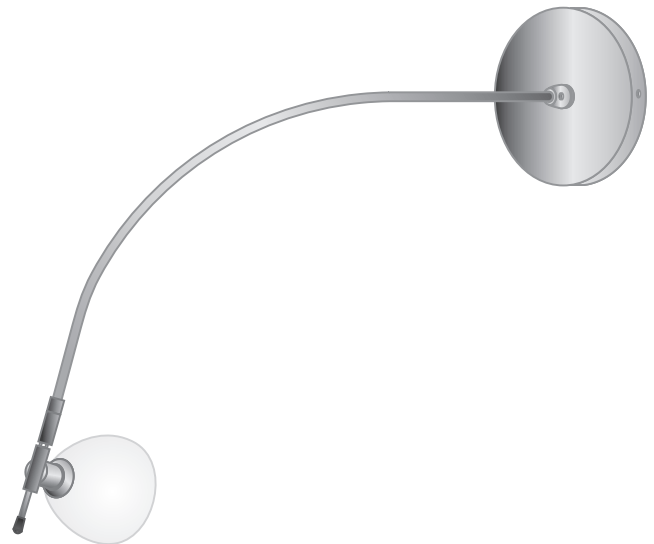

**CAUTION - RISK OF FIRE**  
 This product requires installation by a qualified electrician. Before installing be sure to read all instructions and **TURN THE POWER TO THE ELECTRICAL BOX OFF.**

**Install the Fixture**

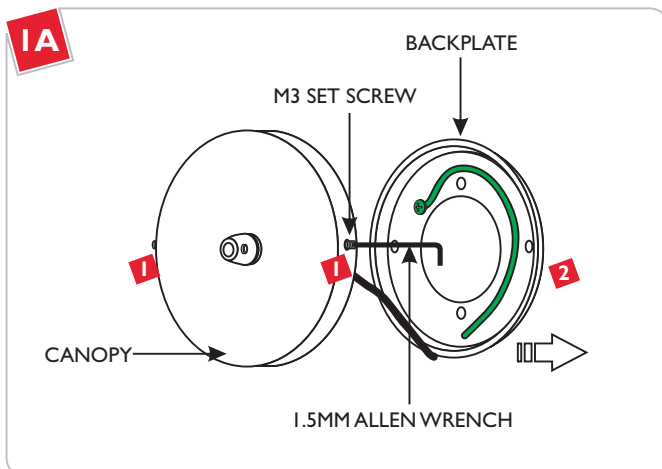

- 1** Loosen (**Do Not Remove**) the two M3 set screws on side of the canopy with the 1.5MM Allen wrench provided.
- 2** Remove the backplate.

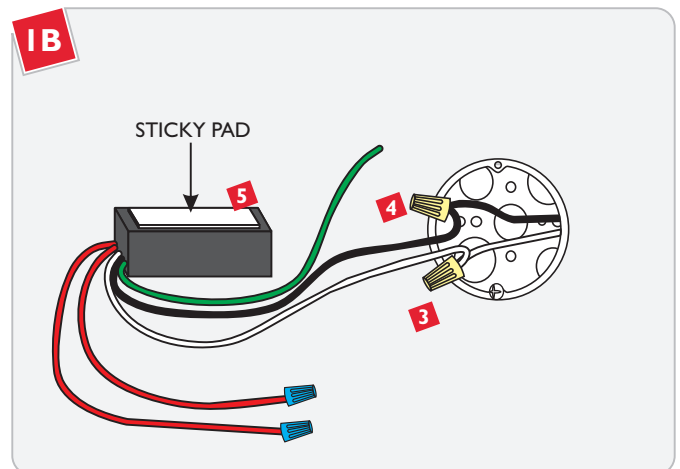

- 3** Connect the transformer white wire to the neutral power line wire with a wire nut.
- 4** Connect the transformer black wire to the hot power line wire with a wire nut.
- 5** Place the transformer inside the electrical box. Use the attached sticky pad to secure it against the electrical box.

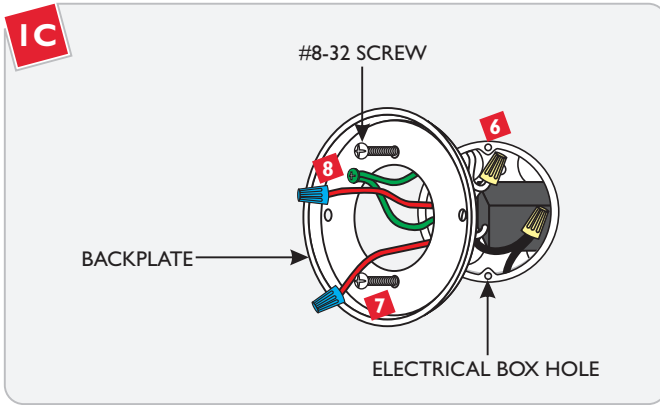

- 6** Line up two backplate holes with the electrical box holes.
- 7** Mount the backplate to the electrical box with the two #8-32 screws provided.
- 8** In accordance with local electrical codes, make sure that the backplate and the transformer green wire are grounded.

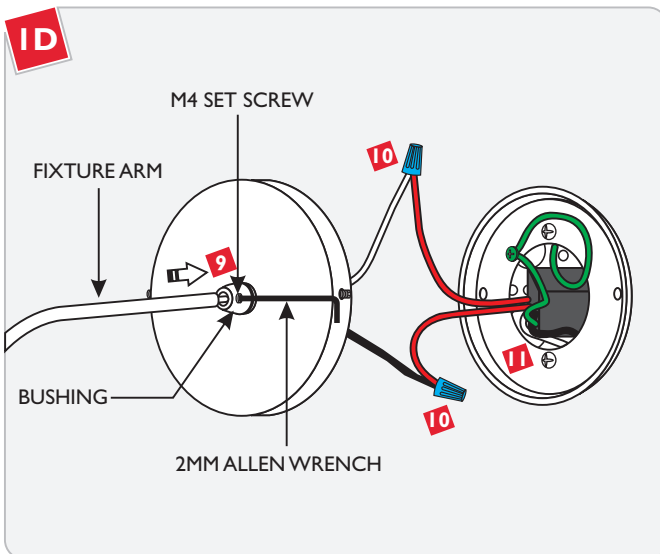

- 9** Push the fixture arm with the wire completely into the bushing and tighten the M4 set screw with the 2MM Allen wrench.
- 10** Connect each transformer low voltage wire (red wire) to one fixture wire with a wire nut.
- 11** Place all wires and wire nut connections inside the electrical box.

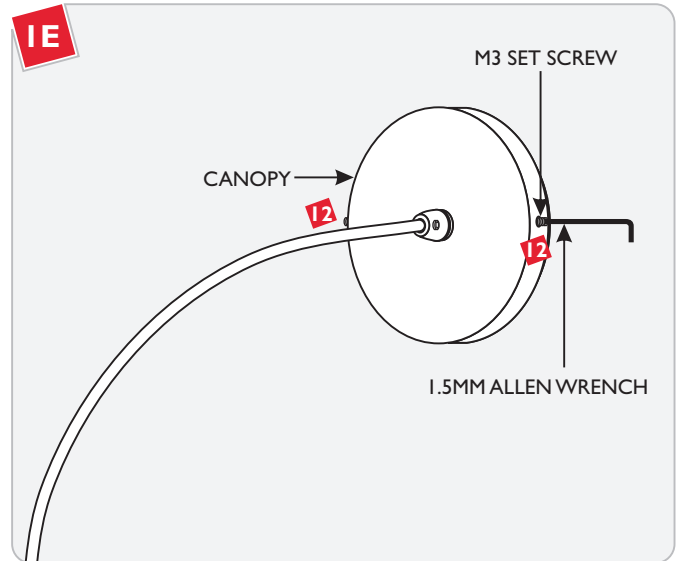

- 12** Place the fixture canopy onto the backplate. Level the fixture vertically and tighten the two M3 set screws with the 1.5MM Allen wrench to secure the fixture in place.

## Install the Glass Shade & Lamp

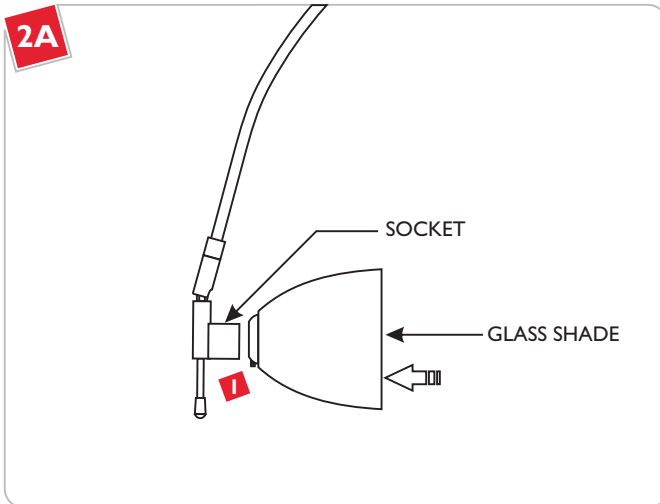

**1** Push the glass shade completely onto the socket.

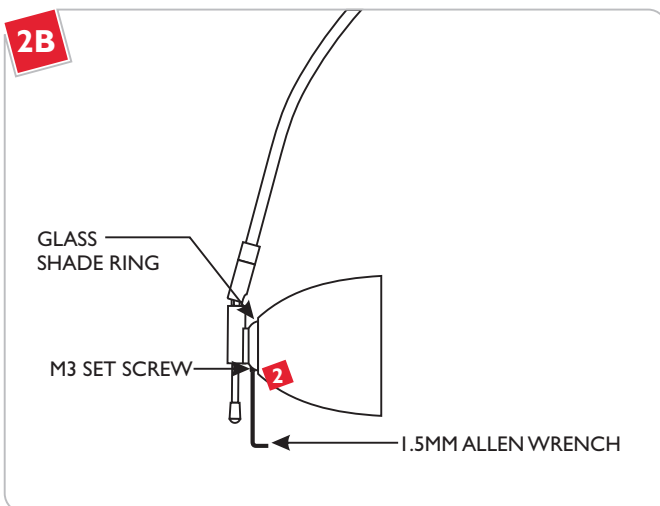

**2** Tighten the M3 set screw on the glass shade ring with the 1.5MM Allen wrench.

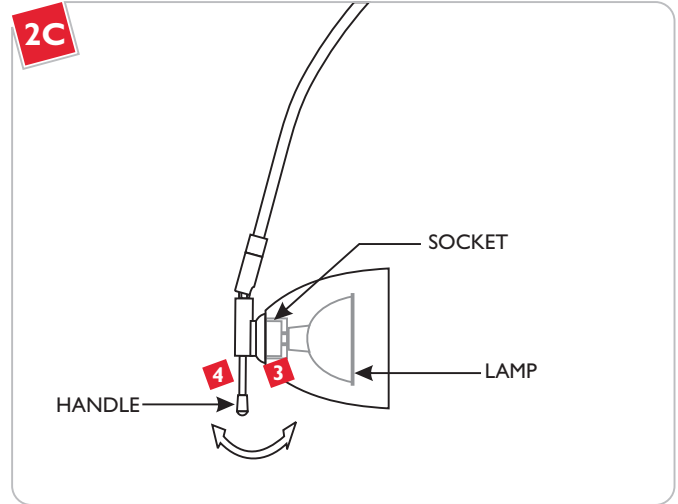

Use **MAX 50** Watt MR16 Front Cover Halogen Lamp With Ursula, Mini-Dome I, Mini-Dome II, Orbit, Mini-Reflex, and Calla Galleria Models.



Use **MAX 35** Watt MR16 Front Cover Halogen Lamp With Black Mini-Reflex Galleria Model.



Use **MAX 20** Watt MR11 Front Cover Halogen Lamp With Cube Galleria Model.



**3** Align and push the lamp pins completely into the socket holes.

**4** Use the fixture handle to rotate and aim the light.

### **NOTE: To replace the lamp:**

- Turn the power to the fixture off.
- Loosen (**Do Not Remove**) the M3 set screw on the glass shade ring with the 1.5MM Allen wrench.
- Pull the glass shade along with the lamp out.
- Repeat steps 1 through 4.

## IMPORTANT SAFETY INSTRUCTIONS

**To reduce the risk of fire, electrical shock, exposure to excessive UV radiation, or injury to person:**

- Use this fixture indoors only.
- Do not look directly at the lighted lamp.
- Do not remain in light if skin feels warm.
- Risk of fire: Use only the type of lamp and maximum wattage indicated in this instruction manual.
- Never cover the halogen lamp with anything other than a LBL Lighting lamp shield and never place flammable material close to your fixture.
- Never turn the fixture on and off by connecting and disconnecting the halogen lamp.
- Do not touch the fixture shades or lamp shield while the fixture is on. These surfaces may be HOT.

## Halogen Lamp General Information

- A new halogen lamp may smoke slightly when it is used for the first time. This is perfectly normal; the protective coating is simply being vaporized.

## Two Tips For Prolonging Halogen Lamp Life

- First avoid touching the lamp with bare hands during installation. Any contaminant, even the oil from your hands can deteriorate the lamp. Rubbing alcohol can be used to remove any contaminant.
- Second, do not run the lamps at full power when you do not need to. However, if dimming the fixture for an extended period of time, occasionally bring the light up to full brightness for a few minutes to complete the halogen cycle.

**SAVE THESE INSTRUCTIONS!**



7400 Linder Ave, Skokie, IL 60077

800.323.3226 - 847.626.6300

[www.lblighting.com](http://www.lblighting.com)

© 2008 LBL Lighting. All rights reserved. The "LBL Lighting" graphic is a registered trademark of LBL Lighting. LBL Lighting reserves the right to change specifications for product improvements without notification.

A Generation Brands Company