

# LED Floor Lamp

# FL95360

INSTALLATION SHEET

## START FROM HERE

- Prepare everything in a clear area
- Wear gloves at all time during this installation
- Read instructions carefully before you start assembly
- Keep this installation sheet for future reference

### Please Note:

- This Kuzco LED fixtures come with pre-wired LED module(s)
- Unless instructed, Do Not touch any part of the LED module(s) as any unnecessary contact with the module could cause permanent damage
- Touch Dimmer

Technical Support: 1-855-855-8926

- 1.** Remove the fixture from it's original packaging
- 2.** Connect driver (1a) to coaxial connector (1b)
- 3.** Plug driver (1a) into outlet.
- 4.** Use hand to activate dimmer (2a). Touch and hold to dim, touch to turn on/off.

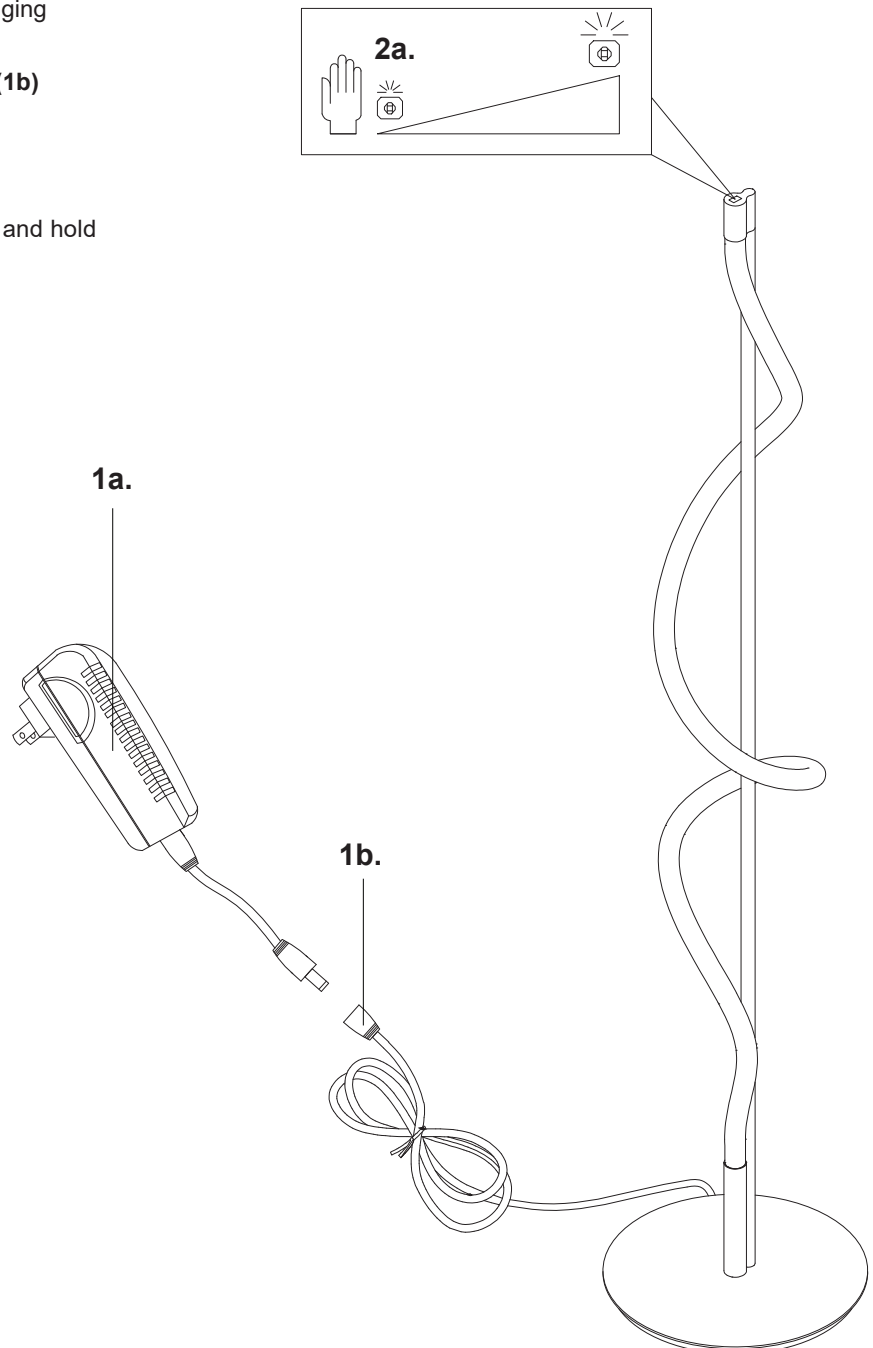

# KUZCO

19054 28th Avenue Surrey, BC Canada V3Z 6M3  
T: 604 538 7162 TF: 1-855 85 KUZCO F: 604 538 7196  
W: kuzcolighting.com  
20200428