

KOHLER®

INSTALLATION
INSTRUCTIONS

WIDESPREAD LAVATORY SHAMPOO FAUCETS

BEFORE YOU BEGIN

NOTES

- Shut off the main water supply.
- Observe local plumbing codes.
- If possible, install this faucet before installing the lavatory.
- Inspect the supply tubing for damage. Replace as necessary.
- Kohler Co. reserves the right to make revisions in the design of faucets without notice, as specified in the Price Book.

TOOLS AND MATERIALS RECOMMENDED

- Adjustable wrench
- Thread sealant
- Plumbers putty
- Hacksaw or tubing cutter
- Pipe wrench
- Channel lock pliers

INSTALLATION

FAUCET

- Apply a ring of plumbers putty or other sealant to the spout escutcheon underside according to the putty manufacturer's instructions.
- Thread the shank assembly locknut down against the supply tee. Remove and discard the plastic thread protector from the shank assembly. Insert the shank assembly up through the center lavatory hole, and thread the spout escutcheon to the shank assembly so about 3/8" of shank thread is exposed above the escutcheon.
- Carefully press the spout onto the shank, and securely hand tighten the spout to the shank assembly. Thread the spout escutcheon counterclockwise until it stops.
- Align the spout escutcheon so the lift rod hole is to the rear. Turn the supply tee so the cold inlet (blue) is on the left. Securely wrench tighten the shank locknut.
- Remove any excess putty or sealant.

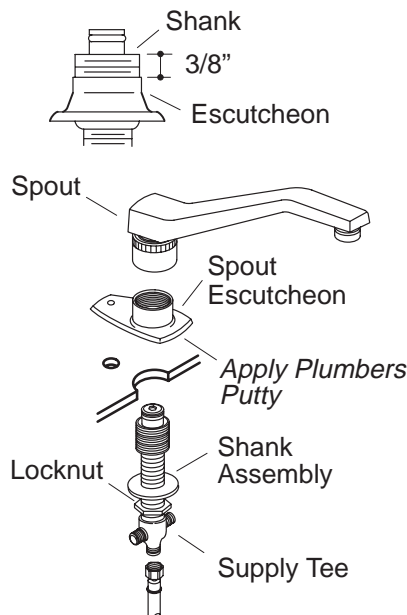

DISPENSER

- Apply plumbers putty or other sealant to the underside of the dispenser flange according to the putty manufacturer's instructions. Fit the dispenser through the lavatory hole.
- Secure the dispenser to the lavatory with the locknut.
- Thread on the bottle.
- Remove any excess putty or sealant.

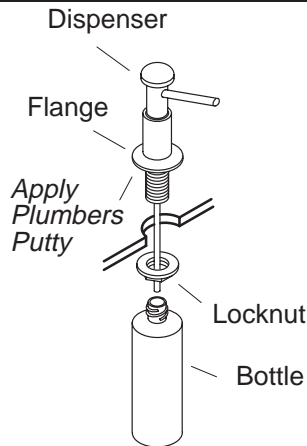

HANDSPRAY

- Remove and save the locknut from the spray escutcheon.
- Apply a ring of plumbers putty or other sealant to the spray escutcheon according to the putty manufacturer's instructions. Insert the spray escutcheon into the appropriate lavatory hole. Thread the locknut to the spray escutcheon, and securely wrench tighten.
- Remove any excess putty or sealant.
- Insert the spray hose into the spray escutcheon, and thread the hose to the bottom shank tee connection. Carefully wrench tighten.

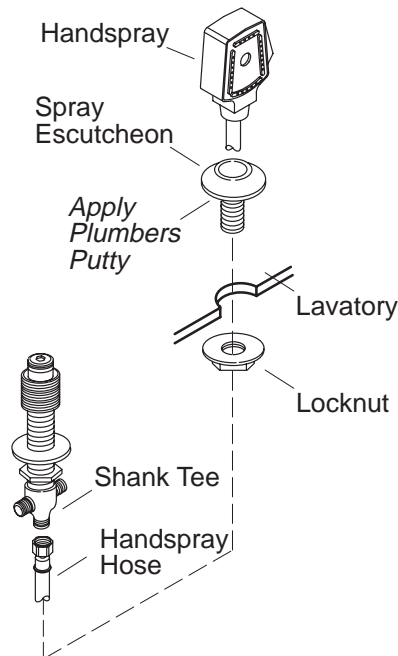

END BODIES

- Apply a ring of plumbers putty or other sealant to the underside of the end body escutcheons according to the putty manufacturer's instructions.
- Insert the end bodies into the mounting holes from the top of the lavatory. Make sure the end body marked "Cold" is installed in the right-hand hole (as viewed from the front of the lavatory).

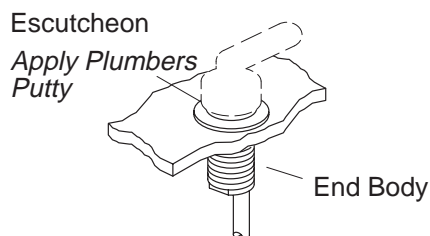

- Install a washer and nut to the bottom of the end bodies.
- Align the end bodies so the copper tubing faces to the outside.
- Wrench tighten the nuts.
- Remove any excess putty or sealant.

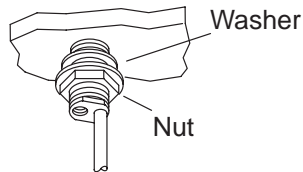

- Thread the flexible hoses to the end body outlets. Wrench tighten, but do not overtighten.
- Connect the flexible hoses to the tee inlets. Do not use thread sealant. To avoid kinking the hoses, loop them. Do not overtighten.

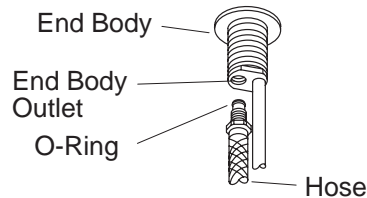

DETERMINE YOUR DRAIN STYLE AND FOLLOW THE APPROPRIATE INSTALLATION STEPS.

DRAIN (CP AND PB FINISHES)

- Remove the protective seal from the flange.
- Apply a 1/2" diameter ring of plumbers putty or other sealant around the underside of the flange according to the putty manufacturer's instructions. Insert the flange into the lavatory drain hole.
- Assemble the gasket (tapered side up) and washer to the flange, and partially thread the nut to the flange. **Do not** fully tighten the nut at this time.
- Install the body washer and body to the flange, and wrench tighten.
- Position the body so the seal hole is facing toward the back of the lavatory.
- Handtighten the nut.
- Remove any excess putty or sealant.

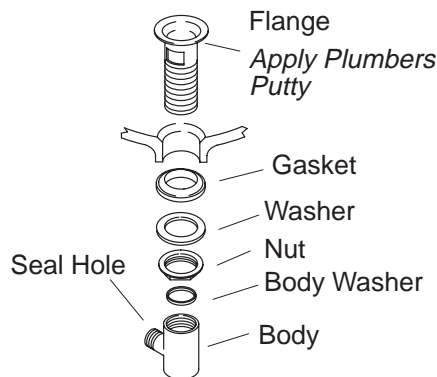

DRAIN (OTHER FINISHES)

- Remove the flange from the body.
- Thread the nut completely onto the body.
- Apply a 1/2" diameter ring of plumbers putty or other sealant to the underside of the drain flange according to the putty manufacturer's instructions.
- Insert the drain body up into the underside of the lavatory drain hole.
- Position the body so the seal hole is facing toward the back of the lavatory.
- Thread the flange onto the drain body from the topside of the lavatory.
- Securely handtighten the nut from the underside of the lavatory.
- Remove any excess putty or sealant.

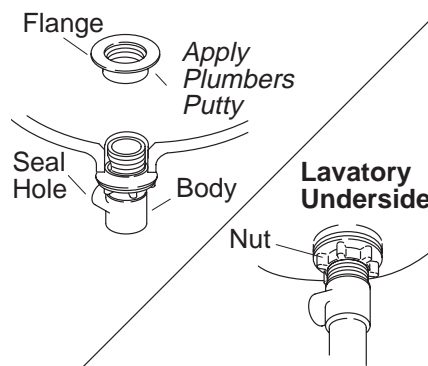

- Assemble the nylon washer, metal washer, and nut onto the long end of the rod.
- Assemble the nylon washer and rubber washer onto the short end of the rod.

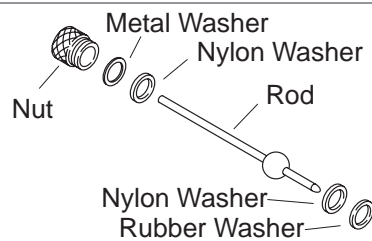

ALL DRAINS

- Insert the stopper into the flange.
- Remove the body nut from the seal hole.
- Fit the short end of the rod into the body seal hole and **under** the stopper for regular installations; **through** the hole for vandal-resistant installations.
- Loosely secure in place with the body nut.
- Remove and adjust the stopper so the stopper lifts about 3/8" when opened. To adjust, loosen the stopper nut and shorten or lengthen the stopper as needed. Re-tighten the stopper nut.
- Handtighten the body nut.
- Apply thread sealant to the tailpiece. Thread the tailpiece into the body and securely handtighten.

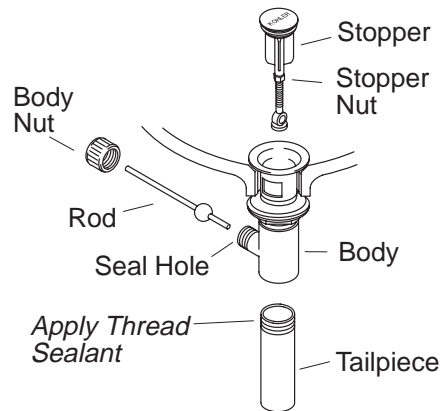

- Assemble the link to the lift rod with the clip.
- Insert the lift rod through the escutcheon from the underside, and thread the lift rod knob to the lift rod.
- Slide the lift rod through the hole in the link.
- Wrench tighten the screw on the link so the lift rod knob is 1/2" above the top of the escutcheon.

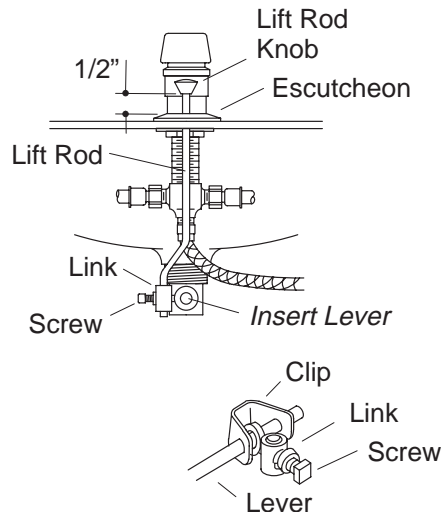

IF THE LAVATORY IS NOT INSTALLED, INSTALL IT AT THIS TIME. BE SURE TO FOLLOW ALL INSTRUCTIONS PACKED WITH THE LAVATORY.

SUPPLIES AND STOPS

- Connect the supply tubes to the faucet end bodies and supply stops. (Left is hot – right is cold.)
- Tighten all connections.

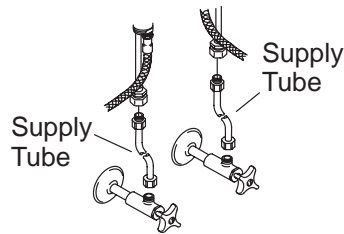

INSTALLATION CHECKOUT

- Connect the tailpiece and P-trap.
- Ensure that all connections are tight.
- Remove the aerator.
- Open the drain.
- Turn on the main water supply and check for leaks.
- Open both hot and cold valves and run water through the spout to remove any debris. Turn the valves off.
- Reinstall the aerator.

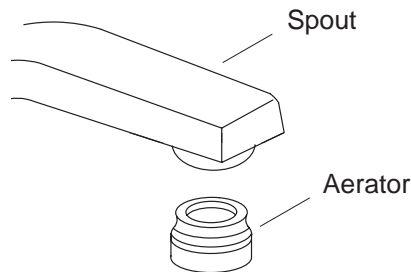

CALL US FOR HELP – 1-800-4-KOHLER

REQUESTING SERVICE

Here's what you need to do if you require service:

First review the installation instructions to ensure correct installation. If you are still unable to correct the problem, call our Customer Service Department for direct help. Dial **1-800-4-KOHLER**.



KOHLER®

